

State

Budget Bureau No. 42-R359.4.
Approval expires 12-31-60.

(SUBMIT IN TRIPLICATE)

UNITED STATES
DEPARTMENT OF THE INTERIOR
GEOLOGICAL SURVEY

Indian Agency _____

Allottee _____

Lease No. 14-20-604-1951

SUNDRY NOTICES AND REPORTS ON WELLS

NOTICE OF INTENTION TO DRILL	<input checked="" type="checkbox"/>	SUBSEQUENT REPORT OF WATER SHUT-OFF	
NOTICE OF INTENTION TO CHANGE PLANS		SUBSEQUENT REPORT OF SHOOTING OR ACIDIZING	
NOTICE OF INTENTION TO TEST WATER SHUT-OFF		SUBSEQUENT REPORT OF ALTERING CASING	
NOTICE OF INTENTION TO REDRILL OR REPAIR WELL		SUBSEQUENT REPORT OF REDRILLING OR REPAIR	
NOTICE OF INTENTION TO SHOOT OR ACIDIZE		SUBSEQUENT REPORT OF ABANDONMENT	
NOTICE OF INTENTION TO PULL OR ALTER CASING		SUPPLEMENTARY WELL HISTORY	
NOTICE OF INTENTION TO ABANDON WELL			

(INDICATE ABOVE BY CHECK MARK NATURE OF REPORT, NOTICE, OR OTHER DATA)

~~Banner Drilling Co.~~
UTE

June 25th, 1958

Well No. 2 is located 2140 ft. from N line and 735 ft. from W line of sec. _____

NW 1/4 Sec 34

T1N - 16 W

N.M.M.

(1/4 Sec. and Sec. No.)

(Twp.)

(Range)

(Meridian)

Verde alluv

San Juan

N.M.

(Field)

(County or Subdivision)

(State or Territory)

The elevation of the derrick floor above sea level is 5375 ft.

DETAILS OF WORK

(State names of and expected depths to objective sands; show sizes, weights, and lengths of proposed casings; indicate mudding jobs, cementing points, and all other important proposed work)

It is intended to drill a well with rotary tools and thru the
Lahota formation estimated depth 1900'

Casing program: 95/8 surface set @ 120' w/100 sacks circulated
to surface.

5" set at 1900' w/200 sacks.

NW 1/4 of sec 34 is dedicated to this well.

I understand that this plan of work must receive approval in writing by the Geological Survey before operations may be commenced.

Company Banner Drilling Co.

Address P.O. Box 1571

Farmin ton, New Mexico

By Ben Banner
Co owner

Title _____

۱۲۷

Number of hauls	<i>P. setiferus</i> (%)	<i>P. setiferus</i> + <i>P. setiferus</i> + <i>P. setiferus</i> (%)
1	10	5
2	30	10
3	50	15
4	70	20
5	85	25
6	95	30
7	100	35
8	100	38
9	100	40
10	100	42

100

[illegible]

NEW MEXICO OIL CONSERVATION COMMISSION

Well Location and Acreage Dedication Plat

Section A.

Date 6/25-58

Operator Banner Drilling Company Lease Ute
Well No. 2 Unit Letter Section 34 Township 31 North Range 16 West NMPM
Located 2140 Feet From South Line, 735 Feet From West Line
County San Juan G. L. Elevation 5369 Dedicated Acreage 39.74 Acres
Name of Producing Formation Norsealike Pool Wash Gallup

1. Is the Operator the only owner* in the dedicated acreage outlined on the plat below?
Yes ☒ No ☐
2. If the answer to question one is "no," have the interests of all the owners been consolidated by communitization agreement or otherwise? Yes ☐ No ☐. If answer is "yes,"
Type of Consolidation
3. If the answer to question two is "no," list all the owners and their respective interests below:

Owner

Land Description

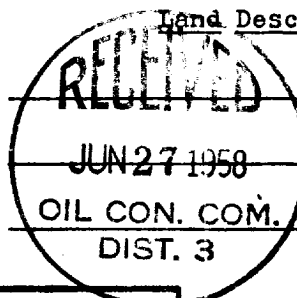

Section. B

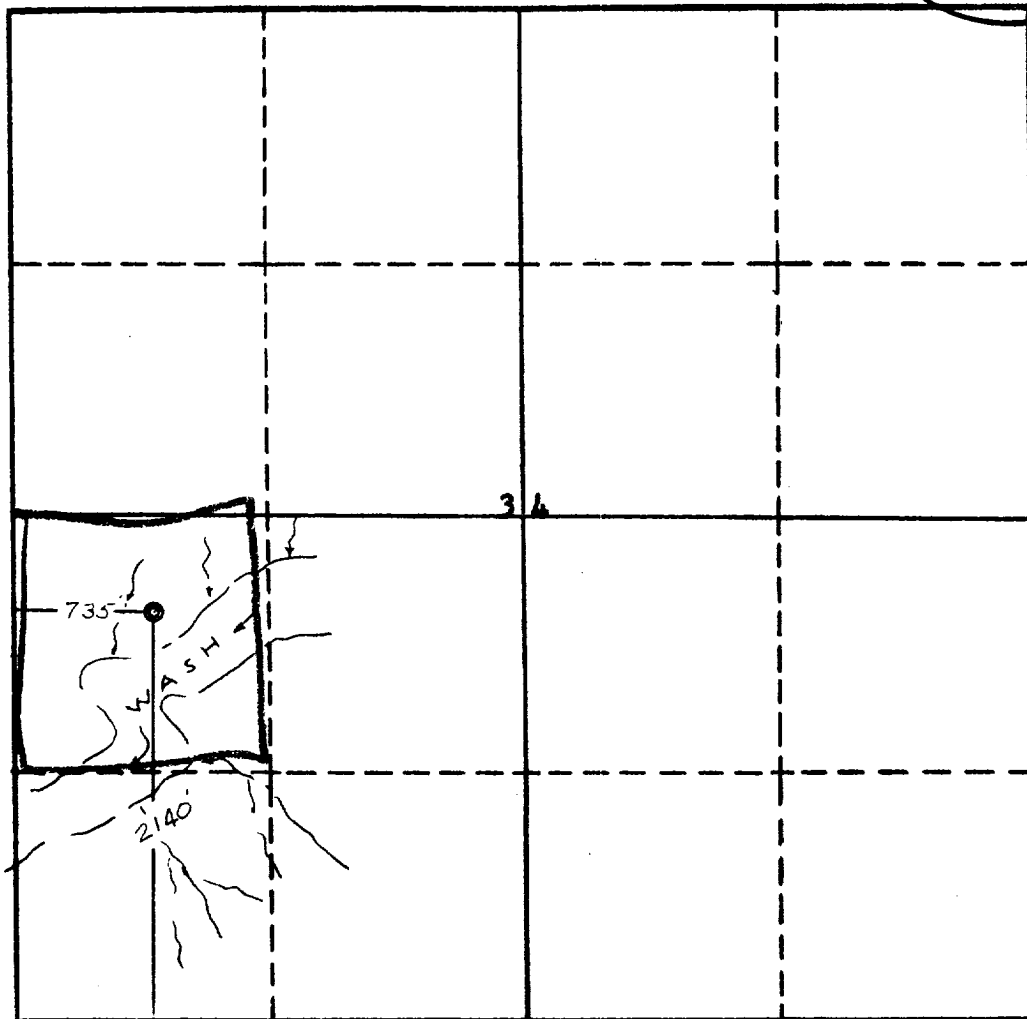

This is to certify that the information in Section A above is true and complete to the best of my knowledge and belief.

Banner Drilling Co
(Operator)

Ben Banner
(Representative)

Box 1571
Farmington N.M.
Address

This is to certify that the well location on the plat in Section B was located from field notes of actual surveys made by or under my supervision and that the same is true and correct to the best of my knowledge and belief.

Date Surveyed June 21, 1958

Ernest V. Echohawk
Ernest V. Echohawk
Registered Land Surveyor.

Certificate No. 1545

