

(SUBMIT IN TRIPLICATE)

UNITED STATES
DEPARTMENT OF THE INTERIOR
GEOLOGICAL SURVEY

Indian Agency _____

Navajo

Allottee _____

Lease No. **14-80-403-1057**

SUNDRY NOTICES AND REPORTS ON WELLS

NOTICE OF INTENTION TO DRILL	<input checked="" type="checkbox"/>	SUBSEQUENT REPORT OF WATER SHUT-OFF	
NOTICE OF INTENTION TO CHANGE PLANS		SUBSEQUENT REPORT OF SHOOTING OR ACIDIZING	
NOTICE OF INTENTION TO TEST WATER SHUT-OFF		SUBSEQUENT REPORT OF ALTERING CASING	
NOTICE OF INTENTION TO REDRILL OR REPAIR WELL		SUBSEQUENT REPORT OF REDRILLING OR REPAIR	
NOTICE OF INTENTION TO SHOOT OR ACIDIZE		SUBSEQUENT REPORT OF ABANDONMENT	
NOTICE OF INTENTION TO PULL OR ALTER CASING		SUPPLEMENTARY WELL HISTORY	
NOTICE OF INTENTION TO ABANDON WELL			

(INDICATE ABOVE BY CHECK MARK NATURE OF REPORT, NOTICE, OR OTHER DATA)

U. S. GEOLOGICAL SURVEY
FARMINGTON, NEW MEXICO

October 26, 19**61**

Care Note: _____

Well No. **25** is located **1650** ft. from **[N]** line and **2095** ft. from **[E]** line of sec. **36**

SW NE Section 36 **1N** **19W** **104N**

(1/4 Sec. and Sec. No.) (Twp.) (Range) (Meridian)

Wildcat **San Juan** **New Mexico**

(Field) (County or Subdivision) (State or Territory)

The elevation of the derrick floor above sea level is _____ ft. **1810' ungraded ground.**

DETAILS OF WORK

(State names of and expected depths to objective sands; show sizes, weights, and lengths of proposed casings; indicate mudding jobs, cementing points, and all other important proposed work)

Rotary drilling equipment will be used to drill to approximately 1450' to the San Juan Formation. If production is found, casing will be set and cemented with required amount of cement. Native mud and water will be used in drilling. Shows will be tested and electric logs will be run prior to setting casing or abandonment. Stimulation treatments may be employed in completion.



I understand that this plan of work must receive approval in writing by the Geological Survey before operations may be commenced.

Company **Humble Oil & Refining Company**

Address **P. O. Box 1002,**
Durango, Colorado

COPY (ORIGINAL SIGNED) **B. M. BRADLEY**

By **B. M. Bradley**

Title **Dist. Supt.**

NUMBER OF COPIES RECEIVED	
DISTRIBUTION	
SANTA FE	
FILE	
U.S.G.S	
LAND OFFICE	
TRANSPORTER	OIL GAS
PRODUCTION OFFICE	
OPERATOR	

NEW MEXICO OIL CONSERVATION COMMISSION
WELL LOCATION AND ACREAGE DEDICATION PLAT
 SEE INSTRUCTIONS FOR COMPLETING THIS FORM ON THE REVERSE SIDE

FORM C-128
 Revised 5/1/57

SECTION A

Operator Humble Oil & Refining Company			Lease Core Hole		Well No. 25
Unit Letter G	Section 36	Township 31 N	Range 19 W	County San Juan	
Actual Footage Location of Well: 1650 feet from the North line and 2095 feet from the East line					
Ground Level Elev. 4848'	Producing Formation		Pool Wildcat	Dedicated Acreage: Acres	

1. Is the Operator the only owner in the dedicated acreage outlined on the plat below? YES ☒ NO ☐ *(Owner means the person who has the right to drill into and to produce from any pool and to appropriate the production either for himself or himself and another. (65-3-29 (e) NMSA 1935 Comp.)*
2. If the answer to question one is "no," have the interests of all the owners been consolidated by communitization agreement or otherwise? YES ☐ NO ☐ . If answer is "yes," Type of Consolidation _____
3. If the answer to question two is "no," list all the owners and their respective interests below:

Owner	Land Description

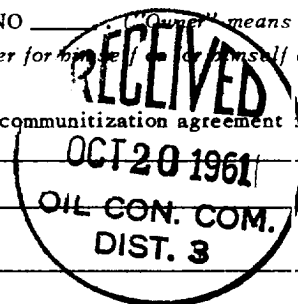

SECTION B

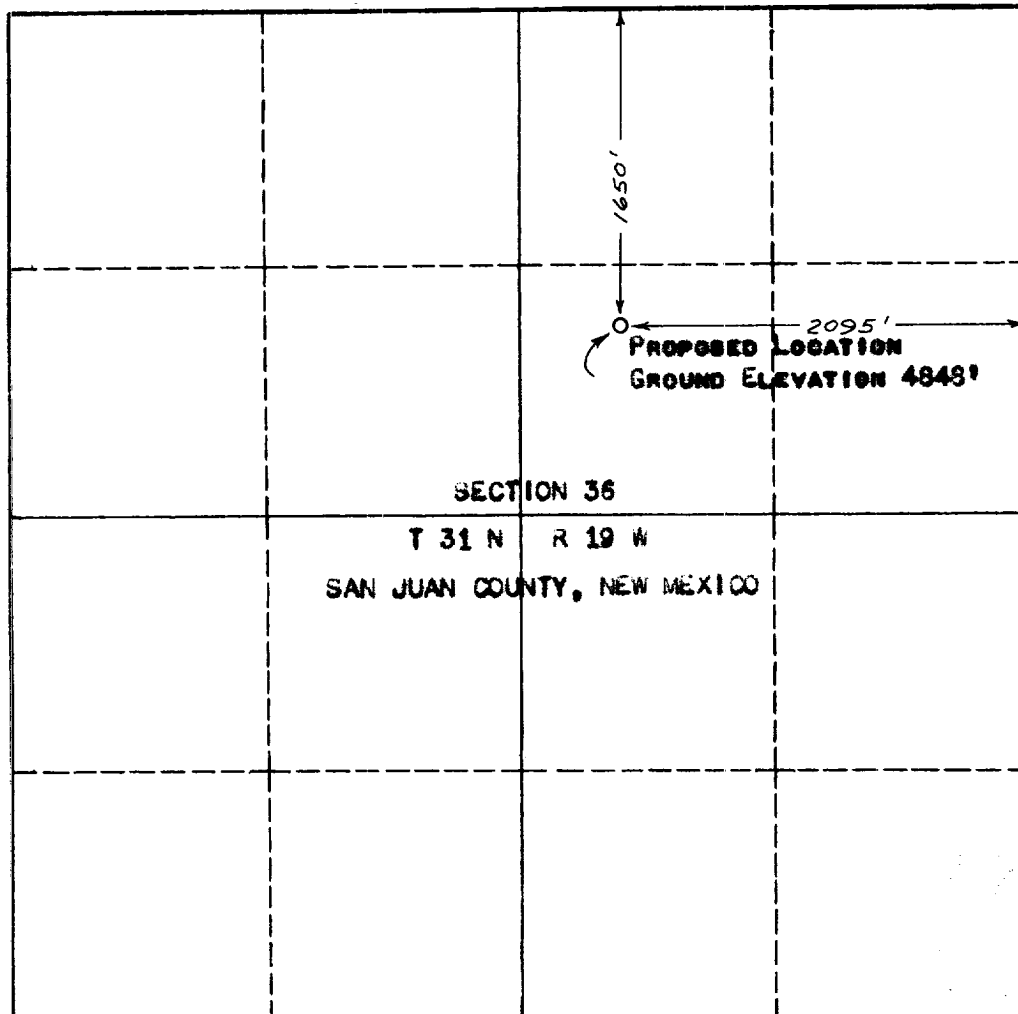

CERTIFICATION

I hereby certify that the information in SECTION A above is true and complete to the best of my knowledge and belief.

COPY (ORIGINAL SIGNED)	B. M. BRADLEY
Position	B. M. Bradley Dist. Supt.
Company	Humble Oil & Refining Co.
Date	October 16, 1961

I hereby certify that the well location shown on the plat in SECTION B was plotted from field notes of actual surveys made by me or under my supervision, and that the same is true and correct to the best of my knowledge and belief.

Date Surveyed	October 13, 1961
Registered Professional Engineer and/or Land Surveyor	<i>Charles M. Clark</i>

Certificate No.
NEW MEXICO #3189

0 330 660 990 1320 1650 1980 2310 2640 2000 1500 1000 500 0

INSTRUCTIONS FOR COMPLETION OF FORM C-128

1. Operator shall furnish and certify to the information called for in Section A.
2. Operator shall outline the dedicated acreage for *both* oil and gas wells on the plat in Section B.
3. A registered professional engineer or land surveyor registered in the State of New Mexico or approved by the Commission shall show on the plat the location of the well and certify this information in the space provided.
4. All distances shown on the plat must be from the outer boundaries of the Section.
5. If additional space is needed for listing owners and their respective interests as required in question 3 of Section A, please use space below.