

(SUBMIT IN TRIPLICATE)

UNITED STATES  
DEPARTMENT OF THE INTERIOR  
GEOLOGICAL SURVEY

Indian Agency \_\_\_\_\_

Window Rock

Allottee Navajo Tribal

Lease No. 11-20-603-731

## SUNDRY NOTICES AND REPORTS ON WELLS

NOTICE OF INTENTION TO DRILL	<input checked="" type="checkbox"/>	SUBSEQUENT REPORT OF WATER SHUT-OFF	
NOTICE OF INTENTION TO CHANGE PLANS		SUBSEQUENT REPORT OF SHOOTING OR ACIDIZING	
NOTICE OF INTENTION TO TEST WATER SHUT-OFF		SUBSEQUENT REPORT OF ALTERING CASING	
NOTICE OF INTENTION TO REDRILL OR REPAIR WELL		SUBSEQUENT REPORT OF REDRILLING OR REPAIR	
NOTICE OF INTENTION TO SHOOT OR ACIDIZE		SUBSEQUENT REPORT OF ABANDONMENT	
NOTICE OF INTENTION TO PULL OR ALTER CASING		SUPPLEMENTARY WELL HISTORY	
NOTICE OF INTENTION TO ABANDON WELL			

(INDICATE ABOVE BY CHECK MARK NATURE OF REPORT, NOTICE, OR OTHER DATA)

April 17, 1959

Well No. 51 is located 1980 ft. from N line and 660 ft. from W line of sec. 32  
SW 1/4 Sec. 32 31 N 16 W N.H.P.M.  
(1/4 Sec. and Sec. No.) (Twp.) (Range) (Meridian)  
Horseshoe Gallup San Juan New Mexico  
(Field) (County or Subdivision) (State or Territory)

The elevation of the ground ~~surface~~ above sea level is 5394 ft.

## DETAILS OF WORK

(State names of and expected depths to objective sands; show sizes, weights, and lengths of proposed casings; indicate mudding jobs, cementing points, and all other important proposed work)

We propose to drill a well at the above location to an approximate total depth of 1350'. 100' of 8-5/8" O.D. casing will be set and cemented to surface. Should the well prove productive a 4-1/2" O.D. oil string will be used. Completion is contemplated in the Gallup formation.



I understand that this plan of work must receive approval in writing by the Geological Survey before operations may be commenced.

Company The Atlantic Refining CompanyAddress P. O. Box 520Casper, WyomingBy AD KlopferTitle Drilling Superintendent

喜

~~...of ... ..~~

1997-1998

### Ans. continued

## NEW MEXICO OIL CONSERVATION COMMISSION

Well Location and Acreage Dedication Plat

Section A.

Date April 16, 1959

Operator THE ATLANTIC REFINING COMPANY Lease NAVAJO  
 Well No. 51 Unit Letter E Section 32 Township 31 NORTH Range 16 WEST NMPM  
 Located 1980 Feet From NORTH Line, 660 Feet From WEST Line  
 County SAN JUAN G. L. Elevation 5394.0 Dedicated Acreage 40.08 Acres  
 Name of Producing Formation Gallup Pool Horseshoe Gallup

1. Is the Operator the only owner in the dedicated acreage outlined on the plat below?

Yes ☒ No ☐2. If the answer to question one is "no", have the interests of all the owners been consolidated by communitization agreement or otherwise? Yes ☐ No ☐ If answer is "yes", Type of Consolidation.

3. If the answer to question two is "no", list all the owners and their respective interests below:

OwnerLand Description

RECEIVED

APR 20 1959

J. S. OLOGIC - NEW

Section B.

Note: All distances must be from outer boundaries of section.

This is to certify that the information in Section A above is true and complete to the best of my knowledge and belief.

The Atlantic Refining Co.  
 (Operator)

A. D. Klerin  
 (Representative)

P. O. Box 580  
 (Address)

Casper, Wyoming

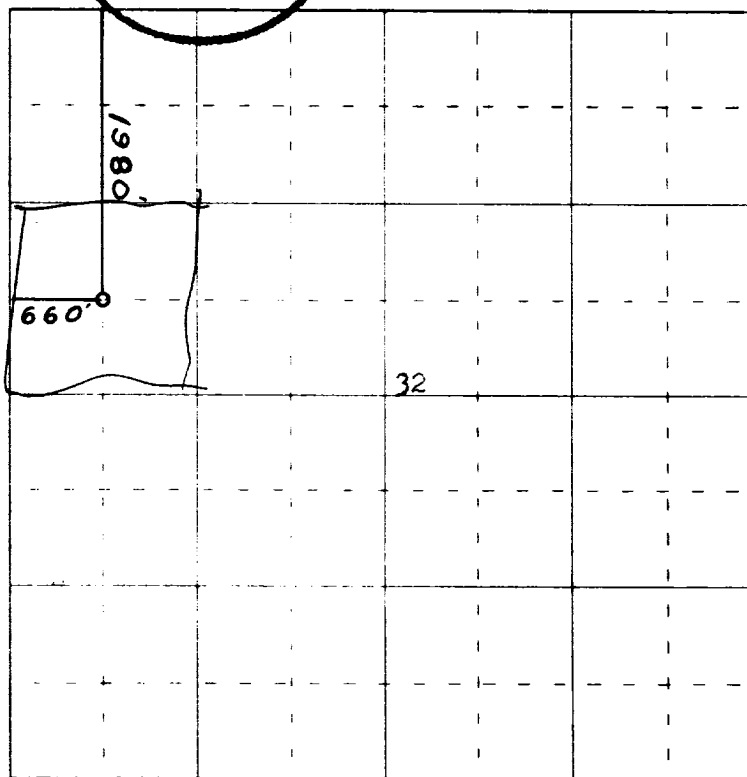

0 330 660 990 1320 1650 1980 2310 2640 2000 1500 1000 500 0

Scale 4 inches equal 1 mile

N



(Seal)

Farmington, New Mexico

This is to certify that the above plat was prepared from field notes of actual surveys made by me or under my supervision and that the same are true and correct to the best of my knowledge and belief.

Date Surveyed 29 September 1958

James P. Leese  
 Registered Professional Engineer and/or Land Surveyor  
 James P. Leese, N. Mex. Reg. No. 1162