

District I
P O Box 1980, Hobbs, NM

District II
P O. Drawer DD, Artesia, NM 88221

District III
1000 Rio Brazos Rd, Aztec, NM 87410

State of New Mexico
Energy, Minerals and Natural Resources Department

OIL CONSERVATION DIVISION

2040 South Pacheco Street
Santa Fe, New Mexico 87505

OK
SUBMIT 1 COPY TO
APPROPRIATE
DISTRICT OFFICE
AND 1 COPY TO
SANTA FE OFFICE

PIT REMEDIATION AND CLOSURE REPORT

Operator: PNM Gas Services (Burlington) Telephone: 324-3764

Address: 603 W. Elm Street Farmington, NM 87401

Facility or Well Name: Taliaferro #4

Location: Unit M Sec 29 T 31 N R 12 W County San Juan

Pit Type: Separator ☐ Dehydrator ☒ Other

Land Type: BLM ☐ State ☐ Fee ☒ Other

Pit Location: Pit dimensions: length 13' width 13' depth 3'

(Attach diagram) Reference: wellhead ☒ other

Footage from reference: 175'

Direction from reference: 45 Degrees ☐ East North ☐
of ☒ West South ☒

Depth to Ground Water:

(Vertical distance from contaminants to
seasonal high water elevation of ground
water)

Less than 50 feet (20 points)
50 feet to 99 feet (10 points)
Greater than 100 feet (0 points) 0

Wellhead Protection Area:

(Less than 200 feet from a private
domestic water source, or, less than 1,000
feet from all other water sources)

Yes (20 points)
No (0 points) 0

Distance to Surface Water:

(Horizontal distance to perennial lakes,
ponds, rivers, streams, creeks, irrigation
canals and ditches)

Less than 200 feet (20 points)
200 feet to 1,000 feet (10 points)
Greater than 1,000 feet (0 points) 10

RANKING SCORE (TOTAL POINTS): 10

Taliaferro #4

Date Remediation Started: 06/03/1999

Date Completed: 06/03/1999

Remediation Method:

Excavation ☒

Approx. Cubic Yard 760

(Check all appropriate sections)

Landfarmed ☒

Amount Landfarmed (cubic yds) 760

Other

Remediation Location:

Onsite ☒

Offsite

(i.e., landfarmed onsite, name and location of offsite facility)

Backfill Material Location:

General Description of Remedial Action:

Excavated contaminated soil to a pit size of 27' X 38' X 20' and landfarmed soil onsite within a bermed area at a depth of 6" to 12". Soil was aerated by disking/plowing until soil met regulatory levels.

Ground Water Encountered:

No



Yes



Depth

Final Pit Closure Sampling:

Sample Location

5 pt. composite - bottom.

(if multiple samples, attach sample result and diagram of sample locations and depths.)

Sample depth

20'

Sample date

06/03/1999

Sample time

1:50:00 PM

Sample Results

Benzene (ppm) < 0.025

Total BTEX (ppm) 1.886

Field headspace (ppm)

TPH (ppm)

170.00

Method

8015B

Vertical Extent (ft)

Risk Analysis form attached Yes

No



Ground Water Sample:

Yes



No



(If yes, see attached Groundwater Site Summary Report)

I HEREBY CERTIFY THAT THE INFORMATION ABOVE IS TRUE AND COMPLETE TO THE BEST OF MY KNOWLEDGE AND MY BELIEF

DATE January 24, 2000

SIGNATURE

Maureen Gannon

PRINTED NAME Maureen Gannon
AND TITLE Project Manager

Fallick #4
(M) 29.31N-12W
Burlington
6-3-94 @ 0637

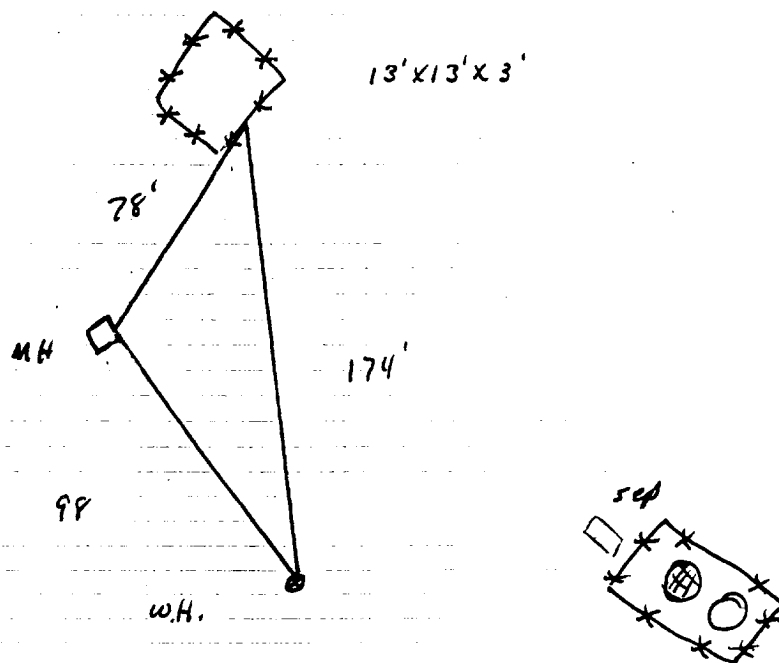

Excavation Sampling PID Readings

5' - 1592 ppm
10' - 1635 ppm
15' - 1787 ppm
20' - 1281 ppm

27'(N+S) x 38'(E+W) x 20'(D)

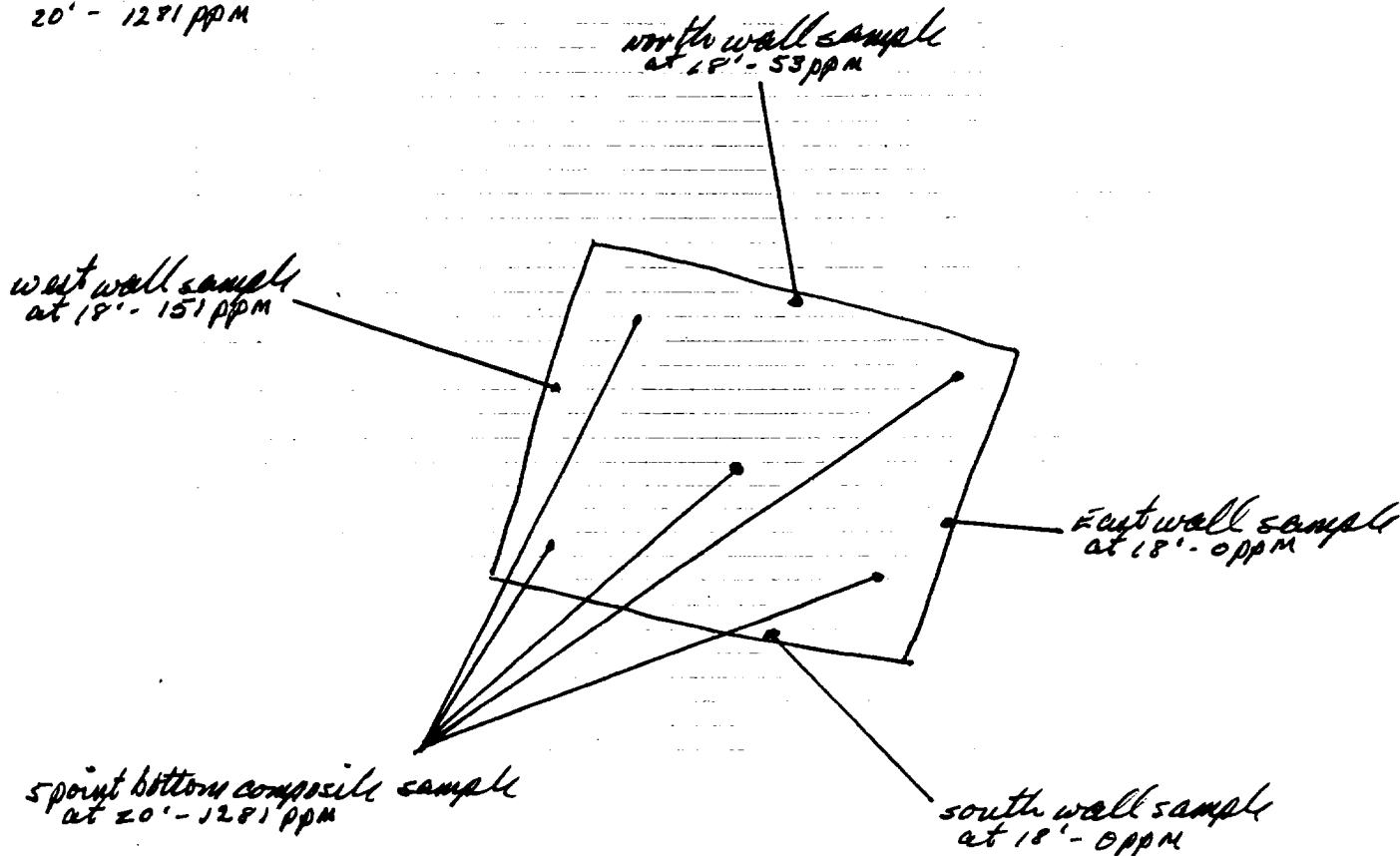

OFF: (505) 325-5667



LAB: (505) 325-1556

On Site Technologies, LTD.

Date: 17-Jun-99

CLIENT: PNM - Public Service Company of NM

Project: Taliaferro #4

Lab Order: 9906014

CASE NARRATIVE

Samples were analyzed using the methods outlined in the following references:

Test Methods for Evaluating Solid Waste, Physical/Chemical Methods, SW846, 3rd Edition

All method blanks, laboratory spikes, and/or matrix spikes met quality assurance objectives.

Ray

OFF: (505) 325-5667



LAB: (505) 325-1556

ANALYTICAL REPORT

Date: 17-Jun-99

Client:	PNM - Public Service Company of NM	Client Sample Info:	Taliaferro #4
Work Order:	9906014	Client Sample ID:	9906031350; 5pt. Bottom Comp
Lab ID:	9906014-01A	Matrix:	SOIL
Project:	Taliaferro #4	Collection Date:	6/3/99 1:50:00 PM
		COC Record:	7633

Parameter	Result	PQL	Qual	Units	DF	Date Analyzed
DIESEL RANGE ORGANICS						
	SW8015B					
T/R Hydrocarbons: C10-C28	170	25		mg/Kg	1	Analyst: DC 6/15/99
AROMATIC VOLATILES BY GC/PID						
	SW8021B					
Benzene	ND	25		µg/Kg	25	Analyst: DC 6/11/99
Toluene	72	50		µg/Kg	25	6/11/99
Ethylbenzene	94	25		µg/Kg	25	6/11/99
m,p-Xylene	1300	50		µg/Kg	25	6/11/99
o-Xylene	420	25		µg/Kg	25	6/11/99

1886
1.886 ppm

Qualifiers:	PQL - Practical Quantitation Limit	S - Spike Recovery outside accepted recovery limits
	ND - Not Detected at Practical Quantitation Limit	R - RPD outside accepted recovery limits
	J - Analyte detected below Practical Quantitation Limit	E - Value above quantitation range
	B - Analyte detected in the associated Method Blank	Surr: - Surrogate

P.O. BOX 2606 • FARMINGTON, NM 87499

1 of 1

OFF: (505) 325-5667



LAB: (505) 325-1556

ANALYTICAL REPORT

Date: 17-Jun-99

Client:	PNM - Public Service Company of NM	Client Sample Info:	Taliaferro #4
Work Order:	9906014	Client Sample ID:	9906031355; 4pt. Wall Comp
Lab ID:	9906014-02A	Matrix:	SOIL
Project:	Taliaferro #4	Collection Date:	6/3/99 1:55:00 PM
		COC Record:	7633

Parameter	Result	PQL	Qual	Units	DF	Date Analyzed
DIESEL RANGE ORGANICS		SW8015B				Analyst: DC
T/R Hydrocarbons: C10-C28	ND	25		mg/Kg	1	6/10/99

Qualifiers:

PQL - Practical Quantitation Limit
ND - Not Detected at Practical Quantitation Limit
J - Analyte detected below Practical Quantitation Limit
B - Analyte detected in the associated Method Blank

S - Spike Recovery outside accepted recovery limits
R - RPD outside accepted recovery limits
E - Value above quantitation range
Surr: - Surrogate

1 of 1

P.O. BOX 2606 • FARMINGTON, NM 87499

Taliaferro #4
Sec-29 T-31N R-12W ul-m
Burlington

LANDFARM DRAWING

App 760 cu yds

2" to 12" Depth

Headspace 91.7pf
Sample # 9907140922

60'

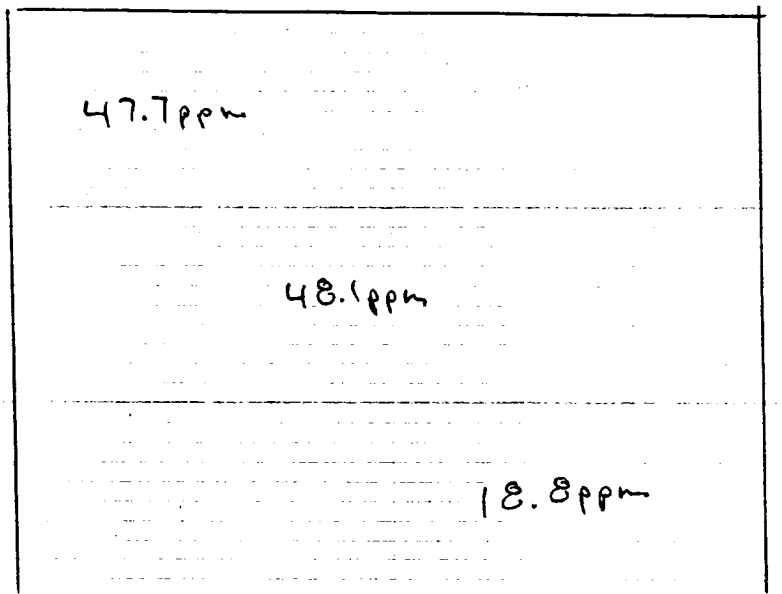

29'

37'
⊕

51'

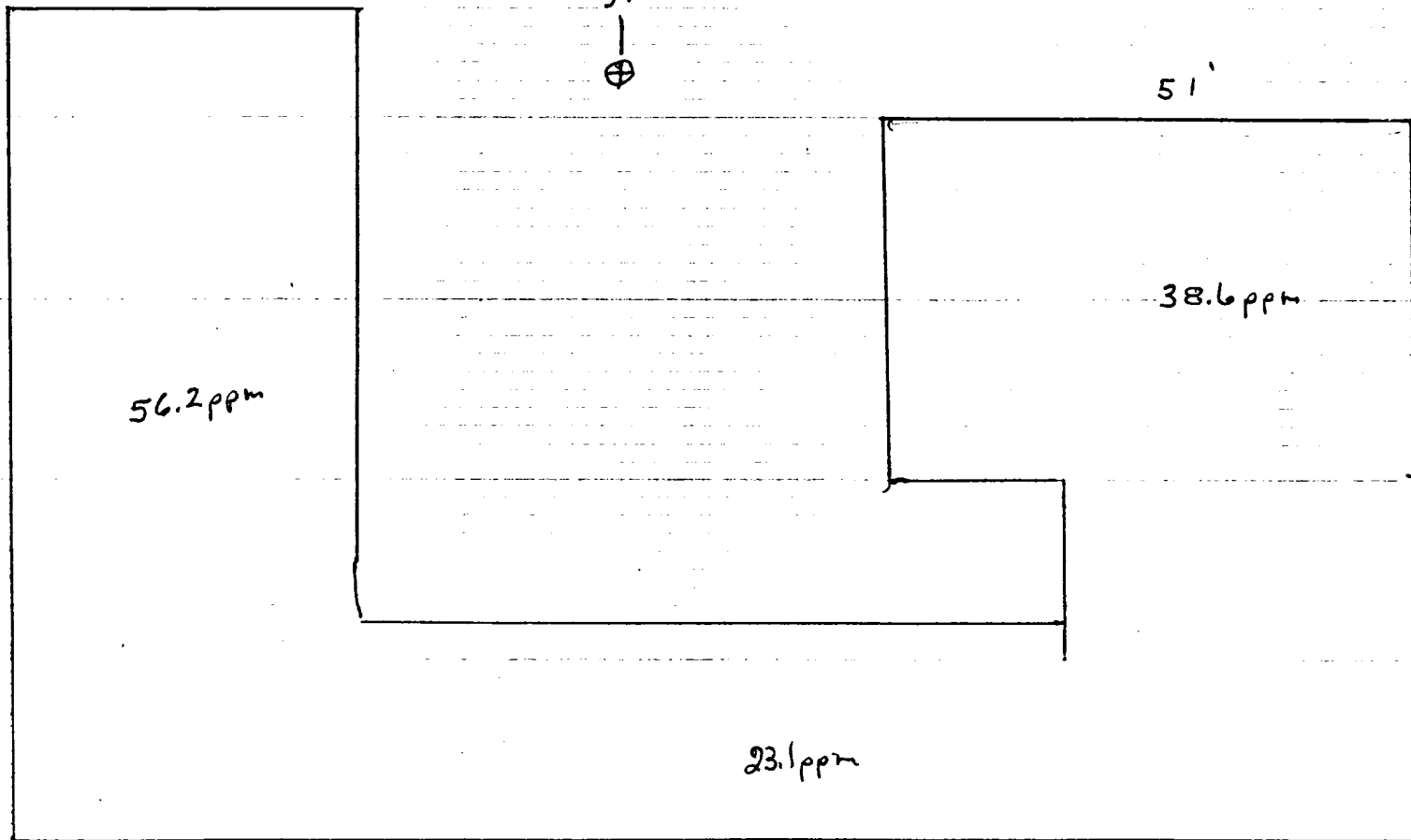

OFF: (505) 325-5667



LAB: (505) 325-1556

On Site Technologies, LTD.

Date: 30-Jul-99

CLIENT: PNM - Public Service Company of NM
Project: Talaferro 3, 4 & 7 and Grenier 19 LF
Lab Order: 9907037

CASE NARRATIVE

Samples were analyzed using the methods outlined in the following references:

Test Methods for Evaluating Solid Waste, Physical/Chemical Methods, SW846, 3rd Edition

All method blanks, laboratory spikes, and/or matrix spikes met quality assurance objectives.

OFF: (505) 325-5667



LAB: (505) 325-1556

ANALYTICAL REPORT

Date: 30-Jul-99

Client:	PNM - Public Service Company of NM	Client Sample Info:	Taliaferro #4 LF
Work Order:	9907037	Client Sample ID:	9907140922; 6pt Comp
Lab ID:	9907037-03A	Matrix:	SOIL
Project:	Taliaferro 3, 4 & 7 and Grenier 19 LF	Collection Date:	7/14/99 9:22:00 AM
		COC Record:	7737

Parameter	Result	PQL	Qual	Units	DF	Date Analyzed
DIESEL RANGE ORGANICS		SW8015B				Analyst: DC
T/R Hydrocarbons: C10-C28	34	25		mg/Kg	1	7/29/99

Qualifiers:	PQL - Practical Quantitation Limit	S - Spike Recovery outside accepted recovery limits
	ND - Not Detected at Practical Quantitation Limit	R - RPD outside accepted recovery limits
	J - Analyte detected below Practical Quantitation Limit	E - Value above quantitation range
	B - Analyte detected in the associated Method Blank	Surr - Surrogate

1 of 1

P.O. BOX 2606 • FARMINGTON, NM 87499

Technology Blending Industry with the Environment