

F C  
I O  
L P  
E Y

Form O-101

## NEW MEXICO OIL CONSERVATION COMMISSION

F C  
I O  
L P  
E Y

## NOTICE OF INTENTION TO DRILL

See Rules 101 and 1104.

If changes in the proposed plan are considered advisable, a copy of this notice showing such changes will be returned to the sender. Submit this notice in triplicate. One copy will be returned following approval.

Dallas, Texas

Place

August 29, 1952

Date

Notice hereby is given that it is our intention to commence the drilling of a well to be known as

Southern Union Gas Company Wilmoth Pooled Unit well No. 1 in NW $\frac{1}{4}$ SW $\frac{1}{4}$   
Company or Operator Lease  
of Sec. 26, T. 31N, R. 11W, N. M., P. M., Blanco Pool, San Juan County.

N

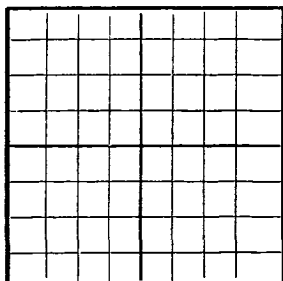

AREA 640 ACRES

LOCATE WELL CORRECTLY

The well is 1650 feet from ~~XX~~ (S.) line and 1190 feet from  
(~~XX~~ (W.) line of the above section.

(Give location from section lines. Cross out wrong directions.)

If state land the oil and gas lease is No. Assignment No.

If patented land the owner is Neal Wilmoth and Elinor Periman

Address

If government land the permittee is

Address

The lessee is

Address

We propose to drill well with drilling equipment as follows: Rotary tools to top

of Cliff House, approx. 3985', and completed with natural gas method to a total depth  
of app. 4900'.

The status of a bond for this well in conformance with Rule 101 of the General Rules and Regulations of the Commission is as follows: Company maintains blanket bond

We propose to use the following strings of casing and to land or cement them as indicated:

Size of Hole	Size of Casing	Weight Per Foot	New or Second Hand	Depth	Landed or Cemented	Sacks Cement
	9-5/8"			200'	Cemented	75 sacks
	5-1/2"			3935'	Cemented	200 sacks
	2" tubing			4900'		

If changes in the above plans become advisable we will notify you before cementing or landing casing. We estimate that the first productive oil or gas sand should occur at a depth of about 3985' feet.

Additional information: Well will be shot with approx. 1800 qts. of Nitro Glycering from 3985' to T.D. Pooled Unit: S $\frac{1}{2}$  Sec. 26: A.D. Hill E $\frac{1}{2}$  SE $\frac{1}{4}$ SW $\frac{1}{4}$ , NE $\frac{1}{4}$ SW $\frac{1}{4}$ --Mae Rose, NW $\frac{1}{4}$ SE $\frac{1}{4}$ --L. Kohl, W $\frac{1}{2}$ SW $\frac{1}{4}$ SE $\frac{1}{4}$ --R.M. Stinson, SE $\frac{1}{4}$ SE $\frac{1}{4}$ --R.M. Stinson, E $\frac{1}{2}$ SW $\frac{1}{4}$ SE $\frac{1}{4}$ --Elinor Periman ( $\frac{1}{2}$  int.) N $\frac{1}{2}$ SW $\frac{1}{4}$ SW $\frac{1}{4}$ , NW $\frac{1}{4}$ SW $\frac{1}{4}$  east of Animas River, S $\frac{1}{2}$ SW $\frac{1}{4}$ SW $\frac{1}{4}$ --Neal Wilmoth, other  $\frac{1}{2}$  of E. periman tract--Sarah Knowlton, NE $\frac{1}{4}$ SE $\frac{1}{4}$ --Marion Hill, W $\frac{1}{2}$ SE $\frac{1}{4}$ SW $\frac{1}{4}$ --4 acres in NW $\frac{1}{4}$ SW $\frac{1}{4}$  west of Animas River, owner unknown.

Approved Sept. 4, 1952

except as follows:

SOUTHERN UNION GAS COMPANY  
Company or Operator

By /S/ A.M. Wiederkehr

Position Reservoir Engineer

Send communications regarding well to:

Name

Address

OIL CONSERVATION COMMISSION,

By /S/ Al Greer

Title Oil &amp; Gas Inspector Dist. #3

SOUTHERN UNION GAS COMPANY  
BURT BUILDING  
Dallas 1, Texas

August 29, 1952

Re: Pooled Unit; S $\frac{1}{2}$ Sec. 26; A.D. Hill E $\frac{1}{2}$  SE $\frac{1}{4}$  SW $\frac{1}{4}$ ;  
NE $\frac{1}{4}$  SW $\frac{1}{4}$ --Mas Rose, NW $\frac{1}{4}$  SE $\frac{1}{4}$ --L. Kohl, W $\frac{1}{2}$  SW $\frac{1}{4}$  SE $\frac{1}{4}$ --  
R. M. Stineon, SE $\frac{1}{4}$  SW $\frac{1}{4}$ --R.M. Stineon, E $\frac{1}{2}$  SW $\frac{1}{4}$  SE $\frac{1}{4}$ --  
Elinor Periman ( $\frac{1}{2}$  int.) N $\frac{1}{2}$  SW $\frac{1}{4}$  SW $\frac{1}{4}$ , NW $\frac{1}{4}$  SW $\frac{1}{4}$  east  
of Animas River, S $\frac{1}{2}$  SW $\frac{1}{4}$  SW $\frac{1}{4}$ --Neal Wilmoth, other  
 $\frac{1}{2}$  of E. Periman tract--Sarah Knownton, NE $\frac{1}{4}$  SE $\frac{1}{4}$ --  
M. Hill, W $\frac{1}{2}$  SE $\frac{1}{4}$  SW $\frac{1}{4}$ -- $\frac{1}{4}$  acres in NW $\frac{1}{4}$  SW $\frac{1}{4}$  west  
of Animas River, owner unknown.

Mr. Al Greer  
New Mexico Oil Conservation Commission  
P.O. Box 697  
Aztec, New Mexico

Dear Mr. Greer:

Attached are three copies each of Notice of Intention to Drill and  
Surveyor's plat covering Southern Union Gas Company's No. 1 Wilmoth  
well located 1650' from the South line and 990' from the west line  
(NW $\frac{1}{4}$  SE $\frac{1}{4}$ ) Section 26, T-31-N, R-11-W, N.M.P.M., Blanco Field,  
San Juan County, New Mexico.

Yours very truly

/S/  
A. M. Wiederkehr  
Reservoir Engineer

AMW/lm  
Attachments-6  
cc: Mr. P.T. McGrath  
U.S. Geological Survey  
Box 965  
Farmington, New Mexico



SOUTHERN UNION GAS COMPANY  
Drilling and Geological  
P.O. Box 815  
Farmington, New Mexico

September 3, 1952

Mr. Al Greer  
New Mexico Oil Conservation Commission  
P.O. Box 697  
Aztec, New Mexico

Dear Sir:

We are enclosing a revised Notice of Intention to Drill  
and 5 copies of a new Surveyor's plat.

It was necessary to move this location 200 feet East  
due to the previous location being west of the main irrigation  
ditch and it would have been impossible to drill this location  
without going to the expense of building a bridge across the  
ditch.

This irrigation ditch is shown on the attached certified  
plats.

Yours very truly,

SOUTHERN UNION GAS COMPANY

/s/ Van Thompson

VT:mw

cc: Mr. P.T. McGrath  
U.S. Geological Survey  
Box 965  
Farmington, New Mexico

Mr. J. Edgar Hoover  
Director, Federal Bureau of Investigation  
Washington, D. C.

Dear Sir:

Enclosed for the Bureau are two copies of a letterhead memorandum dated and captioned as above.

Very truly yours,

W. J. Connelley, Special Agent in Charge, New York Office

The New York Office has advised that the above-named individual is a known associate of the late John J. Lee, who was a member of the New York Office staff and was killed in the line of duty on May 1, 1941.

The Bureau is requested to advise the New York Office of any information received from other sources.

Very truly yours,

W. J. Connelley, Special Agent in Charge, New York Office

cc: Mr. J. Edgar Hoover

cc: Mr. J. Edgar Hoover  
Mr. J. P. Connelley, New York  
Box 997  
New York, New York

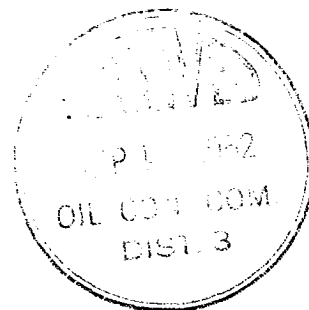

Company Southern Union Gas Company

Lease Wilmuth Well No. 1

Sec. 26 T. 31 N., R. 11 W., N.M.P.M.

Location 1650' from the South line and 1190' from  
the West line.

San Juan County

New Mexico

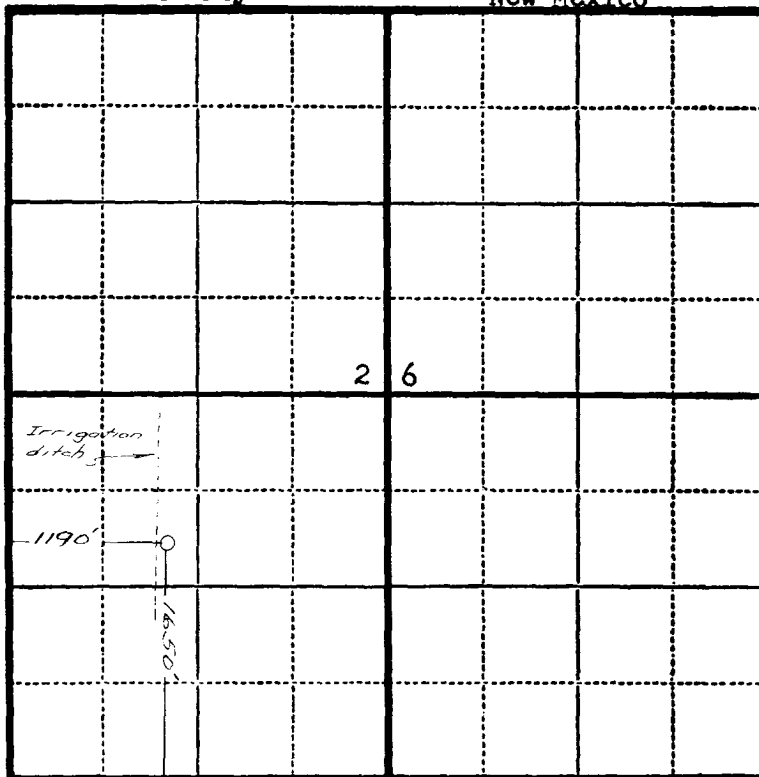

Scale—4 inches equals 1 mile.

This is to certify that the above plat was prepared from field notes of actual surveys made by me or under my supervision and that the same are true and correct to the best of my knowledge and belief.

*Charles J. Finklea*

Seal:

Registered Professional  
Engineer and Land Surveyor.

Charles J. Finklea  
N. Mex. Reg. No. 1302

Surveyed September 3, 19 52



Company Southern Union Gas Company  
Lease Wilmoth Well No. 1  
Sec. 26 T. 31 N., R. 11 W., N.M.P.M.  
Location 1650' from the South line and 1190' from  
the West line.

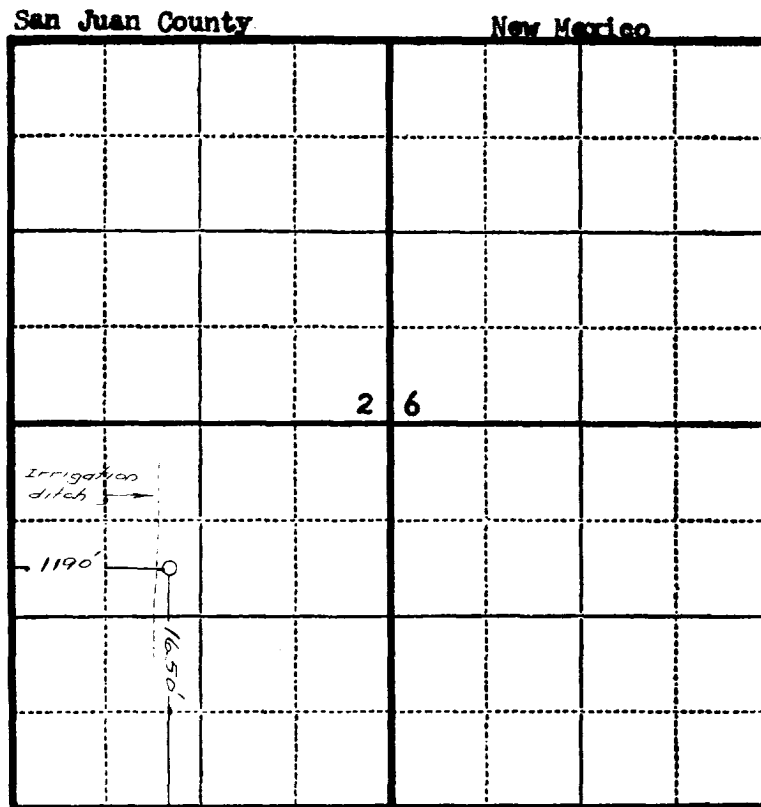

Scale—4 inches equals 1 mile.

This is to certify that the above plat was prepared from field notes of actual surveys made by me or under my supervision and that the same are true and correct to the best of my knowledge and belief.

Seal:

  
Registered Professional  
Engineer and Land Surveyor.

Charles J. Finklea  
N. Mex. Reg. No. 1302

Surveyed September 3, 19 52

## OIL CONSERVATION COMMISSION

## AZTEC DISTRICT OFFICE

No. Copies Received 4

## DISTRIBUTION

	NO. FURNISHED	
Inspector	<u>1</u>	
San Antonio	<u>1</u>	
Operation Office		
State Land Office		
U. S. G. S. <u>P. ...</u>	<u>1</u>	
Transporter		
File	<u>1</u>	