

## NEW MEXICO OIL CONSERVATION COMMISSION

Santa Fe, New Mexico

## NOTICE OF INTENTION TO DRILL

Notice must be given to the Oil Conservation Commission or its proper agent and approval obtained before drilling begins. If changes in the proposed plan are considered advisable, a copy of this notice showing such changes will be returned to the sender. Submit this notice in triplicate. One copy will be returned following approval. See additional instructions in Rules and Regulations of the Commission.

Dallas, Texas

April 24, 1951

Place

Date

OIL CONSERVATION COMMISSION,  
Santa Fe, New Mexico,

Gentlemen:

You are hereby notified that it is our intention to commence the drilling of a well to be known as \_\_\_\_\_

Southern Union Gas Company's

J. A. Pierce

well No. 2

in NE 1/4 SW 1/4

Company or Operator

Lease

of Sec. 30, T. 31-N, R. 10-W, N. M., P. M., Wildcat Field, San Juan County.

The well is 1650 feet (N.) (S) of the South line and 1650 feet (E.) (W.) of the West line of Section 30

(Give location from section or other legal subdivision lines. Cross out wrong directions.)

If state land the oil and gas lease is No. \_\_\_\_\_ Assignment No. \_\_\_\_\_

If patented land the owner is J. A. Pierce - Communitized - Section 30.

Address Astec, New Mexico Federal Santa Fe 078134 -

If government land the permittee is \_\_\_\_\_ NE 1/4, SW 1/4, NW 1/4, SE 1/4

Address

The lessee is Southern Union Gas Company

Address 1104 Bart Building - Dallas, Texas

We propose to drill well with drilling equipment as follows: Rotary to top of

LOCATE WELL CORRECTLY  
Point Lockout Sand

and drilled in with cable tools

The status of a bond for this well in conformance with Rule 89 of the General Rules and Regulations of the Commission is as follows: Operator maintains blanket bond

We propose to use the following strings of casing and to land or cement them as indicated:

Size of Hole	Size of Casing	Weight Per Foot	New or Second Hand	Depth	Landed or Cemented	Seals Cement
13"	8-5/8"	32#		150' approx. cemented		75 sz.
8"	5-1/2"	15.5#		4700'	"	200 sz./
	2" tubing			4750'		

If changes in the above plan become advisable we will notify you before cementing or landing casing. We estimate that the first productive oil or gas sand should occur at a depth of about 4700 feet.

Additional information:

Approved May 2, 1951  
except as follows:

OIL CONSERVATION COMMISSION,

By

Al Kuer

Title

Oil and Gas Inspector Dist. #3

Sincerely yours,

SOUTHERN UNION GAS COMPANY

Company or Operator

By

S. H. Newman

Position

Engineer

Send communications regarding well to:

Name SOUTHERN UNION GAS COMPANY

Address

1104 Bart Building - Dallas, Texas

Company **Southern Union Gas Company**

Lease **J. A. Pierce**

Well No. **2**

Sec. **30** T. **31** N., R. **10** W., N.M.P.M.

Location **1650' from the South line and 1650' from the West line.**

San Juan County

New Mexico

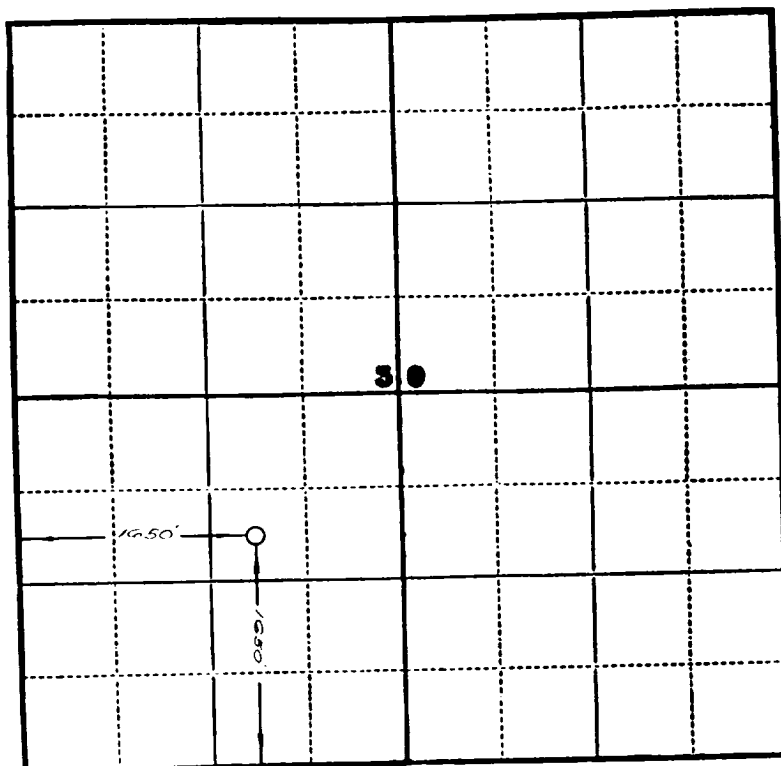

Scale—4 inches equals 1 mile.

This is to certify that the above plat was prepared from field notes of actual surveys made by me or under my supervision and that the same are true and correct to the best of my knowledge and belief.

Seal:

Farmington, New Mexico

Surveyed **April, 14**, 19**51**

Registered Professional  
Engineer and Land Surveyor.

**Charles J. Finklee**  
N. Mex. Reg. No. 1502