

(SUBMIT IN TRIPLICATE)

Indian Agency _____

UNITED STATES
DEPARTMENT OF THE INTERIOR
GEOLOGICAL SURVEY

Window Rock
Allottee Navajo Tribal
Lease No. 11-20-603-734

| | | | |
|--|--|--|--|
| | | | |
| | | | |
| | | | |
| | | | |

SUNDRY NOTICES AND REPORTS ON WELLS

| | | | |
|---|-------------------------------------|--|--|
| NOTICE OF INTENTION TO DRILL | <input checked="" type="checkbox"/> | SUBSEQUENT REPORT OF WATER SHUT-OFF | |
| NOTICE OF INTENTION TO CHANGE PLANS | | SUBSEQUENT REPORT OF SHOOTING OR ACIDIZING | |
| NOTICE OF INTENTION TO TEST WATER SHUT-OFF | | SUBSEQUENT REPORT OF ALTERING CASING | |
| NOTICE OF INTENTION TO REDRILL OR REPAIR WELL | | SUBSEQUENT REPORT OF REDRILLING OR REPAIR | |
| NOTICE OF INTENTION TO SHOOT OR ACIDIZE | | SUBSEQUENT REPORT OF ABANDONMENT | |
| NOTICE OF INTENTION TO PULL OR ALTER CASING | | SUPPLEMENTARY WELL HISTORY | |
| NOTICE OF INTENTION TO ABANDON WELL | | | |

(INDICATE ABOVE BY CHECK MARK NATURE OF REPORT, NOTICE, OR OTHER DATA)

October 14, 1958

Well No. 8 is located 660 ft. from N line and 703 ft. from W line of sec. 30

14 N Sec. 30 31 N 16 E T. 1 N. R. 1 E
(14 Sec. and Sec. No.) (Twp.) (Range) (Meridian)

Gallup San Juan New Mexico
(Field) (County or Subdivision) (State or Territory)

The elevation of the ground ~~formation~~ above sea level is 5652 ft.

DETAILS OF WORK

(State names of and expected depths to objective sands; show sizes, weights, and lengths of proposed casings; indicate mudlogging jobs, cementing points, and all other important proposed work)

We propose to drill a well at the above location to an approximate total depth of 1500' with rotary tools for completion in the Gallup formation. 100' of 8-5/8" O.D. casing will be set and cemented to surface. If the well is productive 5-1/2" O.D. oil string will be used.

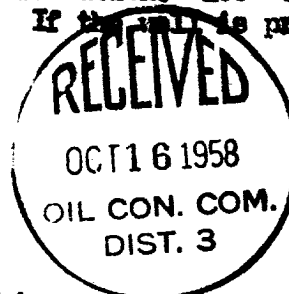

I understand that this plan of work must receive approval in writing by the Geological Survey before operations may be commenced.

Company The Atlantic Refining Company

Address P. O. Box 520

Casper, Wyoming

By A. D. Klapinske
Title Drilling Superintendent

三

We propose to drill a well at the above location to an approximate total depth of 1500'; this would allow for completion in the Gulf formation. The 3-2 1/2" 0.11 casing will be run and cemented to surface. If the well is productive 4 1/2" casing will be used.

has not been killed

NEW MEXICO OIL CONSERVATION COMMISSION

Well Location and Acreage Dedication Plat

Section A.

Date 10-14-58

Operator THE ATLANTIC REFINING COMPANY Lease NAVAJO
 Well No. 8 Unit Letter D Section 30 Township 31 NORTH Range 16 WEST, NMPM
 Located 660 Feet From the NORTH Line, 703 Feet From the WEST Line
 County SAN JUAN G. L. Elevation 5652.0 Dedicated Acreage 82.56 Acres
 Name of Producing Formation Gallup Pool Horseshoe-Gallup

1. Is the Operator the only owner in the dedicated acreage outlined on the plat below?
 Yes X No _____
2. If the answer to question one is "no", have the interests of all the owners been consolidated by communitization agreement or otherwise? Yes _____ No _____. If answer is "yes", Type of Consolidation.

3. If the answer to question two is "no", list all the owners and their respective interests below:

Owner

Land Deed

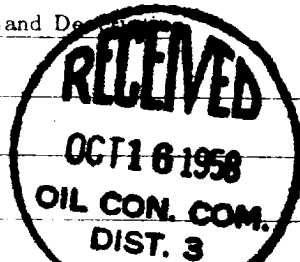

Section B.

Note: All distances must be from outer boundaries of section.

This is to certify that the information in Section A above is true and complete to the best of my knowledge and belief.

The Atlantic Refining Company
 (Operator)

Ad Klesin
 (Representative)

P. O. Box 520
 (Address)

Casper, Wyoming

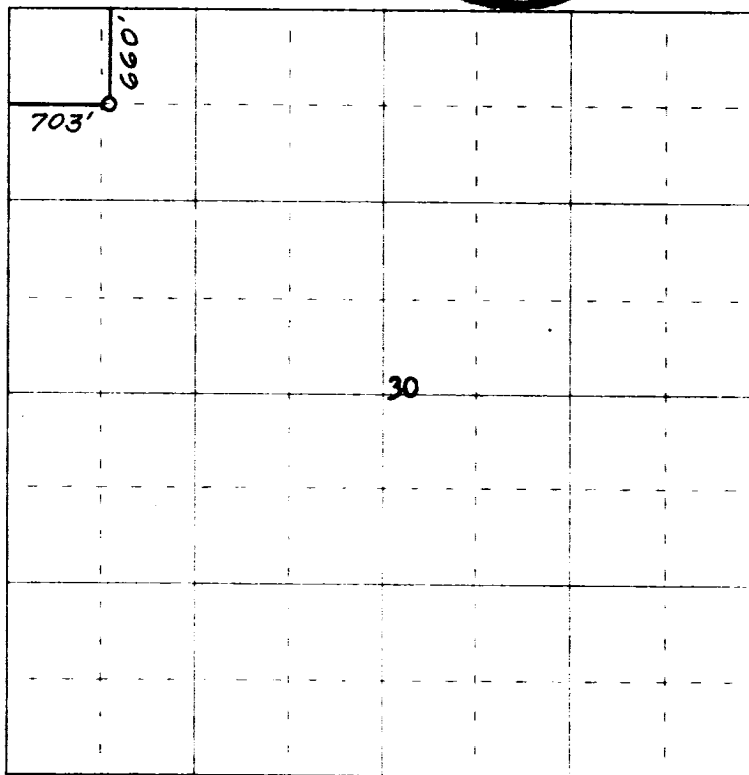

0 330 660 990 1320 1650 1980 2310 2640 2000 1500 1000 500 0

Scale 4 inches equal 1 mile



Farmington, New Mexico

This is to certify that the above plat was prepared from field notes of actual surveys made by me or under my supervision and that the same are true and correct to the best of my knowledge and belief.

Date Surveyed 9 October 1958

James P. Leese
 Registered Professional Engineer and/or Land Surveyor
 JAMES P. LEESE N. MEX. REG. No. 1463