

(SUBMIT IN TRIPLICATE)

UNITED STATES
DEPARTMENT OF THE INTERIOR
GEOLOGICAL SURVEY

Indian Agency Navajo-Lee Tribal
Contract

Allottee

Lease No. **14-20-604-1951**

	X		

SUNDRY NOTICES AND REPORTS ON WELLS

NOTICE OF INTENTION TO DRILL	<input checked="" type="checkbox"/>	SUBSEQUENT REPORT OF WATER SHUT-OFF
NOTICE OF INTENTION TO CHANGE PLANS		SUBSEQUENT REPORT OF SHOOTING OR ACIDIZING
NOTICE OF INTENTION TO TEST WATER SHUT-OFF		SUBSEQUENT REPORT OF ALTERING CASING
NOTICE OF INTENTION TO REDRILL OR REPAIR WELL		SUBSEQUENT REPORT OF REDRILLING OR REPAIR
NOTICE OF INTENTION TO SHOOT OR ACIDIZE		SUBSEQUENT REPORT OF ABANDONMENT
NOTICE OF INTENTION TO PULL OR ALTER CASING		SUPPLEMENTARY WELL HISTORY
NOTICE OF INTENTION TO ABANDON WELL		

(INDICATE ABOVE BY CHECK MARK NATURE OF REPORT, NOTICE, OR OTHER DATA)

ORAL APPROVAL RECEIVED 10-7-59.

October 7, 1959

Harvesting the

Well No. 24 is located 640 ft. from SE line and 1980 ft. from W line of sec. 27

SE SW/4 Section 27
(14 Sec. and Sec. No.)

31N
(Twp.)

16W
(Range)

NMIPM
(Meridian)

Horned Lark Ext.
(Field)

San Juan
(County or Subdivision)

New Mexico
(State or Territory)

The elevation of the derrick floor above sea level is 5501 ft.

DETAILS OF WORK

(State names of and expected depths to objective sands; show sizes, weights, and lengths of proposed casings; indicate mudding jobs, cementing points, and all other important proposed work)

It is intended to drill a well through the Lower-Gallup Formation using rotary tools and mud circulation. Possible productive intervals will be perforated and sandoil fractured. Estimated Total Depth 1570'.

Casting Programs:

8-5/8" at 100' with 150 sacks cement circulated to surface.

5-1/2" at 1570' with 200 sacks cement.

The SE SW/4 of Section 27 is dedicated to this well.

SE SW/4 Section 27 Navajo-Ute Tribal 14-20-604-1951

I understand that this plan of work must receive approval in writing by the Geological Survey before operations may be commenced.

Company **El Paso Natural Gas Products Company**

Address **Post Office Box 1565**

Farmington, New Mexico

ORIGINAL SIGNED BY: WILLIAM K. GLAZENER

Title **Petroleum Engineer**

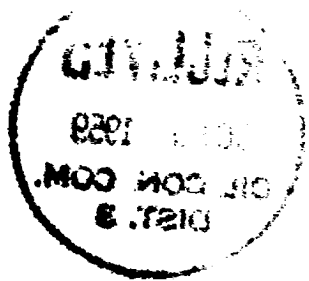

THE ALL-AMERICAN ...

NEW MEXICO OIL CONSERVATION COMMISSION

Well Location and Acreage Dedication Plat

Section A.

Date October 7, 1959
Navajo-Dee Tribal Contract
14-28-604-1951

Operator El Paso Natural Gas Products Company Lease Horseshoe Dee
Well No. 21 Unit Letter N Section 27 Township 31 North Range 16 West NMPM
Located 660 Feet From South Line, 1980 Feet From West 40 Line
County San Juan G. L. Elevation 5494 Dedicated Acreage 32.16 Acres
Name of Producing Formation Lower Gallup Pool Horseshoe Valley Nat.

1. Is the Operator the only owner* in the dedicated acreage outlined on the plat below?
Yes X No _____
2. If the answer to question one is "no," have the interests of all the owners been consolidated by communitization agreement or otherwise? Yes _____ No _____. If answer is "yes,"
Type of Consolidation _____
3. If the answer to question two is "no," list all the owners and their respective interests below:

Owner

Land Description

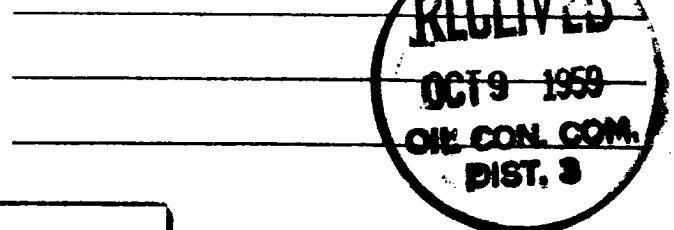

Section. B

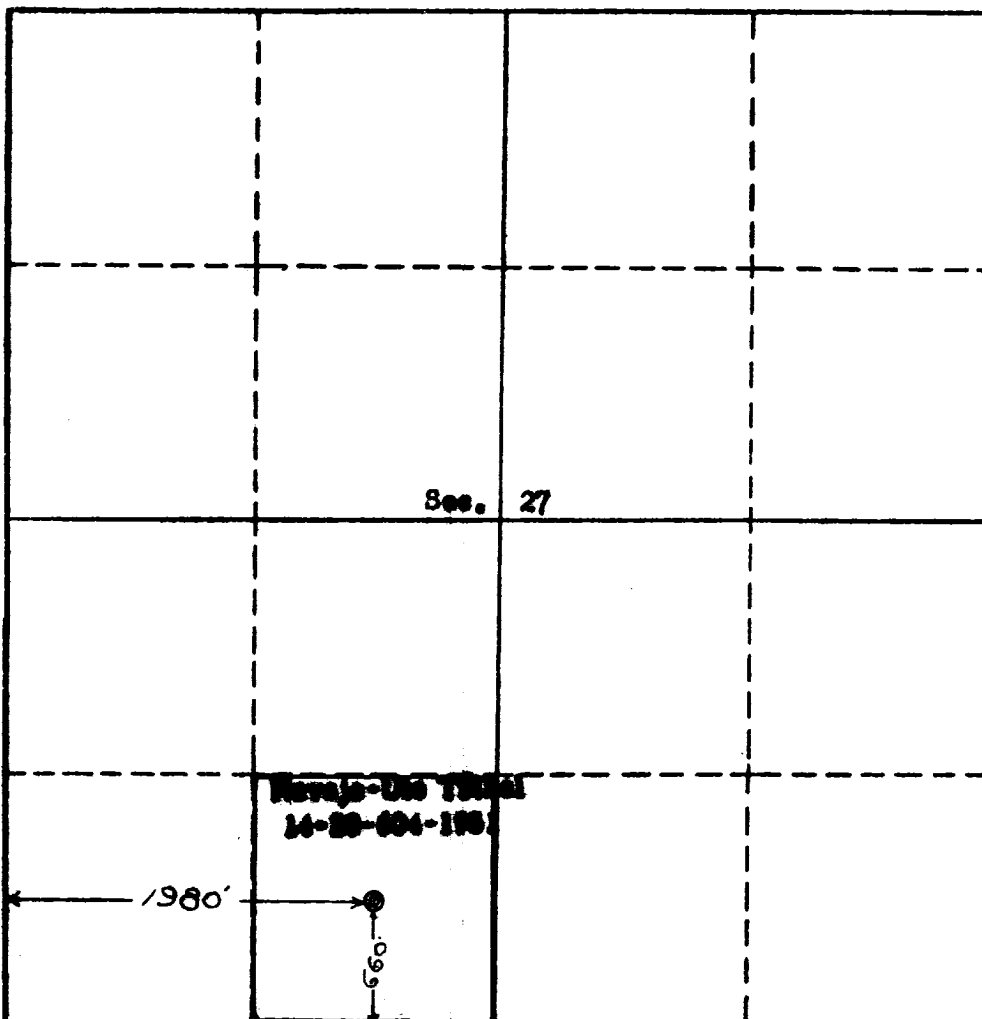

This is to certify that the information in Section A above is true and complete to the best of my knowledge and belief.

El Paso Natural Gas Products Co.

(Operator)

William K. Haynes

(Representative)

Box 1546, Farmington, New Mexico

Address

This is to certify that the well location on the plat in Section A is located from field notes of actual surveys made by me or under my supervision and that the same is true to the best of my knowledge and belief.

Date Surveyed Oct. 5, 1959

Ernest V. Echoshawk

Ernest V. Echoshawk
Registered Land Surveyor.

Certificate No. 1545