

RECEIVED

AUG 4 1952

U. S. GEOLOGICAL SURVEY  
FANNINGTON, N. M.

Company Three States Natural Gas Company

Lease Navajo Well No. 1

Sec. 27 T. 31 N. R. 17 W., N.M.P.M.

Location 1650' from the South line and 990' from the East line.

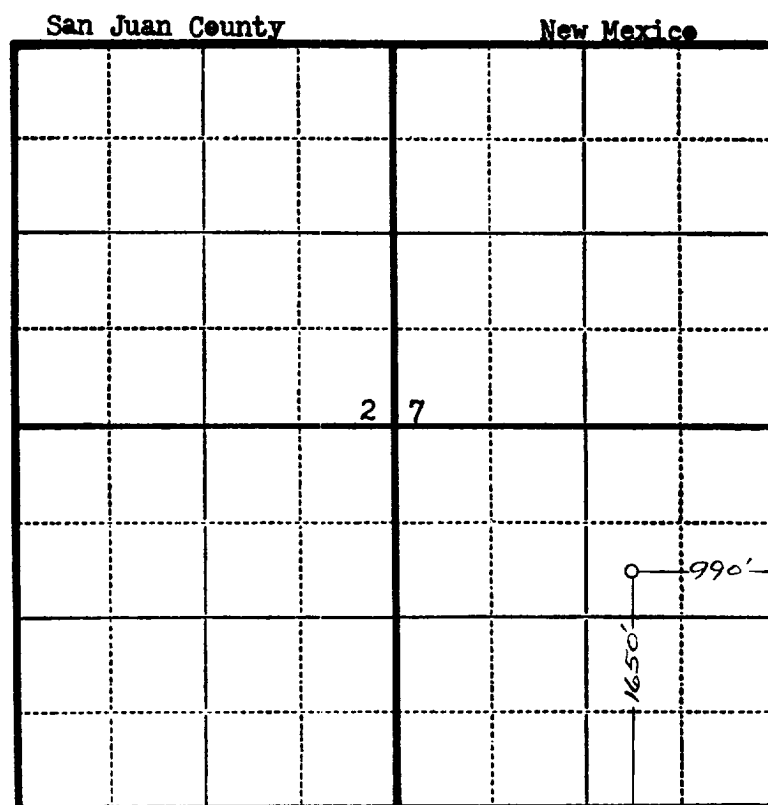

Scale—4 inches equals 1 mile.

This is to certify that the above plat was prepared from field notes of actual surveys made by me or under my supervision and that the same are true and correct to the best of my knowledge and belief.

*Charles J. Finklea*

Seal:

Registered Professional  
Engineer and Land Surveyor.

Charles J. Finklea  
N. Mex. Reg. No. 1302

Surveyed July 31, 19 52

**OIL CONSERVATION COMMISSION**

**AZTEC DISTRICT OFFICE**

No. Copies Received /

**DISTRIBUTION**

	NO. FURNISHED	
Operator		
Santa Fe		
Proration Office		
State Land Office		
U. S. G. S.		
Transporter		
File		✓