

(SUBMIT IN TRIPLICATE)

Indian Agency

UNITED STATES
DEPARTMENT OF THE INTERIOR
GEOLOGICAL SURVEY

Ute Mountain Tribe

Allottee

Lease No. 14-20-604-88

SUNDRY NOTICES AND REPORTS ON WELLS

NOTICE OF INTENTION TO DRILL	<input checked="" type="checkbox"/>	SUBSEQUENT REPORT OF WATER SHUT-OFF	RECEIVED NOV 10 1960 U. S. GEOLOGICAL SURVEY DURANGO, COLO.
NOTICE OF INTENTION TO CHANGE PLANS	<input type="checkbox"/>	SUBSEQUENT REPORT OF SHOOTING OR ACIDIZING	
NOTICE OF INTENTION TO TEST WATER SHUT-OFF	<input type="checkbox"/>	SUBSEQUENT REPORT OF ALTERING CASING	
NOTICE OF INTENTION TO REDRILL OR REPAIR WELL	<input type="checkbox"/>	SUBSEQUENT REPORT OF REDRILLING OR REPAIR	
NOTICE OF INTENTION TO SHOOT OR ACIDIZE	<input type="checkbox"/>	SUBSEQUENT REPORT OF ABANDONMENT	
NOTICE OF INTENTION TO PULL OR ALTER CASING	<input type="checkbox"/>	SUPPLEMENTARY WELL HISTORY	
NOTICE OF INTENTION TO ABANDON WELL	<input type="checkbox"/>		

(INDICATE ABOVE BY CHECK MARK NATURE OF REPORT, NOTICE, OR OTHER DATA)

November 9, 1960

Century Exploration

Well No. 2 Ute C is located 2310 ft. from $\left[\begin{smallmatrix} N \\ S \end{smallmatrix} \right]$ line and 330 ft. from $\left[\begin{smallmatrix} E \\ W \end{smallmatrix} \right]$ line of sec. 27SE NE 1/4 Sec. 27
(1/4 Sec. and Sec. No.)31N
(Twp.)15W
(Range)NMPM
(Meridian)Verde Gallup
(Field)San Juan
(County or Subdivision)New Mexico
(State or Territory)

The elevation of the derrick floor above sea level is 5545 ft. (5535' GL)

DETAILS OF WORK

(State names of and expected depths to objective sands; show sizes, weights, and lengths of proposed casings; indicate mudding jobs, cementing points, and all other important proposed work)

Using rotary tools, drill 12 $\frac{1}{4}$ " surface hole to approximately 200', set 200' of 8-3/4", 24#, J-55 casing, circulate with cement, WOC 18 hours and test for water shut off; drill 7-7/8" hole to approximately 3200', run 5 $\frac{1}{2}$ ", 15.50# J-55 casing to approximately 3200' or top of Gallup formation, cement, WOC 24 hours. Move cable tools on well and drill 4" hole through Gallup formation and test.

I understand that this plan of work must receive approval in writing by the Geological Survey before operations may be commenced.

Company Century Exploration Company

Address P. O. Box 168

Farmington, N. M.

By D. M. Rucker

Title Office Manager

NEW MEXICO OIL CONSERVATION COMMISSION

FORM C-128
Revised 5/1/57

WELL LOCATION AND ACREAGE DEDICATION PLAT

SEE INSTRUCTIONS FOR COMPLETING THIS FORM ON THE REVERSE SIDE

SECTION A

Operator CENTURY EXPLORATION COMPANY		Lease CENTURY EXPLORATION COMPANY		Well No. 2 H "C"	
Unit Letter H	Section 27	Township 31N	Range 15W	County San Juan, Mexico	
Actual Footage Location of Well: 2310 feet from the North line and 330 feet from the East line					
Ground Level Elev. 5535.0	Producing Formation VALLEY		Pool VALLEY		Dedicated Acreage: 40 Acres

1. Is the Operator the only owner in the dedicated acreage outlined on the plat below? YES ☒ NO ☐ ("Owner" means the person who has the right to drill into and to produce from any pool and to appropriate the production either for himself or for himself and another. (65-3-29 (e) NMSA 1935 Comp.) (~~Paragrap~~ from an American petroleum)
2. If the answer to question one is "no," have the interests of all the owners been consolidated by communitization agreement or otherwise? YES ☐ NO ☐ If answer is "yes," Type of Consolidation **RECEIVED**
3. If the answer to question two is "no," list all the owners and their respective interests below:

Owner	Land Description
	NOV 10 1960

U. S. GEOLOGICAL SURVEY
DURANGO, COLO.
CERTIFICATION

SECTION B

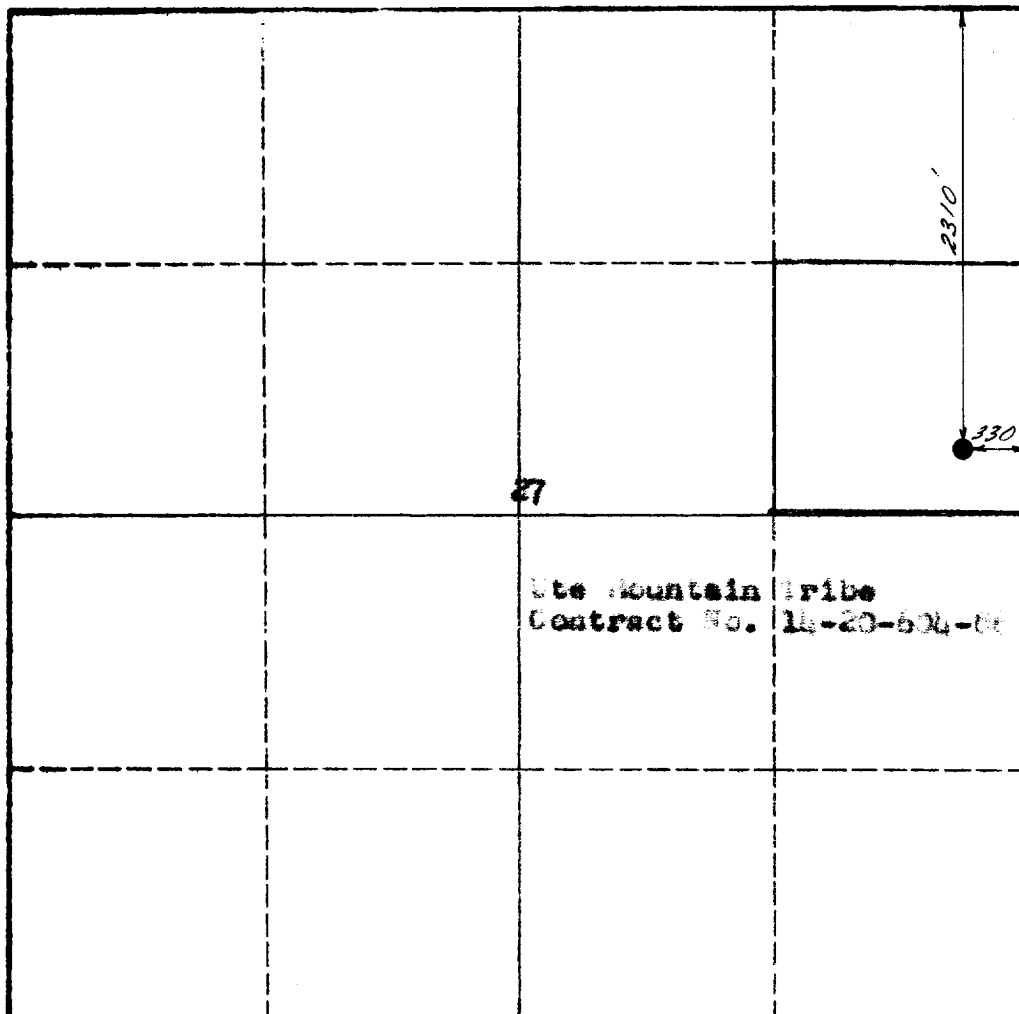

I hereby certify that the information in SECTION A above is true and complete to the best of my knowledge and belief.

Name
I. M. Tucker

Position
Office Manager

Company
CENTURY EXPLORATION

Date
November 7, 1960

I hereby certify that the well location shown on the plat in SECTION B was plotted from field notes of actual surveys made by me or under my supervision, and that the same is true and correct to the best of my knowledge and belief.

Date Surveyed
Nov. 7, 1960

Registered Professional Engineer and/or Land Surveyor
R. J. Aronson

Certificate No.
#11457

0 330 660 990 1320 1650 1980 2310 2640 2000 1500 1000 500 0

INSTRUCTIONS FOR COMPLETION OF FORM C-128

1. Operator shall furnish and certify to the information called for in Section A.
2. Operator shall outline the dedicated acreage for *both* oil and gas wells on the plat in Section B.
3. A registered professional engineer or land surveyor registered in the State of New Mexico or approved by the Commission shall show on the plat the location of the well and certify this information in the space provided.
4. All distances shown on the plat must be from the outer boundaries of the Section.
5. If additional space is needed for listing owners and their respective interests as required in question 3 of Section A, please use space below.