

(SUBMIT IN TRIPLICATE)

Indian Agency \_\_\_\_\_

UNITED STATES

Window Rock

DEPARTMENT OF THE INTERIOR  
GEOLOGICAL SURVEY

Allottee Navajo Tribal

Lease No. 14-20-603-734

OCT 10 1958

SUNDRY NOTICES AND REPORTS ON WELLS

NOTICE OF INTENTION TO DRILL	<input checked="" type="checkbox"/>	SUBSEQUENT REPORT OF WATER SHUT-OFF	
NOTICE OF INTENTION TO CHANGE PLANS		SUBSEQUENT REPORT OF SHOOTING OR ACIDIZING	
NOTICE OF INTENTION TO TEST WATER SHUT-OFF		SUBSEQUENT REPORT OF ALTERING CASING	
NOTICE OF INTENTION TO REDRILL OR REPAIR WELL		SUBSEQUENT REPORT OF REDRILLING OR REPAIR	
NOTICE OF INTENTION TO SHOOT OR ACIDIZE		SUBSEQUENT REPORT OF ABANDONMENT	
NOTICE OF INTENTION TO PULL OR ALTER CASING		SUPPLEMENTARY WELL HISTORY	
NOTICE OF INTENTION TO ABANDON WELL			

RECEIVED

OCT 10 1958

U. S. GEOLOGICAL SURVEY  
FARMINGTON NEW MEXICO

(INDICATE ABOVE BY CHECK MARK NATURE OF REPORT, NOTICE, OR OTHER DATA)

October 8, 1958

Navajo  
Well No. 6 is located 1980 ft. from [S] line and 1980 ft. from [E] line of sec. 30

NW SE Sec. 30 T31N R16E NMPM  
(4 Sec. and Sec. No.) (Twp.) (Range) (Meridian)

Horseshoe Gallup San Juan New Mexico  
(Field) (County or Subdivision) (State or Territory)

The elevation of the ground floor above sea level is 5501.5 ft.

DETAILS OF WORK

(State names of and expected depths to objective sands; show sizes, weights, and lengths of proposed casings; indicate mudding jobs, cementing points, and all other important proposed work)

We propose to drill a well at the above location with rotary tool to an approximate total depth of 1100'. 100' of 8 5/8" O. D. Casing will be set and cemented to surface. Completion is contemplated in the Gallup formation. A 5 1/2" O. D. oil string will be used.

OPERATIONS BY:

- ☒ RECORD LESSEE
- ☐ O. OF O. ON FILE
- ☐ O. OF O. ATTACHED
- BOND ATTACHED
- ☐ O. OF O. ATTACHED
- ☐ O. OF O. ATTACHED
- ☐ O. OF O. ATTACHED
- ☐ O. OF O. ATTACHED
- ☐ O. OF O. ATTACHED

RECEIVED  
OCT 14 1958  
OIL CON. COM.  
DIST. 3

I understand that this plan of work must receive approval in writing by the Geological Survey before operations may be commenced.

Company The Atlantic Refining Company

Address P. O. Box 520

Casper, Wyoming

By *Ad Klopfer*

Title Drilling Superintendent

100-100000  
100-100000

APPROVED

100-100000

ACTING DISTRICT ENGINEER  
BILLY J. SHUGER

100-100000  
OIL COM. INC.  
100-100000

100-100000  
100-100000  
100-100000

100-100000  
OIL COM. INC.  
100-100000

100-100000

100-100000

NEW MEXICO OIL CONSERVATION COMMISSION  
WELL LOCATION AND ACREAGE DEDICATION PLAT

FORM C-128  
Revised 5/1/57

SEE INSTRUCTIONS FOR COMPLETING THIS FORM ON THE REVERSE SIDE

SECTION A

Operator THE ATLANTIC OIL AND REFINING COMPANY			Lease NAVAJO		Well No. <del>XXX</del> 6
Unit Letter J	Section 30	Township 31 NORTH	Range 16 WEST	County SAN JUAN	
Actual Footage Location of Well: 1980 feet from the SOUTH line and 1980 feet from the EAST line					
Ground Level Elev. 5504.5	Producing Formation Gallup		Pool Horse Shoe Gallup		Dedicated Acreage: 40.0 Acres

1. Is the Operator the only owner in the dedicated acreage outlined on the plat below? YES ☒ NO \_\_\_\_ . ("Owner" means the person who has the right to drill into and to produce from any pool and to appropriate the production either for himself or for himself and another. (65-3-29 (e) NMSA 1935 Comp.)
2. If the answer to question one is "no," have the interests of all the owners been consolidated by communitization agreement or otherwise? YES \_\_\_\_ NO \_\_\_\_ . If answer is "yes," Type of Consolidation \_\_\_\_
3. If the answer to question two is "no," list all the owners and their respective interests below:

Owner	Land Description

RECEIVED

OCT 10 1958

U. S. GEOLOGICAL SURVEY  
WASHINGTON, D. C.  
CERTIFICATE NO. 1463

SECTION B

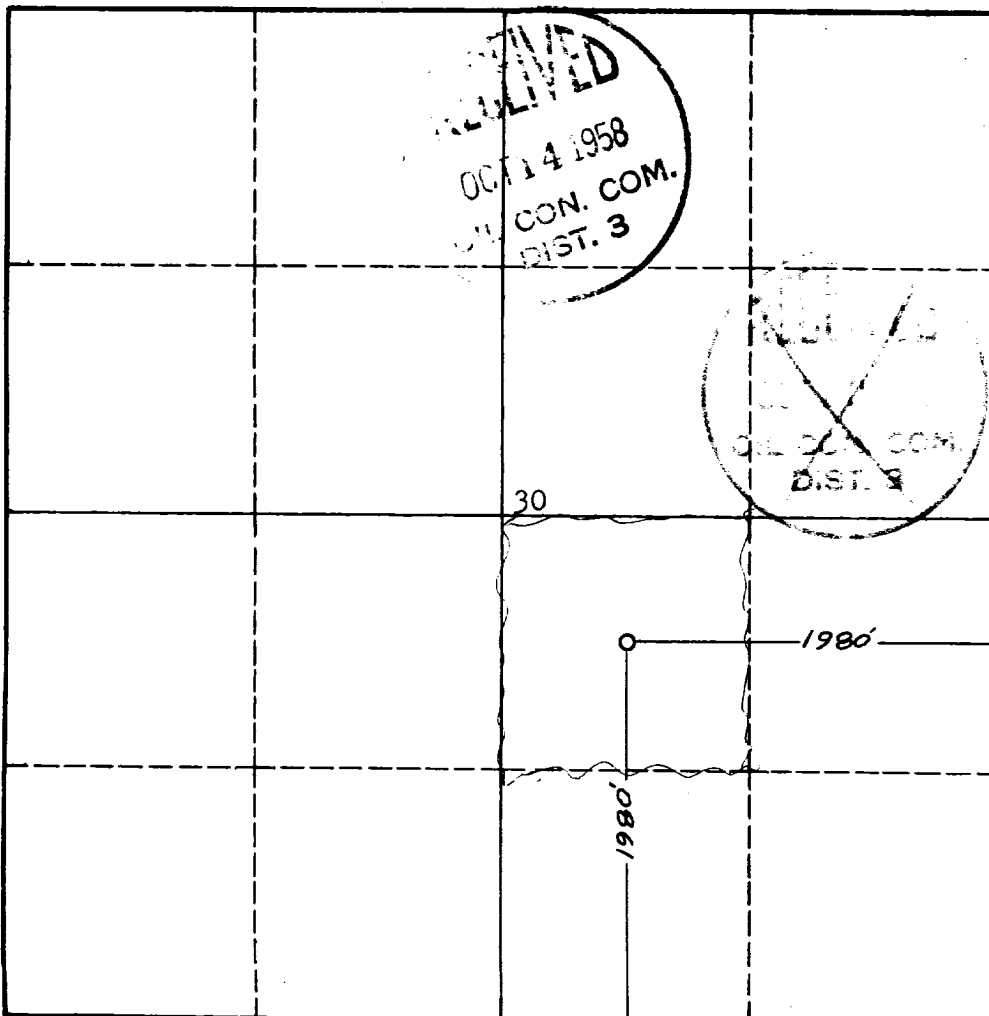

I hereby certify that the information in SECTION A above is true and complete to the best of my knowledge and belief.

*Ad Keapin*  
Name  
Operations Manager  
Position  
The Atlantic Refining Co.  
Company  
Box 520, Casper, Wyoming  
Date  
October 8, 1958

I hereby certify that the well location shown on the plat in SECTION B was plotted from field notes of actual surveys made by me or under my supervision, and that the same is true and correct to the best of my knowledge and belief.

Date Surveyed  
29 September 1958  
Registered Professional Engineer  
and/or Land Surveyor  
*James P. Leese*  
James P. Leese  
Certificate No. 1463

## INSTRUCTIONS FOR COMPLETION OF FORM C-128

1. Operator shall furnish and certify to the information called for in Section A.
2. Operator shall outline the dedicated acreage for *both* oil and gas wells on the plat in Section B.
3. A registered professional engineer or land surveyor registered in the State of New Mexico or approved by the Commission shall show on the plat the location of the well and certify this information in the space provided.
4. All distances shown on the plat must be from the outer boundaries of the Section.
5. If additional space is needed for listing owners and their respective interests as required in question 3 of Section A, please use space below.