

Form G-381b
(April 1962)

(SUBMIT IN TRIPLICATE)

UNITED STATES
DEPARTMENT OF THE INTERIOR
GEOLOGICAL SURVEY

Indian Agency _____

Window Rock _____

Allottee Havajo Tribal

Lease No. 11-20-603-72

SUNDRY NOTICES AND REPORTS ON WELLS

NOTICE OF INTENTION TO DRILL	<input checked="" type="checkbox"/>	SUBSEQUENT REPORT OF WATER SHUT-OFF	
NOTICE OF INTENTION TO CHANGE PLANS		SUBSEQUENT REPORT OF SHOOTING OR ACIDIZING	
NOTICE OF INTENTION TO TEST WATER SHUT-OFF		SUBSEQUENT REPORT OF ALTERING CASING	
NOTICE OF INTENTION TO REDRILL OR REPAIR WELL		SUBSEQUENT REPORT OF REDRILLING OR REPAIR	
NOTICE OF INTENTION TO SHOOT OR ACIDIZE		SUBSEQUENT REPORT OF ABANDONMENT	
NOTICE OF INTENTION TO PULL OR ALTER CASING		SUPPLEMENTARY WELL HISTORY	
NOTICE OF INTENTION TO ABANDON WELL			

(INDICATE ABOVE BY CHECK MARK NATURE OF REPORT, NOTICE, OR OTHER DATA)

RECEIVED
APR 17 1959

GEOLOGICAL SURVEY
NEW MEXICO

April 15, 1959

Well No. Havajo 52 is located 1980 ft. from [S] line and 2060 ft. from [W] line of sec. 30

NE 34 Sec. 30 31 N 16 W N.H.P.M.
(34 Sec. and Sec. No.) (Twp.) (Range) (Meridian)

Horneshee Gallup San Juan New Mexico
(Field) (County or Subdivision) (State or Territory)

The elevation of the ground surface above sea level is 5546 ft.

DETAILS OF WORK

(State names of and expected depths to objective sands; show sizes, weights, and lengths of proposed casings; indicate mudding jobs, cementing points, and all other important proposed work)

We propose to drill a well at the above location to an approximate total depth of 1150'. 100' of 8-5/8" O.D. casing will be set and cemented to surface. Should the well prove productive a 4-1/2" O.D. oil string will be used. Completion is contemplated in the Gallup formation.

RECEIVED
APR 20 1959
OIL CON. COM.
DIST. 3

I understand that this plan of work must receive approval in writing by the Geological Survey before operations may be commenced.

Company The Atlantic Refining Company

Address P. O. Box 520
Casper, Wyoming

By Ad Klopfer

Title Drilling Superintendent

1. The first part of the document is a letter from the President of the United States to the Congress, dated January 3, 1862, in which he reports on the state of the Union and the progress of the war.

2. The second part of the document is a report from the Secretary of the War Department, dated January 10, 1862, in which he details the military operations and the condition of the army.



3. The third part of the document is a report from the Secretary of the Navy, dated January 15, 1862, in which he describes the naval operations and the state of the fleet.

4. The fourth part of the document is a report from the Secretary of the Interior, dated January 20, 1862, in which he discusses the land and natural resources of the United States.

NEW MEXICO OIL CONSERVATION COMMISSION

Well Location and Acreage Dedication Plat

Section A.

Date April 25, 1959

Operator THE ATLANTIC REFINING COMPANY Lease NAVAJO
 Well No. 8 Unit Letter K Section 30 Township 31 NORTH Range 16 WEST, NMPM
 Located 1980 Feet From the SOUTH Line, 2060 Feet From the WEST Line
 County SAN JUAN G. L. Elevation 5548.0 Dedicated Acreage 10.00 Acres
 Name of Producing Formation Gallup Pool Horseshoe Gallup

1. Is the Operator the only owner in the dedicated acreage outlined on the plat below?
 Yes X No _____
2. If the answer to question one is "no", have the interests of all the owners been consolidated by communitization agreement or otherwise? Yes _____ No _____. If answer is "yes", Type of Consolidation _____
3. If the answer to question two is "no", list all the owners and their respective interests below:

Owner

Land Description

Section B.

This is to certify that the information in Section A above is true and complete to the best of my knowledge and belief.

THE ATLANTIC REFINING COMPANY
 (Operator)

A. D. Elston
 (Representative)

P.O. BOX 520
 (Address)

Casper, Wyoming

Note: All distances must be from outer boundaries of section.

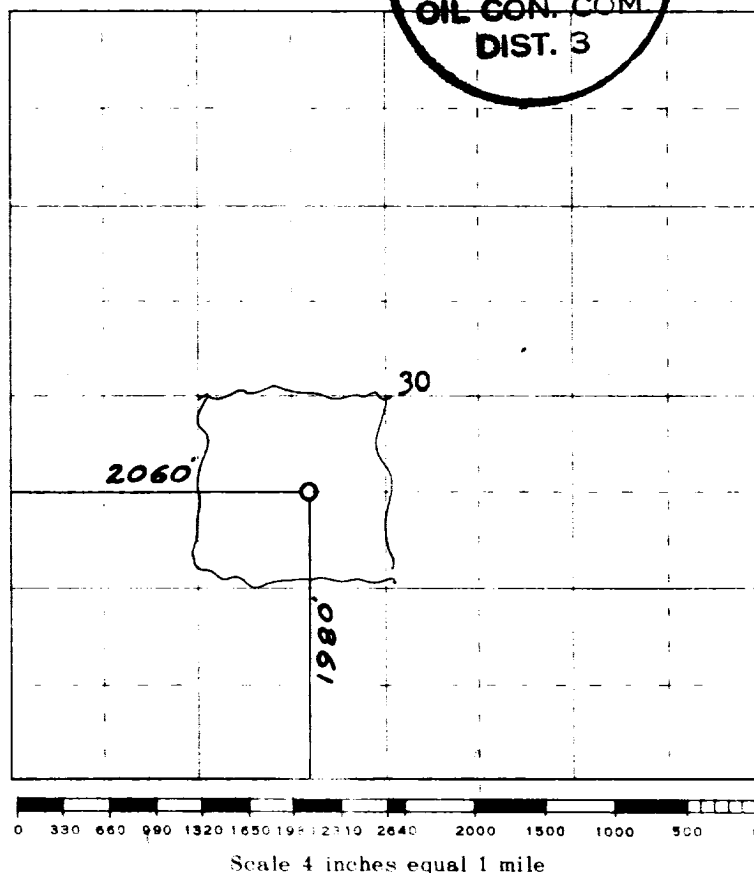

Scale 4 inches equal 1 mile



(Seal)

Farmington, New Mexico

27

Date Surveyed 19 October 1958

James P. Lese
 Registered Professional Engineer and/or Land Surveyor
 JAMES P. LEESE N. MEX. REG. NO. 1462