

(SUBMIT IN TRIPLICATE)

UNITED STATES
DEPARTMENT OF THE INTERIOR
GEOLOGICAL SURVEY

Indian Agency _____

Window Rock _____

Allottee Navajo Tribal _____

Lease No. 11-20-603-734

SUNDRY NOTICES AND REPORTS ON WELLS

NOTICE OF INTENTION TO DRILL	<input checked="" type="checkbox"/>	SUBSEQUENT REPORT OF WATER SHUT-OFF	
NOTICE OF INTENTION TO CHANGE PLANS		SUBSEQUENT REPORT OF SHOOTING OR ACIDIZING	
NOTICE OF INTENTION TO TEST WATER SHUT-OFF		SUBSEQUENT REPORT OF ALTERING CASING	
NOTICE OF INTENTION TO REDRILL OR REPAIR WELL		SUBSEQUENT REPORT OF REDRILLING OR REPAIR	
NOTICE OF INTENTION TO SHOOT OR ACIDIZE		SUBSEQUENT REPORT OF ABANDONMENT	
NOTICE OF INTENTION TO PULL OR ALTER CASING		SUPPLEMENTARY WELL HISTORY	
NOTICE OF INTENTION TO ABANDON WELL			

RECEIVED

5-1958

(INDICATE ABOVE BY CHECK MARK NATURE OF REPORT, NOTICE, OR OTHER DATA)

GEOLOGICAL SURVEY

November 3 1958

Well No. 11 is located 1980 ft. from [S] line and 660 ft. from [W] line of sec. 29

C NW SW Sec. 29
(1/4 Sec. and Sec. No.)

31 N
(Twp.)

16 W
(Range)

N.M.P.M.
(Meridian)

Hammock Gallup
(Field)

San Juan
(County or Subdivision)

New Mexico
(State or Territory)

The elevation of the ground above sea level is 562 ft.

DETAILS OF WORK

(State names of and expected depths to objective sands; show sizes, weights, and lengths of proposed casings; indicate mudding jobs, cementing points, and all other important proposed work)

We propose to drill a well at the above location with rotary tools to an approximate total depth of 1500'. 100' of 8-5/8" O.D. casing will be set and cemented to surface. Should the well prove productive a 5-1/2" O.D. oil string will be used. Completion is contemplated in the Gallup formation.

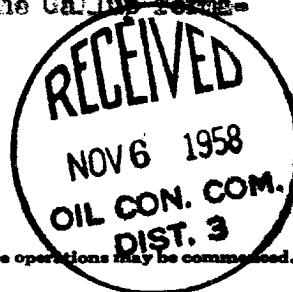

I understand that this plan of work must receive approval in writing by the Geological Survey before operations may be commenced.

Company The Atlantic Refining Company

Address P. O. Box 520

Casper, Wyoming

By [Signature]

Title Drilling Superintendent

MOO MOO J. J.
E. 1610

NEW MEXICO OIL CONSERVATION COMMISSION

Well Location and Acreage Dedication Plat

Date November 3, 1958

Leased by THE AMERICAN DRILLING COMPANY Lease NAVAJO
 Well No. 1 Well Letter L Section 29 Township 31 NORTH Range 16 WEST, NMPM
 Feet From the SOUTH Line, 660 Feet From the WEST Line
 G. L. Elevation 5462.0 Dedicated Acreage 40 Acres
 Producing Formation Gallup Pool Horseshoe Gallup

Operator the only owner in the dedicated acreage outlined on the plat below?

If the answer to question one is "no", have the interests of all the owners been consolidated by communitization or otherwise? Yes _____ No _____. If answer is "yes", Type of Consolidation.

If the answer to question two is "no", list all the owners and their respective interests below:

Owner

Land Description

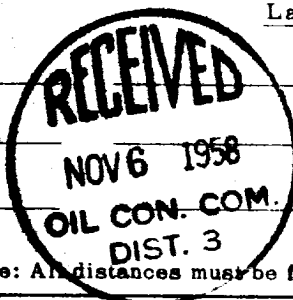

RECEIVED

NOV 5 1958

U. S. GEOLOGICAL SURVEY
 FARMINGTON, NEW MEXICO

Note: All distances must be from outer boundaries of Section 29

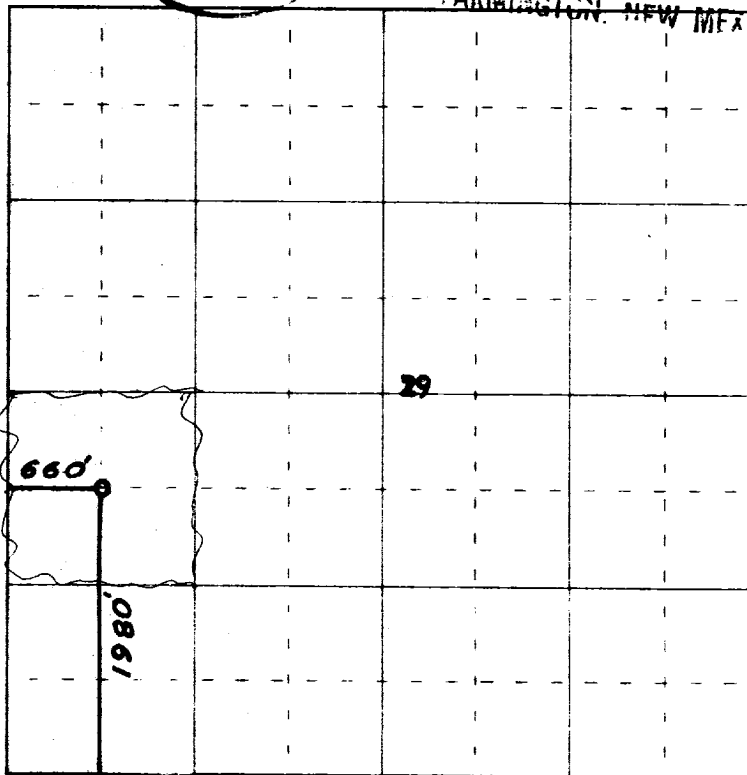

0 330 660 990 1320 1650 1980 2310 2640 2000 1500 1000 500 0

Scale 4 inches equal 1 mile

This is to certify that the above plat was prepared from field notes of actual surveys made by me or under my supervision and that the same are true and correct to the best of my knowledge and belief.

Date Surveyed 19 October 1958

James P. Lese
 Registered Professional Engineer and/or Land Surveyor
 JAMES P. LESE N. Mex. Reg. No. 1462