

P. O. Box 965
Farmington, New Mexico

March 29, 1956

El Paso Natural Gas Company
Box 997
Farmington, New Mexico

Re: Santa Fe 078097

Gentlemen:

Receipt is acknowledged of your "Notice of Intention to Drill" dated March 27, 1956 covering your well No. 8 Heaton in NE $\frac{1}{4}$ sec. 30, T. 31 N., R. 11 W., N. M. P. M., San Juan County, New Mexico, Blanco pool.

Your proposed work is here by approved subject to compliance with the provisions of the "Oil and Gas Operating Regulations" revised May 26, 1942, a copy of which will be sent to you on request, and subject to the following conditions:

1. Drilling operations so authorized are subject to the attached sheet for general conditions of approval.
2. Furnish copies of all logs.
3. Approved subject to the communitization of the E $\frac{1}{2}$ sec. 30 to form a unit of 320 acres more or less.

Very truly yours,

(Orig. Sgd.) P. T. McGrath

P. T. McGrath
District Engineer

PTMcGrath:ac

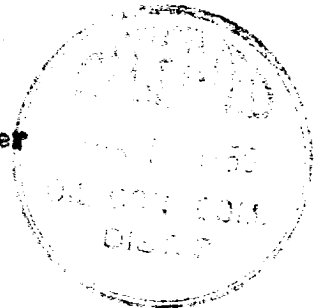

Form 9-331a
(Feb. 1951)

(SUBMIT IN TRIPLICATE)

UNITED STATES
DEPARTMENT OF THE INTERIOR
GEOLOGICAL SURVEY

Land Office Santa Fe
Lease No. 070097
Unit Heaton

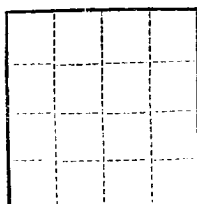

SUNDRY NOTICES AND REPORTS ON WELLS

NOTICE OF INTENTION TO DRILL	<input checked="" type="checkbox"/>	SUBSEQUENT REPORT OF WATER SHUT-OFF
NOTICE OF INTENTION TO CHANGE PLANS		SUBSEQUENT REPORT OF SHOOTING OR ACIDIZING
NOTICE OF INTENTION TO TEST WATER SHUT-OFF		SUBSEQUENT REPORT OF ALTERING CASING
NOTICE OF INTENTION TO RE-DRILL OR REPAIR WELL		SUBSEQUENT REPORT OF RE-DRILLING OR REPAIR
NOTICE OF INTENTION TO SHOOT OR ACIDIZE		SUBSEQUENT REPORT OF ABANDONMENT
NOTICE OF INTENTION TO PULL OR ALTER CASING		SUPPLEMENTARY WELL HISTORY
NOTICE OF INTENTION TO ABANDON WELL		

(INDICATE ABOVE BY CHECK MARK NATURE OF REPORT, NOTICE, OR OTHER DATA)

March 27, 1936

Well No. 6 is located 390 ft. from N line and 1650 ft. from E line of sec. 30
NE Section 30 31N 11W R4PM
 (1/4 Sec. and Sec. No.) (Twp.) (Range) (Meridian)
Blanco San Juan New Mexico
 (Field) (County or Subdivision) (State or Territory)

The elevation of the derrick floor above sea level is 5920 ft.

DETAILS OF WORK

(State names of and expected depths to objective sands; show sizes, weights, and lengths of proposed casings; indicate mudding jobs, cementing points, and all other important proposed work)

It is intended to drill a well with rotary tools thru the Mesa Verde formation. Mud circulation will be used thru the Pictured Cliffs and set intermediate casing. Gas circulation will be used thru the Mesa Verde and a liner will be set. Possible productive intervals will be perforated and fractured. T.D. 4915'.

Casing Program:

9 5/8" at 170' with 125 sacks cement circulated to the surface.
 7" at 4625' with 250 sacks cement.
 5 1/2" at 4915' with 150 sacks cement.

The E. 2 of Section 30 is dedicated to this well.

E/2 SE 070097 (NE/4, N35E), Ada L. Fritz (S35E), T. P. Thurston (E/2SE) DIST. 3

I understand that this plan of work must receive approval in writing by the Geological Survey before operations may be commenced.

Company El Paso Natural Gas Company

Address Box 997

Farmington, New Mexico

By Carroll H. Walsh

Title Petroleum Engineer

OIL CONSERVATION COMMISSION

WELL LOCATION AND/OR GAS PRODUCTION PLAT

DATE March 1, 1956OPERATOR EL PASO NATURAL GAS COMPANY LEASE HEATON SF 078097WELL NO. 8 SECTION 30 TOWNSHIP 31N RANGE 11W NMMLOCATED 990 FEET FROM NORTH LINE 1650 FEET FROM EAST LINESAN JUAN COUNTY, NEW MEXICO G. L. ELEVATION 5910NAME OF PRODUCING FORMATION MESA VERDE POOL BLANCO DEDICATED ACREAGE 320 ACRES
(1880 PLAT)

Note: All distances must be from outer boundaries of section.

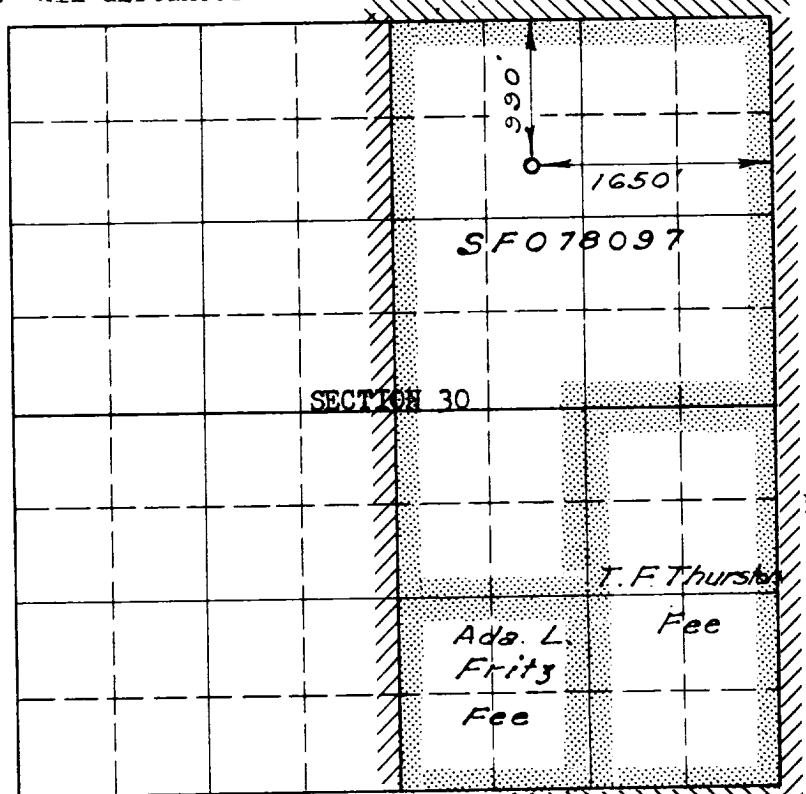

Scale 4 inches equal 1 mile

NOTE

This section of
farm is to be used
for gas wells only.

This is to certify that the above plat was prepared from field notes of actual surveys made by me or under my supervision and that the same are true and correct to the best of my knowledge and belief.

Date Surveyed FEBRUARY 21, 1956

E. O. Walpe
Registered Professional Engineer and/or
Land Surveyor



(Seal)

1. Is this well a Dual Comp.
Yes _____ No X
2. If the answer to question 1 is yes, are there any other dually completed wells within the dedicated acreage.
Yes _____ No _____

Name W. L. WalpePosition Petroleum EngineerRepresenting El Paso Natural GasAddress Box 997, Farmington, N.M.