

(SUBMIT IN TRIPLICATE)

UNITED STATES
DEPARTMENT OF THE INTERIOR
GEOLOGICAL SURVEY

Land Office Santa Fe

Lease No. 24-01614

Unit Thompson

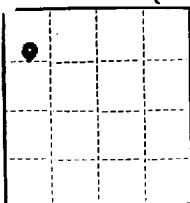

SUNDRY NOTICES AND REPORTS ON WELLS

NOTICE OF INTENTION TO DRILL	<input checked="" type="checkbox"/>	SUBSEQUENT REPORT OF WATER SHUT-OFF	<input type="checkbox"/>
NOTICE OF INTENTION TO CHANGE PLANS	<input type="checkbox"/>	SUBSEQUENT REPORT OF SHOOTING OR ACIDIZING	<input type="checkbox"/>
NOTICE OF INTENTION TO TEST WATER SHUT-OFF	<input type="checkbox"/>	SUBSEQUENT REPORT OF ALTERING CASING	<input type="checkbox"/>
NOTICE OF INTENTION TO RE-DRILL OR REPAIR WELL	<input type="checkbox"/>	SUBSEQUENT REPORT OF RE-DRILLING OR REPAIR	<input type="checkbox"/>
NOTICE OF INTENTION TO SHOOT OR ACIDIZE	<input type="checkbox"/>	SUBSEQUENT REPORT OF ABANDONMENT	<input type="checkbox"/>
NOTICE OF INTENTION TO PULL OR ALTER CASING	<input type="checkbox"/>	SUPPLEMENTARY WELL HISTORY	<input type="checkbox"/>
NOTICE OF INTENTION TO ABANDON WELL	<input type="checkbox"/>		

(INDICATE ABOVE BY CHECK MARK NATURE OF REPORT, NOTICE, OR OTHER DATA)

August 9, 1962

Well No. 6-9 is located 1055 ft. from N line and 1080 ft. from W line of sec. 28

24, Section 28
(1/4 Sec. and Sec. No.)

31N
(Twp.)

12W
(Range)

N.M.P.M.
(Meridian)

Dubin Dakota
(Field)

San Juan
(County or Subdivision)

New Mexico
(State or Territory)

The elevation of the derrick floor above sea level is 6076 ft. (Ungraded Ground Elevation)

DETAILS OF WORK

(State names of and expected depths to objective sands; show sizes, weights, and lengths of proposed casings; indicate mudding jobs, cementing points, and all other important proposed work)

Propose to:

Set 300 feet of 8 5/8" surface casing and cement to surface. Drill with rotary to approximately 7190 feet or through the Dubin formation and set 4 1/2" production casing. Set two-stage cement collar approximately 100 ft. below the Manverda formation and cement with sufficient cement to cover both the Manverda and the Pictured Cliffs formations. Perforate and sand-water free with 80,000 gal. sand and 80,000 gals. water. Run 2 1/8" tubing.

Set one-half, 380 acres, Section 28, dedicated to this well.

I understand that this plan of work must receive approval in writing by the Geological Survey before operation may be commenced.

Company Agate Oil and Gas Company

Address P. O. Drawer 570

Farmington, New Mexico

By Joe C. Salmon
Title District Superintendent

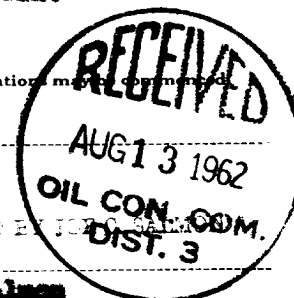

NEW MEXICO OIL CONSERVATION COMMISSION

Well Location and Acreage Dedication Plot

SECTION A.

Date **July 13, 1962**

Operator **Astec Oil and Gas Company** Lease **Thompson**
Well No. **8-D** Unit Letter **D** Section **28** Township **31N** Range **12W** NMPM
Located **1055** Feet From **North** Line **1080** Feet From **West** Line
County **San Juan** G. L. Elevation **6076** Dedicated Acreage **W $\frac{1}{2}$, 320** Acres
Name of Producing Formation **Dakota** Pool **Basin**

- Is the Operator the only owner* in the dedicated acreage outlined on the plot below? Yes **XX**
- If the answer to question One is "No," have the interests of all the owners been consolidated by a consolidation agreement or otherwise? Yes **XX** No **XX** If answer is "Yes," Type of Consolidation **XX**
- If the answer to question Two is "No," list all the owners and their respective interests below

OWNER

LAND DESCRIPTION

SECTION B.

5305.74' **N 86° 21' W**

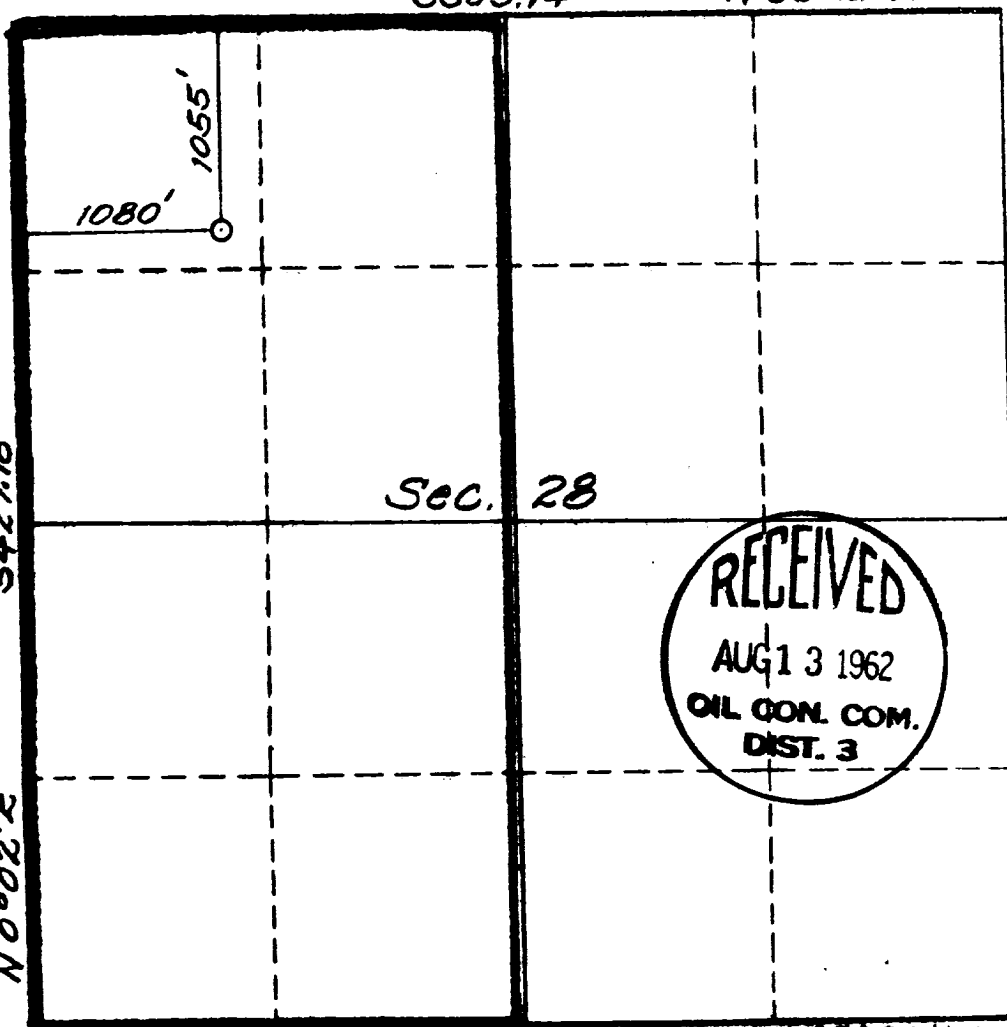

This is to certify that the information in Section A above is true and complete to the best of my knowledge and belief.

Astec Oil and Gas Company

ORIGINAL SIGNED BY **JOE C. SALMON**
Joe C. Salmon, Dist. Supt.

P. O. Drawer 570, Farmington

This is to certify that the information in Section B above is true and complete to the best of my knowledge and belief.

Date Surveyed **July 11, 1962**

Four States Engineering Co.
FARMINGTON, UTAH

REGISTERED LAND SURVEYOR

Certificate No. **3602**