

(SUBMIT IN TRIPLICATE)

UNITED STATES
DEPARTMENT OF THE INTERIOR
GEOLOGICAL SURVEY

Indian Agency _____

Allottee _____

Lease No. **21-01-000-0000**

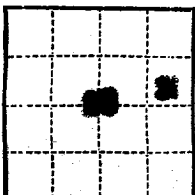

SUNDRY NOTICES AND REPORTS ON WELLS

NOTICE OF INTENTION TO DRILL	SUBSEQUENT REPORT OF WATER SHUT-OFF
NOTICE OF INTENTION TO CHANGE PLANS	SUBSEQUENT REPORT OF SHOOTING OR ACIDIZING
NOTICE OF INTENTION TO TEST WATER SHUT-OFF	SUBSEQUENT REPORT OF ALTERING CASING
NOTICE OF INTENTION TO REDRILL OR REPAIR WELL	SUBSEQUENT REPORT OF REDRILLING OR REPAIR
NOTICE OF INTENTION TO SHOOT OR ACIDIZE	SUBSEQUENT REPORT OF ABANDONMENT
NOTICE OF INTENTION TO PULL OR ALTER CASING	SUPPLEMENTARY WELL HISTORY
NOTICE OF INTENTION TO ABANDON WELL	

(INDICATE ABOVE BY CHECK MARK NATURE OF REPORT, NOTICE, OR OTHER DATA)

RECEIVED
DEC 27 1961
U. S. GEOLOGICAL SURVEY
WASHINGTON, NEW MEXICO

Well No. **22** is located **2000** ft. from **[N]** line and **400** ft. from **[E]** line of sec. **22**
22 **22** Section **22**
(1/4 Sec. and Sec. No.) (Twp.) (Range) (Meridian)
22 **22** **22**
(Field) (County or Subdivision) (State or Territory)

The elevation of the derrick floor above sea level is _____ ft.

DETAILS OF WORK

(State names of and expected depths to objective sands; show sizes, weights, and lengths of proposed casings; indicate mudlogging jobs, cementing points, and all other important proposed work)

Rotary drilling equipment will be used to drill to approximately 400' to the formation. If production is found, casing will be set and cemented with standard cement of strength. Before and after casing will be drilled. There will be tested and electric logs will be run prior to setting casing or abandonment. Stimulation treatments may be employed in completion.

RECEIVED
DEC 28 1961
OIL CON. COM.
DIST. 3

I understand that this plan of work must receive approval in writing by the Geological Survey before operations may be commenced.

Company **Beulah Oil & Refining Company**
Address **P. O. Box 2000**
Durango, Colorado

By **COPY (ORIGINAL) B. M. BRADLEY**

Title **State Eng.**

OK

Figure 1. The effect of the number of trials on the number of correct responses. The number of correct responses was significantly higher than the number of incorrect responses in all cases.

NUMBER OF COPIES RECEIVED	
DISTRIBUTION	
SANTA FE	
FILE	
U.S.G.S.	
LAND OFFICE	
TRANSPORTER	OIL GAS
PRORATOR OFFICE	
OPERATOR	

NEW MEXICO OIL CONSERVATION COMMISSION
WELL LOCATION AND ACREAGE DEDICATION PLAT
 SEE INSTRUCTIONS FOR COMPLETING THIS FORM ON THE REVERSE SIDE

FORM C-128
 6-1-57

RECEIVED
DEC 28 1961
 OIL COM. DIV.
 Well No. 1

SECTION A

Operator: Phillips Oil & Refining Company			Lease Cure Hole		Well No. 1
Unit Letter H	Section 28	Township 31N	Range 18W	County San Juan	
Actual Footage Location of Well: 1980 feet from the North line and 660' feet from the East line					
Ground Level Elev. 5008.3	Producing Formation -		Pool Williston		Dedicated Acreage: - Acres

1. Is the Operator the only owner in the dedicated acreage outlined on the plat below? YES ☒ NO ☐ ("Owner" means the person who has the right to drill into and to produce from any pool and to appropriate the production either for himself or for himself and another. (65-3-29 (e) NMSA 1935 Comp.)
2. If the answer to question one is "no," have the interests of all the owners been consolidated by communitization agreement or otherwise? YES ☐ NO ☐ If answer is "yes," Type of Consolidation _____
3. If the answer to question two is "no," list all the owners and their respective interests below:

Owner	Land Description

SECTION B

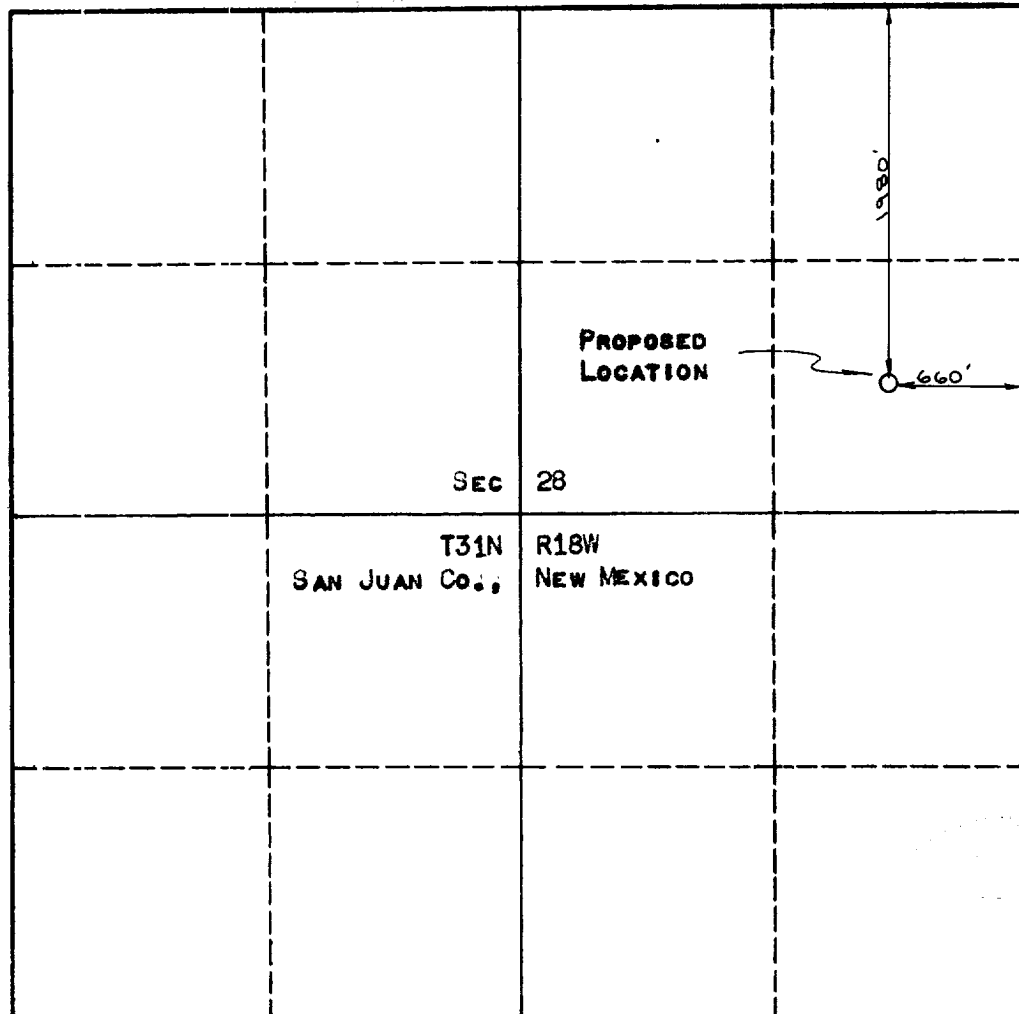

CERTIFICATION

I hereby certify that the information in SECTION A above is true and complete to the best of my knowledge and belief.

D. M. Bradley

Name
COPY (ORIGINAL) D. M. BRADLEY
 Position
Dist. Supt.

Company
Phillips Oil & Refining Co.

Date
December 22, 1961

I hereby certify that the well location shown on the plat in SECTION B was plotted from field notes of actual surveys made by me or under my supervision, and that the same is true and correct to the best of my knowledge and belief.

Date Surveyed
12-7-61

Registered Professional Engineer and/or Land Surveyor

Edmund M. Clark

Certificate No.
NEW MEXICO 3189

INSTRUCTIONS FOR COMPLETION OF FORM C-128

1. Operator shall furnish and certify to the information called for in Section A.
2. Operator shall outline the dedicated acreage for *both* oil and gas wells on the plat in Section B.
3. A registered professional engineer or land surveyor registered in the State of New Mexico or approved by the Commission shall show on the plat the location of the well and certify this information in the space provided.
4. All distances shown on the plat must be from the outer boundaries of the Section.
5. If additional space is needed for listing owners and their respective interests as required in question 3 of Section A, please use space below.