

	X	

(SUBMIT IN TRIPLICATE)

UNITED STATES  
DEPARTMENT OF THE INTERIOR  
GEOLOGICAL SURVEY

Indian Agency Navajo-Us Tribal

Contract \_\_\_\_\_

Allottee \_\_\_\_\_

Lease No. 14-20-604-1951

SUNDRY NOTICES AND REPORTS ON WELLS

NOTICE OF INTENTION TO DRILL	X	SUBSEQUENT REPORT OF WATER SHUT-OFF	
NOTICE OF INTENTION TO CHANGE PLANS		SUBSEQUENT REPORT OF SHOOTING OR ACIDIZING	
NOTICE OF INTENTION TO TEST WATER SHUT-OFF		SUBSEQUENT REPORT OF ALTERING CASING	
NOTICE OF INTENTION TO REDRILL OR REPAIR WELL		SUBSEQUENT REPORT OF REDRILLING OR REPAIR	
NOTICE OF INTENTION TO SHOOT OR ACIDIZE		SUBSEQUENT REPORT OF ABANDONMENT	
NOTICE OF INTENTION TO PULL OR ALTER CASING		SUPPLEMENTARY WELL HISTORY	
NOTICE OF INTENTION TO ABANDON WELL			

(INDICATE ABOVE BY CHECK MARK NATURE OF REPORT, NOTICE, OR OTHER DATA)

October 7, 1959

Hershee Use

Well No. 26 is located 1900 ft. from N line and 3300 ft. from E line of sec. 28

SE NW/4 Section 28  
(1/4 Sec. and Sec. No.)

31N  
(Twp.)

16W  
(Range)

NMPM  
(Meridian)

Hershee Gallup Ext.  
(Field)

S. a. Juan  
(County or Subdivision)

New Mexico  
(State or Territory)

The elevation of the derrick floor above sea level is 5763 ft.

DETAILS OF WORK

(State names of and expected depths to objective sands; show sizes, weights, and lengths of proposed casings; indicate mudding jobs, cementing points, and all other important proposed work)

It is intended to drill a well through the Lower-Gallup Formation using rotary tools and mud circulation. Possible productive intervals will be perforated and sandoil fractured. Estimated Total Depth 1700'.

Casing Program:

8-5/8" at 100' with 150 sacks cement circulated to surface

5-1/2" at 1700' with 100 sacks cement.

The SE NW/4 of Section 28 is dedicated to this well.

SE NW/4 Section 28 Navajo-Us Tribal 14-20-604-1951



I understand that this plan of work must receive approval in writing by the Geological Survey before operations may be commenced.

Company El Paso Natural Gas Products Company

Address Post Office Box 1545

Farmington, New Mexico

ORIGINAL SIGNED BY: WILLIAM K. GLAZENER

Title Petroleum Engineer

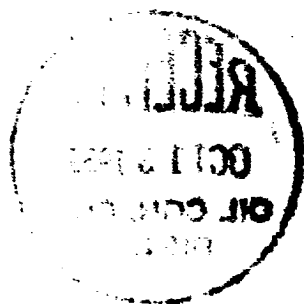

1961

NEW MEXICO OIL CONSERVATION COMMISSION

Well Location and Acreage Dedication Plat

Section A.

Date October 7, 1959

Operator El Paso Natural Gas Products Company Lease Horseshoe Ute Navajo-Ute Tribal Contract  
Well No. 26 Unit Letter F Section 28 Township 31 North Range 16 West NMPM  
Located 1980 Feet From North Line, 3300 Feet From East Line  
County San Juan G. L. Elevation 5756 Dedicated Acreage 40 Acres  
Name of Producing Formation Lower Gallup Pool Horseshoe Gallup Rut.

1. Is the Operator the only owner\* in the dedicated acreage outlined on the plat below?  
Yes X No
2. If the answer to question one is "no," have the interests of all the owners been consolidated by communitization agreement or otherwise? Yes        No       . If answer is "yes,"  
Type of Consolidation
3. If the answer to question two is "no," list all the owners and their respective interests below:

Owner

Land Description



Section B

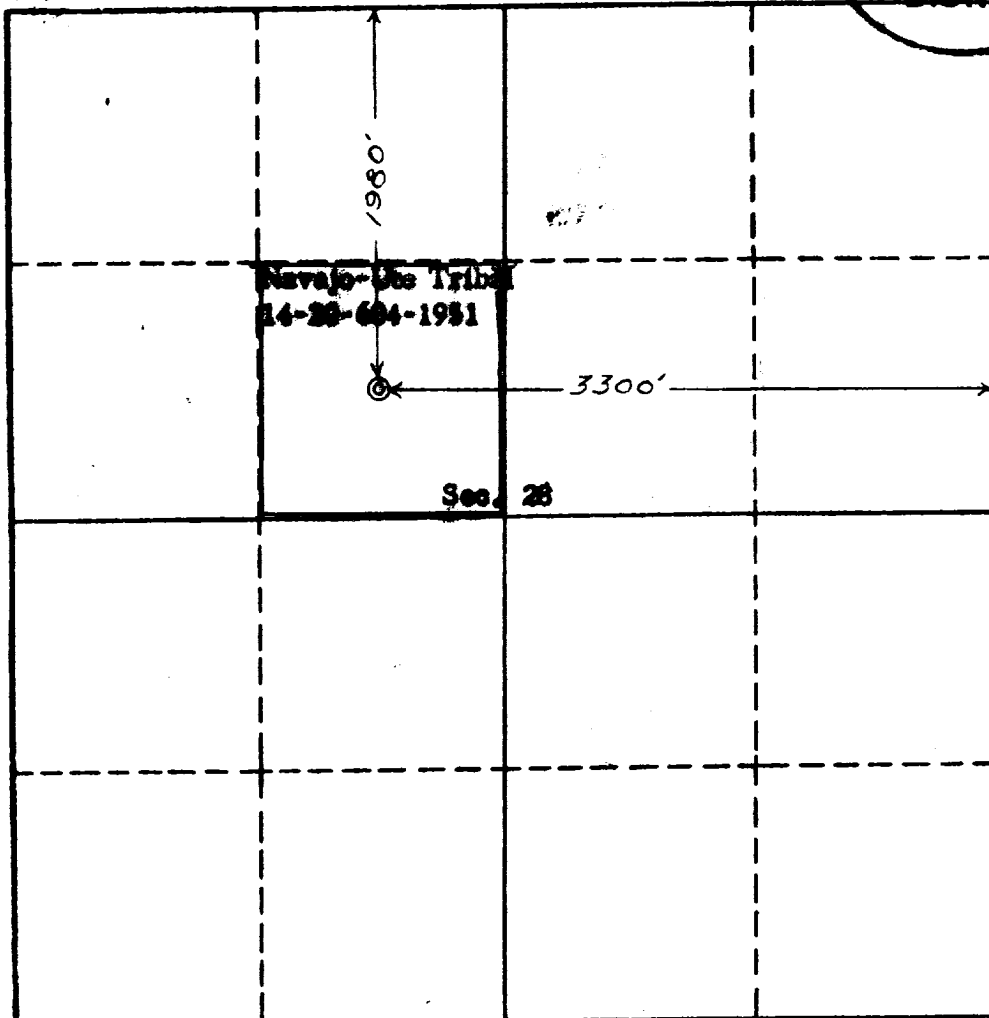

This is to certify that the information in Section A above is true and complete to the best of my knowledge and belief.

El Paso Natural Gas Products Co.  
(Operator)

William K. Grayson  
(Representative)

Box 1545, Farmington, New Mexico  
Address

This is to certify that the well location shown on the plat is correct as plotted from field notes of actual survey made by me or under my supervision and that the same is true to the best of my knowledge and belief.

Date Surveyed Oct. 5, 1959

Ernest V. Echolaw  
Ernest V. Echolaw  
Registered Land Surveyor.

Certificate No. 1545