

(SUBMIT IN TRIPPLICATE)

UNITED STATES
DEPARTMENT OF THE INTERIOR
GEOLOGICAL SURVEY

Indian Agency
Ute Mountain Tribal
Allottee
Lease No. 14-20-604-84

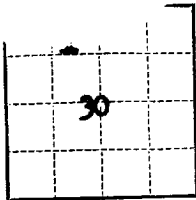

SUNDRY NOTICES AND REPORTS ON WELLS

NOTICE OF INTENTION TO DRILL.....	<input checked="" type="checkbox"/>	SUBSEQUENT REPORT OF WATER SHUT-OFF.....	
NOTICE OF INTENTION TO CHANGE PLANS.....		SUBSEQUENT REPORT OF SHOOTING OR ACIDIZING.....	
NOTICE OF INTENTION TO TEST WATER SHUT-OFF.....		SUBSEQUENT REPORT OF ALTERING CASING.....	
NOTICE OF INTENTION TO REDRILL OR REPAIR WELL.....		SUBSEQUENT REPORT OF REDRILLING OR REPAIR.....	
NOTICE OF INTENTION TO SHOOT OR ACIDIZE.....		SUBSEQUENT REPORT OF ABANDONMENT.....	
NOTICE OF INTENTION TO PULL OR ALTER CASING.....		SUPPLEMENTARY WELL HISTORY.....	
NOTICE OF INTENTION TO ABANDON WELL.....			

RECEIVED
NOV 25 1958
U. S. GEOLOGICAL SURVEY
FARMINGTON NEW MEXICO

(INDICATE ABOVE BY CHECK MARK NATURE OF REPORT, NOTICE, OR OTHER DATA)

November 24, 1958

Well No. Tribal is located 660 ft. from N line and 1980 ft. from W line of sec. 30
NE NW Sec. 30 31N 14W NMPM
(1/4 Sec. and Sec. No.) (Twp.) (Range) (Meridian)
Verde-Gallup San Juan New Mexico
(Field) (County or Subdivision) (State or Territory)

The elevation of the ~~formation~~ ^{ground} above sea level is 5553 ft.

DETAILS OF WORK

(State names of and expected depths to objective sands; show sizes, weights, and lengths of proposed casings; indicate mudding jobs, cementing points, and all other important proposed work)

Plan to drill well with cable tools to estimated depth of 3800'. Sand oil frac the Gallup formation in open hole.

13-3/8" O.D. at 100' w/125 sx. regular cement, circulated to surface.
10-3/4" O.D. at 1100', no cement. Will pull when complete.
8-5/8" O.D. at 2600', no cement. Will pull when complete.
5-1/2" O.D. at 3650', set D.V. tool at 2550', and two stage cement s/50 sx. below and 100 sx. above tool.

The NE NW of Section 30 is dedicated to this well.

I understand that this plan of work must receive approval in writing by the Geological Survey before operations may be commenced

Company Three States Natural Gas Company

Address P. O. Box 67

Farmington, New Mexico

By Original signed by W. D. Bellman

Title District Supt.

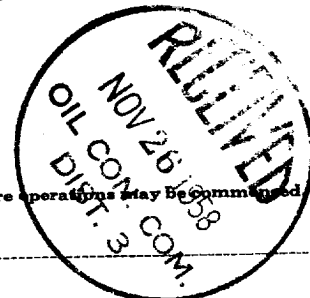



NEW MEXICO OIL CONSERVATION COMMISSION

Well Location and Acreage Dedication Plat

Section A.

Date Nov. 24, 1958

Operator Three States Natural Gas Company Lease Ute Mountain Tribal
Well No. 4 Unit Letter Section 30 Township 31 North Range 14 West NMPM
Located 660 Feet From North Line, 1980 Feet From West Line
County San Juan G. L. Elevation 5553 Dedicated Acreage 40 Acres
Name of Producing Formation Gallup Pool Verde Gallup

1. Is the Operator the only owner* in the dedicated acreage outlined on the plat below?
Yes X No
2. If the answer to question one is "no," have the interests of all the owners been consolidated by communitization agreement or otherwise? Yes No . If answer is "yes,"
Type of Consolidation
3. If the answer to question two is "no," list all the owners and their respective interests below:

Owner

Land Description

RECEIVED

DEC 11 1958

OIL CON. COM.

RECEIVED

DEC 5 1958

LOGICARE SURVEY

FARMINGTON NEW MEXICO

Section. B

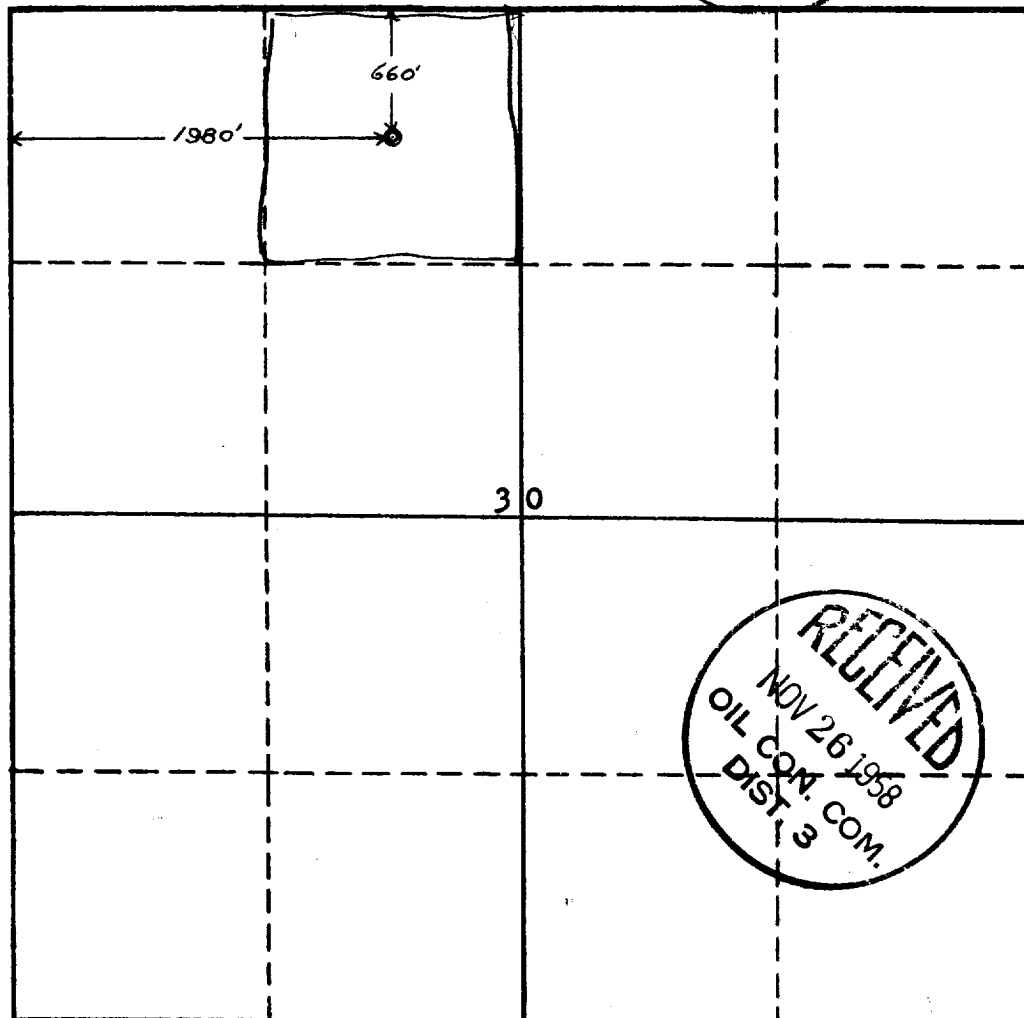

This is to certify that the information in Section A above is true and complete to the best of my knowledge and belief.

Three States Nat. Gas Co.
(Operator)

W. R. Bellman
(Representative)

Box 67, Farmington, N.M.
Address

This is to certify that the well location on the plat in Section B was obtained from field notes of a well survey made by me or under my supervision and that the same is true to the best of my knowledge and belief.

Date Surveyed Feb. 6, 1958

Ernest V. Echohawk
Registered Land Surveyor.

Certificate No. 1545