

(SUBMIT IN TRIPLICATE)

Indian Agency Ute Indian

UNITED STATES
DEPARTMENT OF THE INTERIOR
GEOLOGICAL SURVEY

Allottee Ute Mountain Tribal
Contract No. 14-20-604-82
Lease No. 14-20-604-82

0	20
---	----

SUNDRY NOTICES AND REPORTS ON WELLS

NOTICE OF INTENTION TO DRILL	XX	SUBSEQUENT REPORT OF WATER SHUT-OFF
NOTICE OF INTENTION TO CHANGE PLANS		SUBSEQUENT REPORT OF SHOOTING OR ACIDIZING
NOTICE OF INTENTION TO TEST WATER SHUT-OFF		SUBSEQUENT REPORT OF ALTERING CASING
NOTICE OF INTENTION TO REDRILL OR REPAIR WELL		SUBSEQUENT REPORT OF REDRILLING OR REPAIR
NOTICE OF INTENTION TO SHOOT OR ACIDIZE		SUBSEQUENT REPORT OF ABANDONMENT
NOTICE OF INTENTION TO PULL OR ALTER CASING		SUPPLEMENTARY WELL HISTORY
NOTICE OF INTENTION TO ABANDON WELL		

(INDICATE ABOVE BY CHECK MARK NATURE OF REPORT, NOTICE, OR OTHER DATA)

January 26, 1959

Ute Indian
Well No. 2-20/ is located 700 ft. from S line and 1940 ft. from E line of sec. 20
SW 1/4 SE 1/4 Section 20 T-31N R-14W N.M.P.M.
(1/4 Sec. and Sec. No.) (Twp.) (Range) (Meridian)
Verde Gallup San Juan County New Mexico
(Field) (County or Subdivision) (State or Territory)

The elevation of the derrick floor above sea level is 5618 ft.

DETAILS OF WORK

(State names of and expected depths to objective sands; show sizes, weights, and lengths of proposed casings; indicate mudding jobs, cementing points, and all other important proposed work)

We Propose to: Set 100' 9 5/8" at 100' with 100 sacks. Drill to approximately 3300'. Set 5 1/2" casing at 3300' with 125 sacks, run DV tool below Point Lookout and cement Point Lookout with 200 sacks. Perforate Gallup formation. Sand Oil Frac. Run 2 3/8" tubing and install pump.

I understand that this plan of work must receive approval in writing by the Geological Survey before operations may be commenced.

Company SOUTHERN UNION GAS COMPANY

Address 1001 Burt Building

Dallas, Texas

By [Signature]
Title Drilling Superintendent

*notified to record
1-27-59*

NEW MEXICO OIL CONSERVATION COMMISSION
WELL LOCATION AND ACREAGE DEDICATION PLAT

FORM C-128
Revised 5/1/57

SEE INSTRUCTIONS FOR COMPLETING THIS FORM ON THE REVERSE SIDE

SECTION A

Operator SOUTHERN UNION GAS CO.		Lease UT. INDIAN		Well No. 2-20
Unit Letter J	Section 20	Township 31 SOUTH	Range 14 WEST	County SAN JUAN
Actual Footage Location of Well: 700 feet from the SOUTH line and 1940 feet from the EAST line				
Ground Level Elev. 5618.0	Producing Formation GALLUP	Pool VERDE GALLUP	Dedicated Acreage: 40 Acres	

1. Is the Operator the only owner in the dedicated acreage outlined on the plat below? YES _____ NO _____. ("Owner" means the person who has the right to drill into and to produce from any pool and to appropriate the production either for himself or for himself and another. (65-3-29 (e) NMSA 1935 Comp.)
2. If the answer to question one is "no," have the interests of all the owners been consolidated by communization agreement or otherwise? YES _____ NO _____. If answer is "yes," Type of Consolidation _____
3. If the answer to question two is "no," list all the owners and their respective interests below:

Owner	Land Description

SECTION B

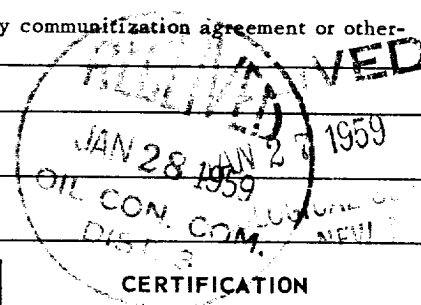
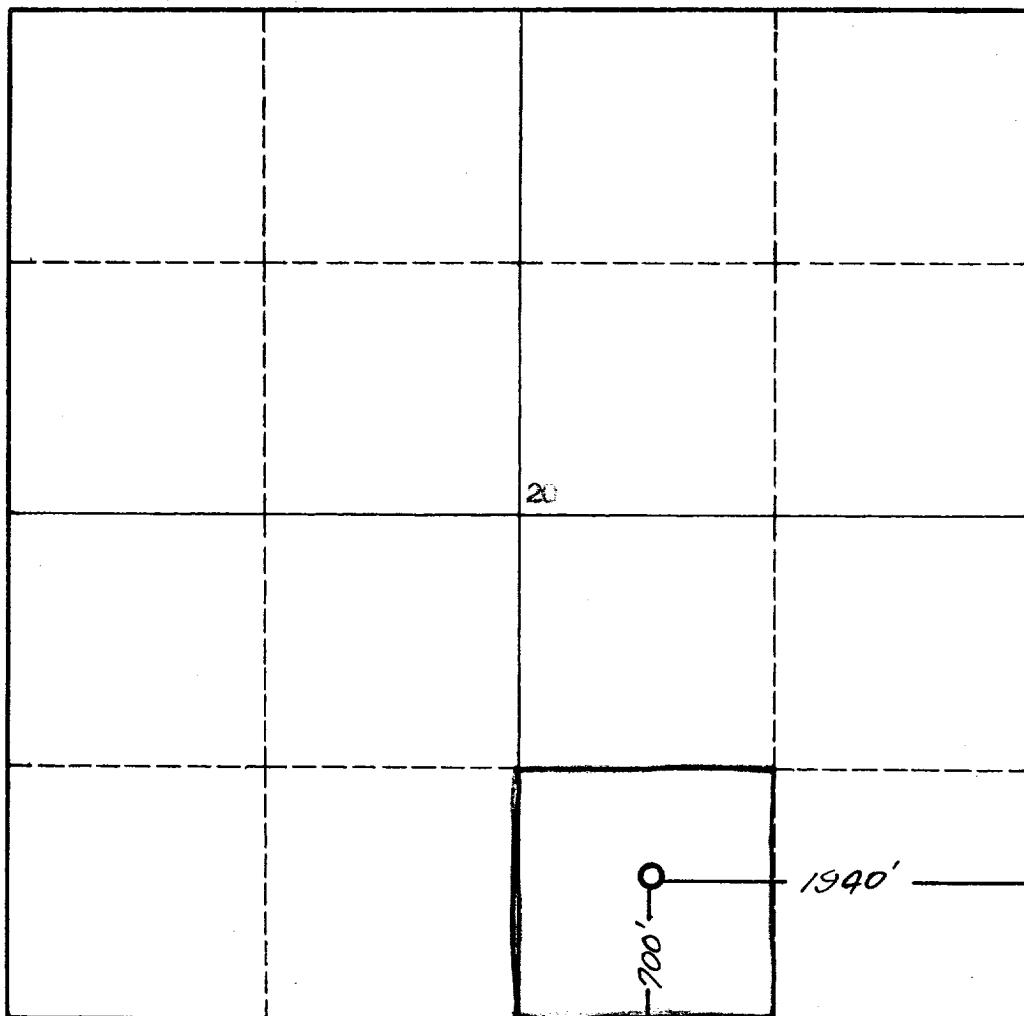

I hereby certify that the information in SECTION A above is true and complete to the best of my knowledge and belief.

Name

Paul J. Clote

Position

Drilling Superintendent

Company

SOUTHERN UNION GAS CO.

Date

January 26, 1959

I hereby certify that the well location shown on the plat in SECTION B was plotted from field notes of actual surveys made by me or under my supervision, and that the same is true and correct to the best of my knowledge and belief.

Date Surveyed

22 JANUARY 1959

Registered Professional Engineer and/or Land Surveyor

James P. Tease
James P. Tease

Certificate No.

1463

INSTRUCTIONS FOR COMPLETION OF FORM C-128

1. Operator shall furnish and certify to the information called for in Section A.
2. Operator shall outline the dedicated acreage for *both* oil and gas wells on the plat in Section B.
3. A registered professional engineer or land surveyor registered in the State of New Mexico or approved by the Commission shall show on the plat the location of the well and certify this information in the space provided.
4. All distances shown on the plat must be from the outer boundaries of the Section.
5. If additional space is needed for listing owners and their respective interests as required in question 3 of Section A, please use space below.