

(SUBMIT IN TRIPLICATE)

Land Office **077652**

Lease No. _____

Unit **East**UNITED STATES
DEPARTMENT OF THE INTERIOR
GEOLOGICAL SURVEY

SUNDRY NOTICES AND REPORTS ON WELLS

NOTICE OF INTENTION TO DRILL	<input checked="" type="checkbox"/>	SUBSEQUENT REPORT OF WATER SHUT-OFF	<input type="checkbox"/>
NOTICE OF INTENTION TO CHANGE PLANS	<input type="checkbox"/>	SUBSEQUENT REPORT OF SHOOTING OR ACIDIZING	<input type="checkbox"/>
NOTICE OF INTENTION TO TEST WATER SHUT-OFF	<input type="checkbox"/>	SUBSEQUENT REPORT OF ALTERING CASING	<input type="checkbox"/>
NOTICE OF INTENTION TO RE-DRILL OR REPAIR WELL	<input type="checkbox"/>	SUBSEQUENT REPORT OF RE-DRILLING OR REPAIR	<input type="checkbox"/>
NOTICE OF INTENTION TO SHOOT OR ACIDIZE	<input type="checkbox"/>	SUBSEQUENT REPORT OF ABANDONMENT	<input type="checkbox"/>
NOTICE OF INTENTION TO PULL OR ALTER CASING	<input type="checkbox"/>	SUPPLEMENTARY WELL HISTORY	<input type="checkbox"/>
NOTICE OF INTENTION TO ABANDON WELL	<input type="checkbox"/>		

(INDICATE ABOVE BY CHECK MARK NATURE OF REPORT, NOTICE, OR OTHER DATA)

October 4, 1954

Well No. 5 is located 990 ft. from $\left\{ \begin{smallmatrix} N \\ S \end{smallmatrix} \right\}$ line and 1650 ft. from $\left\{ \begin{smallmatrix} E \\ W \end{smallmatrix} \right\}$ line of sec. 24 $\frac{34}{4}$ Sec. 24 31N 12W N.M.P.M.
($\frac{1}{4}$ Sec. and Sec. No.) (Twp.) (Range) (Meridian)Blanco San Juan New Mexico
(Field) (County or Subdivision) (State or Territory)

The elevation of the derrick floor above sea level is _____ ft. To be reported

DETAILS OF WORK

(State names of and expected depths to objective sands; show sizes, weights, and lengths of proposed casings; indicate mudding jobs, cementing points, and all other important proposed work)

We propose to drill to the top of Point Lookout with rotary, set 7" casing, drill in with gas, treat by semi-frac with 5,000 gal. and 3000 lbs. sand for completion in the Point Lookout.

The casing program proposed is:

150'	-	10-3/4"	-	Surface
5000'	-	7"	-	Production
5200'	-	2"	-	Tubing



I understand that this plan of work must receive approval in writing by the Geological Survey before operations may be commenced.

Company **AMCO OIL & GAS COMPANY**Address **112 No. Behrend****Farrington, New Mexico**By *G. B. Williams***G. B. Williams**Title **Petroleum Engineer**

1. The first part of the document

2. The second part of the document

3. The third part of the document

4. The fourth part of the document

5. The fifth part of the document

6. The sixth part of the document

7. The seventh part of the document

8. The eighth part of the document

9. The ninth part of the document

10. The tenth part of the document

11. The eleventh part of the document

12. The twelfth part of the document

13. The thirteenth part of the document

14. The fourteenth part of the document

15. The fifteenth part of the document

16. The sixteenth part of the document

17. The seventeenth part of the document

18. The eighteenth part of the document

19. The nineteenth part of the document

20. The twentieth part of the document

21. The twenty-first part of the document

22. The twenty-second part of the document

23. The twenty-third part of the document

24. The twenty-fourth part of the document

25. The twenty-fifth part of the document

26. The twenty-sixth part of the document

27. The twenty-seventh part of the document

28. The twenty-eighth part of the document

29. The twenty-ninth part of the document

30. The thirtieth part of the document

31. The thirty-first part of the document

32. The thirty-second part of the document

33. The thirty-third part of the document

34. The thirty-fourth part of the document

35. The thirty-fifth part of the document

36. The thirty-sixth part of the document

37. The thirty-seventh part of the document

38. The thirty-eighth part of the document

39. The thirty-ninth part of the document

40. The fortieth part of the document

Company.....Southern Union Gas Company.....

Lease.....East.....Well No. 5.....

Sec. 24....., T. 31 N....., R. 12 W., N.M.P.M.

Location 990' from the South line and 1650' from
the West line.

San Juan County

New Mexico

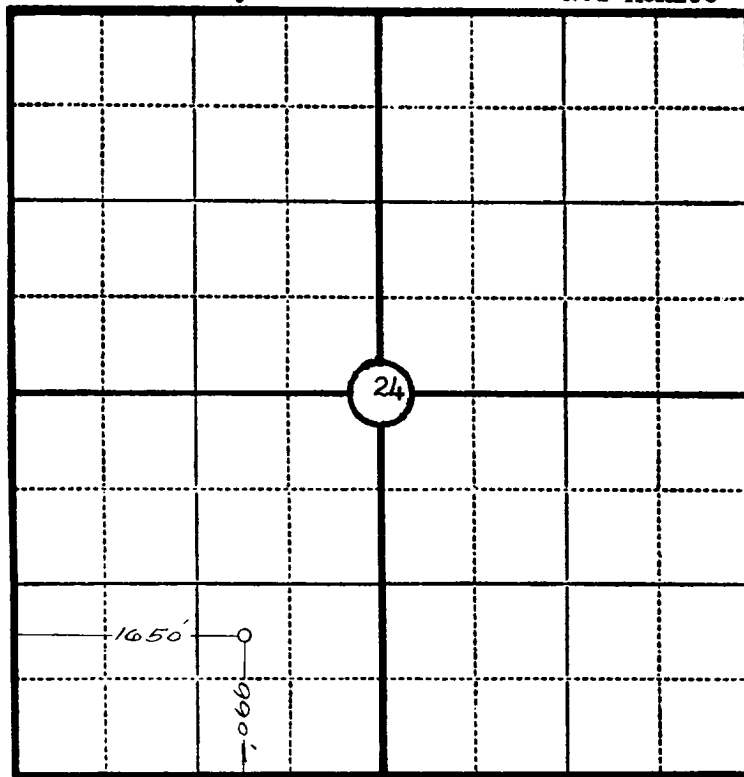

Scale—4 inches equal 1 mile.

This is to certify that the above plat was prepared from field notes of actual surveys made by me or under my supervision and that the same are true and correct to the best of my knowledge and belief.

Seal:

Registered Professional
Engineer and Land Surveyor

Ernest V. Echohawk
N. Mex. Reg. No. 1545

Surveyed December 16 1953

