

NEW MEXICO OIL CONSERVATION COMMISSION
Well Location and Acreage Dedication Plat

Section A.

Date July 13, 1957

Operator COLORADO WESTERN EXPLORATION CO. Lease 41-19 Southern Union Guaranty
Well No. _____ Unit Letter N Section 19 Township 31 NORTH Range 12 WEST NMPM
Located 1090 Feet From the SOUTH Line, 1090 Feet From the WEST Line
County SAN JUAN G. L. Elevation 5903.0 Dedicated Acreage 330 + 14 1/2 Acres
Name of Producing Formation Nasa Verde - Salina Pool BLANCO - Wildcat 304.48

1. Is the Operator the only owner* in the dedicated acreage outlined on the plat below?
Yes X No _____.
2. If the answer to question one is "no," have the interests of all the owners been consolidated by communitization agreement or otherwise? Yes _____ No _____. If answer is "yes," Type of Consolidation _____
3. If the answer to question two is "no," list all the owners and their respective interests below:

Owner

Land Description

Section B

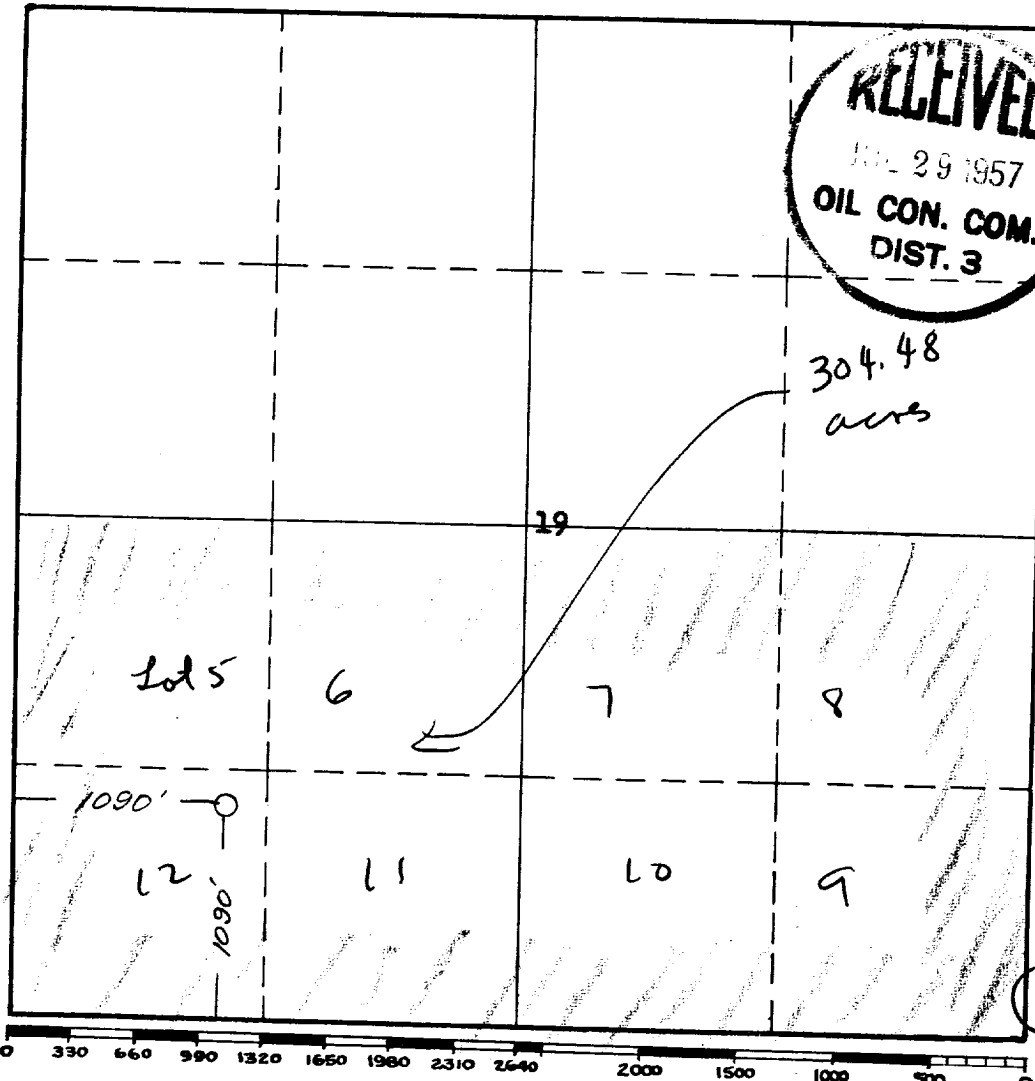

RECEIVED
JUL 29 1957
OIL CON. COM.
DIST. 3

This is to certify that the information in Section A above is true and complete to the best of my knowledge and belief.

COLORADO WESTERN EXPLORATION, INC.
(Operator)
Harry A. Trumblood, Jr., Pres.
(Representative)

312 U. S. National Bank Bldg.
Address
Denver, Colorado

This is to certify that the well location shown on the plat in Section B was plotted from field notes of actual surveys made by me or under my supervision and that the same is true and correct to the best of my knowledge and belief.

Date Surveyed 29 JUNE 1957

James P. Leese
Registered Professional
Engineer and/or Land Surveyor.

Certificate No. 1463

(See instructions for completing this form on the reverse side)

INSTRUCTIONS FOR COMPLETION:

1. Operator shall furnish and certify to the information called for in Section A.
2. Operator shall outline the dedicated acreage for both oil and gas wells on the plat in Section B.
3. A registered professional engineer or land surveyor registered in the State of New Mexico or approved by the Commission shall show on the plat the location of the well and certify this information in the space provided.
4. All distances shown on the plat must be from the outer boundaries of Section.
5. If additional space is needed for listing owners and their respective interests as required in question 3, Section A, please use space below

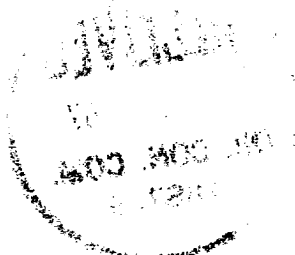

* "Owner" means the person who has the right to drill into and to produce from any pool and to appropriate the production either for himself or for himself and another. (65-3-29 (e) NMSA 1953 Comp.)