

Form. 3-331 b
(April 1952)

(SUBMIT IN TRIPLICATE)

Indian Agency Ute-Indian

UNITED STATES
DEPARTMENT OF THE INTERIOR
GEOLOGICAL SURVEY

Allottee Ute-Indian Tribal
Contract No. 14-20-604-82
Lease No. 14-20-604-82

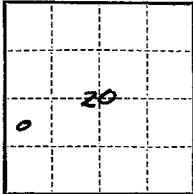

SUNDRY NOTICES AND REPORTS ON WELLS

NOTICE OF INTENTION TO DRILL	<input checked="" type="checkbox"/>	SUBSEQUENT REPORT OF WATER SHUT-OFF	
NOTICE OF INTENTION TO CHANGE PLANS		SUBSEQUENT REPORT OF SHOOTING OR ACIDIZING	
NOTICE OF INTENTION TO TEST WATER SHUT-OFF		SUBSEQUENT REPORT OF ALTERING CASING	
NOTICE OF INTENTION TO REDRILL OR REPAIR WELL		SUBSEQUENT REPORT OF REDRILLING OR REPAIR	
NOTICE OF INTENTION TO SHOOT OR ACIDIZE		SUBSEQUENT REPORT OF ABANDONMENT	
NOTICE OF INTENTION TO PULL OR ALTER CASING		SUPPLEMENTARY WELL HISTORY	
NOTICE OF INTENTION TO ABANDON WELL			

(INDICATE ABOVE BY CHECK MARK NATURE OF REPORT, NOTICE, OR OTHER DATA)

U. S. GEOLOGICAL SURVEY
FARMINGTON, NEW MEXICO

July 14, 1959

Well No. 5-20/ is located 2080 ft. from NW line and 330 ft. from W line of sec. 20
NW/4 SW/4 20 31N 14W N.M.P.M.
(1/4 Sec. and Sec. No.) (Twp.) (Range) (Meridian)
Verde Gallup San Juan New Mexico
(Field) (County or Subdivision) (State or Territory)

The elevation of the derrick floor above sea level is 5615 ft.

DETAILS OF WORK

(State names of and expected depths to objective sands; show sizes, weights, and lengths of proposed casings; indicate mudding jobs, cementing points, and all other important proposed work)

We propose to: Set 90' surface casing cemented w/100 sx. Drill to approximately 3085' Set 5 1/2" csg. at 3085' with 70 sx. run DV tool below Point Lookout and cement w/70 sx. Perforate Gallup formation Sand oil frac. Run 2-3/8" tubing and install pump.



I understand that this plan of work must receive approval in writing by the Geological Survey before operations may be commenced.

Company SOUTHERN UNION GAS COMPANY

Address P. O. Box 815

Farmington

New Mexico

By C. L. Haseltine

Title Drilling Superintendent

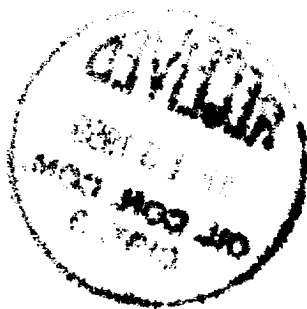

NEW MEXICO OIL CONSERVATION COMMISSION
Well Location and Acreage Dedication Plat

Section A.

Date July 13, 1959

Operator Southern Union Gas Company Lease Ute Indian
Well No. 5-20 Unit Letter L Section 20 Township 31 North Range 14 West NMPM
Located 2080 Feet From South Line, 330 Feet From West Line
County San Juan G. L. Elevation 5615 Dedicated Acreage 88 40 Acres
Name of Producing Formation Gallup Pool Verde-Gallup

1. Is the Operator the only owner* in the dedicated acreage outlined on the plat below?
Yes X No .
2. If the answer to question one is "no," have the interests of all the owners been consolidated by communitization agreement or otherwise? Yes No . If answer is "yes," Type of Consolidation
3. If the answer to question two is "no," list all the owners and their respective interests below:

Owner

Land Description

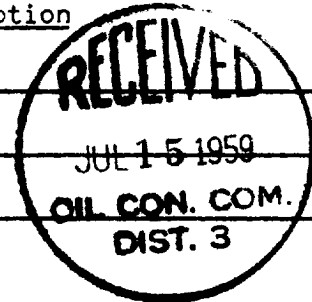

Section B

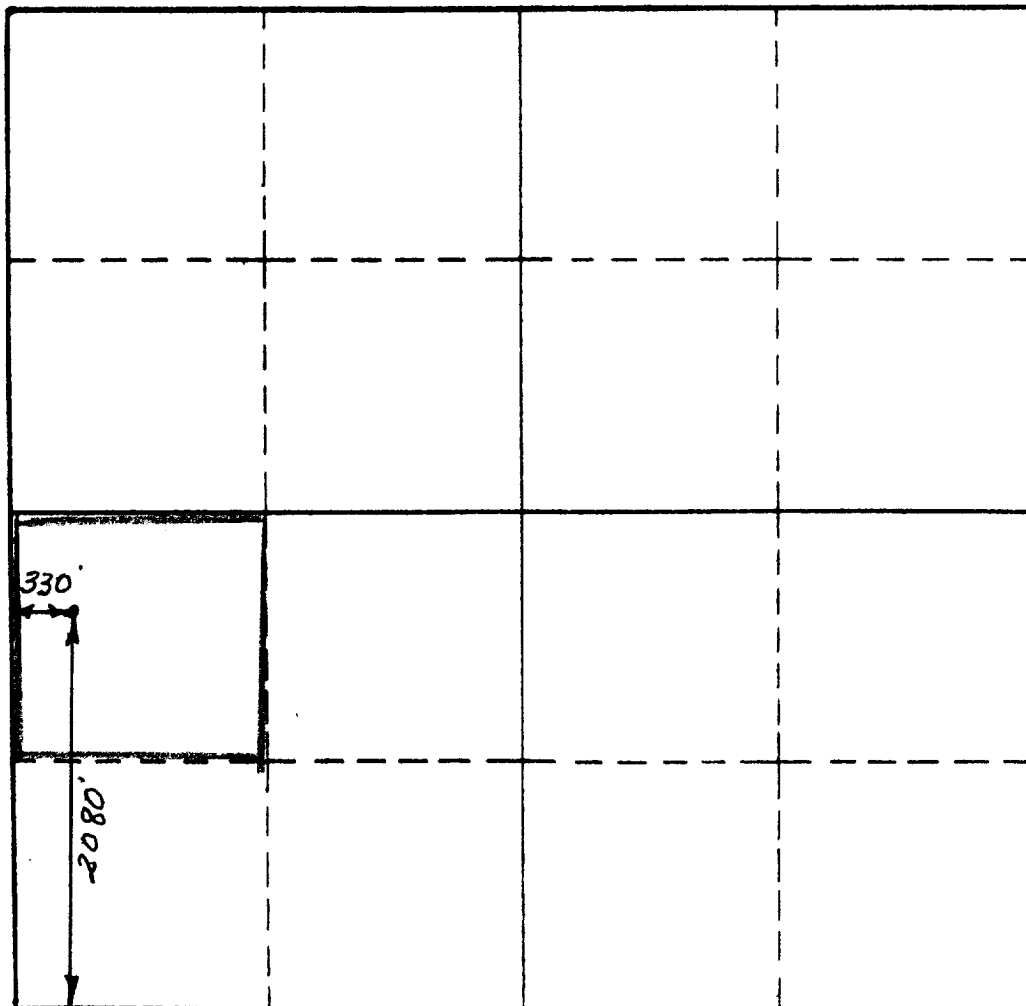

This is to certify that the information in Section A above is true and complete to the best of my knowledge and belief.

(Operator)

Oran H. Haseltine
(Representative)

Address

This is to certify that the well location shown on the plat in Section B was plotted from field notes of actual surveys made by me or under my supervision and that the same is true and correct to the best of my knowledge and belief.

Date Surveyed July 11, 1959

C. L. Potat
Registered Professional
Engineer and/or Land Surveyor.

Certificate No. 2088