

Indian Land
(SUBMIT IN TRIPLICATE)

UNITED STATES
DEPARTMENT OF THE INTERIOR
GEOLOGICAL SURVEY

Budget Bureau No. 42-R358.4
Approval expires 12-31-60.
Indian Agency Consolidate Sta
Alottee **11-20-60-33**
Lease No. **the Mountain**

SUNDRY NOTICES AND REPORTS ON WELLS

NOTICE OF INTENTION TO DRILL	<input checked="" type="checkbox"/>	SUBSEQUENT REPORT OF WATER SHUT-OFF	
NOTICE OF INTENTION TO CHANGE PLANS		SUBSEQUENT REPORT OF SHOOTING OR ACIDIZING	
NOTICE OF INTENTION TO TEST WATER SHUT-OFF		SUBSEQUENT REPORT OF ALTERING CASING	APR 17 1959
NOTICE OF INTENTION TO RE-DRILL OR REPAIR WELL		SUBSEQUENT REPORT OF RE-DRILLING OR REPAIR	
NOTICE OF INTENTION TO SHOOT OR ACIDIZE		SUBSEQUENT REPORT OF ABANDONMENT	
NOTICE OF INTENTION TO PULL OR ALTER CASING		SUPPLEMENTARY WELL HISTORY	
NOTICE OF INTENTION TO ABANDON WELL			

(INDICATE ABOVE BY CHECK MARK NATURE OF REPORT, NOTICE, OR OTHER DATA)

April 13, 1959

Well No. 3 is located 660 ft. from N line and 660 ft. from E line of sec. 16
W line of sec. 16
W/A Sec. 16 (1/4 Sec. and Sec. No.)
Ap. XII (Twp.) 11th (Range) S. 21. 21. 21. (Meridian)
Gallop (Field) San Juan (County or Subdivision) New Mexico (State or Territory)

The elevation of the G.I. ~~formation~~ above sea level is 5690 ft.

DETAILS OF WORK

(State names of and expected depths to objective sands; show sizes, weights, and lengths of proposed casings; indicate mudding jobs, cementing points, and all other important proposed work)

Propose to drill the above well to a total depth of approximately 3000'.
 We expect to test the Gallop formation @ approximately 2900', and any other
 zones that appear productive of oil or gas.
 Casing Patterns 150' of 8 5/8" cement w/150 lbs of cement
2500' of 5 1/2" cement w/200 lbs of cement

If necessary we propose to sand oil from w/75,000 gals.



I understand that this plan of work must receive approval in writing by the Geological Survey before operations may be commenced.

Company Magnolia Petroleum Company

Address Box 2406

Hotchkiss, New Mexico

By [Signature]

Title District Superintendent

NEW MEXICO OIL CONSERVATION COMMISSION
Well Location and Acreage Dedication Plat

Section A.

Date April 13, 1959

Operator MAGNOLIA PETROLEUM COMPANY Lease UTE MOUNTAIN
Well No. 3 Unit Letter _____ Section 16 Township 31N Range 11W NMPM
Located 660 Feet From West Line, 660 Feet From South Line
County San Juan G. L. Elevation 690 Dedicated Acreage 40 Acres
Name of Producing Formation Gallup Pool Verde-Gallup

1. Is the Operator the only owner in the dedicated acreage outlined on the plat below?
Yes X No _____.
2. If the answer to question one is "no," have the interests of all the owners been consolidated by communitization agreement or otherwise? Yes _____ No _____. If answer is "yes," Type of Consolidation _____
3. If the answer to question two is "no," list all the owners and their respective interests below:

Owner

Land Description

<u>Owner</u>	<u>Land Description</u>

Section B.

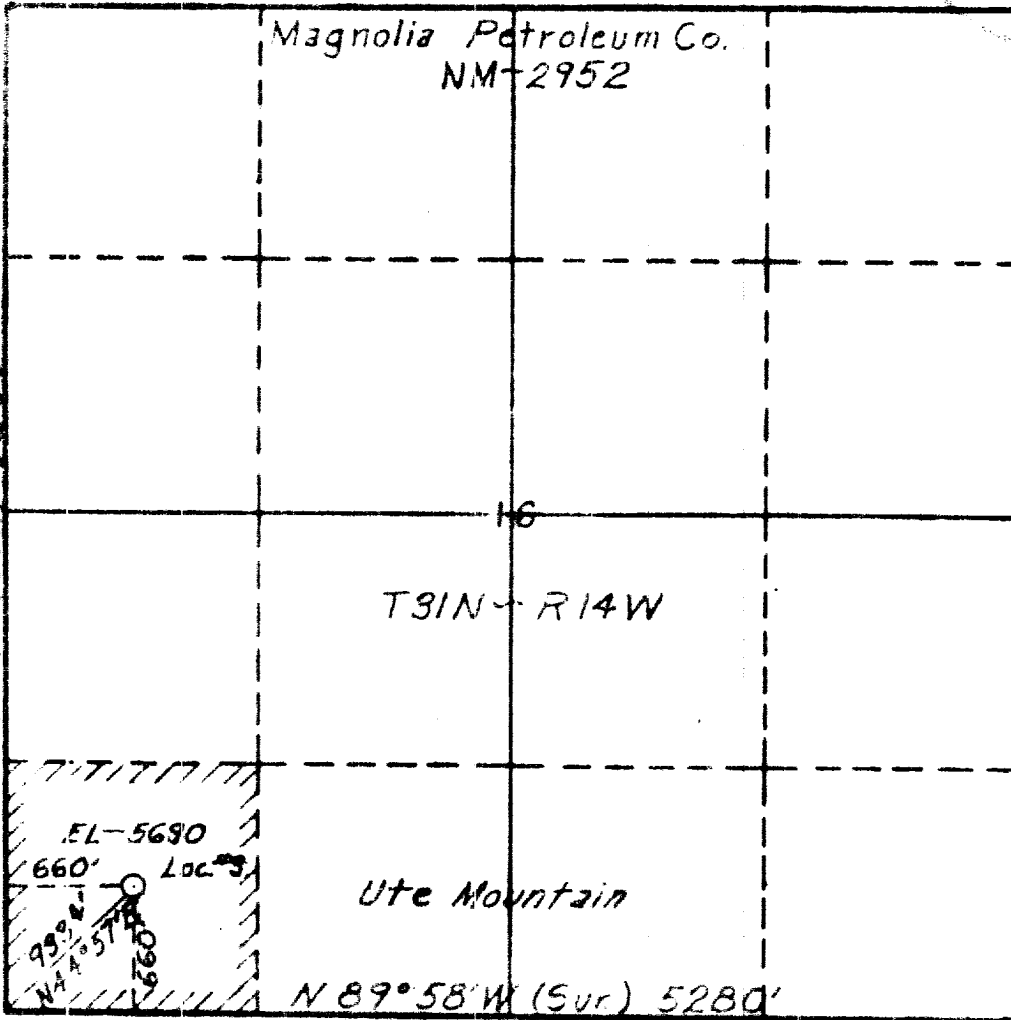

This is to certify that the information in Section A above is true and complete to the best of my knowledge and belief.

MAGNOLIA PETROLEUM COMPANY
(Operator)

(Representative)

Box 2406, Hobbs, New Mexico
Address

This is to certify that the well location shown on the plat in Section B was plotted from field notes of actual surveys made by me or under my supervision and that the same is true and correct to the best of my knowledge and belief.

Date Surveyed February 2, 1959
Carl E. Janner
Registered Professional Engineer and/or Land Surveyor.

Certificate No. 2190