

NEW MEXICO OIL CONSERVATION COMMISSION

Well Location and Acreage Dedication Plat

Section A.

Date **JANUARY 22, 1963**

Operator **ATLANTIC OIL AND REFINING CO.** Lease **NAVAJO 18-1-31-16**
Well No. **1** Unit Letter **A** Section **18** Township **31 NORTH** Range **16 WEST** NMPM
Located **360** Feet From **the NORTH** Line, **855** Feet From **the EAST** Line
County **SAN JUAN** G. L. Elevation **5675.0'** Dedicated Acreage **10.0** Acres
Name of Producing Formation **Gallup** Pool **Undesignated**

1. Is the Operator the only owner in the dedicated acreage outlined on the plat below?
Yes ☒ No ☐
2. If the answer to question one is "no", have the interests of all the owners been consolidated by communitization agreement or otherwise? Yes ☐ No ☐. If answer is "yes", Type of Consolidation.
3. If the answer to question two is "no", list all the owners and their respective interests below:

Owner

Land Description

Section B.

Note: All distances must be from outer boundaries of section.

This is to certify that the information in Section A above is true and complete to the best of my knowledge and belief.

THE ATLANTIC REFINING CO.

(Operator) -

B. J. Sartain

(Representative)

P. O. BOX 2197

(Address)

FARMINGTON, NEW MEXICO

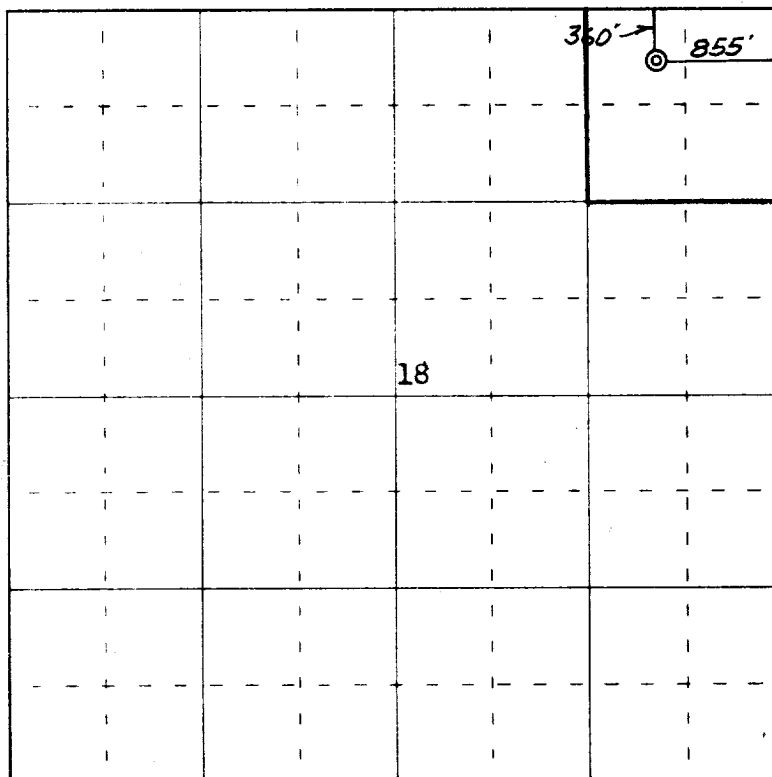

0 330 660 990 1320 1650 1980 2310 2640 2000 1500 1000 500 0

Scale 4 inches equal 1 mile

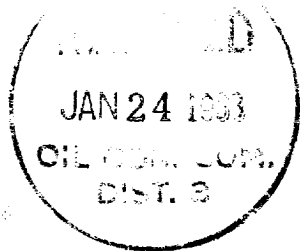

This is to certify that the above plat was prepared from field notes of actual surveys made by me or under my supervision and that the same are true and correct to the best of my knowledge and belief.

(Seal)

Date Surveyed **9 January 1963**

James P. Leese
Registered Professional Engineer and/or Land Surveyor
James P. Leese, N. Mex. Reg. No. 1463
San Juan Engineering Company

Farmington, New Mexico