

(SUBMIT IN TRIPLICATE)

Indian Agency Navajo

UNITED STATES
DEPARTMENT OF THE INTERIOR
GEOLOGICAL SURVEY

Allottee _____

Lease No. 14-32-000-0004
Co. Loc. No. 234871

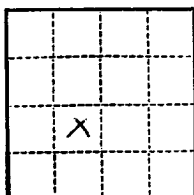

See Attached Flat

SUNDRY NOTICES AND REPORTS ON WELLS

NOTICE OF INTENTION TO DRILL	<input checked="" type="checkbox"/>	SUBSEQUENT REPORT OF WATER SHUT-OFF	
NOTICE OF INTENTION TO CHANGE PLANS		SUBSEQUENT REPORT OF SHOOTING OR ACIDIZING	
NOTICE OF INTENTION TO TEST WATER SHUT-OFF		SUBSEQUENT REPORT OF ALTERING CASING	
NOTICE OF INTENTION TO REDRILL OR REPAIR WELL		SUBSEQUENT REPORT OF REDRILLING OR REPAIR	
NOTICE OF INTENTION TO SHOOT OR ACIDIZE		SUBSEQUENT REPORT OF ABANDONMENT	
NOTICE OF INTENTION TO PULL OR ALTER CASING		SUPPLEMENTARY WELL HISTORY	
NOTICE OF INTENTION TO ABANDON WELL			

(INDICATE ABOVE BY CHECK MARK NATURE OF REPORT, NOTICE, OR OTHER DATA)

Navajo Tribe of Indians "T"

March 5, 1959

Well No. 9 is located 1900 ft. from N line and 1900 ft. from W line of sec. 10
SW/4 Sec. 10 11-S 17-W
 (1/4 Sec. and Sec. No.) (Twp.) (Range) (Meridian)
Chimney Rock San Juan New Mexico
 (Field) (County or Subdivision) (State or Territory)

The elevation of the derrick floor above sea level is later ft.

DETAILS OF WORK

(State names of and expected depths to objective sands; show sizes, weights, and lengths of proposed casings; indicate mudding jobs, cementing points, and all other important proposed work)

CASING PROGRAM
 Size 4" Length 1500'
 Weight 14#

CEMENT PROGRAM
 Circulate to surface sufficient volume
 to cement at least 500' above pay zone.

GRUING PROGRAM
 None

Completion Method: Sand oil fracture with 20,000 gal oil and 30,000# sand.
 Halliburton method of cementing to be used.
 Proposed total depth 1900' to test Gallup.

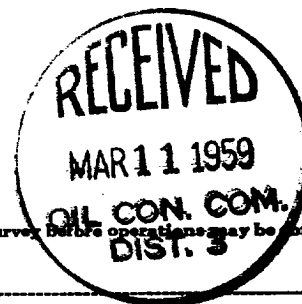

I understand that this plan of work must receive approval in writing by the Geological Survey before operations may be commenced.

Company Humble Oil & Refining Company

Address Box 1000

Midland, Texas

By [Signature]
 Title Asst. Div. Chief Clerk

NEW MEXICO OIL CONSERVATION COMMISSION
Well Location and Acreage Dedication Plat

Section A.

Date 3-4-59

Operator HUMBLE OIL & REFG CO Lease Navajo Tribe of Indians "F"
Well No. 9 Unit Letter "K" Section 10 Township -31-N Range -17-W NMPH
Located 1980 Feet From South Line, 1980- Feet From West Line
County San Juan G. L. Elevation _____ Dedicated Acreage 40 Acres
Name of Producing Formation Gallup Sand Pool Chimney Rock

1. Is the Operator the only owner* in the dedicated acreage outlined on the plat below?
Yes L No _____.
2. If the answer to question one is "no," have the interests of all the owners been consolidated by communitization agreement or otherwise? Yes _____ No _____. If answer is "yes," Type of Consolidation _____
3. If the answer to question two is "no," list all the owners and their respective interests below:

Owner

Land Description

3-4-1959

Section B

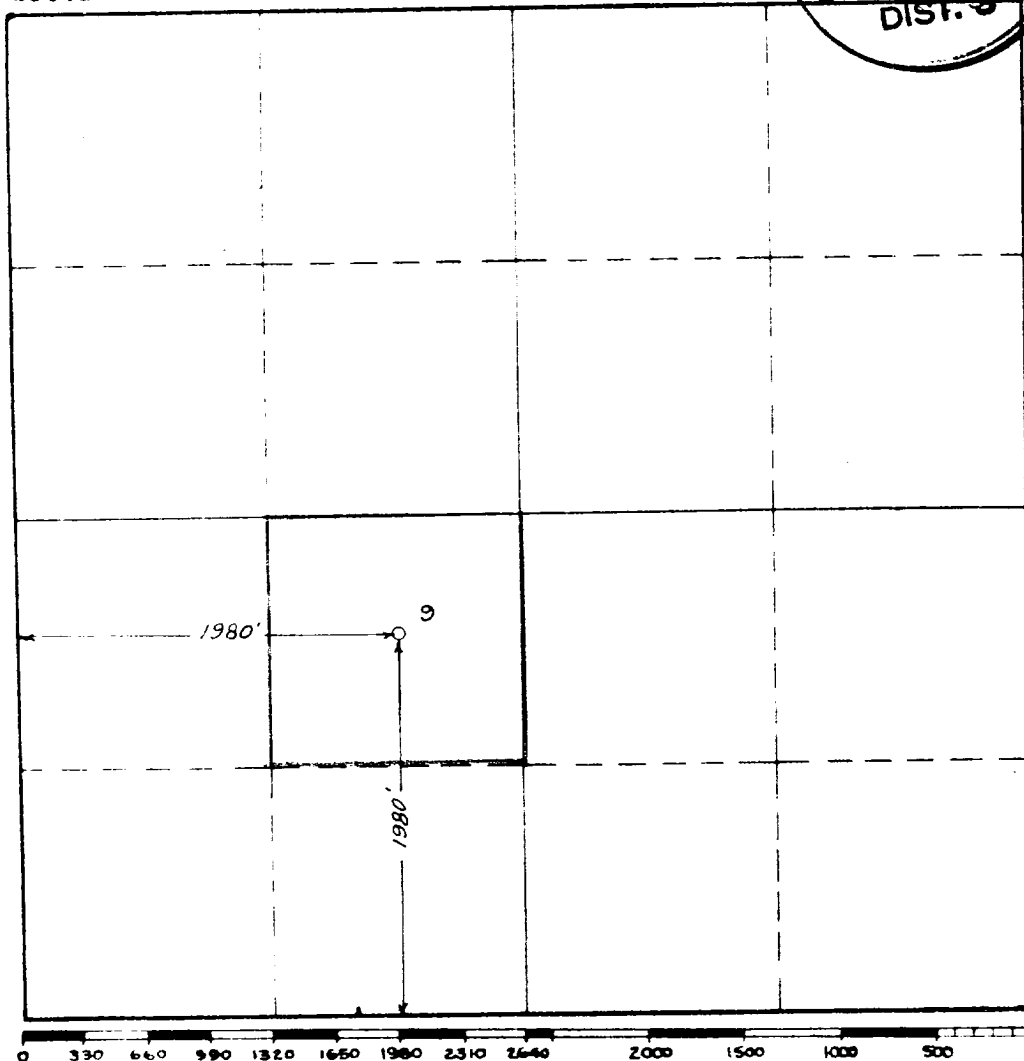

This is to certify that the information in Section A above is true and complete to the best of my knowledge and belief.

HUMBLE OIL & REFG CO
(Operator)

H L Henkel
(Representative)
Assistant Division Supt.
Box 1600 Midland, Texas
Address

This is to certify that the well location shown on the plat in Section B was plotted from field notes of actual surveys made by me or under my supervision and that the same is true and correct to the best of my knowledge and belief.

Date Surveyed 2-26-59

W. S. Winterfeld
Registered Professional
Engineer and/or Land Surveyor.

Certificate No. 1382