

# BURLINGTON RESOURCES

SAN JUAN DIVISION

August 16, 1996

Mr. William LeMay  
New Mexico Oil Conservation Division  
2040 South Pacheco Street  
Santa Fe, New Mexico 87505

Re: Davis #10  
1000'FNL, 1600'FWL Section 12, T-31-N, R-12-W, San Juan County, NM  
API #30-045-10946

Dear Mr. LeMay:

This is a request for administrative approval for downhole commingling the Blanco Mesa Verde and Basin Dakota pools in the subject well. It is intended to add the Mesa Verde formation to this Dakota well and commingle both formations.

To comply with the New Mexico Oil Conservation Division rules, Burlington Resources Oil & Gas Company is submitting the following for your approval of this commingling:

1. Form C107A - Application for Downhole Commingling;
2. C-102 plat for each zone showing its spacing unit and acreage dedication;
3. Production curve for the Dakota for at least one year;
4. Notification list of offset operators - Meridian is the surrounding operator;
5. Shut in wellhead pressure and calculated down hole pressure;
6. Nine-section plats for the Mesa Verde and Dakota.

The ownership for both the Mesa Verde and Dakota are common in this well. No notification to interest owners is required.

The allocation formula will be based off actual flow rates from the Mesa Verde and Dakota formations.

Please let me know if you require additional data.

Sincerely,



Peggy Bradfield  
Regulatory/Compliance Administrator

encs.

xc: Bureau of Land Management

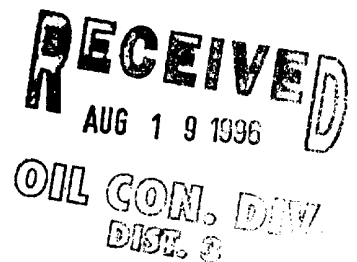

DISTRICT I

P.O. Box 1980, Hobbs, NM 88241-1980

DISTRICT II

611 South First St., Artesia, NM 88210-2835

DISTRICT III

1000 Rio Brazos Rd, Aztec, NM 87410-1893

State of New Mexico Energy, Minerals and Natural Resources Department

OIL CONSERVATION DIVISION

2040 S. Pacheco Santa Fe, New Mexico 87505-8429

Form C-107-A New 3-12-96

APPROVAL PROCESS

X Administrative Hearing

APPLICATION FOR DOWNHOLE COMMINGLING EXISTING WELLBORE

X YES NO

Burlington Resources Oil & Gas Company

PO Box 4289, Farmington, NM 87499

Operator

Address

Davis

10

C-12-31N-12W

San Juan

Lease

Well No.

Unit Ltr. - Sec - Twp - Rge

County

Spacing Unit Lease Types: (check 1 or more)

OGRID NO. 14538 Property Code 18509 API NO. 30-045-10946 Federal X State (and/or) Fee

Table with 4 columns: Upper Zone, Intermediate Zone, Lower Zone, and The following facts are submitted in support of downhole commingling. Rows include Pool Name and Pool Code, Top and Bottom of Pay Section, Type of production, Method of Production, Bottomhole Pressure, Oil Gravity, and Fixed Percentage Allocation.

RECEIVED AUG 19 1996

OIL CON. DIV. DIST. 3

9. If allocation formula is based upon something other than current or past production, or is based upon some other method, submit attachments with supporting data and/or explaining method and providing rate projections or other required data.

10. Are all working, overriding, and royalty interests identical in all commingled zones? X Yes No

If not, have all working, overriding, and royalty interests been notified by certified mail? X Yes No Have all offset operators been given written notice of the proposed downhole commingling? X Yes No

11. Will cross-flow occur? X No If yes, are fluids compatible, will the formations not be damaged, will any cross-flowed production be recovered, and will the allocation formula be reliable. X Yes No (If No, attach explanation)

12. Are all produced fluids from all commingled zones compatible with each other? X Yes No

13. Will the value of production be decreased by commingling? Yes X No (If Yes, attach explanation)

14. If this well is on, or communitized with, state or federal lands, either the Commissioner of Public Lands or the United States Bureau of Land Management has been notified in writing of this application. X Yes No

15. NMOCD Reference Cases for Rule 303(D) Exceptions: ORDER NO(S).

16. ATTACHMENTS:

- \* C-102 for each zone to be commingled showing its spacing unit and acreage dedication.
\* Production curve for each zone for at least one year. (If not available, attach explanation.)
\* For zones with no production history, estimated production rates and supporting data.
\* Data to support allocation method or formula.
\* Notification list of all offset operators.
\* Notification list of working, overriding, and royalty interests for uncommon interest cases.
\* Any additional statements, data, or documents required to support commingling.

I hereby certify that the information above is true and complete to the best of my knowledge and belief.

SIGNATURE [Signature] TITLE\_Regulatory Administrator DATE 8-2-96

TYPE OR PRINT NAME\_Peggy Bradfield TELEPHONE NO. (505) 326-9700

District I  
 PO Box 1799, Hobbs, NM 88241-1799  
 District II  
 PO Drawer DD, Artesia, NM 88211-8719  
 District III  
 1000 N. Main Rd., Aztec, NM 87410  
 District IV  
 PO Box 2088, Santa Fe, NM 87504-2088

State of New Mexico  
 Energy, Minerals & Natural Resources Department

OIL CONSERVATION DIVISION  
 PO Box 2088  
 Santa Fe, NM 87504-2088

Form C  
 Revised February 21,  
 Instructions on  
 Submit to Appropriate District Office  
 State Lease - 4 C.  
 Fee Lease - 3 C.

AMENDED REPORT

WELL LOCATION AND ACREAGE DEDICATION PLAT

APL Number 30-045-10946		Well Code 72319/71599		Well Name Blanco Mesaverde/Basin Dakota	
Property Code 18509		Property Name Davis		Well Number 10	
OGRID No. 14538		Operator Name MERIDIAN OIL INC.		Elevation 6382'	

10 Surface Location

UL or lot no.	Section	Township	Range	Lot side	Feet from line	North/South line	Feet from line	East/West line	County
C	12	31 N	12 W		1000	North	1600	West	S. J.

11 Bottom Hole Location if Different From Surface

UL or lot no.	Section	Township	Range	Lot side	Feet from line	North/South line	Feet from line	East/West line	County
W/276.90									
E/276.90									

12 Dedicated Acres 13 Jctns or Infill 14 Cancellation Code 15 Order No.

NO ALLOWABLE WILL BE ASSIGNED TO THIS COMPLETION UNTIL ALL INTERESTS HAVE BEEN CONSOLIDATED OR A NON-STANDARD UNIT HAS BEEN APPROVED BY THE DIVISION

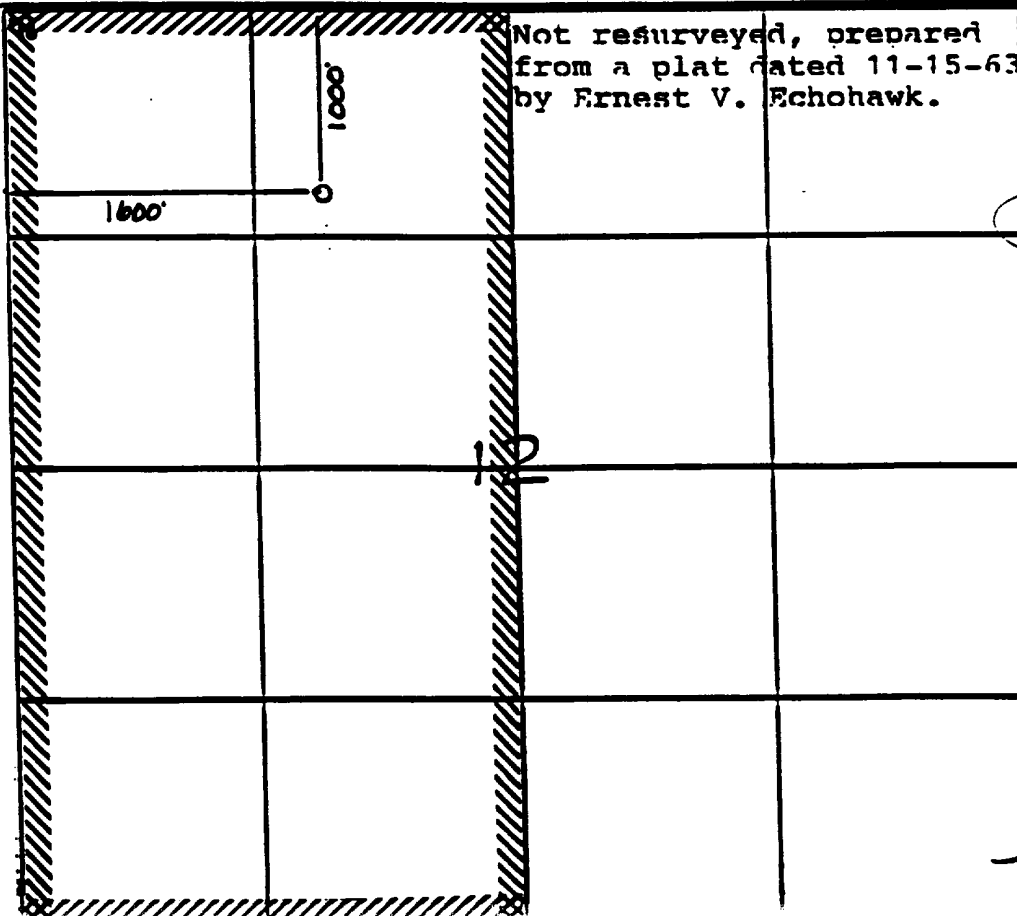

Not resurveyed, prepared from a plat dated 11-15-63 by Ernest V. Echohawk.

17 OPERATOR CERTIFICATION

I hereby certify that the information contained herein is true and complete to the best of my knowledge and belief.

*Peggy Bradford*  
 Signature  
 Peggy Bradford  
 Printed Name  
 Regulatory Administrator  
 Title  
 6-25-96  
 Date

18 SURVEYOR CERTIFICATION

I hereby certify that the well location shown on this plat was plotted from field notes of actual surveys made or under my supervision, and that the same is true and correct to the best of my belief.

6-24-96  
 Date of Survey  
 Signature of Surveyor

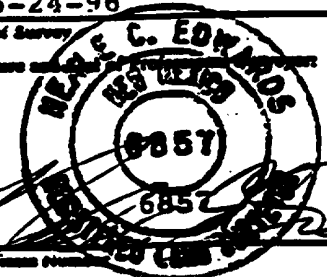

Certification Number

Prop: 253

OIL  
Bbl/d  
GAS  
MCF/D

DAVIS I 10 I : : 423 CF: 92 SIP: DAKOTA ZONE

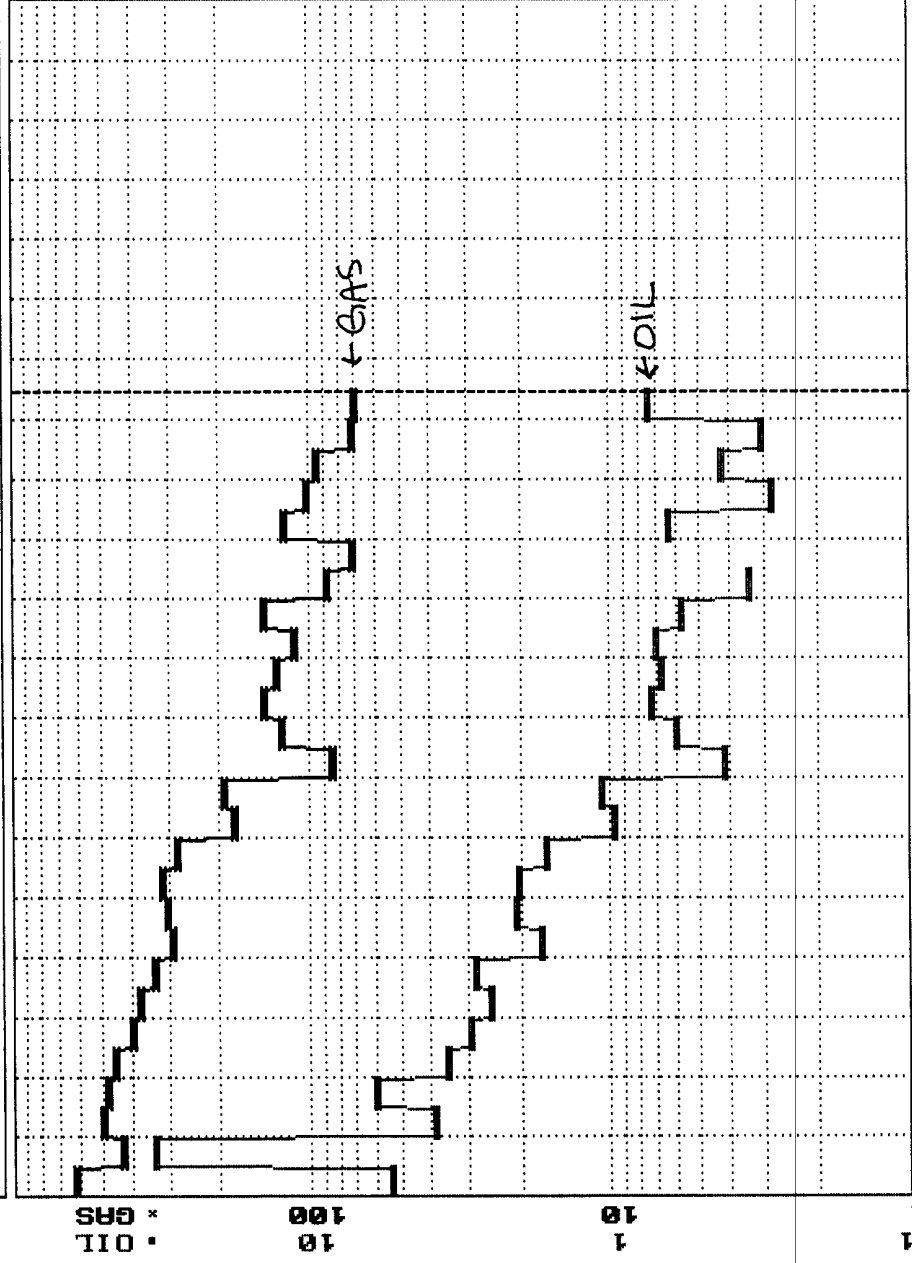

Major=GAS

# MERIDIAN OIL INC

DAVIS #10

OFFSET OPERATOR \ OWNER PLAT

Mesaverde / Dakota Formations Commingle Well

Township 31 North, Range 12 West

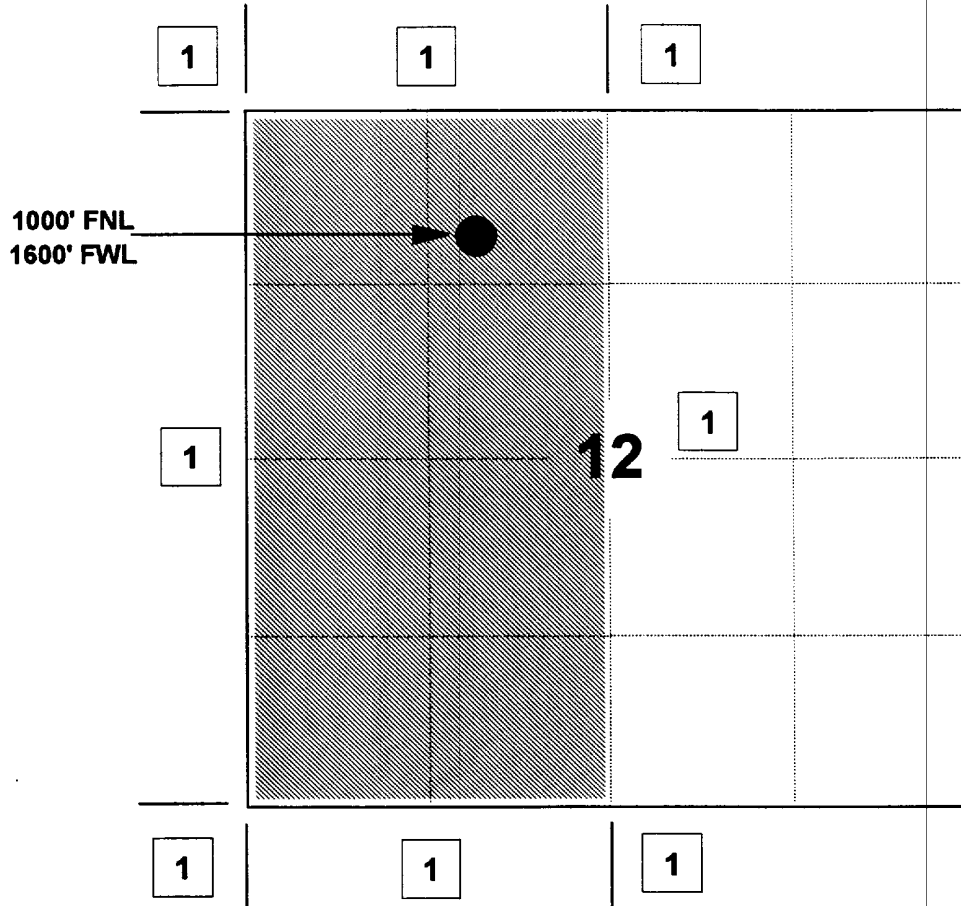

1) Meridian Oil Inc

---

---

---

---

---

---

---

---

---

---

**FLOWING AND STATIC BHP  
CULLENDER AND SMITH METHOD**

VERSION 1.0 3/13/94

GAS GRAVITY	0.65
COND. OR MISC. (C/M)	C
%N2	0.23
%CO2	2.2
%H2S	0
DIAMETER (IN)	2.441
DEPTH (FT)	7646
SURFACE TEMPERATURE (DEG F)	60
BOTTOMHOLE TEMPERATURE (DEG F)	160
FLOWRATE (MCFPD)	0
SURFACE PRESSURE (PSIA)	1983
BOTTOMHOLE PRESSURE (PSIA)	2436.2

DAVIS #10 DAKOTA - ( ORIGINAL )

**FLOWING AND STATIC BHP  
CULLENDER AND SMITH METHOD**

VERSION 1.0 3/13/94

GAS GRAVITY	0.65
COND. OR MISC. (C/M)	C
%N2	0.23
%CO2	2.2
%H2S	0
DIAMETER (IN)	2.441
DEPTH (FT)	7646
SURFACE TEMPERATURE (DEG F)	60
BOTTOMHOLE TEMPERATURE (DEG F)	160
FLOWRATE (MCFPD)	0
SURFACE PRESSURE (PSIA)	332
BOTTOMHOLE PRESSURE (PSIA)	394.4

DAVIS #10 DAKOTA - ( CURRENT )

# DAVIS #4 BLANCO MESAVERDE SECTION 12, T31N, R12W

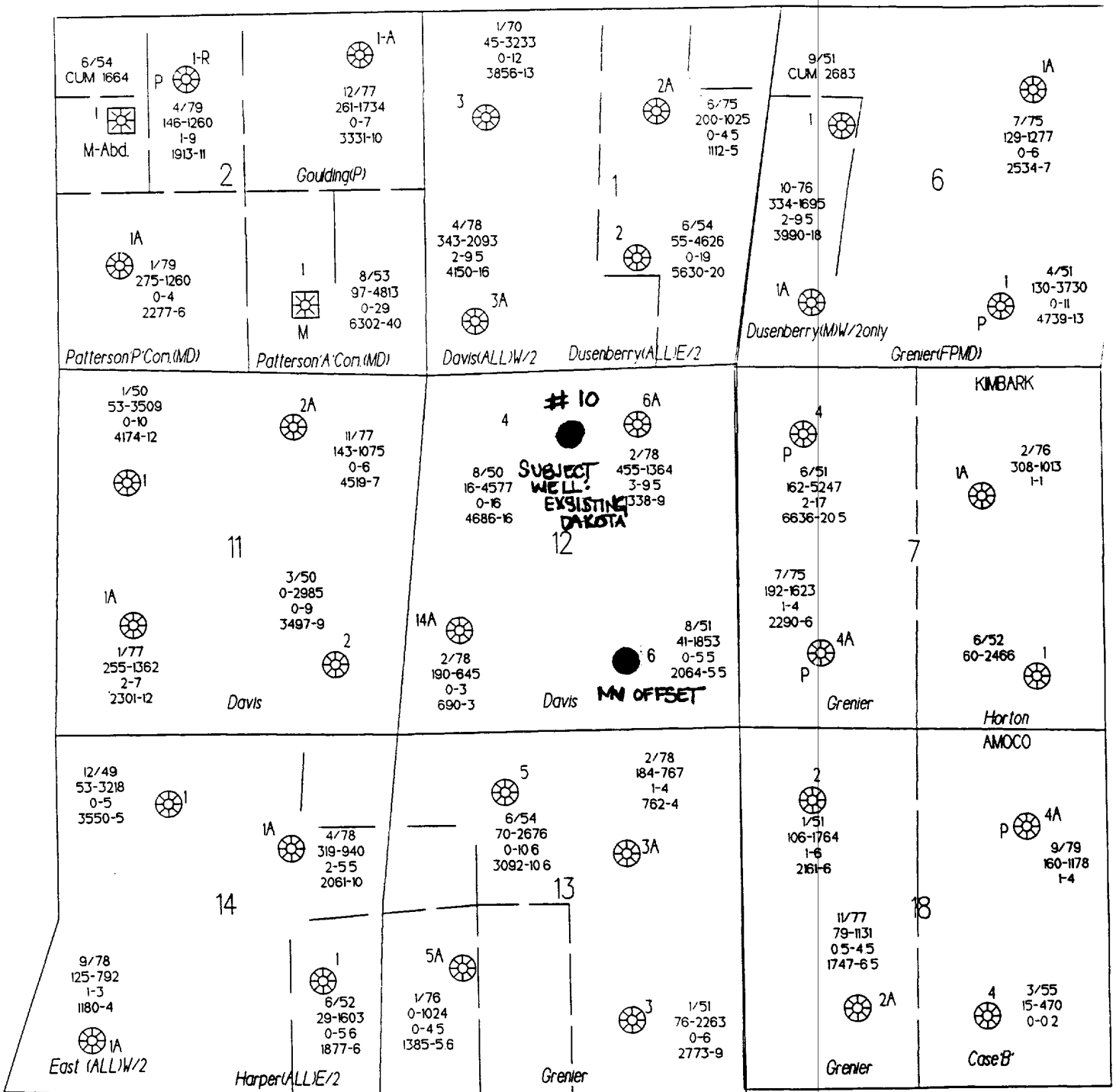

**LEGEND**

-----  
 FIRST PRODUCED  
 MCFPD - CUM (MMCF)  
 BOPD - CUM (MBO)  
 EUR\_NG - EUR\_CND

R-12-W

R-11-W