

(SUBMIT IN TRIPLICATE)

UNITED STATES
DEPARTMENT OF THE INTERIOR
GEOLOGICAL SURVEYLand Office Santa FeLease No. 078119Unit 1/2 Sec 14 is
designated as drilling unit

SUNDRY NOTICES AND REPORTS ON WELLS

NOTICE OF INTENTION TO DRILL.....	<input checked="" type="checkbox"/>	SUBSEQUENT REPORT OF WATER SHUT-OFF.....	
NOTICE OF INTENTION TO CHANGE PLANS.....		SUBSEQUENT REPORT OF SHOOTING OR ACIDIZING.....	
NOTICE OF INTENTION TO TEST WATER SHUT-OFF.....		SUBSEQUENT REPORT OF ALTERING CASING.....	
NOTICE OF INTENTION TO RE-DRILL OR REPAIR WELL.....		SUBSEQUENT REPORT OF RE-DRILLING OR REPAIR.....	
NOTICE OF INTENTION TO SHOOT OR ACIDIZE.....		SUBSEQUENT REPORT OF ABANDONMENT.....	
NOTICE OF INTENTION TO PULL OR ALTER CASING.....		SUPPLEMENTARY WELL HISTORY.....	
NOTICE OF INTENTION TO ABANDON WELL.....			

(INDICATE ABOVE BY CHECK MARK NATURE OF REPORT, NOTICE, OR OTHER DATA)

October 19, 1953

Sater Federal
Well No. 13 is located 1615' ft. from [N] line and 1630' ft. from [E] line of sec. 1411/4 Section 14 32 North 11 West N.H.P.M.
(1/4 Sec. and Sec. No.) (Twp.) (Range) (Meridian)
Blanco Mesa Verde San Juan New Mexico
(Field) (County or Subdivision) (State or Territory)ungraded ground
The elevation of the ~~section floor~~ above sea level is 6499' ft.

DETAILS OF WORK

(State names of and expected depths to objective sands; show sizes, weights, and lengths of proposed casings; indicate mudding jobs, cementing points, and all other important proposed work)

It is proposed to drill with rotary mud to the top of the Mesa Verde formation estimated to be at a depth of 4600' and thereafter to drill with gas through the Mesa Verde formation on to the top of the Mancos shale. It is further proposed to shoot the entire Mesa Verde section with solid nitroglycerine. Tentative casing program is as follows:

10 3/4" surface casing	190' - 250'	cement w/150 - 200 Sks
7" casing	4600' ±	cement w/250 - 300 Sks

A blanket drilling bond has been approved.

I understand that this plan of work must receive approval in writing by the Geological Survey before operations may be commenced.

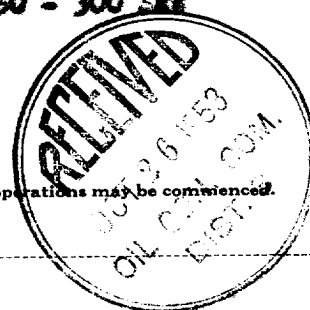
Company PURCO DEVELOPMENT, INC.Address P.O. Box 1360ALBUQUERQUE, NEW MEXICOBy F. G. Laniell, Jr.
Title Chief, Land Department

Company.....Pubco Development, Ind.....

Lease.....Pubco Suter Federal Well No. 3.....

Sec. 14....., T. 32 N....., R. 11 W., N.M.P.M.....

Location 1615' from the North line and 1630' from
the East line.

Elevation 6499 Ungraded ground.....

San Juan County

New Mexico

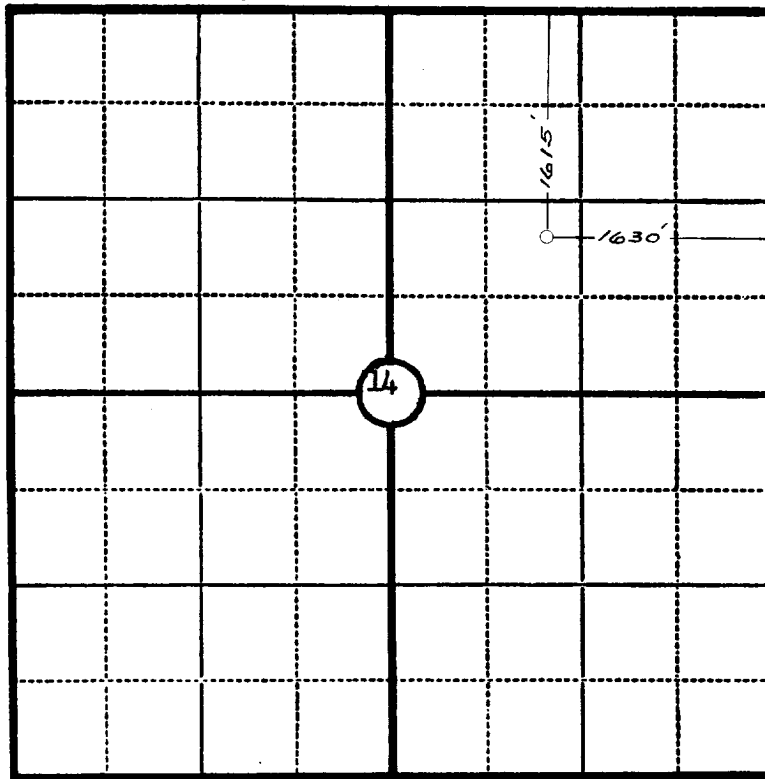

Scale—4 inches equal 1 mile.

This is to certify that the above plat was prepared from field notes of actual surveys made by me or under my supervision and that the same are true and correct to the best of my knowledge and belief.

Ernest V. Echoshawk

Seal:

Registered Professional
Engineer and Land Surveyor.

Ernest V. Echoshawk
N. Mex. Reg. No. 1545

SurveyedOctober 12....., 19.....53

