

**(SUBMIT IN TRIPLICATE)**

**Indian Agency** .....

Contract 14-20-603-124

Allottee -----

Lease No. Co. 234467-----

UNITED STATES  
DEPARTMENT OF THE INTERIOR  
GEOLOGICAL SURVEY

				X

## SUNDRY NOTICES AND REPORTS ON WELLS

NOTICE OF INTENTION TO DRILL.....	X	SUBSEQUENT REPORT OF WATER SHUT-OFF.....	
NOTICE OF INTENTION TO CHANGE PLANS.....		SUBSEQUENT REPORT OF SHOOTING OR ACIDIZING.....	
NOTICE OF INTENTION TO TEST WATER SHUT-OFF.....		SUBSEQUENT REPORT OF ALTERING CASING.....	
NOTICE OF INTENTION TO REDRILL OR REPAIR WELL.....		SUBSEQUENT REPORT OF REDRILLING OR REPAIR.....	
NOTICE OF INTENTION TO SHOOT OR ACIDIZE.....		SUBSEQUENT REPORT OF ABANDONMENT.....	
NOTICE OF INTENTION TO PULL OR ALTER CASING.....		SUPPLEMENTARY WELL HISTORY.....	
NOTICE OF INTENTION TO ABANDON WELL.....			

(INDICATE ABOVE BY CHECK MARK NATURE OF REPORT, NOTICE, OR OTHER DATA)

Ute Indians "B"

July 19, 1960

Well No. 3 is located 1980 ft. from S line and 660 ft. from E line of sec. 25

NE/4 of SE/4  
(1/4 Sec. and Sec. No.)

31-N  
(Twp.)

15-W  
(Range)

(Meridian)

Verde Gallup  
(Field)

San Juan  
(County or Subdivision)

New Mexico  
(State or Territory)

The elevation of the derrick floor above sea level is later ft.

U. S. GEOLOGICAL SURVEY  
FARMINGTON, NEW MEXICO

## DETAILS OF WORK

(State names of and expected depths to objective sands; show sizes, weights, and lengths of proposed casings; indicate mudding jobs, cementing points, and all other important proposed work)

## PROPOSED CASING PROGRAM

<u>Size</u>	<u>Wt.</u>	<u>Depth</u>	<u>New or Second Hand</u>	<u>Cementing Program</u>	<u>Method of Cmtg</u>
8-5/8	24#	100'	New	Circulate to surface.	HOWCO
5-1/2	14#	4500'			

17- (top of pay) New Circulate to above top of Point HOWCO  
Lookout at approx. 2000'. 

4" (slotted liner)	9.5#	4500' to 4600'	New	Not cemented
--------------------	------	----------------	-----	--------------

Minimum mud for samples to top of pay. Drlg pay zone with crude oil.  
Proposed total depth 4600' to test the Gallup.

**I understand that this plan of work must receive approval in writing by the Geological Survey before operations may be commenced.**

Company Humble Oil & Refining Co.

Address \_\_\_\_\_ Box 1600

Midland, Texas

By East

Title Area Adm.

STATE LEASE NO. \_\_\_\_\_  
FEDERAL LEASE NO. \_\_\_\_\_  
Indian Contract  
# 14-20-604-124

Form C-128  
Revised 5/1/57

# NEW MEXICO OIL CONSERVATION COMMISSION

## Well Location and Acreage Dedication Plat

Section A.

Date July 18, 1960

Operator Humble Oil & Refining Co Lease Ute Mountain Tribe of Indians "B"  
Well No. 3 Unit Letter "1" Section 25 Township 31 North Range 13 West NMPM  
Located 1980 Feet From South Line, 660 Feet From East Line  
County San Juan G. L. Elevation Later Dedicated Acreage 40 Acres  
Name of Producing Formation Verde-Gallup Pool Verde-Gallup

1. Is the Operator the only owner\* in the dedicated acreage outlined on the plat below?  
Yes ☒ No ☐
2. If the answer to question one is "no", have the interests of all the owners been consolidated by communitization agreement or otherwise? Yes ☐ No ☐ If answer is "yes," Type of Consolidation \_\_\_\_\_
3. If the answer to question two is "no," list all the owners and thier respective interests below:

Owner

Land Description

Section B

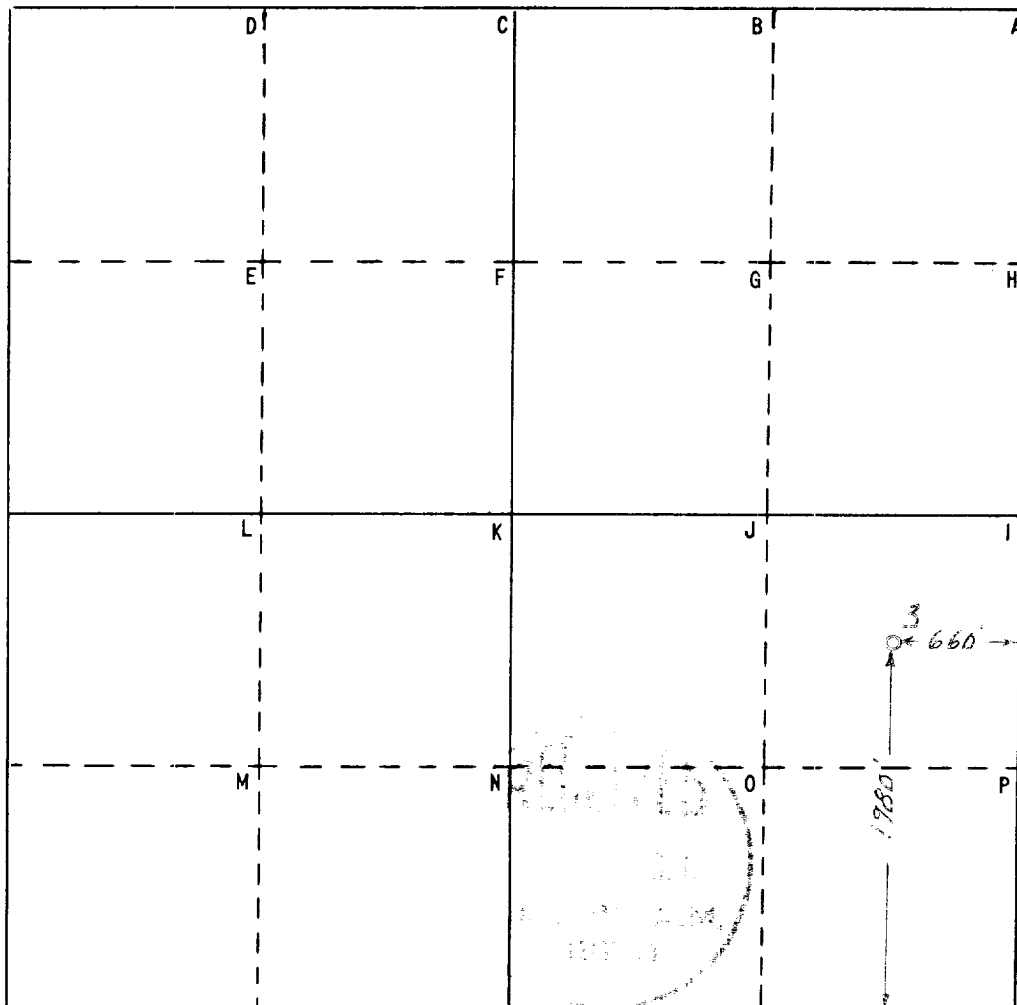

This is to certify that the information in Section A above is true and complete to the best of my knowledge and belief

HUMBLE OIL & REFG. CO.

(Operator)

H. S. Hesterfeld  
(Representative)

Box 1600 Midland, Texas  
Address

This is to certify that the well location shown on the plat in Section B was plotted from field notes of actual surveys made by me or under my supervision and that the same is true and correct to the best of my knowledge and belief.

Date Surveyed 7-16-60  
H. S. Hesterfeld  
Registered Professional  
Engineer and/or Land Surveyor

Certificate No. 1382

HUMBLE LEASE NO. 234674