

UNITED STATES
DEPARTMENT OF THE INTERIOR
GEOLOGICAL SURVEY

30-045-21166

5. LEASE DESIGNATION AND SERIAL NO.

SF 078039

6. IF INDIAN, ALLOTTEE OR TRIBE NAME

7. UNIT AGREEMENT NAME

8. FARM OR LEASE NAME

Barnes

9. WELL NO.

10

10. FIELD AND POOL, OR WILDCAT

Unders. Pictured Cliffs AX7

11. SEC., T., R., M., OR BLK.

Sec. 22, T-32-N, R-11-W

NMPM

12. COUNTY OR PARISH

San Juan

13. STATE

New Mexico

1a. TYPE OF WORK

APPLICATION FOR PERMIT TO DRILL, DEEPEN, OR PLUG BACK

DRILL ☒DEEPEN ☐PLUG BACK ☐

b. TYPE OF WELL

OIL
WELL ☐GAS
WELL ☒

OTHER

SINGLE
ZONE ☒MULTIPLE
ZONE ☐

2. NAME OF OPERATOR

El Paso Natural Gas Company

3. ADDRESS OF OPERATOR

PO Box 990, Farmington, NM 87401

4. LOCATION OF WELL (Report location clearly and in accordance with any State requirements.)*

At surface

800'S, 1736'W

At proposed prod. zone

14. DISTANCE IN MILES AND DIRECTION FROM NEAREST TOWN OR POST OFFICE*

15. DISTANCE FROM PROPOSED*

LOCATION TO NEAREST
PROPERTY OR LEASE LINE, FT.
(Also to nearest drlg. unit line, if any)

16. NO. OF ACRES IN LEASE

17. NO. OF ACRES ASSIGNED
TO THIS WELL

160.00

18. DISTANCE FROM PROPOSED LOCATION*
TO NEAREST WELL, DRILLING, COMPLETED,
OR APPLIED FOR, ON THIS LEASE, FT.

19. PROPOSED DEPTH

3400'

20. ROTARY OR CABLE TOOLS

Rotary

21. ELEVATIONS (Show whether DF, RT, GR, etc.)

6471'GR

22. APPROX. DATE WORK WILL START*

23.

PROPOSED CASING AND CEMENTING PROGRAM

SIZE OF HOLE	SIZE OF CASING	WEIGHT PER FOOT	SETTING DEPTH	QUANTITY OF CEMENT
12 1/4"	8 5/8"	24.0#	130'	107 cu. ft. to circulate
6 3/4"	2 7/8"	6.4#	3400'	568 cu. ft. to cover Ojo Alamo

Selectively perforate and sandwater fracture the Pictured Cliffs formation.

The SW/4 of Section 22 is dedicated to this well.



DEC 7 1972

U. S. GEOLOGICAL SURVEY

IN ABOVE SPACE DESCRIBE PROPOSED PROGRAM: If proposal is to deepen or plug back, give data on present productive zone and proposed new productive zone. If proposal is to drill or deepen directionally, give pertinent data on subsurface locations and measured and true vertical depths. Give blowout preventer program, if any.

24.

SIGNED

TITLE

Petroleum Engineer

DATE

December 7, 1972

(This space for Federal or State office use)

PERMIT NO.

APPROVAL DATE

APPROVED BY

TITLE

DATE

CONDITIONS OF APPROVAL, IF ANY:

**NEW MEXICO OIL CONSERVATION COMMISSION
WELL LOCATION AND ACREAGE DEDICATION PLAT**

Form 0-10,
Supersedes 0-128
Effective 1-1-65

All distances must be from the outer boundaries of the Section.

Operator EL PASO NATURAL GAS COMPANY			Lease BARNES (SF-078039)		Well No. 10
Section N	Section 22	Township 32-N	Range 11-W	County SAN JUAN	
Actual Location of Well: 800 feet from the SOUTH line on 1736 feet from the WEST line.					
Ground Level Elev. 6471	Producing Formation PICTURED CLIFFS	Pool 4173c UNDESIGNATED PICTURED CLIFFS	Dedicated Acreage 160.00 <input checked="" type="checkbox"/> Acres		

1. Outline the acreage dedicated to the subject well by colored pencil or hachure marks on the plat below.
2. If more than one lease is dedicated to the well, outline each and identify the ownership thereof (both as to working interest and royalty).
3. If more than one lease of different ownership is dedicated to the well, have the interests of all owners been consolidated by communitization, unitization, force-pooling, etc?

☐ Yes ☐ No If answer is "yes," type of consolidation _____

If answer is "no," list the owners and tract descriptions which have actually been consolidated (use reverse side of this form if necessary.) _____

No allowable will be assigned to the well until all interests have been consolidated (by communitization, unitization, forced-pooling, or otherwise) or until a non-standard unit, eliminating such interests, has been approved by the Commission.

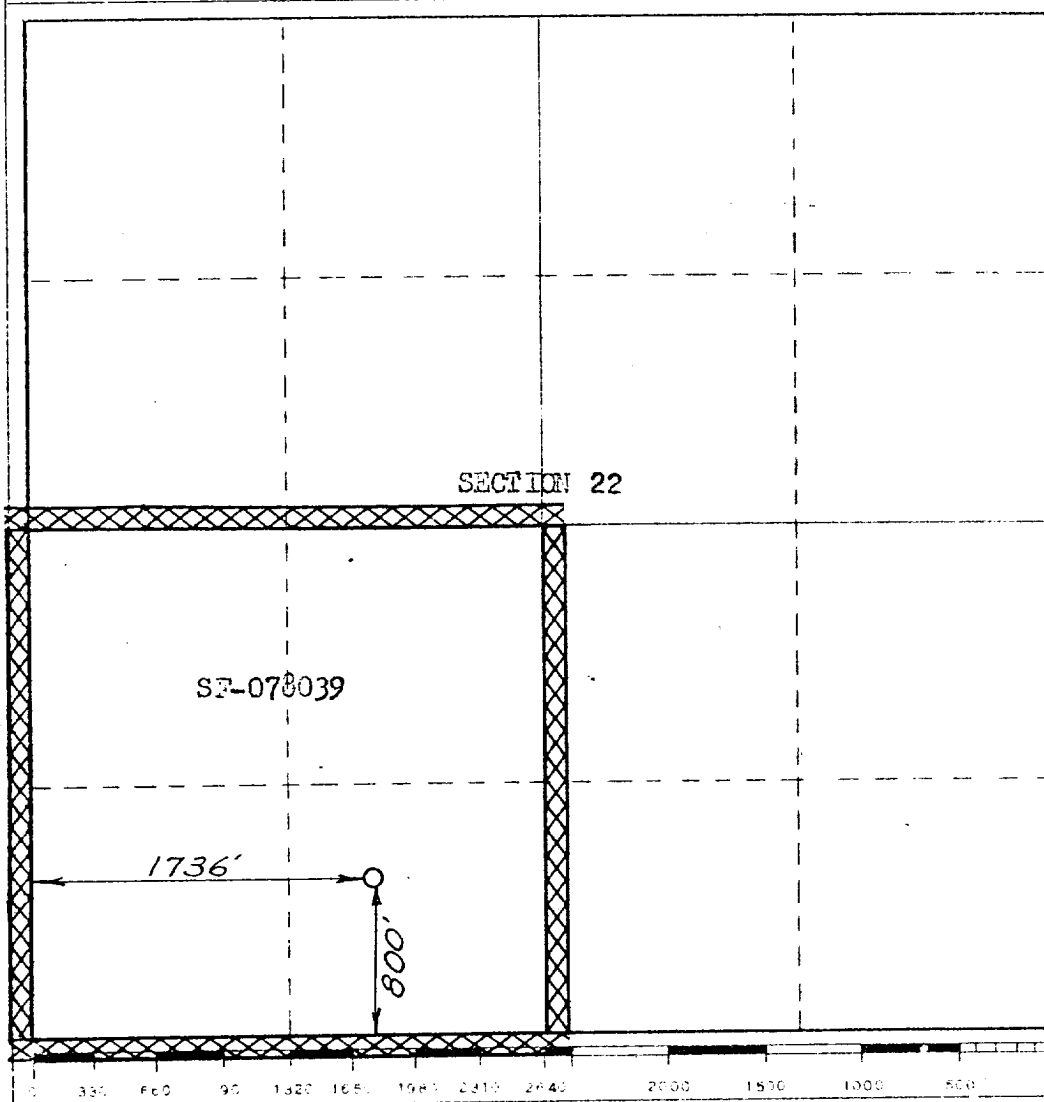

CERTIFICATION

I hereby certify that the information contained herein is true and complete to the best of my knowledge and belief.
Original Signed F. W. V. OOD

Name
Petroleum Engineer
 Location
El Paso Natural Gas Co.
 Company
December 7, 1972
 Date

I hereby certify that the well location shown on this plat was plotted from field notes of actual surveys made by me or under my supervision (and that the same is true and correct to the best of my knowledge and belief).

Date
NOVEMBER 21, 1972

Registered Professional Engineer
and State Surveyor

[Signature]
1760

NEW MEXICO OIL CONSERVATION COMMISSION
WELL LOCATION AND ACREAGE DEDICATION PLAT

Form 1-10,
Supersedes C-128
Effective 1-1-65

All distances must be from the outer boundaries of the Section.

EL PASO NATURAL GAS COMPANY			BARNES		(SF-078039)	Well No. 10
Section	22	Range	32-N	11-W	County SAN JUAN	
Section 22, Township 32-N, Range 11-W, County San Juan, New Mexico 800 feet from the SOUTH line and 1736 feet from the WEST line.						
Acres in Pool	6471	Formation	PICTURED CLIFFS		Pool	UNDESIGNATED PICTURED CLIFFS
					Consolidated Acreage	160.00

1. Outline the acreage dedicated to the subject well by colored pencil or hachure marks on the plat below.
2. If more than one lease is dedicated to the well, outline each and identify the ownership thereof (both ownership interest and royalty).
3. If more than one lease of different ownership is dedicated to the well, have the interests of all owners been consolidated by communitization, unitization, force-pooling, etc?

☐ Yes ☐ No If answer is "yes," type of consolidation _____

If answer is "no," list the owners and tract descriptions which have actually been consolidated. (Use reverse side of this form if necessary.) _____

No allowable will be assigned to the well until all interests have been consolidated (by communitization, unitization, forced-pooling, or otherwise) or until a non-standard unit, eliminating such interests, has been approved by the Commission.

CERTIFICATION

I hereby certify that the information contained herein is true and complete to the best of my knowledge and belief.

Original Signed F. H. 1 000

Name
Petroleum Engineer

Company
El Paso Natural Gas Co.

Date
December 7, 1972

I hereby certify that the well location shown on this plat was plotted from field notes of actual surveys made by me or under my supervision, and that the same is true and correct to the best of my knowledge and belief.

Date
NOVEMBER 21, 1972

[Signature]
1760

