

UNITED STATES  
DEPARTMENT OF THE INTERIOR  
GEOLOGICAL SURVEYSUBMIT IN TRIPPLICATE\*  
(Other instructions on  
reverse side)Form approved.  
Budget Bureau No. 42-R1425.

30-045-21693

## APPLICATION FOR PERMIT TO DRILL, DEEPEN, OR PLUG BACK

## 1a. TYPE OF WORK

DRILL ☒DEEPEN ☐PLUG BACK ☐

## b. TYPE OF WELL

OIL  
WELL ☐GAS  
WELL ☒

OTHER

SINGLE  
ZONE ☒MULTIPLE  
ZONE ☐

## 2. NAME OF OPERATOR

Koch Exploration Company, a Division of Koch Industries, Inc.

## 3. ADDRESS OF OPERATOR

P.O. Box 2256, Wichita, Kansas 67201

4. LOCATION OF WELL (Report location clearly and in accordance with any State requirements.)\*  
At surface1165' FSL & 790' FEL, Sec. 10-31N-10W  
At proposed prod. zone

## 14. DISTANCE IN MILES AND DIRECTION FROM NEAREST TOWN OR POST OFFICE\*

Approx. 15 miles NE of Bloomfield, New Mexico

## 15. DISTANCE FROM PROPOSED\*

LOCATION TO NEAREST  
PROPERTY OR LEASE LINE, FT.  
(Also to nearest drlg. unit line, if any)

790' FEL

## 16. NO. OF ACRES IN LEASE

315.18

17. NO. OF ACRES ASSIGNED  
TO THIS WELL

157.59

18. DISTANCE FROM PROPOSED LOCATION\*  
TO NEAREST WELL, DRILLING, COMPLETED,  
OR APPLIED FOR, ON THIS LEASE, FT.

3400'

## 19. PROPOSED DEPTH

5500'

## 20. ROTARY OR CABLE TOOLS

Rotary

## 21. ELEVATIONS (Show whether DF, RT, GR, etc.)

OR 6132'

## 22. APPROX. DATE WORK WILL START\*

March 22, 1975

## 23.

## PROPOSED CASING AND CEMENTING PROGRAM

SIZE OF HOLE	SIZE OF CASING	WEIGHT PER FOOT	SETTING DEPTH	QUANTITY OF CEMENT
13-3/4	10-3/4	40.5	200	100
8-3/4	7	20	3500	200
6-1/4	4-1/2	10.5	5500	150

- Set new 10-3/4" 40.5# K-55 ST&C csg at 200'. Press. test csg to 1000 PSI. Cement with enough cement to circulate it to the surface. WOC 24 hours.
- Drill w/water and native mud to approx. 1800'. Mud up w/Gel-Benex type mud & drill thru the Pictured Cliffs formation (3300-3500'). Set 7" 20# N-80 LT&C csg (new or tested to 5000#) at 3500'. Cement csg w/enough cement to cover the Pictured Cliffs formation. WOC 24 hours. Press. test csg & BOP's to 3000# before drilling out.
- 8" LWP Shaeffer double pipe & blind rams BOP's will be used. Check BOP's each tour & blind rams each trip.
- Drill 6-1/4" hole to TD. Set & cement 4-1/2" 10.5# H-40 new csg to TD w/BOT liner hanger, cement w/enough cement to circulate out top of liner. WOC 24 hours.
- Well head equipment will consist 2000# WP Brewster equipment for 10-3/4" surface & 7" intermediate csg.
- Mud program will be as follows:

0-200'	Gel-lime slurry
200-1800'	Water & Benex
1800-3500'	Gel-Spersene Mud

IN ABOVE SPACE DESCRIBE PROPOSED PROGRAM: If proposal is to deepen or plug back, give data on present productive zone and proposed new productive zone. If proposal is to drill or deepen directionally, give pertinent data on subsurface locations and measured and true vertical depths. Give blowout preventer program, if any.

24.

SIGNED

Orwell L. Schmitt

TITLE

Operations Manager

DATE

1-23-75

(This space for Federal or State office use)

PERMIT NO.

APPROVAL DATE

APPROVED BY

TITLE

CONDITIONS OF APPROVAL, IF ANY:

RECEIVED

FEB 3 1975

**NEW MEXICO OIL CONSERVATION COMMISSION  
WELL LOCATION AND ACREAGE DEDICATION PLAT**

Form C-102  
Supersedes C-128  
Effective 1-1-65

All distances must be from the outer boundaries of the Section.

Lessee <b>KOCH EXPLORATION COMPANY</b>			Lease <b>WALKER</b>			Well No. <b>2 A</b>		
Section <b>P</b>	Range <b>10</b>	Township <b>31 N</b>	Block <b>10 W</b>	County <b>San Juan County</b>				
Acreage Dedication of Well: 1165 feet from the <b>South</b> line and 790 feet from the <b>East</b> line of the 1165 ft. well. Producing Formation <b>MV</b> Pool <b>Blanco</b> Dedicated Acreage <b>315.18</b> Acres								

- Outline the acreage dedicated to the subject well by colored pencil or hachure marks on the plat below.
- If more than one lease is dedicated to the well, outline each and identify the ownership thereof (both as to working interest and royalty).
- If more than one lease of different ownership is dedicated to the well, have the interests of all owners been consolidated by communitization, unitization, force-pooling, etc?

☐ Yes ☐ No If answer is "yes," type of consolidation \_\_\_\_\_

If answer is "no," list the owners and tract descriptions which have actually been consolidated. (Use reverse side of this form if necessary.) \_\_\_\_\_

No allowable will be assigned to the well until all interests have been consolidated (by communitization, unitization, forced-pooling, or otherwise) or until a non-standard unit, eliminating such interests, has been approved by the Commission.

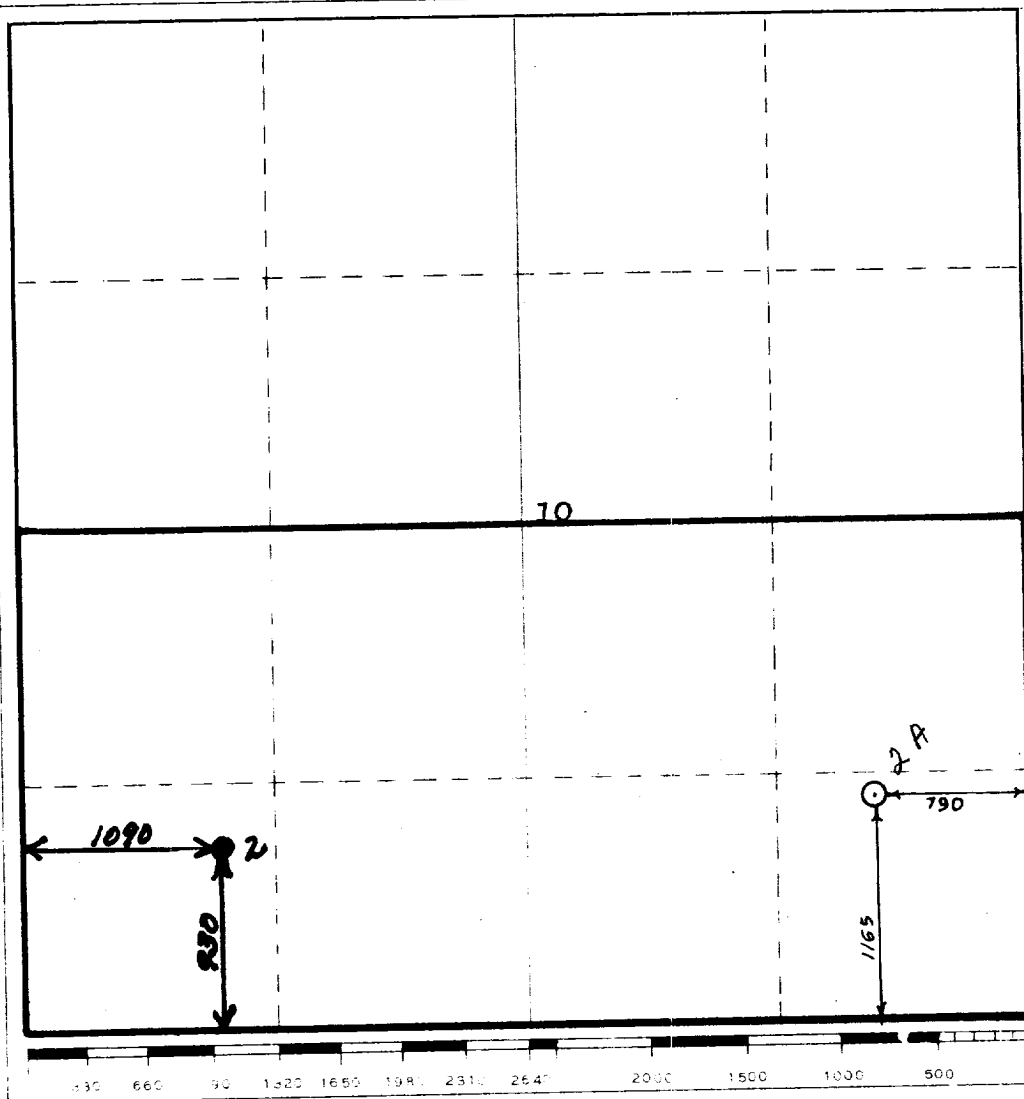

**CERTIFICATION**

I hereby certify that the information contained herein is true and complete to the best of my knowledge and belief.

Name \_\_\_\_\_

Position \_\_\_\_\_

Company \_\_\_\_\_

Date \_\_\_\_\_

I hereby certify that the well location shown on this plat was plotted from field notes of actual surveys made by me or under my supervision, and that the same is true and correct to the best of my knowledge and belief.

**Jan. 11, 1975**

Signature \_\_\_\_\_

**James P. Leese**

Registered Professional Engineer  
and Land Surveyor

*James P. Leese*  
**1463**

Certificate No. \_\_\_\_\_