



NEW MEXICO ENERGY, MINERALS
& NATURAL RESOURCES DEPARTMENT

OIL CONSERVATION DIVISION
AZTEC DISTRICT OFFICE
1000 RIO BRAZOS ROAD
AZTEC NM 87410
(505) 334-6178 FAX: (505) 334-6170
[http://emnrd.state.nm.us/ocd/District IIU3distric.htm](http://emnrd.state.nm.us/ocd/District%20IIU3distric.htm)

GARY E. JOHNSON
Governor

Jennifer A. Salisbury
Cabinet Secretary

December 22, 1998

Ms Peggy Bradfield
Burlington Resources O&G Co
PO Box 4289
Farmington NM 87499-4289

Re: Talliaferro #4E, C-21-30N-10W, API# 30-045-24452, DHC

Dear Ms Bradfield:

Your recommended allocation of commingled production for the referenced well is hereby accepted as follows:

	Gas	Oil
Mesaverde	86%	68%
Dakota	14%	32%

Yours truly,

Ernie Busch
District Geologist/Deputy O&G Inspector

cc: Jim Lovato-Farmington BLM
David Catanach-NMOCD Santa Fe
well file

talfer 4e. dhc

***BURLINGTON
RESOURCES***

SAN JUAN DIVISION

November 7, 1998

New Mexico Oil Conservation Division
1000 Rio Brazos Road
Aztec, NM 87410

Re: Talliaferro #4E
830'FNL & 1850'FWL, Section 21, T-30-N, R-10-W, San Juan
30-045-24452

Gentlemen:

The above referenced well is a Mesa Verde/Dakota commingle. Order DHC-1486 was issued for the commingling. The following allocation formula is submitted for your approval:

Mesa Verde -	86 % gas	68 % oil
Dakota -	14 % gas	32 % oil

These percentages are based on historical production from the Mesa Verde and Dakota.

Please let me know if you have any questions.

Sincerely,



Peggy Bradfield
Regulatory/Compliance Administrator

xc: Bureau of Land Management
NMOCD - Santa Fe

RECEIVED
NOV - 9 1998
OIL CON. DIV.
DIST. 3



LTR



Job separation sheet

District I
P.O. Box 1980, Hobbs, NM

District II
P.O. Drawer DD, Artesia, NM 88221

District III
1000 Rio Brazos Rd, Aztec, NM 87410

State of New Mexico
Energy, Minerals and Natural Resources Department

OIL CONSERVATION DIVISION

2040 South Pacheco Street
Santa Fe, New Mexico 87505

OK

SUBMIT 1 COPY TO
APPROPRIATE
DISTRICT OFFICE
AND 1 COPY TO
SANTA FE OFFICE

PIT REMEDIATION AND CLOSURE REPORT

Operator: PNM Gas Services (Burlington) Telephone: 324-3764

Address: 603 W. Elm Street Farmington, NM 87401

Facility or Well Name: Taliaferro #4E

Location: Unit C Sec 29 T 31 N R 12 W County San Juan

Pit Type: Separator Dehydrator Other _____

Land Type: BLM State Fee Other _____

Pit Location: Pit dimensions: length 17' width 17' depth 3'

(Attach diagram) Reference: wellhead other _____

Footage from reference: 119'

Direction from reference: 48 Degrees East North
of West South

Depth to Ground Water: <small>(Vertical distance from contaminants to seasonal high water elevation of ground water)</small>	Less than 50 feet	(20 points)	
	50 feet to 99 feet	(10 points)	
	Greater than 100 feet	(0 points)	<u>0</u>

Wellhead Protection Area: <small>(Less than 200 feet from a private domestic water source, or, less than 1,000 feet from all other water sources)</small>	Yes	(20 points)	
	No	(0 points)	<u>0</u>

Distance to Surface Water: <small>(Horizontal distance to perennial lakes, ponds, rivers, streams, creeks, irrigation canals and ditches)</small>	Less than 200 feet	(20 points)	
	200 feet to 1,000 feet	(10 points)	
	Greater than 1,000 feet	(0 points)	<u>0</u>

RANKING SCORE (TOTAL POINTS) : 0

RECEIVED
JAN 31 2002
OIL CON. DIV.
DIST. 3

Taliaferro #4E

Date Remediation Started: 06/07/1999 Date Completed: 06/08/1999

Remediation Method: Excavation X Approx. Cubic Yard 367

(Check all appropriate sections)

Landfarmed X Amount Landfarmed (cubic yds) 367

Other _____

Remediation Location: Onsite X Offsite _____

(i.e., landfarmed onsite, name and location of offsite facility)

Backfill Material Location: _____

General Description of Remedial Action:

Excavated contaminated soil to a pit size of 16' X 31' X 20' and landfarmed soil onsite within a bermed area at a depth of 6" to 12". Soil was aerated by disking/plowing until soil met regulatory levels.

Ground Water Encountered: No Yes Depth _____

Final Pit Closure Sampling:

Sample Location 5 pt composite-bottom

(if multiple samples, attach sample result and diagram of sample locations and depths.)

Sample depth 20'

Sample date 06/08/1999 Sample time 9:30:00 AM

Sample Results

Benzene (ppm) < 0.001

Total BTEX (ppm) 0.004900

Field headspace (ppm) _____

TPH (ppm) < 25.00 Method 8015B

Vertical Extent (ft) _____ Risk Analysis form attached Yes No

Ground Water Sample: Yes No (If yes, see attached Groundwater Site Summary Report)

I HEREBY CERTIFY THAT THE INFORMATION ABOVE IS TRUE AND COMPLETE TO THE BEST OF MY KNOWLEDGE AND MY BELIEF

DATE January 24, 2000

SIGNATURE Maureen Gannon

PRINTED NAME **Maureen Gannon**
AND TITLE **Project Manager**

Taliaferro #4E
 (C) 24-31N-12W
 Burlington
 6-7-44 @ 1413

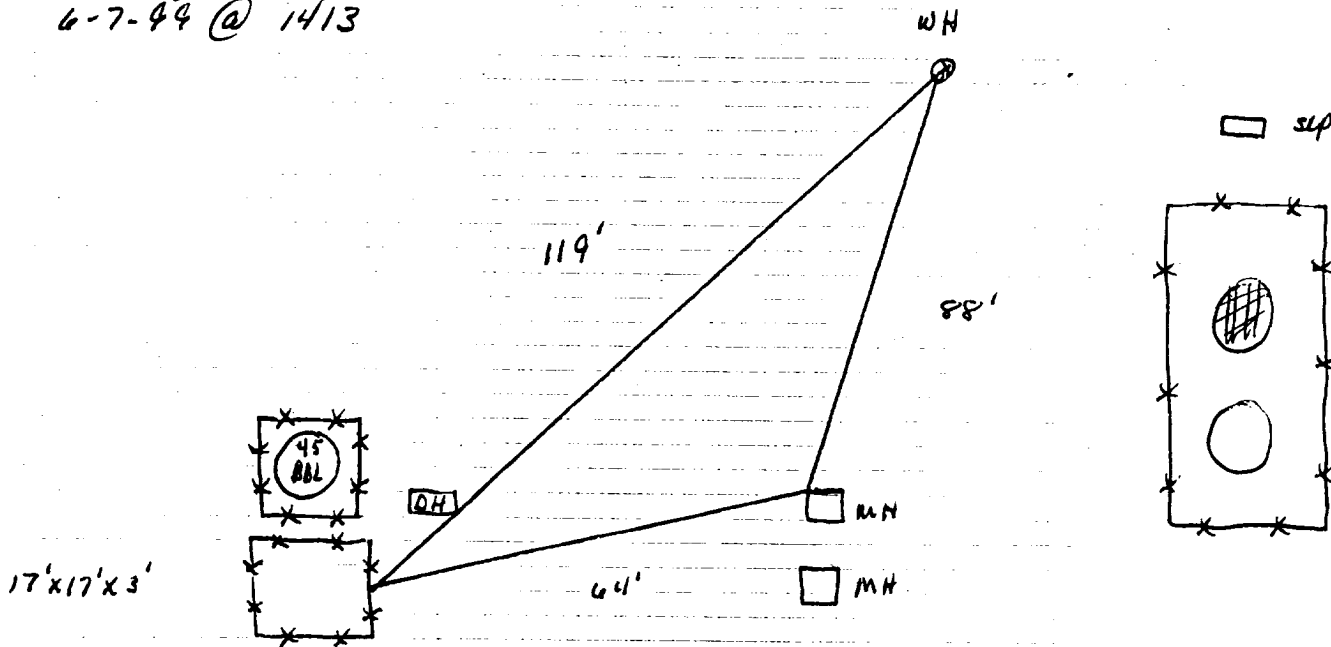

Excavation Sampling

16'(N+S) x 31'(E+W) x 20'(D)

PEO Readings

- 5' - 2999 ppm
- 10' - 2703 ppm
- 15' - 2999 ppm
- 20' - 2070 ppm

north wall sample at 18' - 2333 ppm

west wall sample at 18' - 0 ppm

East wall sample at 18' - 0 ppm

5 point composite sample of bottom at 20' - 540 ppm

south wall sample at 18' - 0 ppm

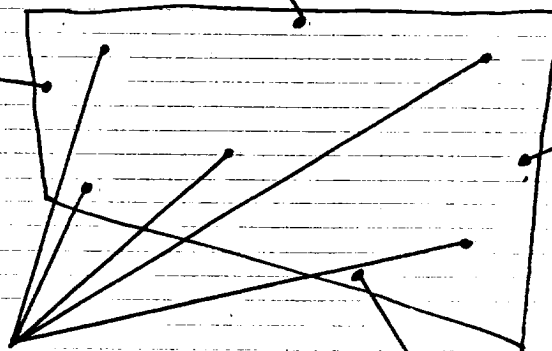

OFF: (505) 325-5667



LAB: (505) 325-1556

On Site Technologies, LTD.

Date: 23-Jun-99

CLIENT: PNM - Public Service Company of NM
Project: Taliaferro 4E & Nye Fed. 1M
Lab Order: 9906026

CASE NARRATIVE

Samples were analyzed using the methods outlined in the following references:

Test Methods for Evaluating Solid Waste, Physical/Chemical Methods, SW846, 3rd Edition

All method blanks, laboratory spikes, and/or matrix spikes met quality assurance objectives.

RH

OFF: (505) 325-5667

LAB: (505) 325-1556



ANALYTICAL REPORT

Date: 23-Jun-99

Client: PNM - Public Service Company of NM	Client Sample Info: Taliaferro 4E
Work Order: 9906026	Client Sample ID: 9906080930; 5pt. Bottom Comp
Lab ID: 9906026-01A Matrix: SOIL	Collection Date: 6/8/99 9:30:00 AM
Project: Taliaferro 4E & Nye Fed. 1M	COC Record: 7635

Parameter	Result	PQL	Qual	Units	DF	Date Analyzed
DIESEL RANGE ORGANICS		SW8015B				Analyst: DC
T/R Hydrocarbons: C10-C28	ND	25		mg/Kg	1	6/17/99
AROMATIC VOLATILES BY GC/PID		SW8021B				Analyst: DC
Benzene	ND	1		µg/Kg	1	6/14/99
Toluene	ND	2		µg/Kg	1	6/14/99
Ethylbenzene	ND	1		µg/Kg	1	6/14/99
m,p-Xylene	3.4	2		µg/Kg	1	6/14/99
o-Xylene	1.5	1		µg/Kg	1	6/14/99

4.9
 .0049

Qualifiers:	PQL - Practical Quantitation Limit	S - Spike Recovery outside accepted recovery limits
	ND - Not Detected at Practical Quantitation Limit	R - RPD outside accepted recovery limits
	J - Analyte detected below Practical Quantitation Limit	E - Value above quantitation range
	B - Analyte detected in the associated Method Blank	Surr: - Surrogate

OFF: (505) 325-5667



LAB: (505) 325-1556

ANALYTICAL REPORT

Date: 23-Jun-99

Client: PNM - Public Service Company of NM	Client Sample Info: Taliaferro 4E
Work Order: 9906026	Client Sample ID: 9906080935; 4pt. Wall Comp
Lab ID: 9906026-02A Matrix: SOIL	Collection Date: 6/8/99 9:35:00 AM
Project: Taliaferro 4E & Nye Fed. 1M	COC Record: 7635

Parameter	Result	PQL	Qual	Units	DF	Date Analyzed
-----------	--------	-----	------	-------	----	---------------

DIESEL RANGE ORGANICS		SW8015B				Analyst: DC
T/R Hydrocarbons: C10-C28	ND	25		mg/Kg	1	6/15/99

Qualifiers:	PQL - Practical Quantitation Limit	S - Spike Recovery outside accepted recovery limits
	ND - Not Detected at Practical Quantitation Limit	R - RPD outside accepted recovery limits
	J - Analyte detected below Practical Quantitation Limit	E - Value above quantitation range
	B - Analyte detected in the associated Method Blank	Surr: - Surrogate



ANALYTICAL REPORT

Date: 23-Jun-99

Client:	PNM - Public Service Company of NM	Client Sample Info:	Taliaferro 4E
Work Order:	9906026	Client Sample ID:	9906080940; North Wall Comp
Lab ID:	9906026-03A	Matrix:	SOIL
Project:	Taliaferro 4E & Nye Fed. 1M	Collection Date:	6/8/99 9:40:00 AM
		COC Record:	7635

Parameter	Result	PQL	Qual	Units	DF	Date Analyzed
DIESEL RANGE ORGANICS						
		SW8015B				Analyst: DC
T/R Hydrocarbons: C10-C28	59	25		mg/Kg	1	6/17/99
AROMATIC VOLATILES BY GC/PID						
		SW8021B				Analyst: DC
Benzene	490	250		µg/Kg	250	6/18/99
Toluene	11000	2000		µg/Kg	1000	6/14/99
Ethylbenzene	2800	1000		µg/Kg	1000	6/14/99
m,p-Xylene	27000	2000		µg/Kg	1000	6/14/99
o-Xylene	5100	1000		µg/Kg	1000	6/14/99

46390
46.39 ppm

Qualifiers:	PQL - Practical Quantitation Limit	S - Spike Recovery outside accepted recovery limits
	ND - Not Detected at Practical Quantitation Limit	R - RPD outside accepted recovery limits
	J - Analyte detected below Practical Quantitation Limit	E - Value above quantitation range
	B - Analyte detected in the associated Method Blank	Surr: - Surrogate

TALIA Ferro # 4E
Sec-29 T-31N R-12W
Burlington

LANDFARM Drawing

App 367 cu yds

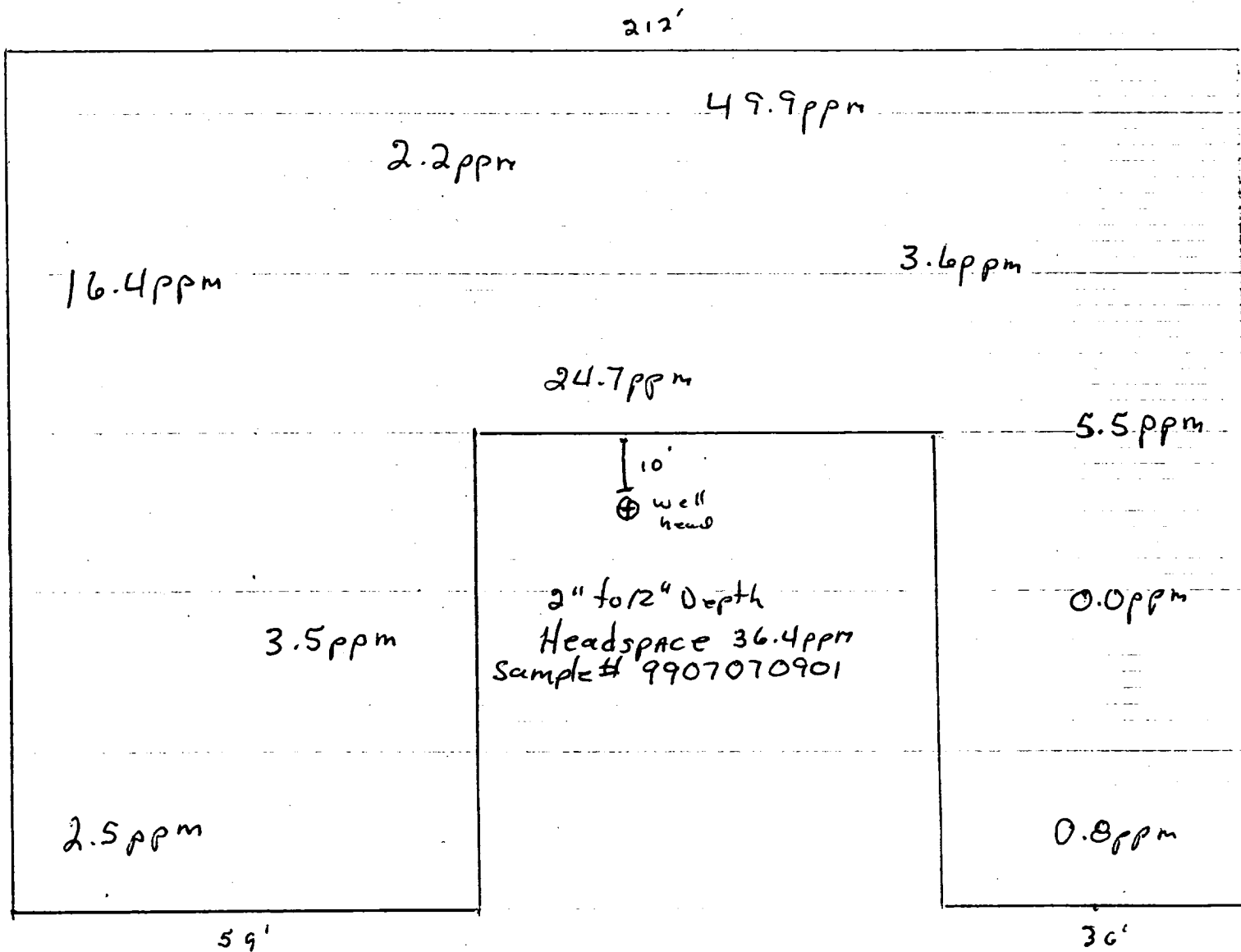

Not to Scale

OFF: (505) 325-5667



LAB: (505) 325-1556

On Site Technologies, LTD.

Date: 20-Jul-99

CLIENT: PNM - Public Service Company of NM
Project: Sadie West, Nye Fed., Taliaferro 4E & 6
Lab Order: 9907011

CASE NARRATIVE

Samples were analyzed using the methods outlined in the following references:

Test Methods for Evaluating Solid Waste, Physical/Chemical Methods, SW846, 3rd Edition

All method blanks, laboratory spikes, and/or matrix spikes met quality assurance objectives.

Key

OFF: (505) 325-5667



LAB: (505) 325-1556

ANALYTICAL REPORT

Date: 20-Jul-99

Client:	PNM - Public Service Company of NM	Client Sample Info:	Taliaferro #4E LF
Work Order:	9907011	Client Sample ID:	9907070901; 10pt Comp
Lab ID:	9907011-03A	Matrix:	SOIL
Project:	Sadie West, Nye Fed., Taliaferro 4E & 6	Collection Date:	7/7/99 9:01:00 AM
		COC Record:	7728

Parameter	Result	PQL	Qual	Units	DF	Date Analyzed
DIESEL RANGE ORGANICS		SW8015B				Analyst: DC
T/R Hydrocarbons: C10-C28	ND	25		mg/Kg	1	7/19/99

Qualifiers:	PQL - Practical Quantitation Limit	S - Spike Recovery outside accepted recovery limits
	ND - Not Detected at Practical Quantitation Limit	R - RPD outside accepted recovery limits
	J - Analyte detected below Practical Quantitation Limit	E - Value above quantitation range
	B - Analyte detected in the associated Method Blank	Surr: - Surrogate