

All distances must be from the outer boundaries of the Section.

Operator SUPRON ENERGY CORPORATION			Lease RAWSON		Well No. #2
Unit Letter B	Section 35	Township 31 NORTH	Range 12 WEST	County SAN JUAN	
Actual Footage Location of Well:					
995 feet from the NORTH line and		1520 feet from the EAST line			
Ground Level Elev. 5902	Producing Formation MESAVERDE	Pool BLANCO	Dedicated Acreage: NE/4 160.00 Acres		

1. Outline the acreage dedicated to the subject well by colored pencil or hatchure marks on the plat below.
2. If more than one lease is dedicated to the well, outline each and identify the ownership thereof (both as to working interest and royalty).
3. If more than one lease of different ownership is dedicated to the well, have the interests of all owners been consolidated by communitization, unitization, force-pooling, etc?

☐ Yes ☐ No If answer is "yes," type of consolidation _____

If answer is "no," list the owners and tract descriptions which have actually been consolidated. (Use reverse side of this form if necessary.) _____

No allowable will be assigned to the well until all interests have been consolidated (by communitization, unitization, forced-pooling, or otherwise) or until a non-standard unit, eliminating such interests, has been approved by the Division

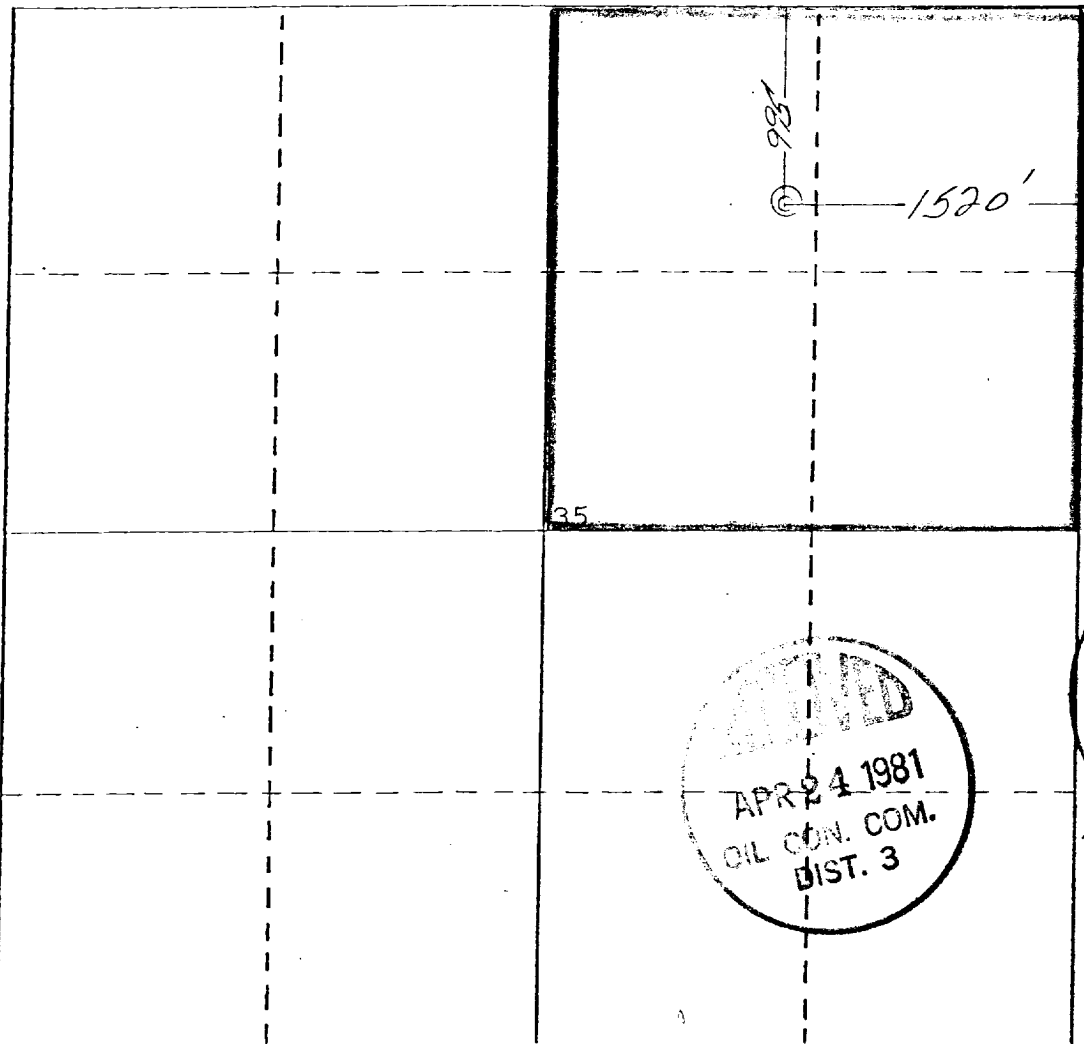

CERTIFICATION

I hereby certify that the information contained herein is true and complete to the best of my knowledge and belief.

Rudy D. Motto
Name

Rudy D. Motto

Position

Area Superintendent

Company

Supron Energy Corporation

Date

April 23, 1981

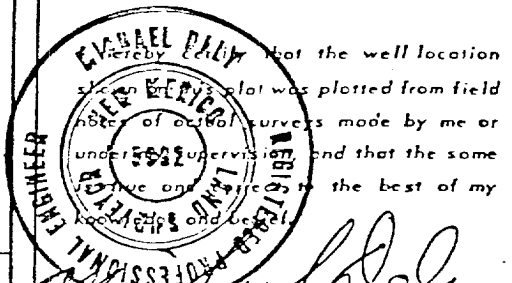

Date Surveyed

April 15, 1981

Registered Professional Engineer
and/or Land Surveyor

Michael Daly

Certificate No.

5992

