

UNITED STATES
DEPARTMENT OF THE INTERIOR
GEOLOGICAL SURVEY

30-045-25080

APPLICATION FOR PERMIT TO DRILL, DEEPEN, OR PLUG BACK

1a. TYPE OF WORK

DRILL ☒DEEPEN ☐PLUG BACK ☐

b. TYPE OF WELL

OIL
WELL ☐GAS
WELL ☒

OTHER

SINGLE
ZONE ☐MULTIPLE
ZONE ☒

2. NAME OF OPERATOR

Northwest Pipeline Corporation

3. ADDRESS OF OPERATOR

P.O. Box 90, Farmington, N.M. 87401

4. LOCATION OF WELL (Report location clearly and in accordance with any State requirements)

At surface 1085' FSL & 1820' FWL Sec 7, T32N, R7W

At proposed prod. zone Same as above

14. DISTANCE IN MILES AND DIRECTION FROM NEAREST TOWN OR POST OFFICE*

Twelve miles South of Ignacio, Colorado

15. DISTANCE FROM PROPOSED*

LOCATION TO NEAREST
PROPERTY OR LEASE LINE, FT.
(Also to nearest drilg. unit line, if any)

820

16. NO. OF ACRES IN LEASE

N/A

17. NO. OF ACRES ASSIGNED
TO THIS WELL

N 293.09 MV / 155.78 PC

18. DISTANCE FROM PROPOSED LOCATION*

TO NEAREST WELL, DRILLING COMPLETED,
OR APPLIED FOR, ON THIS LEASE, FT.

700'

19. PROPOSED DEPTH

5850'

20. ROTARY OR CABLE TOOLS

Rotary

21. ELEVATIONS (Show whether DF, RT, GR, etc.)

6435' GR

DRILLING OPERATIONS AUTHORIZED ARE
SUBJECT TO COMPLIANCE WITH ATTACHED

22. APPROX. DATE WORK WILL START*

July 1981

23. PROPOSED CASING AND CEMENTING PROGRAM
This action is subject to administrative
appeal pursuant to 30 CFR 290.

| SIZE OF HOLE | SIZE OF CASING | WEIGHT PER FOOT | SETTING DEPTH | QUANTITY OF CEMENT |
|--------------|----------------|-----------------|---------------|--------------------|
| 12-1/4" | 9-5/8" | 36# | 200' | 125 cu.ft |
| 8-3/4" | 7" | 20# | 3615' | 555 cu.ft |
| 6-1/4" | 4-1/2" | 10.5# | 5850' | 375 cu.ft |

Selectively perforate and stimulate the Mesa Verde & Pictured Cliffs Formation.
Completion plans will be determined at Total Depth

A BOP will be installed after the surface casing is set and cemented. All subsequent work will be conducted through the BOP's

The South half of the NW/4, the SW/4 of the NE/4, the W/2 of the SE/4 and the SW/4 is dedicated to the Mesa Verde well. The SW/4 of Sec 7 is dedicated to the Pictured Cliffs Well.

Gas is dedicated.

IN ABOVE SPACE DESCRIBE PROPOSED PROGRAM: If proposal is to deepen or plug back, give data on present productive zone and proposed new productive zone. If proposal is to drill or deepen directionally, give pertinent data on subsurface locations and measured and true vertical depths. Give blowout preventer program, if any.

24. SIGNED Paul C. Thompson TITLE Drilling Engineer DATE 5-4-81
Paul C. Thompson
(This space for Federal or State office use)

PERMIT NO. _____ APPROVAL DATE _____

APPROVED BY _____ TITLE _____
CONDITIONS OF APPROVAL, IF ANY:

MU NW 1/4 R-1066
write P.C. NW 1/4

*See Instructions On Reverse Side

NMOCC

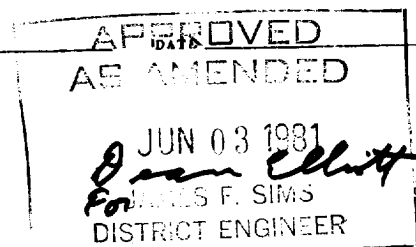

All distances must be from the outer boundaries of the Section.

| | | | | |
|---|---|-----------------------------------|---|-----------------|
| WEST PIPELINE CORPORATION | | Lease SAN JUAN 32-7 UNIT | | Well No. 41A |
| Section 7 | Township 32N | Range 7W | County San Juan | |
| Footage Location of Well: 1085 feet from the South line and 1820 feet from the West line | | | | |
| Ground Level Elev. 6435 | Producing Formation Mesa Verde/Pictured Cliffs | Pool Blanco WV/So Los Pinos PC | Dedicated Acreage: 155.78 PC 293.09 MV Acres | |

1. Outline the acreage dedicated to the subject well by colored pencil or hatchure marks on the plat below.
2. If more than one lease is dedicated to the well, outline each and identify the ownership thereof (both as to working interest and royalty).
3. If more than one lease of different ownership is dedicated to the well, have the interests of all owners been consolidated by communitization, unitization, force-pooling, etc?

☒ Yes ☐ No If answer is "yes," type of consolidation Unitization

If answer is "no," list the owners and tract descriptions which have actually been consolidated. (Use reverse side of this form if necessary.)

No allowable will be assigned to the well until all interests have been consolidated (by communitization, unitization, forced-pooling, or otherwise) or until a non-standard unit, eliminating such interests, has been approved by the Commission.

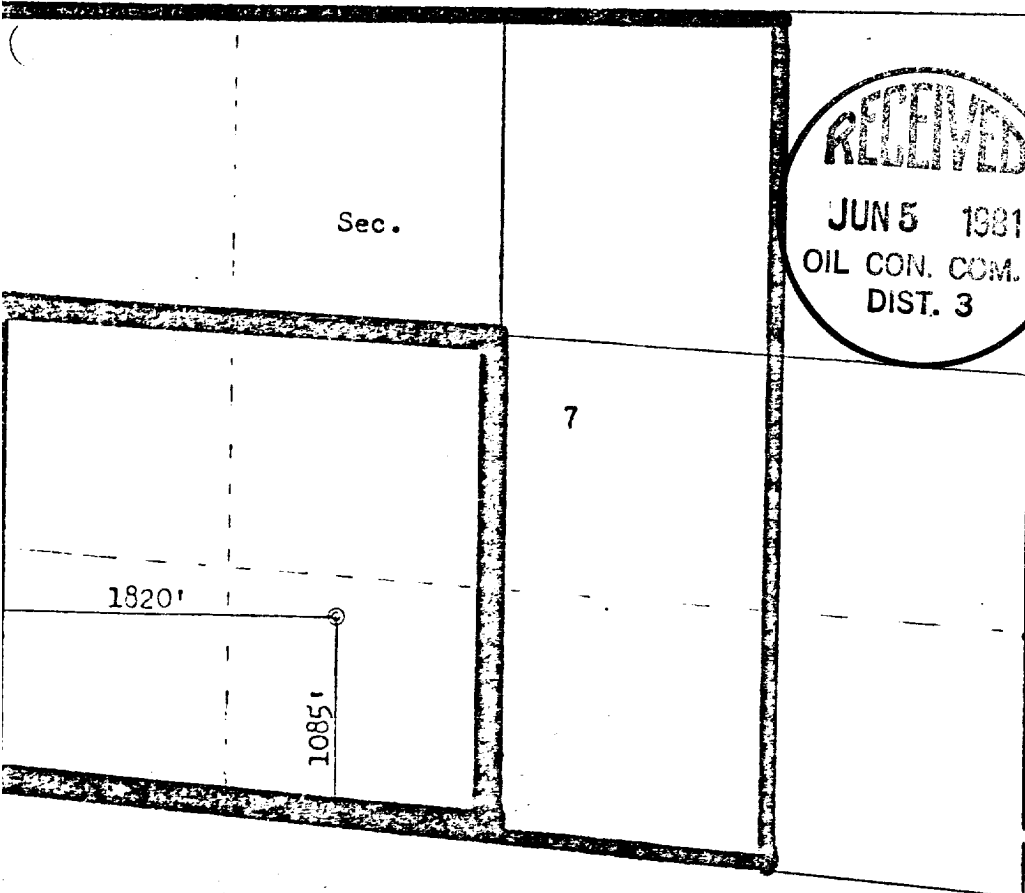

CERTIFICATION

I hereby certify that the information contained herein is true and complete to the best of my knowledge and belief.

Paul C. Thompson

Name
Paul C. Thompson

Position
Drilling Engineer

Company
Northwest Pipeline Corp.

Date
March 10, 1981

I hereby certify that the well location shown on this plat was plotted from field notes of actual surveys made by me or under my supervision, and that the same is true and correct to the best of my knowledge and belief.

Date Surveyed
February 11, 1981

Registered Professional Engineer
and Land Surveyor
Fred B. Kerr Jr.
Fred B. Kerr Jr.

Certificate No.
1000