

District I
P O Box 1980, Hobbs, NM

State of New Mexico
Energy, Minerals and Natural Resources Department

OK
SUBMIT 1 COPY TO
APPROPRIATE
DISTRICT OFFICE
AND 1 COPY TO
SANTA FE OFFICE

District II
P.O. Drawer DD, Artesia, NM 88221

OIL CONSERVATION DIVISION

District III
1000 Rio Brazos Rd, Aztec, NM 87410

2040 South Pacheco Street
Santa Fe, New Mexico 87505

PIT REMEDIATION AND CLOSURE REPORT

RECEIVED
NOV - 1 1998
OIL CON. DIV.
SANTA FE

Operator: <u>PNM Gas Services (Energen)</u>		Telephone: <u>324-3764</u>	
Address: <u>603 W. Elm Street Farmington, NM 87401</u>			
Facility or Well Name: <u>Culpepper Martin #4M</u>			
Location:	Unit <u>J</u>	Sec <u>6</u>	T <u>31 N</u> R <u>12 W</u> County <u>San Juan</u>
Pit Type:	Separator <input type="checkbox"/>	Dehydrator <input checked="" type="checkbox"/>	Other _____
Land Type:	BLM <input type="checkbox"/>	State <input type="checkbox"/>	Fee <input checked="" type="checkbox"/> Other _____
Pit Location:	Pit dimensions: length <u>17'</u> width <u>17'</u> depth <u>3'</u>		
(Attach diagram)	Reference: wellhead <input checked="" type="checkbox"/> other _____		
	Footage from reference: <u>83'</u>		
	Direction from reference: _____ Degrees <input type="checkbox"/> East _____ North _____ of <input checked="" type="checkbox"/> West _____ South <input checked="" type="checkbox"/>		
Depth to Ground Water:	Less than 50 feet	(20 points)	
	50 feet to 99 feet	(10 points)	
	Greater than 100 feet	(0 points)	<u>0</u>
<small>(Vertical distance from contaminants to seasonal high water elevation of ground water)</small>			
Wellhead Protection Area:	Yes	(20 points)	
	No	(0 points)	<u>0</u>
<small>(Less than 200 feet from a private domestic water source, or, less than 1,000 feet from all other water sources)</small>			
Distance to Surface Water:	Less than 200 feet	(20 points)	
	200 feet to 1,000 feet	(10 points)	
	Greater than 1,000 feet	(0 points)	<u>0</u>
<small>(Horizontal distance to perennial lakes, ponds, rivers, streams, creeks, irrigation canals and ditches)</small>			
RANKING SCORE (TOTAL POINTS):			<u>0</u>

Culpepper Martin #4M

Date Remediation Started: 05/18/1999 Date Completed: 05/19/1999

Remediation Method: Excavation X Approx. Cubic Yard 707
(Check all appropriate sections) Landfarmed X Amount Landfarmed (cubic yds) 607
Other 100 cu yds clean overburden

Remediation Location: Onsite X Offsite _____
(i.e., landfarmed onsite, name and location of offsite facility)

Backfill Material Location: _____

General Description of Remedial Action:

Excavated contaminated soil to a pit size of 57' X 33.5' X 10' and landfarmed soil onsite within a bermed area at a depth of .
Soil was aerated by plowing until soil met regulatory levels.

Ground Water Encountered: No Yes Depth _____

Final Pit Closure Sampling:

Sample Location 5 point composite - bottom.

(if multiple samples, attach sample result and diagram of sample locations and depths.)

Sample depth 10'

Sample date 05/19/1999 Sample time 7:40:00 AM

Sample Results

Benzene (ppm) < 0.025

Total BTEX (ppm) 0.692

Field headspace (ppm) _____

TPH (ppm) 33.00 Method 8015B

Vertical Extent (ft) _____ Risk Analysis form attached Yes No

Ground Water Sample: Yes No (If yes, see attached Groundwater Site Summary Report)

I HEREBY CERTIFY THAT THE INFORMATION ABOVE IS TRUE AND COMPLETE TO THE BEST OF MY KNOWLEDGE AND MY BELIEF

DATE October 28, 1999

SIGNATURE Maureen Gannon

PRINTED NAME Maureen Gannon
AND TITLE Project Manager

Culpeper Martin #4M

N

(J) 6-31N-12W

Evergen

5-18-99 @ 918

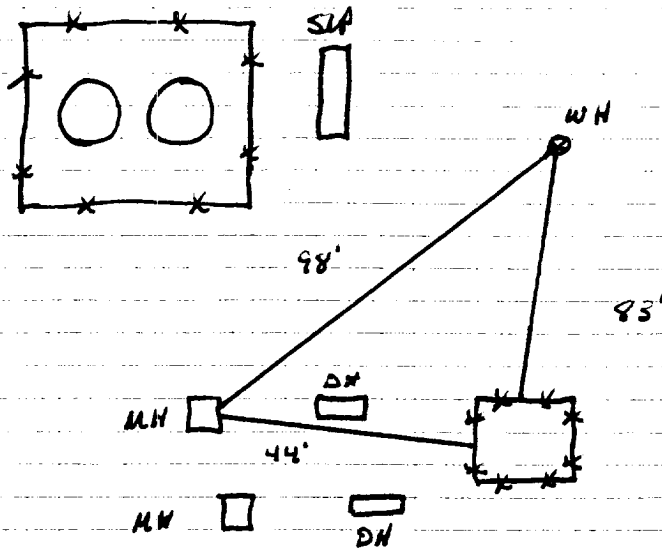

Excavation Sampling

57'(N+S) x 33.5'(E+W) x 10'(D)

PID Readings

Field Headspace: O₂ walls - Composite

5' - 2604 ppm

north wall sample at 10' - 0 ppm

10' - 1366 ppm

West wall sample at 10' - 184 ppm

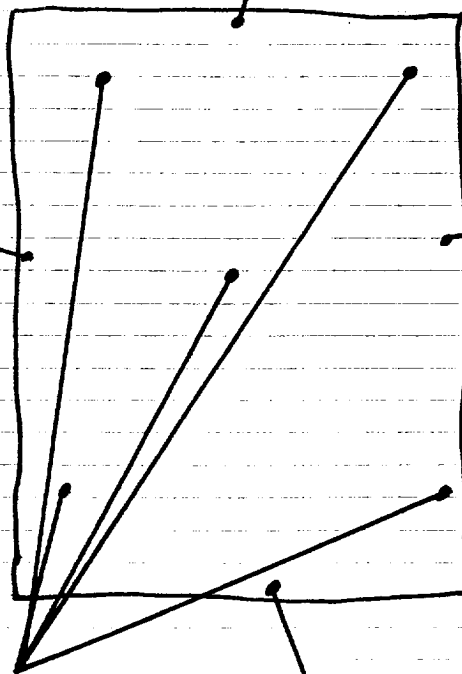

5 point bottom composite sample at 10' - 764 ppm

South wall sample at 10' - 205 ppm

not to scale

OFF: (505) 325-5667



LAB: (505) 325-1556

On Site Technologies, LTD.

Date: 02-Jun-99

CLIENT: PNM - Public Service Company of NM

Project: Culpepper Martin #4M

Lab Order: 9905068

CASE NARRATIVE

Samples were analyzed using the methods outlined in the following references:

Test Methods for Evaluating Solid Waste, Physical/Chemical Methods, SW846, 3rd Edition

All method blanks, laboratory spikes, and/or matrix spikes met quality assurance objectives.

RAY

OFF: (505) 325-5667

LAB: (505) 325-1556



ANALYTICAL REPORT

Date: 02-Jun-99

Client: PNM - Public Service Company of NM	Client Sample Info: Culpepper Martin #4M
Work Order: 9905068	Client Sample ID: 9905190740; 5pt. Bottom Comp
Lab ID: 9905068-01A Matrix: SOIL	Collection Date: 5/19/99 7:40:00 AM
Project: Culpepper Martin #4M	COC Record: 7626

Parameter	Result	PQL	Qual	Units	DF	Date Analyzed
DIESEL RANGE ORGANICS		SW8015B				Analyst: DC
T/R Hydrocarbons: C10-C28	33	25		mg/Kg	1	5/26/99
AROMATIC VOLATILES BY GC/PID		SW8021B				Analyst: DM
Benzene	ND	25		µg/Kg	25	5/28/99
Toluene	ND	50		µg/Kg	25	5/28/99
Ethylbenzene	42	25		µg/Kg	25	5/28/99
m,p-Xylene	520	50		µg/Kg	25	5/28/99
o-Xylene	130	25		µg/Kg	25	5/28/99

692
 .692 ppm

Qualifiers:	PQL - Practical Quantitation Limit	S - Spike Recovery outside accepted recovery limits
	ND - Not Detected at Practical Quantitation Limit	R - RPD outside accepted recovery limits
	J - Analyte detected below Practical Quantitation Limit	E - Value above quantitation range
	B - Analyte detected in the associated Method Blank	Surr: - Surrogate

OFF: (505) 325-5667



LAB: (505) 325-1556

ANALYTICAL REPORT

Date: 02-Jun-99

Client:	PNM - Public Service Company of NM	Client Sample Info:	Culpepper Martin #4M
Work Order:	9905068	Client Sample ID:	9905190745; 4pt. Wall Comp
Lab ID:	9905068-02A	Matrix:	SOIL
Project:	Culpepper Martin #4M	Collection Date:	5/19/99 7:45:00 AM
		COC Record:	7626

Parameter	Result	PQL	Qual	Units	DF	Date Analyzed
DIESEL RANGE ORGANICS		SW8015B				Analyst: DC
T/R Hydrocarbons: C10-C28	ND	25		mg/Kg	1	5/25/99

Qualifiers:	PQL - Practical Quantitation Limit	S - Spike Recovery outside accepted recovery limits
	ND - Not Detected at Practical Quantitation Limit	R - RPD outside accepted recovery limits
	J - Analyte detected below Practical Quantitation Limit	E - Value above quantitation range
	B - Analyte detected in the associated Method Blank	Surr: - Surrogate

Sec-6' T-31N R-12W 4L-5
Burlington

Landfarm Drawing #1

APP 407.22

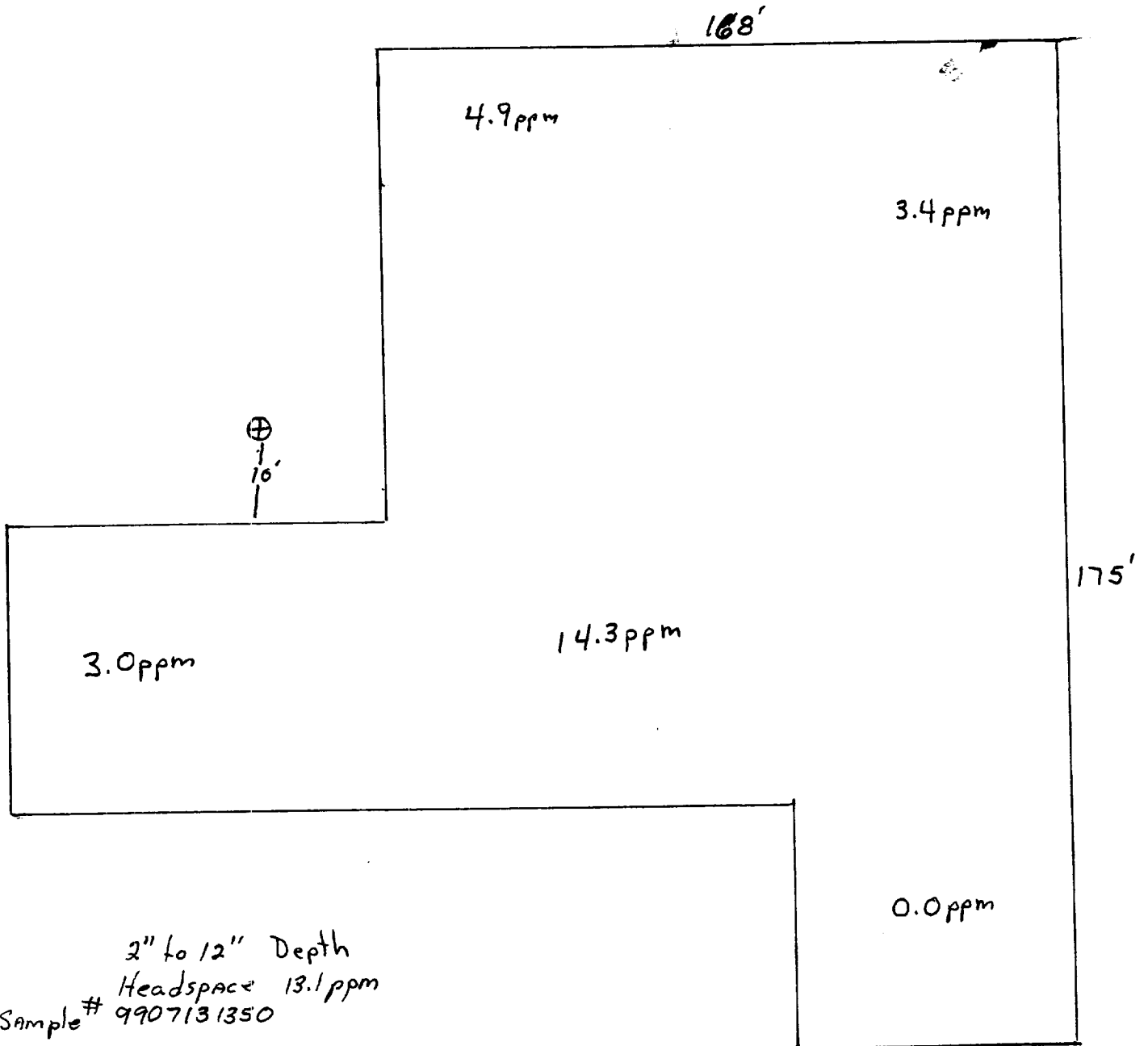

OFF: (505) 325-5667



LAB: (505) 325-1556

On Site Technologies, LTD.

Date: 21-Jul-99

CLIENT: PNM - Public Service Company of NM

Project: PNM Pit Remediation Landfarms

Lab Order: 9907034

CASE NARRATIVE

Samples were analyzed using the methods outlined in the following references:

Test Methods for Evaluating Solid Waste, Physical/Chemical Methods, SW846, 3rd Edition

All method blanks, laboratory spikes, and/or matrix spikes met quality assurance objectives.

Ray

OFF: (505) 325-5667



LAB: (505) 325-1556

ANALYTICAL REPORT

Date: 21-Jul-99

Client:	PNM - Public Service Company of NM	Client Sample Info:	Culpepper Martin #4M LF
Work Order:	9907034	Client Sample ID:	9907131350; 5pt. Comp
Lab ID:	9907034-03A	Matrix:	SOIL
Project:	PNM Pit Remediation Landfarms	Collection Date:	7/13/99 1:50:00 PM
		COC Record:	7734

Parameter	Result	PQL	Qual	Units	DF	Date Analyzed
DIESEL RANGE ORGANICS		SW8015B				Analyst: DC
T/R Hydrocarbons: C10-C28	ND	25		mg/Kg	1	7/14/99

Qualifiers:

PQL - Practical Quantitation Limit	S - Spike Recovery outside accepted recovery limits
ND - Not Detected at Practical Quantitation Limit	R - RPD outside accepted recovery limits
J - Analyte detected below Practical Quantitation Limit	E - Value above quantitation range
B - Analyte detected in the associated Method Blank	Surr: - Surrogate

Culpepper Martin 4M
Sec 6 T31N R12W ULS
Burlington

Landfarm Drawing #2
App 200 Cu. yds

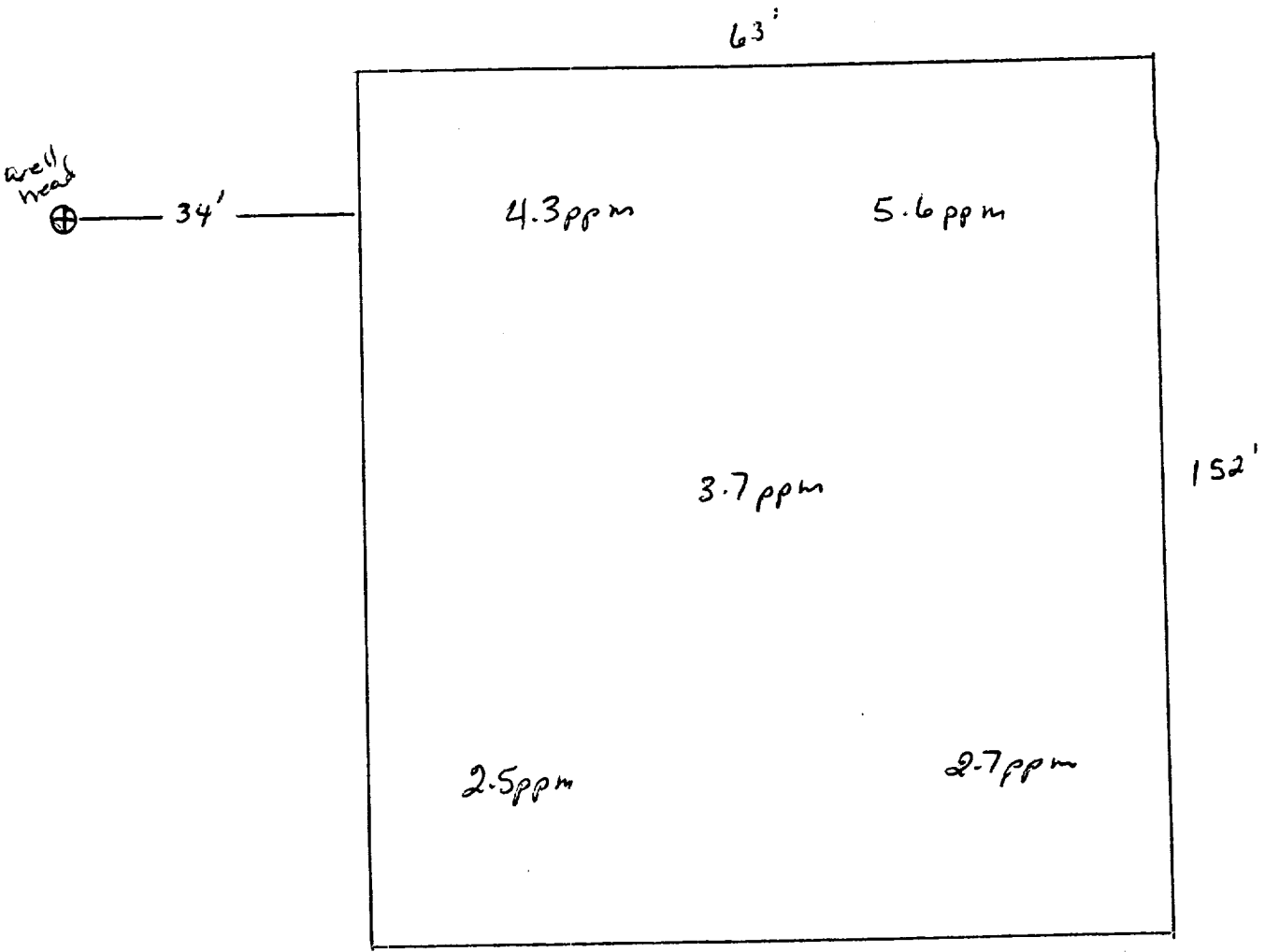

2" to 12" Depth
Headspace 20.7 ppm
Sample # 9908050945

Not to Scale

OFF: (505) 325-5667



LAB: (505) 325-1556

On Site Technologies, LTD.

Date: 11-Aug-99

CLIENT: PNM - Public Service Company of NM
Project: PNM Pit Remediation Landfarms
Lab Order: 9908009

CASE NARRATIVE

Samples were analyzed using the methods outlined in the following references:

Test Methods for Evaluating Solid Waste, Physical/Chemical Methods, SW846, 3rd Edition

All method blanks, laboratory spikes, and/or matrix spikes met quality assurance objectives.

OFF: (505) 325-5667



LAB: (505) 325-1556

ANALYTICAL REPORT

Date: 11-Aug-99

Client:	PNM - Public Service Company of NM	Client Sample Info:	Culpepper Martin #4M LF #2
Work Order:	9908009	Client Sample ID:	9908050945; 5pt Composite
Lab ID:	9908009-04A	Matrix:	SOIL
Project:	PNM Pit Remediation Landfarms	Collection Date:	08/05/1999 9:45:00 AM
		COC Record:	7803

Parameter	Result	PQL	Qual	Units	DF	Date Analyzed
DIESEL RANGE ORGANICS		SW8015B				Analyst: DC
T/R Hydrocarbons: C10-C28	ND	25		mg/Kg	1	08/09/1999

Qualifiers:	PQL - Practical Quantitation Limit	S - Spike Recovery outside accepted recovery limits
	ND - Not Detected at Practical Quantitation Limit	R - RPD outside accepted recovery limits
	J - Analyte detected below Practical Quantitation Limit	E - Value above quantitation range
	B - Analyte detected in the associated Method Blank	Surr: - Surrogate