

30-045-26789

UNITED STATES DEPARTMENT OF THE INTERIOR GEOLOGICAL SURVEY

APPLICATION FOR PERMIT TO DRILL, DEEPEN, OR PLUG BACK

1a. TYPE OF WORK: DRILL [X] DEEPEN [] PLUG BACK []
b. TYPE OF WELL: OIL WELL [] GAS WELL [X] OTHER [] SINGLE ZONE [X] MULTIPLE ZONE []
2. NAME OF OPERATOR: Tenneco Oil Company
3. ADDRESS OF OPERATOR: P. O. Box 3249, Englewood, CO 80155
4. LOCATION OF WELL: 935' FNL, 1775' FEL
14. DISTANCE IN MILES AND DIRECTION FROM NEAREST TOWN OR POST OFFICE: 6 miles north/east of Aztec, New Mexico
15. DISTANCE FROM PROPOSED LOCATION TO NEAREST PROPERTY OR LEASE LINE, FT.: 1500'
16. NO. OF ACRES IN LEASE: 1760A 2394.72
17. NO. OF ACRES ASSIGNED TO THIS WELL: 156.54 160A
19. PROPOSED DEPTH: 3050'
21. ELEVATIONS: 6221' GR

5. LEASE DESIGNATION AND SERIAL NO.: NM-000606
6. IF INDIAN, ALLOTTEE OR TRIBE NAME
7. UNIT AGREEMENT NAME
8. FARM OR LEASE NAME: Atlantic A
9. WELL NO.: 19
10. FIELD AND POOL, OR WILDCAT: Blanco, Pictured Cliffs EXT
11. SEC., T., R., M., OR BLK. AND SURVEY OR AREA: Sec. 27, T31N, R10W
12. COUNTY OR PARISH: San Juan
13. STATE: New Mexico

RECEIVED APR 28 1987

This action is subject to technical and procedural review pursuant to 43 CFR 3165.3 and appeal pursuant to 43 CFR 3165.4.

PROPOSED CASING AND CEMENTING PROGRAM

Table with 2 columns: QUANTITY OF CEMENT, GENERAL REQUIREMENTS. Rows: 106 ft³ Class B + 2% CaCl₂, 625 ft³ 65/35 Poz + 6% gel, 177 ft³ Class B + 2% CaCl₂

Table with 4 columns: INCHES, CASING, WEIGHT PER FOOT, SETTING DEPTH. Rows: 9 7/8" 7" 23# 200', 6 1/4" 3 1/2" 9.2# TD, Tail

See attached drilling procedure The gas is dedicated

RECEIVED MAY 12 1987 OIL CON. DIV. DIST. 3

IN ABOVE SPACE DESCRIBE PROPOSED PROGRAM: If proposal is to deepen or plug back, give data on present productive zone and proposed new productive zone. If proposal is to drill or deepen directionally, give pertinent data on subsurface locations and measured and true vertical depths. Give blowout preventer program, if any.

24. SIGNED: Mike M. McPhee TITLE: Administrative Analyst DATE: 4/24/87

APPROVED AS AMENDED

(This space for Federal or State office use)

PERMIT NO. APPROVAL DATE

"Approval of this action does not warrant that the applicant holds legal or equitable rights or title to this lease."

Tubing required EIB NMOCC

MAY 11 1987 AREA MANAGER

NEW MEXICO OIL CONSERVATION COMMISSION
WELL LOCATION AND ACREAGE DEDICATION PLAT

Form C-102
Supersedes C-128
Effective 1-1-65

All distances must be from the outer boundaries of the Section.

Operator TENNECO OIL CO.		Lease ATLANTIC A		Well No. 19
Unit Letter B	Section 27	Township 31 N	Range 10 W	County San Juan
Actual Footage Location of Well: (cardinal) 935 feet from the North line and 1775 feet from the East line				
Ground Level Elev. 6221	Producing Formation Pictured Cliffs	Pool Blanco EXT	Dedicated Acreage: 156.54 160 Acres	

1. Outline the acreage dedicated to the subject well by colored pencil or hachure marks on the plat below.
2. If more than one lease is dedicated to the well, outline each and identify the ownership thereof (both as to working interest and royalty).
3. If more than one lease of different ownership is dedicated to the well, have the interests of all owners been consolidated by communitization, unitization, force-pooling, etc?

Yes No If answer is "yes," type of consolidation _____

If answer is "no," list the owners and tract descriptions which have actually been consolidated. (Use reverse side of this form if necessary.) _____

No allowable will be assigned to the well until all interests have been consolidated (by communitization, unitization, forced-pooling, or otherwise) or until a non-standard unit, eliminating such interests, has been approved by the Commission.

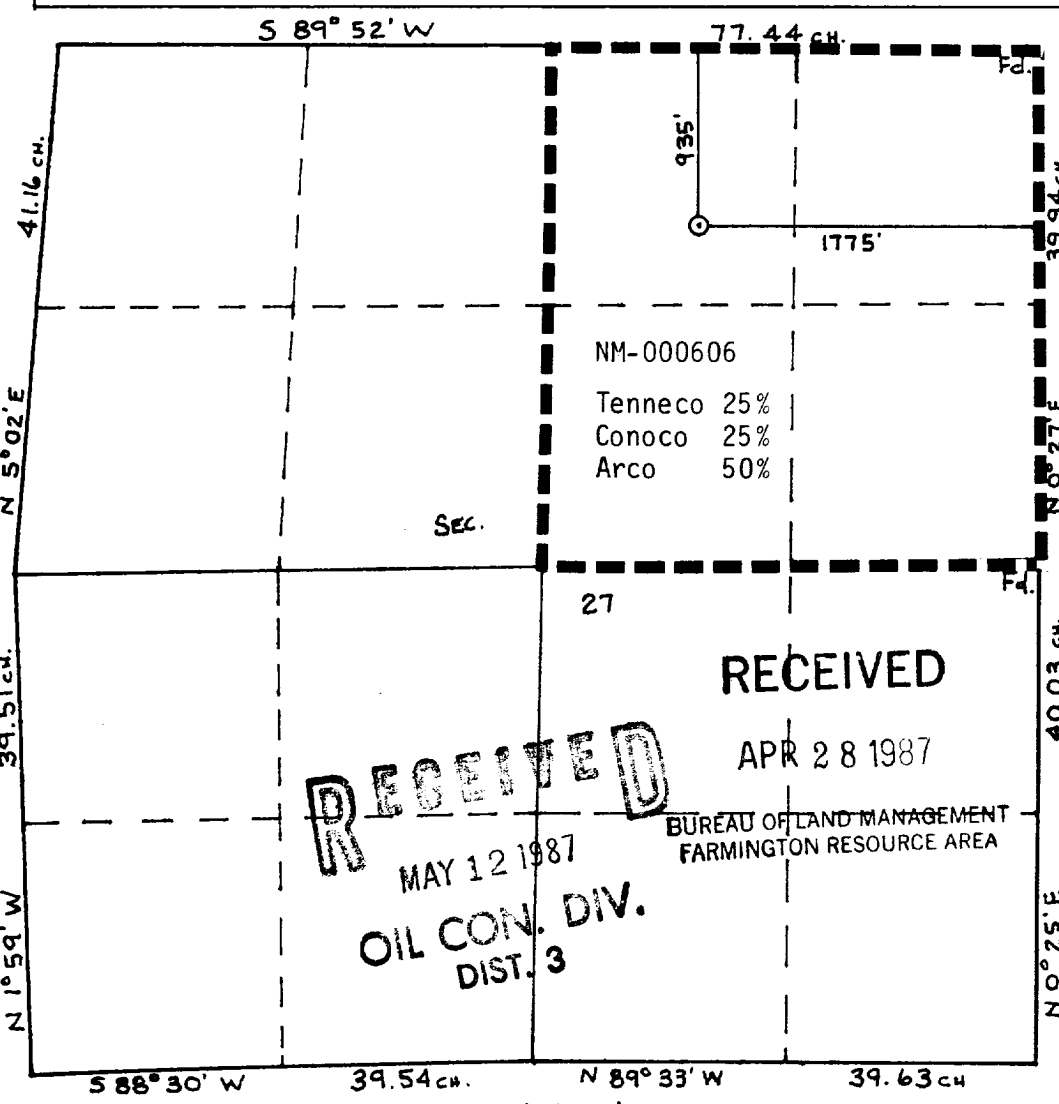

RECEIVED
MAY 12 1987
OIL CON. DIV.
DIST. 3

RECEIVED
APR 28 1987

BUREAU OF LAND MANAGEMENT
FARMINGTON RESOURCE AREA

CERTIFICATION

I hereby certify that the information contained herein is true and complete to the best of my knowledge and belief.

Name
Mike M. McCredie

Position
Administrative Analyst

Company
Tenneco Oil Company

Date
4/24/87

I hereby certify that the well location shown on this plat was plotted from field notes of actual surveys made by me or under my supervision, and that the same is true and correct to the best of my knowledge and belief.

Date Surveyed: **4-16-87**

William B. Mahake
Registered Professional Engineer
and Land Surveyor
#8466

Certificate No. **8438**

SCALE: 1" = 1000'

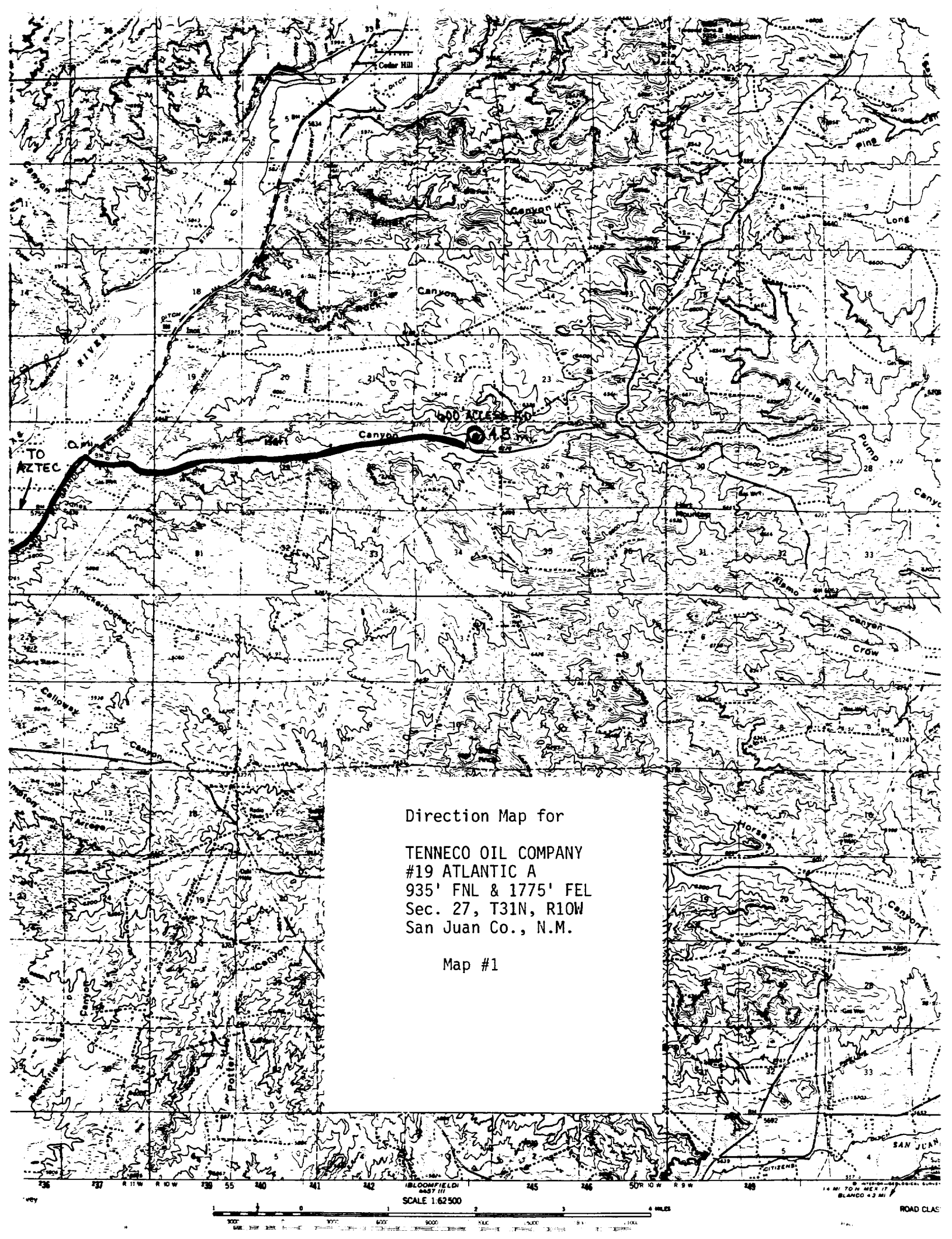

Direction Map for

TENNECO OIL COMPANY
#19 ATLANTIC A
935' FNL & 1775' FEL
Sec. 27, T31N, R10W
San Juan Co., N.M.

Map #1

SCALE 1:62,500

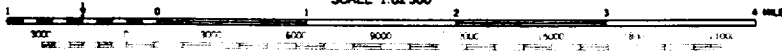

ROAD CLASS

STATE OF NEW MEXICO

ENERGY AND MINERALS DEPARTMENT
OIL CONSERVATION DIVISION



May 26, 1987

GARREY CARRUTHERS
GOVERNOR

POST OFFICE BOX 2088
STATE LAND OFFICE BUILDING
SANTA FE, NEW MEXICO 87501
(505) 827-5800

Tenneco Oil Exploration
and Production
P. O. Box 3249
Englewood, Colorado 80155

Attention: Mike McCredie

Administrative Order TX-178

Gentlemen:

Reference is made to your request for an exception to the tubing setting requirements as contained in Division Rule 107(d)(3) for the below-named well.

Pursuant to the authority granted me by Rule 107(d)(4), you are hereby authorized to set 3 1/2 casing with no tubing in the following well:

Well Name and Number: Atlantic A Well No. 19

Location: Sec. 27, T-31-N, R-10-W, NMPM, San Juan
County, New Mexico

The Division reserves the right to rescind this authority in the event that waste appears to be resulting therefrom.

Very truly yours,

A handwritten signature in cursive script, appearing to read "William J. Lemay".

WILLIAM J. LEMAY,
Division Director

WJL/REJ/dr

cc: ✓ Oil Conservation Division - Aztec

RECEIVED
MAY 29 1987
OIL CON. DIV.
DIST. 3

UNITED STATES
DEPARTMENT OF THE INTERIOR
BUREAU OF LAND MANAGEMENT

SUBMIT IN TRIPPLICATE*
(Other instructions on re-
verse side)

Form approved
Budget Bureau No. 1004-0135
Expires August 31, 1985

SUNDRY NOTICES AND REPORTS ON WELLS

(Do not use this form for proposals to drill or to deepen or plug back to a different reservoir.
Use "APPLICATION FOR PERMIT—" for such proposals.)

1. OIL WELL <input type="checkbox"/> GAS WELL <input checked="" type="checkbox"/> OTHER		5. LEASE DESIGNATION AND SERIAL NO. NM-000606	
2. NAME OF OPERATOR Tenneco Oil Company		6. IF INDIAN, ALLOTTEE OR TRIBE NAME	
3. ADDRESS OF OPERATOR P.O. Box 3249, Englewood, CO 80155		7. UNIT AGREEMENT NAME	
4. LOCATION OF WELL (Report location clearly and in accordance with any State requirements.* See also space 17 below.) At surface 935' FNL, 1775' FEL		8. FARM OR LEASE NAME Atlantic A	
14. PERMIT NO.		9. WELL NO. 19	
15. ELEVATIONS (Show whether DP, ST, CR, etc.) 6221' GR		10. FIELD AND POOL, OR WILDCAT Blanco Pictured Cliffs	
		11. SEC., T., R., N., OR BLK. AND SURVEY OR ARRA Sec. 27, T31N, R10W	
		12. COUNTY OR PARISH San Juan	13. STATE NM

16. Check Appropriate Box To Indicate Nature of Notice, Report, or Other Data

NOTICE OF INTENTION TO:		SUBSEQUENT REPORT OF:	
TEST WATER SHUT-OFF <input type="checkbox"/>	PULL OR ALTER CASING <input type="checkbox"/>	WATER SHUT-OFF <input type="checkbox"/>	REPAIRING WELL <input type="checkbox"/>
FRACTURE TREAT <input type="checkbox"/>	MULTIPLE COMPLETE <input type="checkbox"/>	FRACTURE TREATMENT <input type="checkbox"/>	ALTERING CASING <input type="checkbox"/>
BROUT OR ACIDISE <input type="checkbox"/>	ABANDON* <input type="checkbox"/>	SHOOTING OR ACIDIZING <input type="checkbox"/>	ABANDONMENT* <input type="checkbox"/>
REPAIR WELL <input type="checkbox"/>	CHANGE PLANS <input type="checkbox"/>	(Other) _____	(Other) _____
(Other) Well Completion <input checked="" type="checkbox"/>	(Other) _____	(NOTE: Report results of multiple completion on Well Completion or Recompletion Report and Log form.)	

17. DESCRIBE PROPOSED OR COMPLETED OPERATIONS (Clearly state all pertinent details, and give pertinent dates, including estimated date of starting any proposed work. If well is directionally drilled, give subsurface locations and measured and true vertical depths for all markers and zones pertinent to this work.)*

Tenneco requests permission to complete the referenced well according to the attached detail procedures.

RECEIVED
REGISTRATION DIVISION

07 DEC 18 AM 10:18

REGISTRATION DIVISION
FARMINGTON, NEW MEXICO

RECEIVED
DEC 30 1987
CON. DIV. 1
OFF. 3

18. I hereby certify that the foregoing is true and correct

SIGNED David H. Hatt TITLE Sr. Administrative Analyst DATE 12/15/87

(This space for Federal or State office use)

APPROVED BY _____ TITLE _____ DATE _____

CONDITIONS OF APPROVAL, IF ANY:

NMOCC

*See Instructions on Reverse Side

APPROVED

DEC 28 1987
James E. Edwards
AREA MANAGER

LEASE Atlantic A
WELL NO. 19

CASING:

8 5/8 "OD, 32 LB, K-55 CSG/W 200 SX

TOC @ surf . HOLE SIZE 12 1/4 DT: 12/5 /87

REMARKS

4 1/2 "OD, 10.5 LB, K-55 CSG/W 180/500 SX

TOC @ surf . HOLE SIZE 7 7/8 DT: 12/8 /87

REMARKS DV @ 2268

268

2268

DETAILED PROCEDURE:

1. MIRUSU. NDWH. NUBOP.
2. RIH w/3-7/8" bit on 2-3/8" tbg. DO DV @ 2268. CO to PBTB @ 3056. PT csg to 2500 psi. Circ. hole w/2% KCL wtr. Spot 250 gals 7-1/2% HCL. POOH.
3. MIRU wireline co. Run GR/CCL. Perforate the following interval w/a 3-1/8" csg gun loaded w/2 JSPF
3018-3048 30'
2972-3012 40'
70' 140 holes
Tie into GO GR/CDL/CAL log dated 12/8/87 for depth control.
4. Est rate into perfs w/ KCL.
5. RIH w/ fullbore pkr on 2-3/8 tbg. Set pkr @ 2900'. PT csg to 500 psi.
6. MIRU service co. Acidize perfs w/2000 gals 15% HCL foamed to 70Q. Flush to perfs w/foam. Pump @ 10 BPM and 3500 psi max press. Flow back load & test.
7. Kill well w/KCL. Rlse pkr, POOH w/tbg.
8. MIRU service co. Foam frac as follows:
 - a. 15,000 gal 70Q pad
 - b. 5,000 gal 70Q 1 ppg 20/40
 - c. 8,000 gal 70Q 2 ppg 20/40
 - d. 12,000 gal 70Q 3 ppg 20/40
 - e. 5,000 gal 70Q 4 ppg 20/40
 - f. Flush to perfs with foamTotal 45,000 gals foam
77,000# 20/40 sand
Pump @ 24 BPM and 3500 psi max press.
9. SI well for 3 hrs. FTCU thru tapped bull plug.
10. Kill well w/KCL.
11. RIH w/ 2-3/8" tbg and SN. CO sand to PBTB. PUH, land tbg @ 3000'. NDBOP, NUWH. Swab well in.
12. SI for AOF.

FRAC-WESTERN

3046

3091

2263