

70-045-26887

NO. OF COPIES RECEIVED		
DISTRIBUTION		
SANTA FE		
FILE		
U.S.G.S.		
LAND OFFICE		
OPERATOR		

NEW MEXICO OIL CONSERVATION COMMISSION

Form C-101
Revised 1-1-65

5A. Indicate Type of Lease	
STATE <input checked="" type="checkbox"/>	FEE <input type="checkbox"/>
5. State Oil & Gas Lease No. B-10400-1	

APPLICATION FOR PERMIT TO DRILL, DEEPEN, OR PLUG BACK

1a. Type of Work b. Type of Well OIL WELL <input type="checkbox"/> GAS WELL <input checked="" type="checkbox"/> OTHER <input type="checkbox"/>		DRILL <input checked="" type="checkbox"/> DEEPEN <input type="checkbox"/> PLUG BACK <input type="checkbox"/>	7. Unit Agreement Name
2. Name of Operator Meridian Oil Inc.		SINGLE ZONE <input checked="" type="checkbox"/> MULTIPLE ZONE <input type="checkbox"/>	8. Farm or Lease Name Atlantic D Com A
3. Address of Operator PO Box 4289, Farmington, NM 87499			9. Well No. 200
4. Location of Well UNIT LETTER H LOCATED 1770 FEET FROM THE North LINE AND 940 FEET FROM THE East LINE OF SEC. 36 TWP. 31 RGE. 10 NMPM			10. Field and Pool, or Wildcat Undes. Fruitland
			12. County San Juan
		19. Proposed Depth 3375	19A. Formation Fruitland
		20. Rotary or C.T. Rotary	
21. Elevations (Show whether DF, RT, etc.) 6640' GL	21A. Kind & Status Plug. Bond statewide	21B. Drilling Contractor	22. Approx. Date Work will start

23. PROPOSED CASING AND CEMENT PROGRAM

SIZE OF HOLE	SIZE OF CASING	WEIGHT PER FOOT	SETTING DEPTH	SACKS OF CEMENT	EST. TOP
12 1/4"	9 5/8"	32.3#	200'	130 cu.ft.	circ. surface
8 3/4"	7"	20.0#	3172'	1000 cu.ft.	circ. surface
6 1/4"	5 1/2"	23.0#	3375'	do not cement	

The Fruitland formation will be completed.

A 3000 psi WP and 6000 psi test double gate preventer equipped with blind and pipe rams will be used for blow out prevention on this well.

This gas is dedicated.

The NE/4 of Section 36 is dedicated to this well.

APPROVAL EX/100 10-5-88
UNLESS OTHERWISE COMMENCED.
SPUD NOTICE MUST BE SUBMITTED
WITHIN 10 DAYS.

IN ABOVE SPACE DESCRIBE PROPOSED PROGRAM: IF PROPOSAL IS TO DEEPEN OR PLUG BACK, GIVE DATA ON PRESENT PRODUCTIVE ZONE AND PROPOSED NEW PRODUCTIVE ZONE. GIVE BLOWOUT PREVENTER PROGRAM, IF ANY.

I hereby certify that the information above is true and complete to the best of my knowledge and belief.

Signed [Signature] Title Drilling Clerk Date 4-22-88

(This space for State Use)

APPROVED BY [Signature] TITLE Drilling Clerk DATE 4-22-1988

CONDITIONS OF APPROVAL, IF ANY:

WELL LOCATION AND ACREAGE DEDICATION PLAT

Form C-102
Supersedes C-12
Effective 1-4-88

All distances must be from the outer boundaries of the Section.

Operator MERIDIAN OIL INC.			Lease ATLANTIC D COM A (B-10400-1)		Well No. 200
Unit Letter H	Section 36	Township 31 NORTH	Range 10 WEST	County SAN JUAN	
Actual Footage Location of Well					
1770 feet from the NORTH line and		940 feet from the EAST line			
Ground Level Elev. 6640	Producing Formation Fruitland	Pool Undesignated	Dedicated Acreage 160 Acres		

1. Outline the acreage dedicated to the subject well by colored pencil or hatchure marks on the plat below.
2. If more than one lease is dedicated to the well, outline each and identify the ownership thereof (both as to working interest and royalty).
3. If more than one lease of different ownership is dedicated to the well, have the interests of all owners been consolidated by communitization, unitization, force-pooling, etc?
☒ Yes ☐ No If answer is "yes," type of consolidation communitization

If answer is "no," list the owners and tract descriptions which have actually been consolidated. (Use reverse side of this form if necessary.)

No allowable will be assigned to the well until all interests have been consolidated (by communitization, unitization, forced-pooling, or otherwise) or until a non-standard unit, eliminating such interests, has been approved by the Commission.

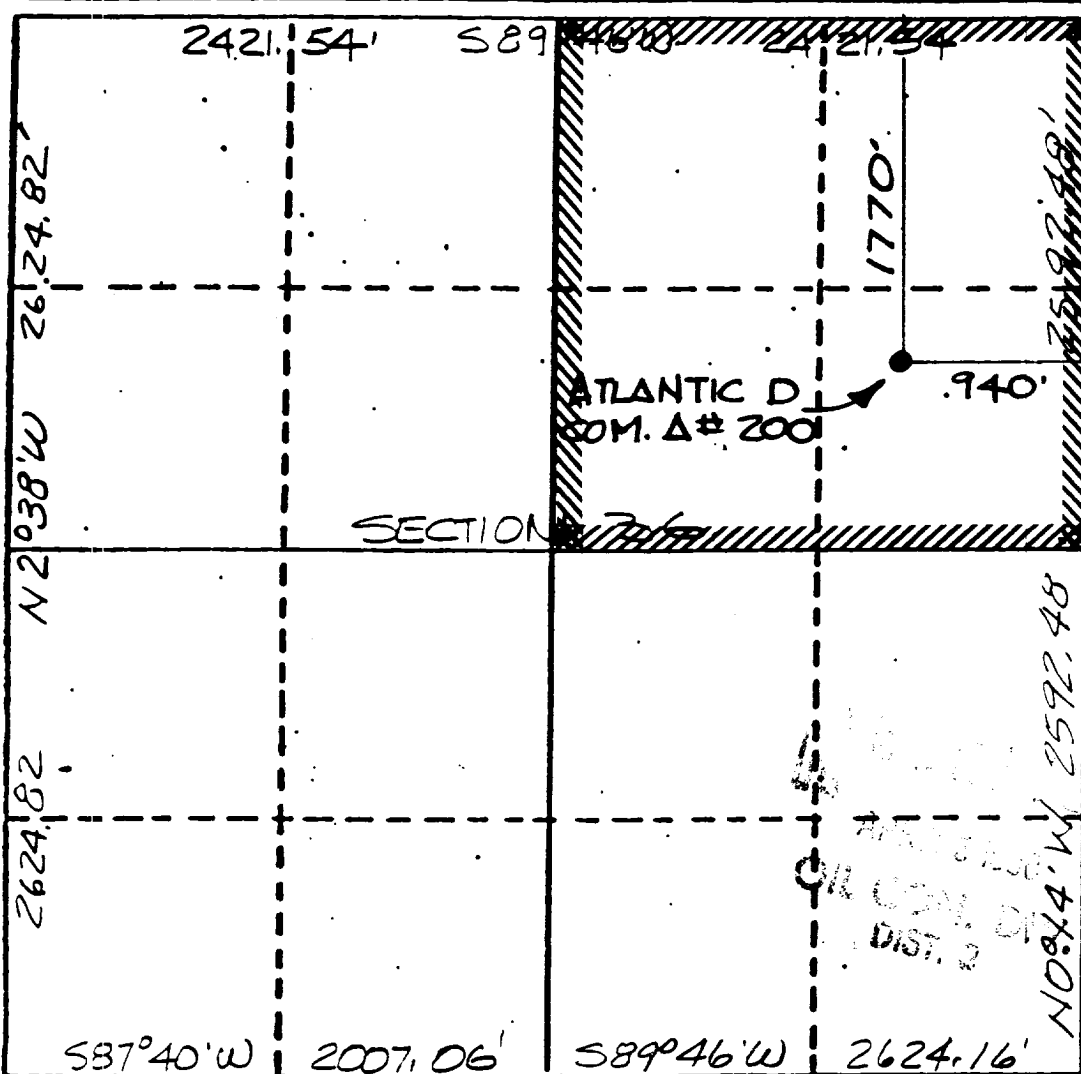

CERTIFICATION

I hereby certify that the information contained herein is true and complete to the best of my knowledge and belief.

Name
Seppah
Drilling Clerk

Position
Meridian Oil Inc.

Company
4-22-88

Date

I hereby certify that the well location shown on this plat was located from field notes of actual survey made by me or under my supervision, and that the same is true and correct to the best of my knowledge and belief.

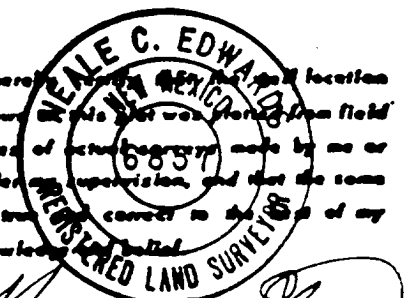

Date Surveyed
APRIL 11, 1988

Registered Professional Engineer and/or Land Surveyor

NEALE C. EDWARDS

Certificate No.
6857