

NEW MEXICO OIL CONSERVATION COMMISSION WELL LOCATION AND ACREAGE DEDICATION PLAT

Form C-100
Supersedes C
Effective 1-4-

All distances must be from the outer boundaries of the Section.

Operator MERIDIAN OIL INC.			Lease ATLANTIC "C" (NM-0607)		Well No. 200
Unit Letter G	Section 35	Township 31 NORTH	Range 10 WEST	County SAN JUAN	
Actual Footage Location of Wells					
1450		feet from the	NORTH	line and	1545
feet from the			EAST	line	
Ground Level Elev. 6422	Producing Formation Fruitland Coal		Pool Basin	Dedicated Acreage 320	

1. Outline the acreage dedicated to the subject well by colored pencil or hatchure marks on the plat below.
2. If more than one lease is dedicated to the well, outline each and identify the ownership thereof (both as to working interest and royalty).
3. If more than one lease of different ownership is dedicated to the well, have the interests of all owners been consolidated by communitization, unitization, force-pooling, etc?

☐ Yes ☐ No If answer is "yes," type of consolidation _____

If answer is "no," list the owners and tract descriptions which have actually been consolidated. (Use reverse side of this form if necessary.) _____

No allowable will be assigned to the well until all interests have been consolidated (by communitization, unitization, forced-pooling, or otherwise) or until a non-standard unit, eliminating such interests, has been approved by the Commission. **S89° 36' W** **N 89° 49' W**

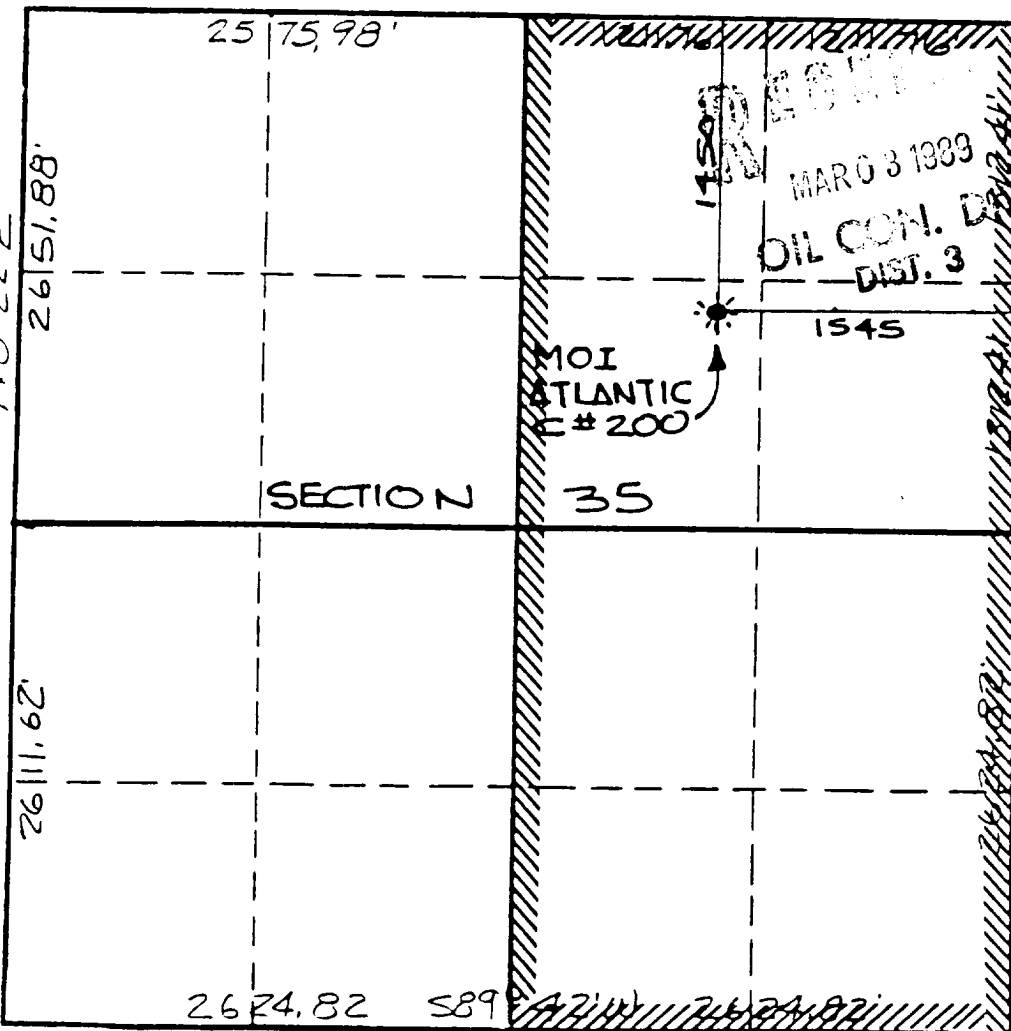

CERTIFICATION

I hereby certify that the information contained herein is true and complete to the best of my knowledge and belief.

Name D. R. Afford
 Position Regulatory Affairs
 Company Meridian Oil Inc.
 Date 12-27-88

I hereby certify that the location shown on this plat was determined from field notes of actual survey made by me or under my supervision, and that the same is true and correct to the best of my knowledge and belief.

Date Surveyed APRIL 27, 1988
 Registered Professional Engineer and/or Land Surveyor

NEALE C. EDWARDS

Certificate No. 6857