

UNITED STATES
DEPARTMENT OF THE INTERIOR
BUREAU OF LAND MANAGEMENT

SUBMIT IN TRIPPLICATE*
(Other instructions on
reverse side)

Form approved.
Budget Bureau No. 1004-0136
Expires August 31, 1985

5. LEASE DESIGNATION AND SERIAL NO.

BLM MAIL ROOM
00-103367

6. IF INDIAN, ALLOTTEE OR TRIBE NAME

UNIT AGREEMENT NAME

FARM OR LEASE NAME

Brown

9. WELL NO.

100

10. FIELD AND POOL, OR WILDCAT

Undes. Fruitland

11. SEC., T., R., M., OR BLK.

Sec. 9, T-32-N, R-10-W
NMPM

12. COUNTY OR PARISH 13. STATE

San Juan NM

1A. TYPE OF WORK

DRILL ☒

DEEPEN ☐

PLUG BACK ☐

B. TYPE OF WELL

OIL
WELL ☐

GAS
WELL ☒

OTHER

SINGLE
ZONE ☒

MULTIPLE
ZONE ☐

2. NAME OF OPERATOR

Meridian Oil Inc.

3. ADDRESS OF OPERATOR

PO Box 4289, Farmington, NM 87499

4. LOCATION OF WELL (Report location clearly and in accordance with any State requirements.)

At surface
1130'S, 860'W

At proposed prod. zone

14. DISTANCE IN MILES AND DIRECTION FROM NEAREST TOWN OR POST OFFICE*

5 miles from Cedar Hill, NM

15. DISTANCE FROM PROPOSED*

LOCATION TO NEAREST
PROPERTY OR LEASE LINE, FT.
(Also to nearest drig. unit line, if any)

860'

16. NO. OF ACRES IN LEASE

167.97/55.61

17. NO. OF ACRES ASSIGNED
TO THIS WELL

167.97

18. DISTANCE FROM PROPOSED LOCATION*
TO NEAREST WELL, DRILLING, COMPLETED,
OR APPLIED FOR, ON THIS LEASE, FT.

500'

19. PROPOSED DEPTH

3515'

20. ROTARY OR CABLE TOOLS

Rotary

21. ELEVATIONS (Show whether DF, RT, GR, etc.)

6781' GL

SUBJECT TO COMPLETION OF ATTACHED
"GENERAL REQUIREMENTS"

22. APPROX. DATE WORK WILL START*

23. PROPOSED CASING AND CEMENTING PROGRAM

SIZE OF HOLE	SIZE OF CASING	WEIGHT PER FOOT	SETTING DEPTH	QUANTITY OF CEMENT
12 1/4"	9 5/8"	32.3#	200'	130 cf. circulated
8 3/4"	7"	20.0#	3375'	1070 cf circ. surface
6 1/4"	5 1/2" liner	23.0#	3515'	do not cement

The Fruitland formation will be completed.

A 3000 psi WP and 6000 psi test double gate preventer equipped with blind and pipe rams will be used for blow out prevention on this well.

This gas is dedicated.

Lots 7,8,9,10 of Sec. 9 are dedicated to this well.

IN ABOVE SPACE DESCRIBE PROPOSED PROGRAM: If proposal is to deepen or plug back, give data on present productive zone and proposed new productive zone. If proposal is to drill or deepen directionally, give pertinent data on subsurface locations and measured and true vertical depths. Give blowout preventer program, if any.

24. SIGNOR [Signature] TITLE Drilling Clerk DATE 04-25-88

(This space for Federal or State office use)

PERMIT NO. _____ APPROVAL DATE _____

APPROVED BY _____ TITLE _____
CONDITIONS OF APPROVAL, IF ANY:

*See Instructions On Reverse Side

WELL LOCATION AND ACREAGE DEDICATION PLAT

Form C-103
Supersedes C-73
Effective 1-4-88

All distances must be from the outer boundaries of the Section.

Operator MERIDIAN OIL INC.			Lease BROWN (NM-013367)		Well No. 100
Unit Letter G	Section 9	Township 32 NORTH	Range 10 WEST	County SAN JUAN	
Actual Footage Location of Well: 1130 feet from the SOUTH line and 860 feet from the WEST line					
Ground Level Elev. 6781	Producing Formation Fruitland		Pool Undesignated		Dedicated Acres 167.97

1. Outline the acreage dedicated to the subject well by colored pencil or hatchure marks on the plat below.
2. If more than one lease is dedicated to the well, outline each and identify the ownership thereof (both as to working interest and royalty).
3. If more than one lease of different ownership is dedicated to the well, have the interests of all owners been consolidated by communitization, unitization, force-pooling, etc?

☐ Yes ☐ No If answer is "yes," type of consolidation _____

If answer is "no," list the owners and tract descriptions which have actually been consolidated. (Use reverse side of this form if necessary.) _____

No allowable will be assigned to the well until all interests have been consolidated (by communitization, unitization, forced-pooling, or otherwise) or until a non-standard unit, eliminating such interests, has been approved by the Commission.

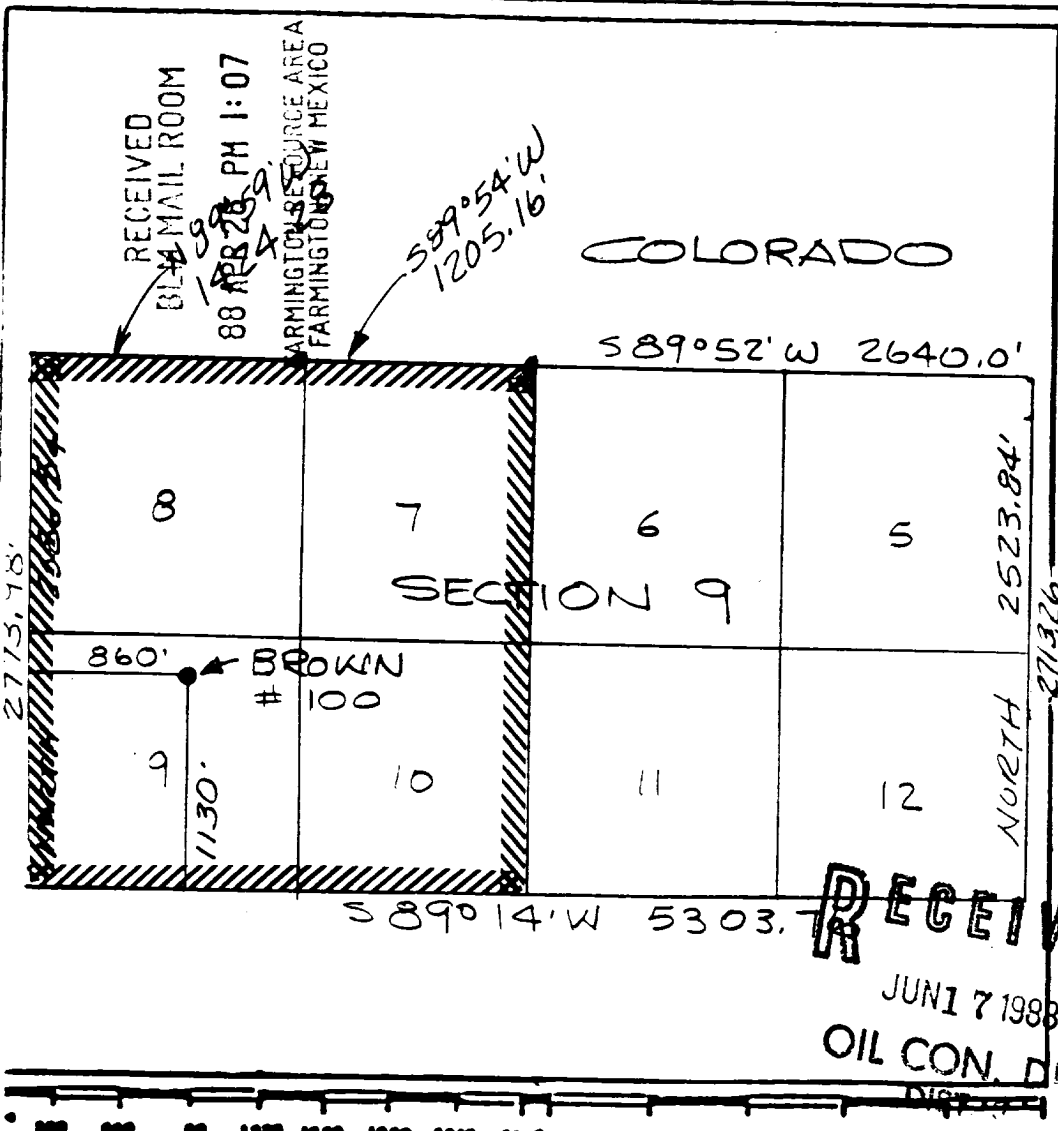

CERTIFICATION

I hereby certify that the information contained herein is true and complete to the best of my knowledge and belief.

Name _____

Drilling Clerk

Position _____

Meridian Oil Inc.

Company _____

4-25-88

Date _____

I hereby certify that the well location shown on this plat is derived from field notes of actual surveys made by me or under my supervision, and that the same is true and correct to the best of my knowledge and belief.

NEALE C. EDWARDS
NEW MEXICO
REGISTERED LAND SURVEYOR

Date Surveyed _____

APRIL 7, 1988

Registered Professional Engineer
and/or Land Surveyor

NEALE C. EDWARDS

Certificate No.
6857

Brown 100

SW 9-32-10

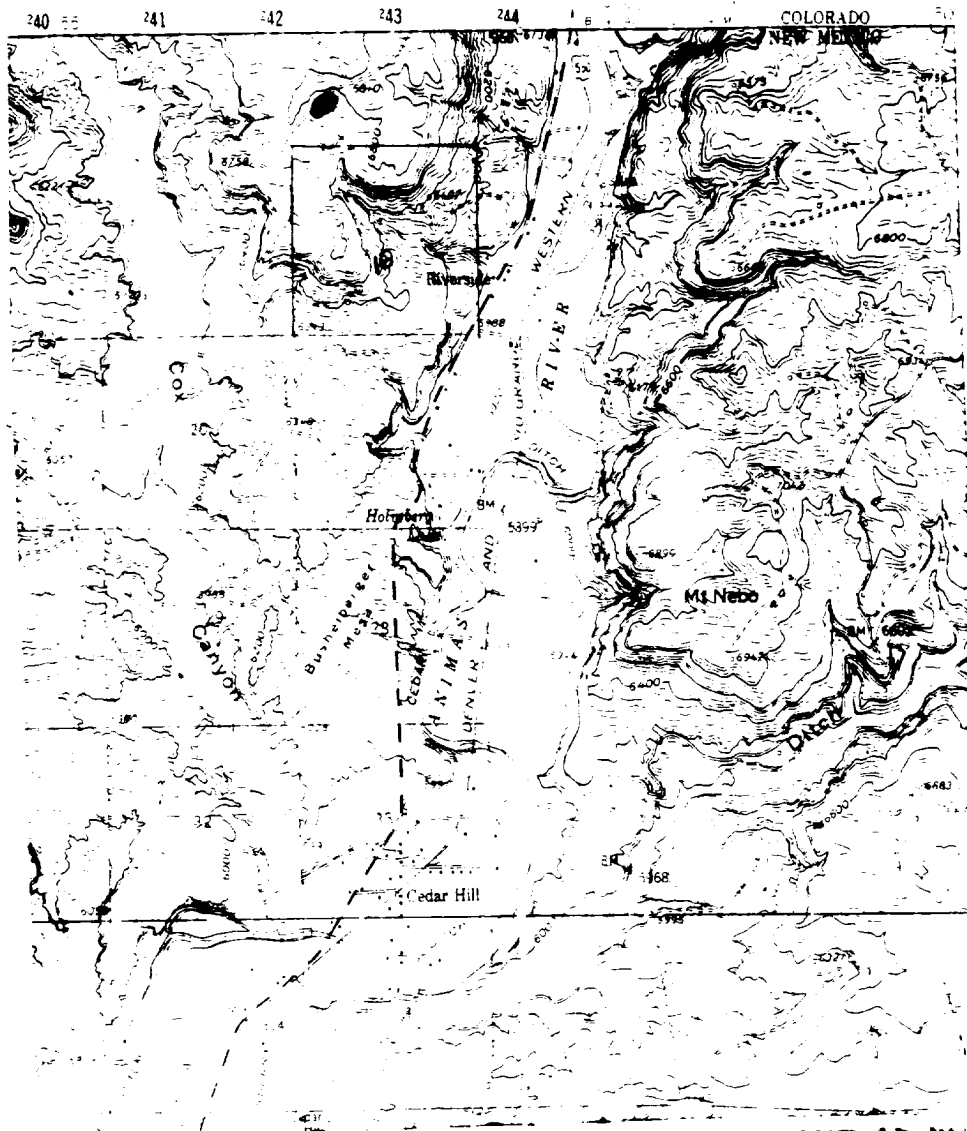

Map #2

LEGEND OF RIGHT-OF-WAYS

EXISTING ROADS

EXISTING PIPELINES

EXISTING ROAD & PIPELINE

PROPOSED ROADS

PROPOSED PIPELINES

PROPOSED ROAD & PIPELINE