

UNITED STATES
DEPARTMENT OF THE INTERIOR
GEOLOGICAL SURVEY

APPLICATION FOR PERMIT TO DRILL, DEEPEN, OR PLUG BACK

1a. TYPE OF WORK DRILL <input checked="" type="checkbox"/> DEEPEN <input type="checkbox"/> PLUG BACK <input type="checkbox"/>				5. LEASE DESIGNATION AND SERIAL NO. NM-013685
b. TYPE OF WELL OIL WELL <input type="checkbox"/> GAS WELL <input checked="" type="checkbox"/> OTHER <input type="checkbox"/> SINGLE ZONE <input checked="" type="checkbox"/> MULTIPLE ZONE <input type="checkbox"/>				6. IF INDIAN, ALLOTTEE OR TRIBE NAME
2. NAME OF OPERATOR Tenneco Oil Company				7. UNIT AGREEMENT NAME
3. ADDRESS OF OPERATOR P.O. Box 3249, Englewood, CO 80155				8. FARM OR LEASE NAME Schwerdtfeger
4. LOCATION OF WELL (Report location clearly and in accordance with any State requirements.) At surface SW/4, Sec. 27, 1120' FSL, 810' FWL At proposed prod. zone <i>Same</i>				9. WELL NO. 3
14. DISTANCE IN MILES AND DIRECTION FROM NEAREST TOWN OR POST OFFICE* <i>12 miles NE of Aztec</i>				10. FIELD AND POOL, OR WELDCAT <i>Blanco Fruitland COAL</i>
15. DISTANCE FROM PROPOSED* LOCATION TO NEAREST PROPERTY OR LEASE LINE, FT. (Also to nearest drilg. unit line, if any)		16. NO. OF ACRES IN LEASE 771.18		11. SEC., T., R., M., OR BLK. AND SURVEY OR AREA <i>M</i> Sec. 27, T31N, R9W
18. DISTANCE FROM PROPOSED LOCATION* TO NEAREST WELL, DRILLING, COMPLETED, OR APPLIED FOR, ON THIS LEASE, FT. 300'		19. PROPOSED DEPTH 3030'		12. COUNTY OR PARISH 13. STATE San Juan NM
21. ELEVATIONS (Show whether DF, RT, GR, etc.) 6083' GR		17. NO. OF ACRES ASSIGNED TO THIS WELL <i>320 159.45</i>		20. ROTARY OR CABLE TOOLS Rotary
22. APPROX. DATE WORK WILL START* 8/1/88				23. DRILLING OPERATIONS AUTHORIZED ARE SUBJECT TO COMPLIANCE WITH ATTACHED "GENERAL REQUIREMENTS" QUANTITY OF CEMENT
SIZE OF HOLE	SIZE OF CASING	WEIGHT PER FOOT	SETTING DEPTH	
12 1/2"	9 5/8"	36#	± 200'	200 cu. ft. - Circ. to Surface
8 3/4"	7"	23#	± 2580'	650 cu. ft. - Circ. to Surface
6 1/2"	5 1/2" - Liner	23#	± 2480' - 3027'	None

See Attached Drilling Procedure.

See Item 1.B in Surface Use Plan and Map 2A and 2B for BLM Right-of-Way Application.

IN ABOVE SPACE DESCRIBE PROPOSED PROGRAM: If proposal is to deepen or plug back, give data on present productive zone and proposed new productive zone. If proposal is to drill or deepen directionally, give pertinent data on subsurface locations and measured and true vertical depths. Give blowout preventer program, if any.

24. SIGNED Larry Bell TITLE Administrative Supervisor DATE 7/7/88
(This space for Federal or State office use)

PERMIT NO. _____ APPROVAL DATE _____

APPROVED BY _____ TITLE _____ DATE _____
CONDITIONS OF APPROVAL, IF ANY:6/4
EPO

NMOCC

Orlan S. Hiner
forRECEIVED
JUL 27 1988
OIL CON. DIV.
DIST. 3

**NEW MEXICO OIL CONSERVATION COMMISSION
WELL LOCATION AND ACREAGE DEDICATION PLAT**

Form C-102
Supersedes C-128
Effective 1-1-65

All distances must be from the outer boundaries of the Section.

Operator TENNECO OIL COMPANY			Lease SCHWERTFEGER		Well No. 3
Unit Letter M	Section 27	Township 31 N	Range 9 W	County SAN JUAN	
Actual Footage Location of Well: 1120 feet from the South line and 810 feet from the West line					
Ground Level Elev. 6083	Producing Formation Fruitland Coal		Pool Blanco Fruitland		Dedicated Acreage: 320 15.45 Acres

1. Outline the acreage dedicated to the subject well by colored pencil or hatchure marks on the plat below.
2. If more than one lease is dedicated to the well, outline each and identify the ownership thereof (both as to working interest and royalty).
3. If more than one lease of different ownership is dedicated to the well, have the interests of all owners been consolidated by communitization, unitization, force-pooling, etc?

☐ Yes ☐ No If answer is "yes," type of consolidation _____

If answer is "no," list the owners and tract descriptions which have actually been consolidated. (Use reverse side of this form if necessary.) _____

No allowable will be assigned to the well until all interests have been consolidated (by communitization, unitization, forced-pooling, or otherwise) or until a non-standard unit, eliminating such interests, has been approved by the Commission.

N 89°55'W

78.36ch.

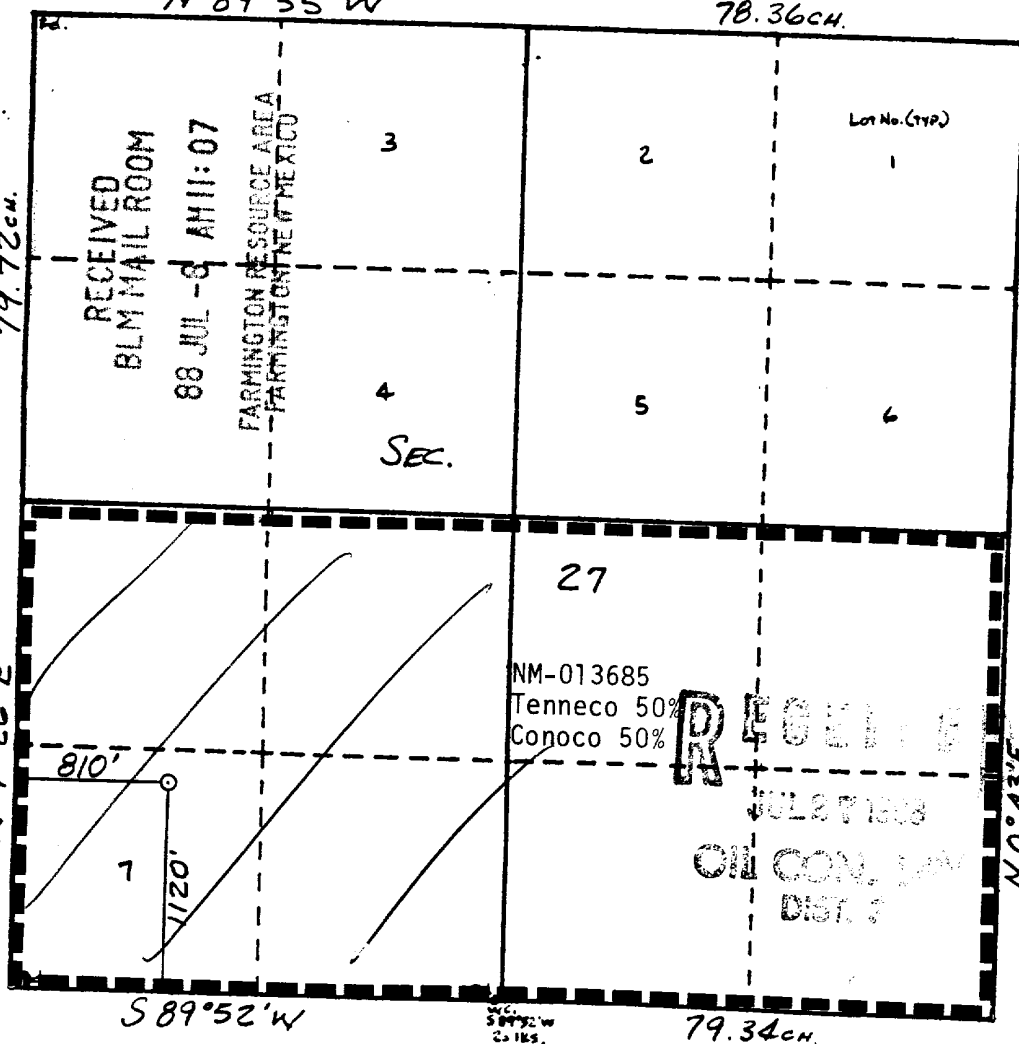

CERTIFICATION

I hereby certify that the information contained herein is true and complete to the best of my knowledge and belief.

Name
Larry Bell
Position
Admin. Supervisor
Company
Tenneco Oil Company
Date
7/7/88

I hereby certify that the well location shown on this plat was plotted from field notes of actual surveys made by me or under my supervision, and that the same is true and correct to the best of my knowledge and belief.

Date Surveyed
7/7/88
Registered Professional Engineer and Land Surveyor
WILLIAM E. HANKE II
Certificate No. **8466**

Existing BLM ROW APPL:

See APD's Barrett 13, Horton 2

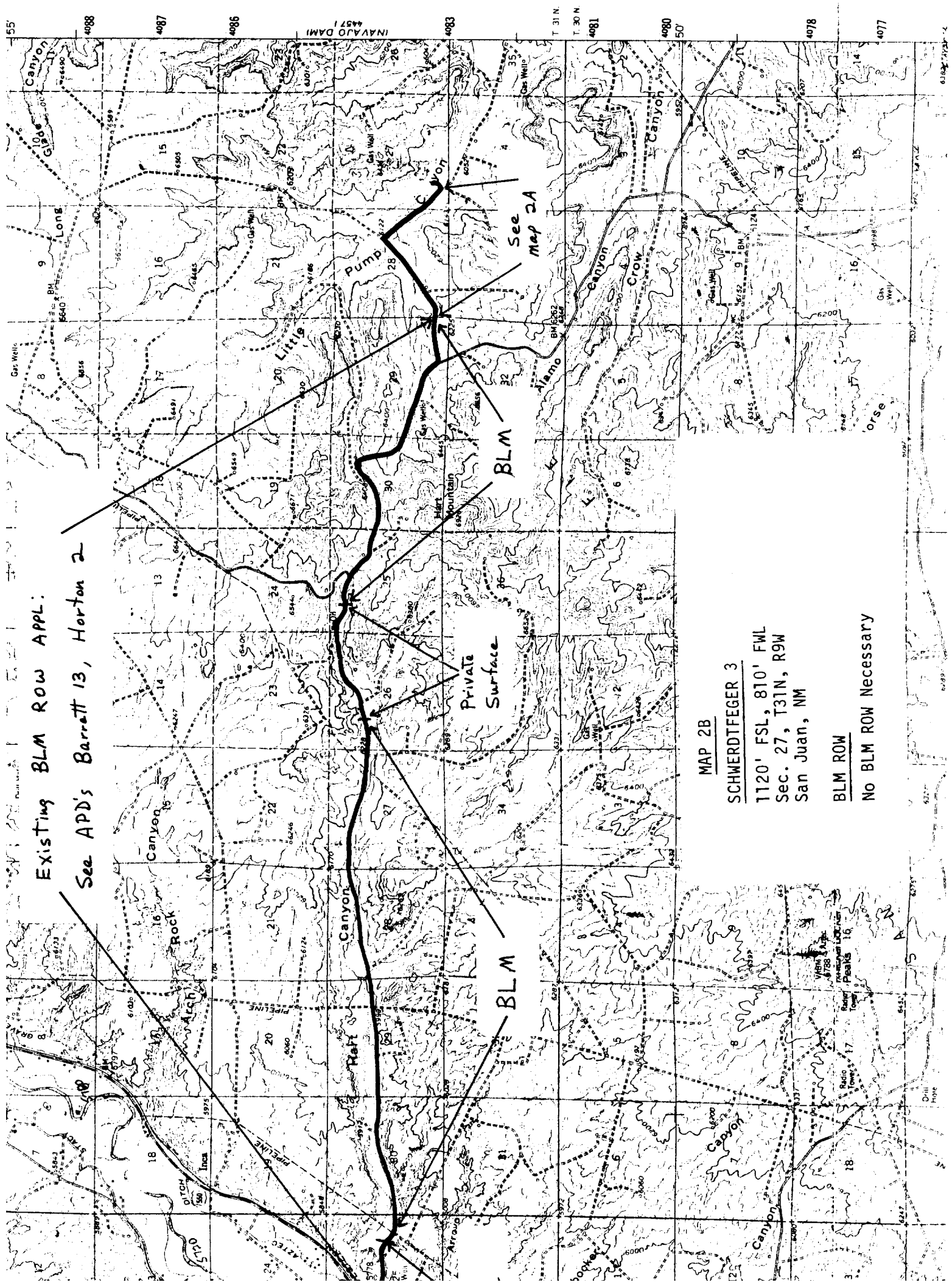

MAP 2B

SCHWEDTFEGER 3

1120' FSL, 810' FWL
Sec. 27, T31N, R9W
San Juan, NM

BLM ROW

No BLM ROW Necessary