

UNITED STATES
DEPARTMENT OF THE INTERIOR
GEOLOGICAL SURVEY

APPLICATION FOR PERMIT TO DRILL, DEEPEN, OR PLUG BACK

5. LEASE DESIGNATION AND SERIAL NO.
SF-078051

6. IF INDIAN, ALLOTTEE OR TRIBE NAME

7. UNIT AGREEMENT NAME

8. FARM OR LEASE NAME
Neil LS

9. WELL NO.
8R

10. FIELD AND POOL, OR WILDCAT
Blanco Mesaverde

11. SEC., T., R., M., OR BLK.
AND SURVEY OR AREA
H
Sec. 4, T31N, R11W

12. COUNTY OR PARISH
San Juan

13. STATE
NM

1a. TYPE OF WORK
DRILL ☒ DEEPEN ☐ PLUG BACK ☐

b. TYPE OF WELL
OIL WELL ☐ GAS WELL ☒ OTHER ☐ SINGLE ZONE ☒ MULTIPLE ZONE ☐

2. NAME OF OPERATOR
Tenneco Oil Company

3. ADDRESS OF OPERATOR
P.O. Box 3249, Englewood, CO 80155

4. LOCATION OF WELL (Report location clearly and in accordance with any State requirements.)
At surface
2055' FNL, 885' FEL
At proposed prod. zone
Same

14. DISTANCE IN MILES AND DIRECTION FROM NEAREST TOWN OR POST OFFICE*
7 miles North of Aztec, NM

15. DISTANCE FROM PROPOSED* LOCATION TO NEAREST PROPERTY OR LEASE LINE, FT.
(Also to nearest drlg. unit line, if any) 885'

16. NO. OF ACRES IN LEASE
2218.66

17. NO. OF ACRES ASSIGNED TO THIS WELL
E320 309.31

18. DISTANCE FROM PROPOSED LOCATION* TO NEAREST WELL, DRILLING, COMPLETED, OR APPLIED FOR, ON THIS LEASE, FT.
5559'

19. PROPOSED DEPTH
5559'

20. ROTARY OR CABLE TOOLS
Rotary

21. ELEVATIONS (Show whether DF, RT, GR, etc.)
6162' GR

22. APPROX. DATE WORK WILL START*
ASAP

DRILLING OPERATIONS SHALL BE SUBJECT TO COMPLIANCE WITH ATTACHED "GENERAL REQUIREMENTS".
This action is subject to technical and procedural review pursuant to 43 CFR 3165.3 and appeal pursuant to 43 CFR 3165.4.

SIZE OF HOLE	SIZE OF CASING	WEIGHT PER FOOT	SETTING DEPTH	QUANTITY OF CEMENT
12 1/4"	9 5/8"	36#, K-55	± 250	Circ. to Surface
8 3/4"	7"	23#, K-55	± 3262	2 Stage - Circ. to Surface
6 1/2"	4 1/2"	10.5#, K-55	± 5559	Circ. to Liner top

See Attached Drilling Procedure

Application for Unorthodox Location Approved has been submitted to NMOCD.

See Item 1.B. on Surface Use Plan and Map 2 for BLM Right-of Way Application.

RECEIVED
AUG 05 1988
OIL CON. DIV
DIST. 3

IN ABOVE SPACE DESCRIBE PROPOSED PROGRAM: If proposal is to deepen or plug back, give data on present productive zone and proposed new productive zone. If proposal is to drill or deepen directionally, give pertinent data on subsurface locations and measured and true vertical depths. Give blowout preventer program, if any.

24. SIGNED Niles V. Jokeva TITLE Staff Admin. Analyst DATE 6/8/88
(This space for Federal or State office use)

PERMIT NO. _____ APPROVAL DATE _____

APPROVED BY _____ TITLE _____ DATE _____

CONDITIONS OF APPROVAL, IF ANY:

NSC-2558
OK
EAB

APPROVED
Jokeva
6/8/88

NEW MEXICO OIL CONSERVATION COMMISSION
WELL LOCATION AND ACREAGE DEDICATION PLAT

Form C-102
Supersedes C-128
Effective 1-1-85

All distances must be from the outer boundaries of the Section

Operator TENNECO OIL COMPANY			Lease NEIL LS		Well No. 8R
Unit Letter H	Section 4	Township 31 N	Range 11 W	County SAN JUAN	
Actual Footage Location of Well: 2055 feet from the North line and 885 feet from the East line					
Ground Level Elev. 6162	Producing Formation Mesaverde	Pool Blanco Mesaverde		Dedicated Acreage: 320 30 9.31 Acres	

1. Outline the acreage dedicated to the subject well by colored pencil or hatchure marks on the plat below.
2. If more than one lease is dedicated to the well, outline each and identify the ownership thereof (both as to working interest and royalty).
3. If more than one lease of different ownership is dedicated to the well, have the interests of all owners been consolidated by communitization, unitization, force-pooling, etc?

☐ Yes ☐ No If answer is "yes," type of consolidation _____

If answer is "no," list the owners and tract descriptions which have actually been consolidated. (Use reverse side of this form if necessary.) _____

No allowable will be assigned to the well until all interests have been consolidated (by communitization, unitization, forced-pooling, or otherwise) or until a non-standard unit, eliminating such interests, has been approved by the Commission.

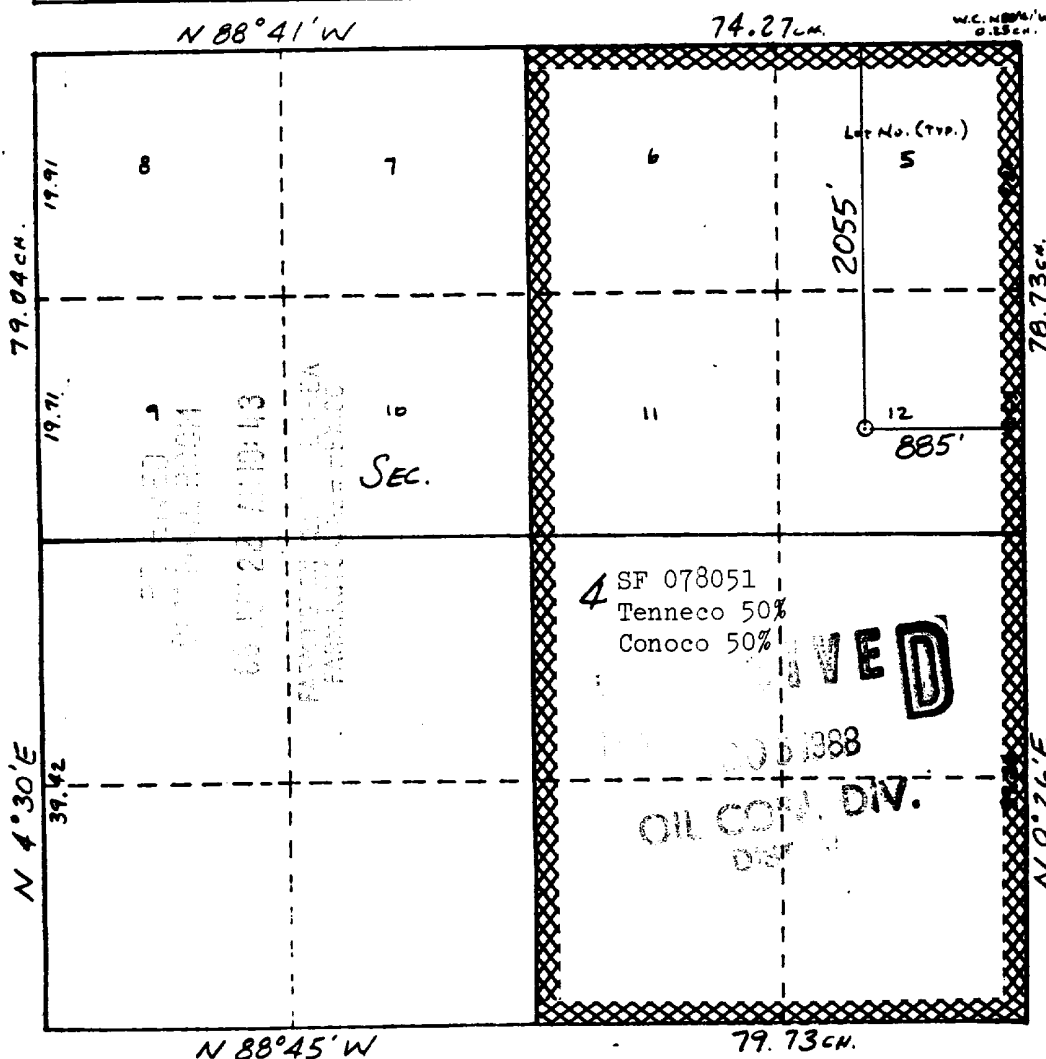

CERTIFICATION

I hereby certify that the information contained herein is true and complete to the best of my knowledge and belief.

Ken Russell
Name
Ken Russell
Position
Administrative Analyst
Company
Tenneco Oil Co
Date
6/2/88

I hereby certify that the well location shown on this plat was plotted from field notes of actual surveys made by me or under my supervision, and that the same is true and correct to the best of my knowledge and belief.

Date Surveyed
William E. Mahnke
Registered Professional Engineer and Land Surveyor
Certificate No.
8466

