

UNITED STATES  
DEPARTMENT OF THE INTERIOR  
BUREAU OF LAND MANAGEMENT

APPLICATION FOR PERMIT TO DRILL, DEEPEN, OR PLUG BACK

1a. TYPE OF WORK

DRILL ☒

DEEPEN ☐

PLUG BACK ☐

b. TYPE OF WELL

OIL  
WELL ☐

GAS  
WELL ☒

OTHER

SINGLE  
ZONE ☒

MULTIPLE  
ZONE ☐

2. NAME OF OPERATOR

Southland Royalty Company

3. ADDRESS OF OPERATOR

PO Box 4289, Farmington, NM 87499

4. LOCATION OF WELL (Report location clearly and in accordance with any State requirements.)\*

At ~~surface~~ 1450'S, 805'W

At proposed prod. zone

14. DISTANCE IN MILES AND DIRECTION FROM NEAREST TOWN OR POST OFFICE\*

8 miles from Ignacio, CO

15. DISTANCE FROM PROPOSED\*

LOCATION TO NEAREST  
PROPERTY OR LEASE LINE, FT. 805'  
(Also to nearest drig. unit line, if any)

16. NO. OF ACRES IN LEASE

640

17. NO. OF ACRES ASSIGNED  
TO THIS WELL

160.00

18. DISTANCE FROM PROPOSED LOCATION\*

TO NEAREST WELL, DRILLING, COMPLETED, 75 mi  
ON APPLIED FOR, ON THIS LEASE, FT.

19. PROPOSED DEPTH

3960'

20. ROTARY OR CABLE TOOLS

Rotary

21. ELEVATIONS (Show whether DF, RT, GR, etc.)

7097' GL DRILLING OPERATIONS AUTHORIZED ARE

SUBJECT TO COMPLIANCE WITH ATTACHED

23. "GENERAL REQUIREMENTS" PROPOSED CASING AND CEMENTING PROGRAM

This action is subject to technical and  
procedural review pursuant to 43 CFR 3107.9  
and appeal pursuant to 43 CFR 3105.4.

SIZE OF HOLE	SIZE OF CASING	WEIGHT PER FOOT	SETTING DEPTH	QUANTITY OF CEMENT
12 1/4"	9 5/8"	32.3#	200'	130 cf. circulated
8 3/4"	7"	20.0#	3730'	1180 cf circ. surface
6 1/4"	5 1/2" liner	23.0#	3960'	do not cement

The Fruitland coal formation will be completed.

A 3000 psi WP and 6000 psi test double gate preventer equipped with blind and pipe rams will be used for blow out prevention on this well.

This gas is dedicated.

The SW/4 of Section 13 is dedicated to this well.

IN ABOVE SPACE DESCRIBE PROPOSED PROGRAM: If proposal is to deepen or plug back, give data on present productive zone and proposed new productive zone. If proposal is to drill or deepen directionally, give pertinent data on subsurface locations and measured and true vertical depths. Give blowout preventer program, if any.

24. SIGNED [Signature] TITLE Drilling Clerk DATE 07-05-88

(This space for Federal or State office use)

PERMIT NO. \_\_\_\_\_

APPROVAL DATE \_\_\_\_\_

APPROVED BY \_\_\_\_\_

TITLE \_\_\_\_\_

CONDITIONS OF APPROVAL, IF ANY:

OK  
EJH

NMOCC

\*See Instructions On Reverse Side

Form C-103  
Supersedes C-12  
Effective 1-4-68

Operator Southland Royalty Company		Lease REESE MESA (NM-6892)		Well No. 100
Unit Letter L	Section 13	Township 32 NORTH	Range 8 WEST	County SAN JUAN
Actual Postage Location of Wells				
1450 feet from the SOUTH line and		805 feet from the WEST line		
Ground Level Elev. 7097	Producing Formation Fruitland Coal	Pool Undesignated		Dedicated Acreage 160 Acres

- ☐ Yes ☐ No If answer is "yes," type of consolidation \_\_\_\_\_

No allowable will be assigned to the well until all interests have been consolidated (by communitization, unitization, forced-pooling, or otherwise) or until a non-standard unit, eliminating such interests, has been approved by the Commission.

N 89° 01' W 5244.36' REVISIED to show moved location

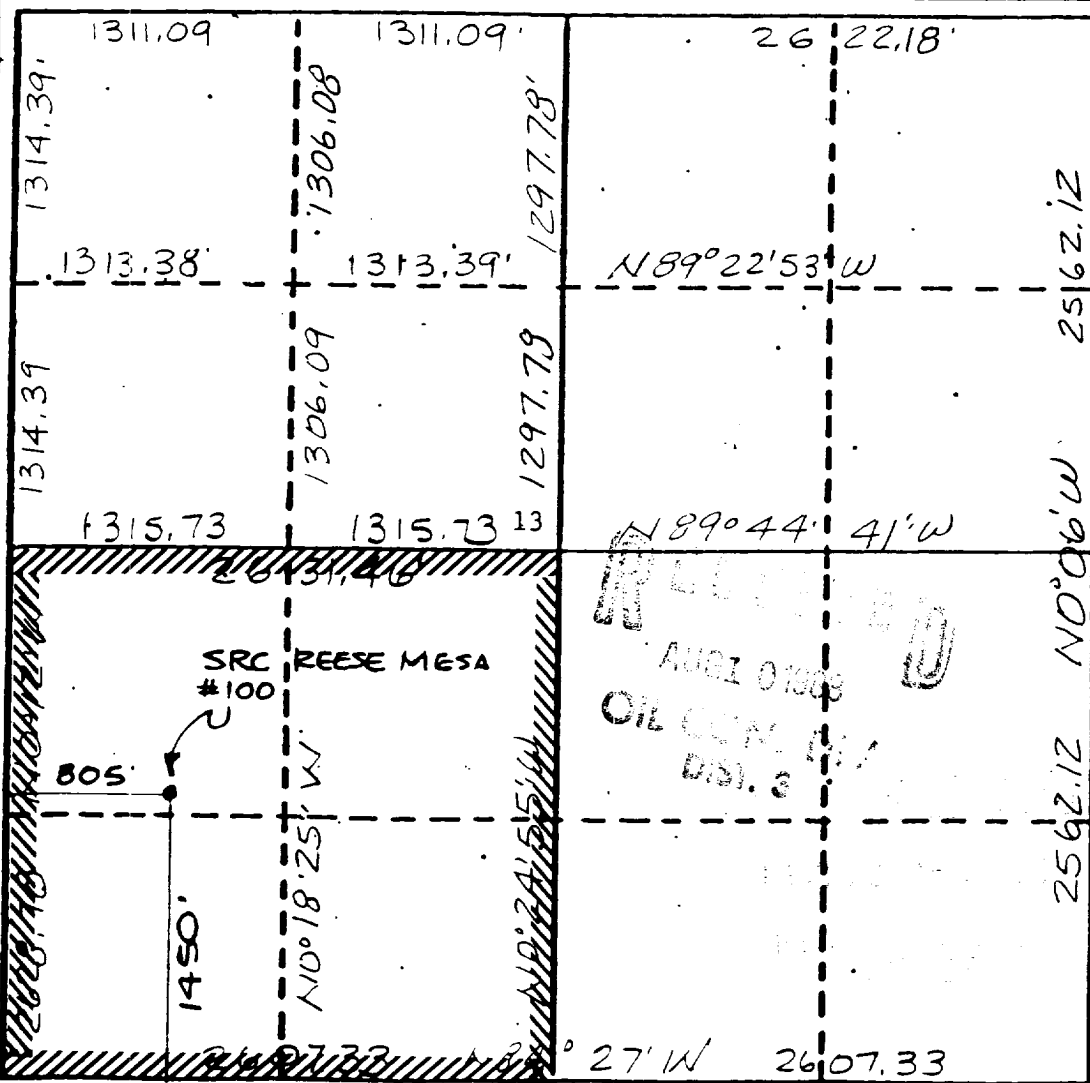

I hereby certify that the information contained herein is true and complete to the best of my knowledge and belief.

**Name**  
Drilling Clerk

**Position**  
Southland Royalty Co.

**Company**  
7-5-88

Date \_\_\_\_\_

I hereby certify that the above location shows the site was obtained from field notes of actual survey made by me or under my supervision, and that the same is true and correct to the best of my knowledge and belief.

Only Surveyed  
MAY 31, 1988  
Registered Professional Engineer  
and/or Land Surveyor

NEALE C. EDWARDS

**Certificate No.**

