

30-045-27129

NO. OF COPIES RECEIVED	
DISTRIBUTION	
SANTA FE	
FILE	
U.S.G.S.	
LAND OFFICE	
OPERATOR	

NEW MEXICO OIL CONSERVATION COMMISSION

Form C-101
Revised 1-1-65

5A. Indicate Type of Lease	
STATE <input type="checkbox"/>	FEE <input checked="" type="checkbox"/>
5. State Oil & Gas Lease No.	

APPLICATION FOR PERMIT TO DRILL, DEEPEN, OR PLUG BACK

1a. Type of Work		7. Unit Agreement Name	
b. Type of Well OIL WELL <input type="checkbox"/> GAS WELL <input checked="" type="checkbox"/> OTHER <input type="checkbox"/>		Allison Unit	
2. Name of Operator Meridian Oil Inc.		8. Farm or Lease Name Allison Unit	
3. Address of Operator PO Box 4289, Farmington, NM 87499		9. Well No. 112	
4. Location of Well UNIT LETTER <u>F</u> LOCATED <u>1800'</u> FEET FROM THE <u>North</u> LINE AND <u>1450</u> FEET FROM THE <u>West</u> LINE OF SEC. <u>18</u> TWP. <u>32N</u> RGE. <u>6W</u> NMPM		10. Field and Pool or Wildcat <u>645.5N</u> <u>Under Fruitland Coal</u>	
		12. County San Juan	
		19. Proposed Depth 3170	
		19A. Formation Fruitland	
		20. Rotary or C.T. Rotary	
21. Elevations (Show whether DF, RT, etc.) 6555' GL		21A. Kind & Status Plug. Bond statewide	
		21B. Drilling Contractor	
		22. Approx. Date Work will start	

23.

PROPOSED CASING AND CEMENT PROGRAM

SIZE OF HOLE	SIZE OF CASING	WEIGHT PER FOOT	SETTING DEPTH	SACKS OF CEMENT	EST. TOP
12 1/4"	9 5/8"	36.0#	200'	130 cu.ft.	circ. surface
8 3/4"	7"	20.0#	3020'	216 cu.ft.	circ. surface
6 1/4"	5 1/2"	23.0#	3170'		circ. surface

The Fruitland Coal formation will be completed. OCT 21 1988

A 3000 psi WP and 6000 psi test double gate preventer equipped with blind and pipe rams will be used for blow out prevention on this well.

This gas is dedicated.

The NW 4 of Section 18 is dedicated to this well.

IN ABOVE SPACE DESCRIBE PROPOSED PROGRAM: IF PROPOSAL IS TO DEEPEN OR PLUG BACK, INDICATE ON PRESENT PRODUCTIVE ZONE AND PROPOSED NEW PRODUCTIVE ZONE. GIVE BLOWOUT PREVENTER PROGRAM, IF ANY.

I hereby certify that the information above is true and complete to the best of my knowledge and belief. DIST. 3

Signed Deputy Sheriff Title Regulatory Affairs Date 10-12-88

(This space for State Use)

APPROVED BY Ernie Bush TITLE DEPUTY OIL & GAS INSPECTOR, DIST. #3

CONDITIONS OF APPROVAL, IF ANY:

DATE

OCT 21 1988

All distances must be from the outer boundaries of the Section.

Operator <u>El Paso Natural Gas</u>		Lease <u>Allison Unit (Fee)</u>		Well No. <u>112</u>
Unit Letter <u>F</u>	Section <u>18</u>	Township <u>30 North</u>	Range <u>6 West</u>	County <u>San Juan</u>
Actual Footage Location of Wells 1800 feet from the North line and 1450 feet from the West line				
Ground Level Elev. <u>6555'</u>	Producing Formation <u>Fruitland Coal</u>	Pool <u>Undesignated</u>	Dedicated Acreage: <u>160 1/8 77</u> Acres	

1. Outline the acreage dedicated to the subject well by colored pencil or hachure marks on the plat below.
2. If more than one lease is dedicated to the well, outline each and identify the ownership thereof (both as to working interest and royalty).
3. If more than one lease of different ownership is dedicated to the well, have the interests of all owners been consolidated by communitization, unitization, force-pooling, etc?

☒ Yes ☐ No If answer is "yes," type of consolidation unitization

If answer is "no," list the owners and tract descriptions which have actually been consolidated. (Use reverse side of this form if necessary.)

No allowable will be assigned to the well until all interests have been consolidated (by communitization, unitization, forced-pooling, or otherwise) or until a non-standard unit, eliminating such interests, has been approved by the Division

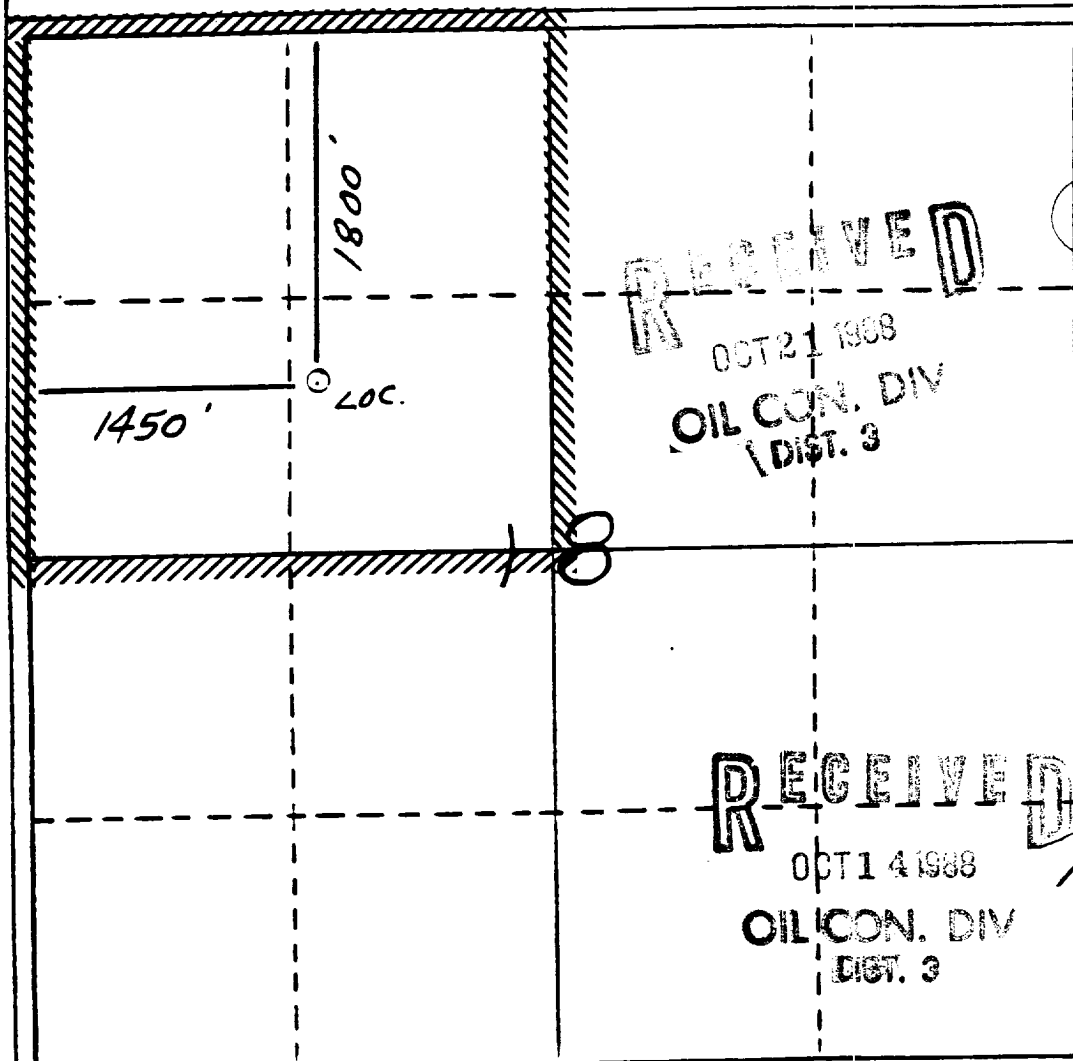

CERTIFICATION

I hereby certify that the information contained herein is true and complete to the best of my knowledge and belief.

Name Regulatory Affairs

Position El Paso Natural Gas

Company 10-12-88

Date

I hereby certify that the location shown on this plat was plotted from field notes of actual surveys made by me or under my supervision, and that the same is true and correct to the best of my knowledge and belief.

Date Surveyed 10-6-88

Registered Professional Engineer and/or Land Surveyor

Neale C. Edwards

Certificate No.

6557