

Submit to Appropriate
District Office
State Lease - 6 copies
Fee Lease - 5 copies

DISTRICT I
P.O. Box 1980, Hobbs, NM 88240

DISTRICT II
P.O. Drawer DD, Artesia, NM 88210

DISTRICT III
1000 Rio Brazos Rd., Aztec, NM 87410

State of New Mexico
Energy, Minerals and Natural Resources Department

OIL CONSERVATION DIVISION

P.O. Box 2088
Santa Fe, New Mexico 87504-2088

Form C-101
Revised 1-1-89

API NO. (assigned by OCD on New Wells)

30-045-27248

5. Indicate Type of Lease

STATE ☒

FEE ☐

6. State Oil & Gas Lease No.

APPLICATION FOR PERMIT TO DRILL, DEEPEN, OR PLUG BACK

1a. Type of Work:

DRILL ☒

RE-ENTER ☐

DEEPEN ☐

PLUG BACK ☐

b. Type of Well:

OIL
WELL ☐

GAS
WELL ☐

OTHER ☐

SINGLE
ZONE ☐

MULTIPLE
ZONE ☐

2. Name of Operator

GREAT WESTERN DRILLING CO.

3. Address of Operator

242 Petroleum Plaza, Farmington, NM 87401

4. Well Location

Unit Letter

I

:

935 Feet From The

East

Line and

1690

Feet From The

South

Line

Section 36

Township

31-N

Range

11-W

NMPM

San Juan

County

13. Elevations (Show whether DF, RT, GR, etc.)

6061' GR

14. Kind & Status Plug. Bond

State wide

15. Drilling Contractor

unknown

11. Formation

Mesa Verde

12. Rotary or C.T.

Rotary

17. PROPOSED CASING AND CEMENT PROGRAM

SIZE OF HOLE	SIZE OF CASING	WEIGHT PER FOOT	SETTING DEPTH	SACKS OF CEMENT	EST. TOP
14-3/4	10-3/4	40#	250±	325	Circulate
8-3/4	7"	23#	2800±	650	"
6-1/4	4 1/2"	10.50#	5100±	350	"

- 1 - Drill & set surface csg. w/circulation to surface.
- 2 - Set 10" 900 series, Hyd. B.O.P. on top of surface pipe, test to 1500# before drilling shoe jt.
- 3 - Drill 8-3/4" hole w/native mud or mist drill with air to 2800' ±
- 4 - Set 7" Csg. @ 2800' and circulate cement to surface w/stage tool.
- 5 - Set 10" 900 hydraulic B.O.P. on top of 7" csg. hanger, test to 2000# before drilling out shoe jt.
- 6 - Drill 6 1/2" hole to T.D. 5100' ±
- 7 - Set 4 1/2" liner 2700' to T.D. circulate cement behind liner and test to 2000#, determine by logs what to perforate and frac in Mesa Verde section.

IN ABOVE SPACE DESCRIBE PROPOSED PROGRAM: IF PROPOSAL IS TO DEEPEN OR PLUG BACK, GIVE DATA ON PRESENT PRODUCTIVE ZONE AND PROPOSED PRODUCTIVE ZONE. GIVE BLOWOUT PREVENTER PROGRAM, IF ANY.

I hereby certify that the information above is true and complete to the best of my knowledge and belief.

SIGNATURE

D E Baylee

TITLE

Superintendent

DATE March 20, 1989

TYPE OR PRINT NAME

TELEPHONE NO.

(This space for State Use)

SUPERVISOR DISTRICT

APPROVED BY

[Signature]

TITLE

DATE

MAR 21 1989

CONDITIONS OF APPROVAL, IF ANY:

APPROVAL EXPIRES 9-21-89
UNLESS DRILLING IS COMMENCED.
SPUD NOTICE MUST BE SUBMITTED
WITHIN 10 DAYS.

**NEW MEXICO OIL CONSERVATION COMMISSION
WELL LOCATION AND ACREAGE DEDICATION PLAT**

Form C-102
Supersedes C-328
Effective 1-1-85

All distances must be from the outer boundaries of the Section.

Operator GREAT WESTERN DRILLING COMPANY			Lease PUBCO STATE		Well No. 1-87
Unit Letter I	Section 36	Township 31 N	Range 11 W	County San Juan	
Actual Footage Location of Well: 1690 feet from the South line and 935 feet from the East line					
Ground Level Elev. 6061	Producing Formation N.V.	Pool Adams	Dedicated Acreage 7320 Acres		

1. Outline the acreage dedicated to the subject well by colored pencil or hachure marks on the plat below.
2. If more than one lease is dedicated to the well, outline each and identify the ownership thereof (both as to working interest and royalty).
3. If more than one lease of different ownership is dedicated to the well, have the interests of all owners been consolidated by communitization, unitization, force-pooling, etc?

☐ Yes ☐ No If answer is "yes," type of consolidation _____

If answer is "no," list the owners and tract descriptions which have actually been consolidated. (Use reverse side of this form if necessary.) _____

No allowable will be assigned to the well until all interests have been consolidated (by communitization, unitization, forced-pooling, or otherwise) or until a non-standard unit, eliminating such interests, has been approved by the Commission.

N 89°54'W

81.43 ch.

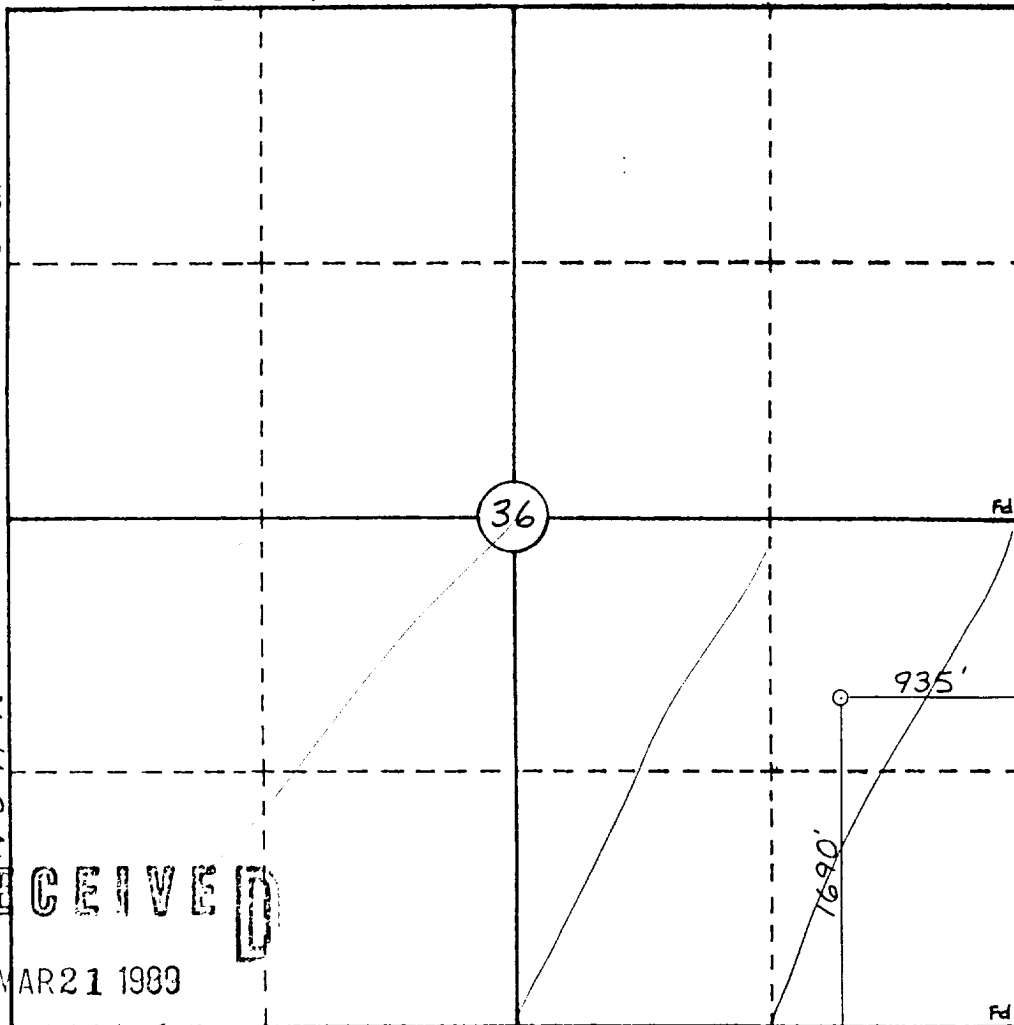

CERTIFICATION

I hereby certify that the information contained herein is true and complete to the best of my knowledge and belief.

Name **D. E. Bryant**
Position **Dist. Supervisor**
Company **Great Western Drilling Co.**
Date **3-23-89**

I hereby certify that the well location shown on this plat was plotted from field notes of actual surveys made by me or under my supervision, and that the same is true and correct to the best of my knowledge and belief.

Date Surveyed **3-13-89**
Surveyor **WILLIAM E. MAHNEY II**
Registered Professional Engineer and Land Surveyor
#8466
Certificate No. _____

RECEIVED

MAR 21 1989

N 00°11'W

81.12 ch.

GREAT WESTERN DRILLING COMPANY
PUBCO STATE 1-E
1690' FSL & 935' FEL
Sec. 36, T31N, R11W
San Juan Co., N.M.

