

Submit to Appropriate
District Office
State Lease - 6 copies
Fee Lease - 5 copies

State of New Mexico
Energy, Minerals and Natural Resources Department

Form C-101
Revised 1-1-89

OIL CONSERVATION DIVISION

P.O. Box 2088
Santa Fe, New Mexico 87504-2088

DISTRICT I
P.O. Box 1980, Hobbs, NM 88240

DISTRICT II
P.O. Drawer DD, Artesia, NM 88210

DISTRICT III
1000 Rio Brazos Rd., Aztec, NM 87410

API NO. (assigned by OCD on New Wells)
30-045-27750

5. Indicate Type of Lease
STATE ☒ FEE ☐

6. State Oil & Gas Lease No.
NM-E3091-E3093-E5094-E5387

APPLICATION FOR PERMIT TO DRILL, DEEPEN, OR PLUG BACK

1a. Type of Work:
DRILL ☒ RE-ENTER ☐ DEEPEN ☐ PLUG BACK ☐

b. Type of Well:
OIL WELL ☐ GAS WELL ☒ OTHER ☐ SINGLE ZONE ☒ MULTIPLE ZONE ☐

2. Name of Operator
NORTHWEST PIPELINE CORP

3. Address of Operator
3539 EAST 30TH ST. FARMINGTON, NM 87401

4. Well Location
Unit Letter B : 1110' Feet From The NORTH Line and 1292 Feet From The EAST Line
Section 16 Township T32N Range R11W NMPM SAN JUAN County

7. Lease Name or Unit Agreement Name
POX CANYON UNIT

8. Well No.
#201

9. Pool name or Wildcat
Basin Fruitland Coal

10. Proposed Depth
3255

11. Formation
FRUITLAND COAL

12. Rotary or C.T.
ROTARY

13. Elevations (Show whether DF, RT, GR, etc.)
6578' GR

14. Kind & Status Plug. Bond
SURETY BOND - CURRENT

15. Drilling Contractor
E/320

16. Approx. Date Work will start
JUNE 15, 1990

17. PROPOSED CASING AND CEMENT PROGRAM

SIZE OF HOLE	SIZE OF CASING	WEIGHT PER FOOT	SETTING DEPTH	SACKS OF CEMENT	EST. TOP
<u>12 1/4</u>	<u>9 5/8"</u>	<u>36 # K-55</u>	<u>200'</u>	<u>120 SK</u>	<u>SURFACE</u>
<u>8 5/4</u>	<u>7"</u>	<u>23 # K-55</u>	<u>2995'</u>	<u>415 SK</u>	<u>SURFACE</u>
<u>6 1/4</u>	<u>5 1/2"</u>	<u>23 # P-110</u>	<u>2895' to 3255'</u>	<u>NONE</u>	<u>N/A</u>

1) PLAN TO DRILL FRUITLAND COAL FROM 3018' TO 3252' AND SET LINER IN OPEN HOLE.

2) THE EAST HALF OF SECTION 16 IS DEDICATED TO THIS WELL

3) BOP: 8" 3000 # SCHAFER. N/ PIPE RAME & BLIND RAMS.

APPROVAL EXPIRES 10-23-90
UNLESS DRILLING IS COMMENCED.
SPUD NOTICE MUST BE SUBMITTED
WITHIN 10 DAYS

RECEIVED

APR 23 1990

OIL CON. DIV
DIST. 3

IN ABOVE SPACE DESCRIBE PROPOSED PROGRAM: IF PROPOSAL IS TO DEEPEN OR PLUG BACK, GIVE DATA ON PRESENT PRODUCTIVE ZONE AND PROPOSED NEW PRODUCTIVE ZONE. GIVE BLOWOUT PREVENTER PROGRAM, IF ANY.

I hereby certify that the information above is true and complete to the best of my knowledge and belief.

SIGNATURE Mark McCallister TITLE PRODUCTION & DRILLING ENGINEER DATE 4/20/90

TYPE OR PRINT NAME MARK MCCALLISTER TELEPHONE NO. 327-5351

(This space for State Use)

APPROVED BY [Signature] TITLE SUPERVISOR DISTRICT III DATE APR 23 1990

CONDITIONS OF APPROVAL, IF ANY:

RECEIVED

1971 11 18 11

OIL COM. DIV.
DET. 3

TO: DIRECTOR, FBI
FROM: SAC, NEW YORK
SUBJECT: [illegible]

RE: [illegible]

1971 11 18 11

1971 11 18 11

Submit to Appropriate
District Office
State Lease - 4 copies
Fee Lease - 3 copies

State of New Mexico
Energy, Minerals and Natural Resources Department

Form C-102
Revised 1-1-89

OIL CONSERVATION DIVISION
P.O. Box 2088
Santa Fe, New Mexico 87504-2088

DISTRICT I
P.O. Box 1980, Hobbs, NM 88240

DISTRICT II
P.O. Drawer DD, Artesia, NM 88210

DISTRICT III
1000 Rio Brazos Rd., Aztec, NM 87410

WELL LOCATION AND ACREAGE DEDICATION PLAT
All Distances must be from the outer boundaries of the section

Operator NORTHWEST PIPELINE CORP.		Lease COX CANYON UNIT		Well No. 201
Unit Letter B	Section 16	Township T.32 N.	Range R.11 W.	County SAN JUAN COUNTY
Actual Footage Location of Well: 1110 feet from the NORTH line and 1292 feet from the EAST line				
Ground level Elev. 6578	Producing Formation FRUITLAND	Pool BASIN FRUITLAND COAL		Dedicated Acreage: E/2 320 Acres

1. Outline the acreage dedicated to the subject well by colored pencil or hachure marks on the plat below.
2. If more than one lease is dedicated to the well, outline each and identify the ownership thereof (both as to working interest and royalty).
3. If more than one lease of different ownership is dedicated to the well, have the interest of all owners been consolidated by communitization, unitization, force-pooling, etc.?
☒ Yes ☐ No If answer is "yes" type of consolidation **UNITIZED**
If answer is "no" list the owners and tract descriptions which have actually been consolidated. (Use reverse side of this form if necessary.)
No allowable will be assigned to the well until all interests have been consolidated (by communitization, unitization, forced-pooling, or otherwise) or until a non-standard unit, eliminating such interest, has been approved by the Division.

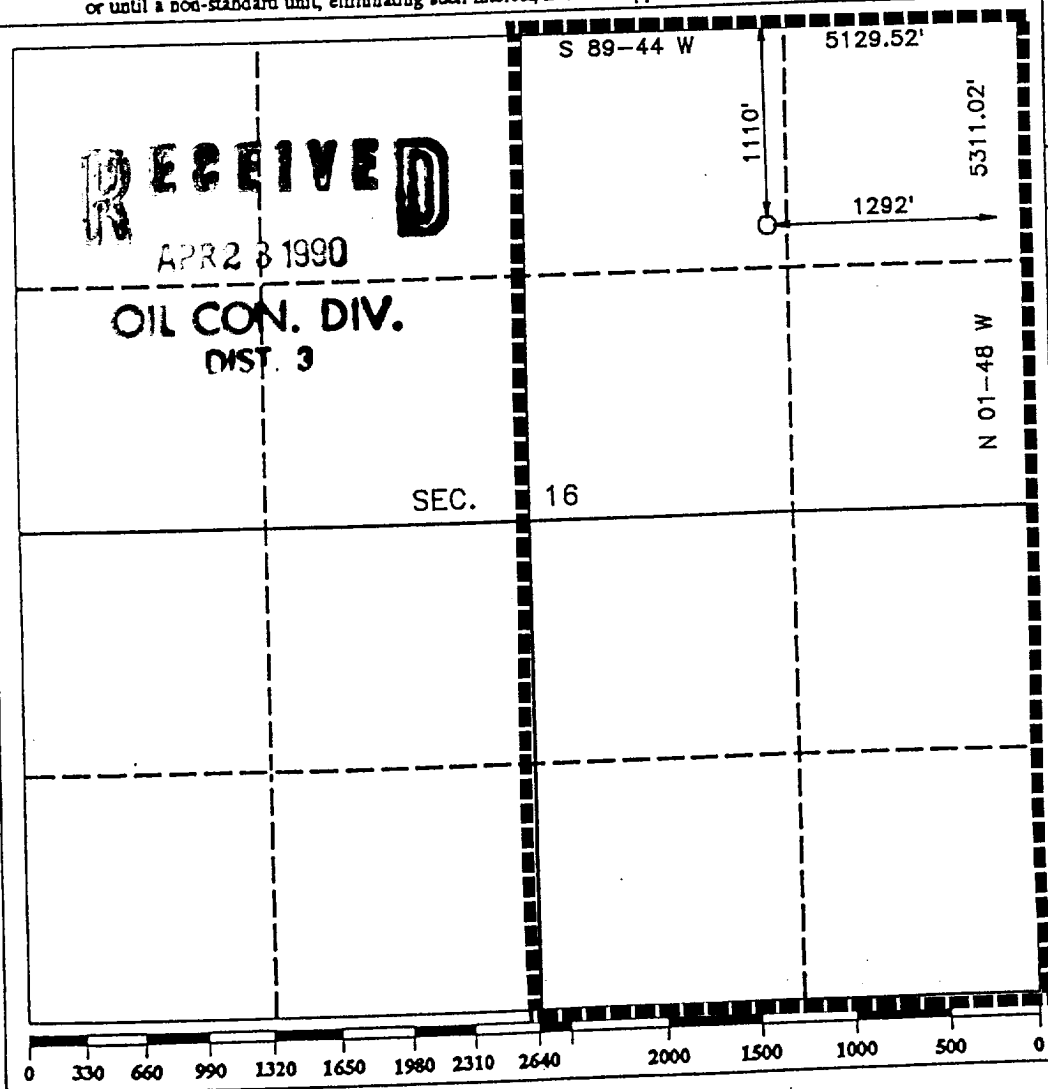

OPERATOR CERTIFICATION

I hereby certify that the information contained herein is true and complete to the best of my knowledge and belief.

Signature *Mark McCallister*
Printed Name **MARK MCCALLISTER**
Position **ENGINEER, PROD & DRLG**
Company **NORTHWEST PIPELINE CORP.**
Date **APRIL 12, 1990**

SURVEYOR CERTIFICATION

I hereby certify that the well location shown on this plat was plotted from field notes of actual surveys made by me or under my supervision, and that the same is true and correct to the best of my knowledge and belief.

Date Surveyed **APRIL 12, 1990**
Signature *R. Howard Dagge*
Professional Surveyor
R. HOWARD DAGGE
9879
Certificate No. **9879**
Registered Professional Land Surveyor

