

UNITED STATES
DEPARTMENT OF THE INTERIOR
BUREAU OF LAND MANAGEMENT

APPLICATION FOR PERMIT TO DRILL, DEEPEN, OR PLUG BACK

1a. TYPE OF WORK

DRILL ☒

DEEPEN ☐

PLUG BACK ☐

b. TYPE OF WELL

OIL WELL ☐

GAS WELL ☒

OTHER

Coal Seam

SINGLE ZONE ☒

MULTIPLE ZONE ☐

2. NAME OF OPERATOR

Amoco Production Company

ATTN: J. L. Hampton

3. ADDRESS OF OPERATOR

P. O. Box 800 Denver, Colorado 80201

4. LOCATION OF WELL (Report location clearly and in accordance with any State requirements.)*

At surface

1180' FSL, 1390' FWL
At proposed prod. zone

SE/SW

14. DISTANCE IN MILES AND DIRECTION FROM NEAREST TOWN OR POST OFFICE*

same

17 miles from Aztec, NM

15. DISTANCE FROM PROPOSED*

LOCATION TO NEAREST
PROPERTY OR LEASE LINE, FT.
(Also to nearest drlg. unit line, if any)

1180'

16. NO. OF ACRES IN LEASE

2,080

17. NO. OF ACRES ASSIGNED
TO THIS WELL

320 acres W/2

18. DISTANCE FROM PROPOSED*

TO NEAREST WELL, DRILLING, COMPLETED,
OR APPLIED FOR, ON THIS LEASE, FT.

19. PROPOSED DEPTH

3397' TD

20. ROTARY OR CABLE TOOLS

Rotary

21. ELEVATIONS (Show whether DF, RT, GR, or other)

6473 GR

DRILLING OPERATIONS AUTHORIZED ARE
SUBJECT TO COMPLIANCE WITH ATTACHED

22. APPROX. DATE WORK WILL START*

As soon as permitted

23.

"GENERAL PROPOSED DRILLING AND CEMENTING PROGRAM"

SIZE OF HOLE	SIZE OF CASING	WEIGHT PER FOOT	SETTING DEPTH	QUANTITY OF CEMENT
12 1/4"	8 5/8"	24# 36#	250'	250 cf (cement to surface)
2 7/8"	5 1/2" 7	17# 20#	3397' (TD)	951 cf (cement to surface)
open hole or 4 1/2" liner				

Notice of Staking was submitted: 3/22/90

Lease Description:

T32N-R11W

Sec.13: S/2

Sec.14: E/2 SE/4

Sec.15: W/2 SW/4

Sec.22: N/2 Nw/4, SW/4

Sec.23: S/2 NE/4, NW/4 Nw/4, E/2 SW/4, SE/4

Sec.24: NE/4, S/2 NW/4

Sec.26: NE/4, E/2 NW/4, SW/4, SW/4 SE/4

Sec.27: N/2

IN ABOVE SPACE DESCRIBE PROPOSED PROGRAM: If proposal is to deepen or plug back, give data on present productive zone and proposed new productive zone. If proposal is to drill or deepen directionally, give pertinent data on subsurface locations and measured and true vertical depths. Give blowout preventer program, if any.

24.

J.L. Hampton

SIGNED

J.L. Hampton/US

TITLE Sr. Staff Admin. Supv.

DATE

4/4/90

(This space for Federal or State office use)

PERMIT NO.

APPROVAL DATE

APPROVED

APPROVED BY

CONDITIONS OF APPROVAL, IF ANY:

TITLE

NMOCD

APR 30 1990

FOR Ken Townsend
AREA MANAGER

*See Instructions On Reverse Side

Submit to Appropriate
District Office
State Lease - 4 copies
Fee Lease - 3 copies

State of New Mexico
Energy, Minerals and Natural Resources Department

Form C-102
Revised 1-1-89

OIL CONSERVATION DIVISION

DISTRICT I
P.O. Box 1980, Hobbs, NM 88240

P.O. Box 2088

Santa Fe, New Mexico 87504-2088

DISTRICT II
P.O. Drawer DD, Artesia, NM 88210

DISTRICT III
1000 Rio Brazos Rd., Aztec, NM 87410

WELL LOCATION AND ACREAGE DEDICATION PLAT

All Distances must be from the outer boundaries of the section

Operator AMOCO PRODUCTION COMPANY			Lease BARNES GAS COM /B/		Well No. # 1
Unit Letter N	Section 22	Township 32 NORTH	Range 11 WEST	County SAN JUAN	
Actual Footage Location of Well: 1180 feet from the SOUTH line and 1390 feet from the WEST line					
Ground level Elev. 6473	Producing Formation Fruitland Coal		Pool Basin Fruitland Coal Gas		Dedicated Acreage: 320 Acres
<p>1. Outline the acreage dedicated to the subject well by colored pencil or hatchure marks on the plat below.</p> <p>2. If more than one lease is dedicated to the well, outline each and identify the ownership thereof (both as to working interest and royalty).</p> <p>3. If more than one lease of different ownership is dedicated to the well, have the interest of all owners been consolidated by communitization, unitization, force-pooling, etc.? <input type="checkbox"/> Yes <input type="checkbox"/> No If answer is "yes" type of consolidation _____</p> <p>If answer is "no" list the owners and tract descriptions which have actually been consolidated. (Use reverse side of this form if necessary.) _____</p> <p>No allowable will be assigned to the well until all interests have been consolidated (by communitization, unitization, forced-pooling, or otherwise) or until a non-standard unit, eliminating such interest, has been approved by the Division.</p>					

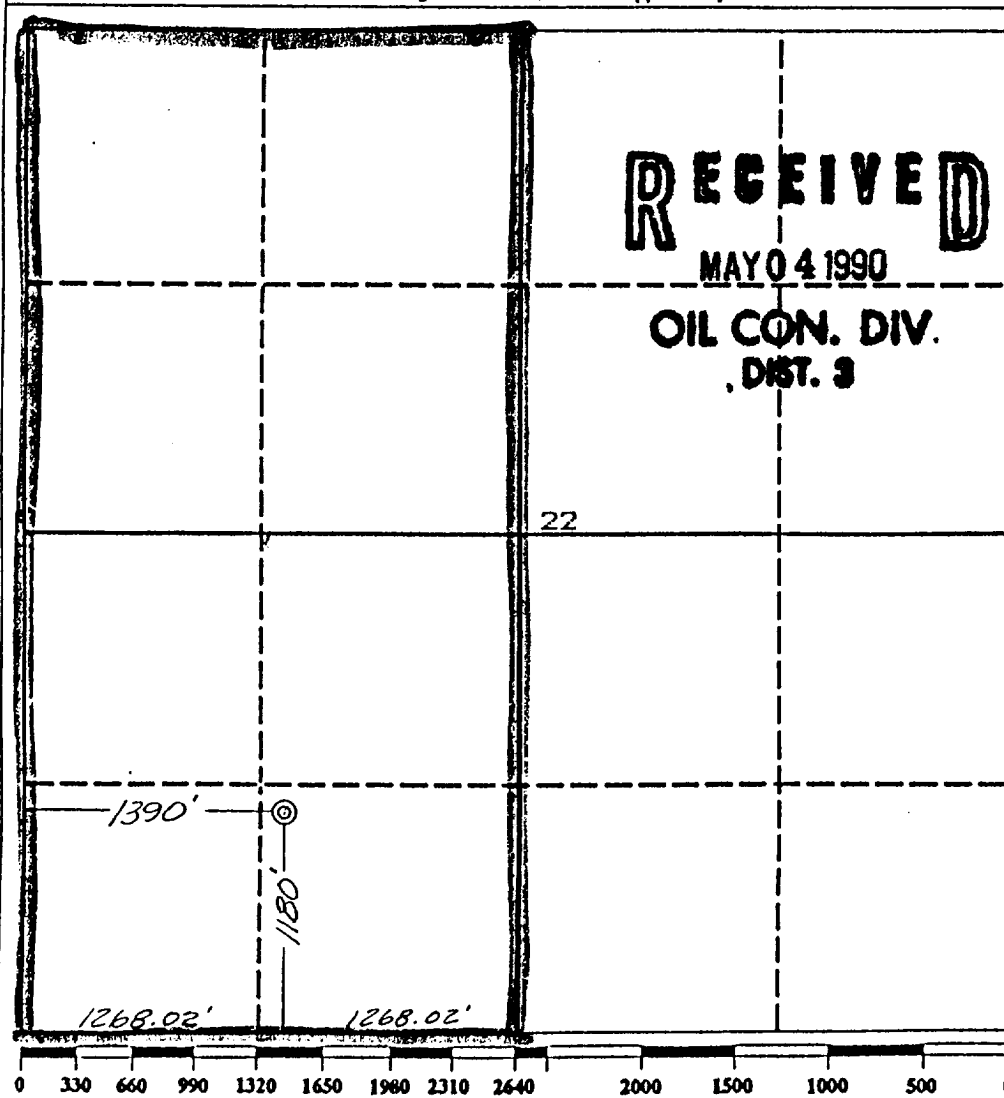

OPERATOR CERTIFICATION

I hereby certify that the information contained herein is true and complete to the best of my knowledge and belief.

Signature *J. L. Hampton*
Printed Name **J. L. Hampton**
Position **Se. Staff Admin. Supr**
Company **Amoco Prod. Company**
Date **3/22/90**

SURVEYOR CERTIFICATION

I hereby certify that the well location shown on this plat was plotted from field notes of actual surveys made by me or under my supervision, and that the same is true and correct to the best of my knowledge and belief.

Date Surveyed
March 16, 1990

Signature & Seal of Professional Surveyor
GARY D. VANN
Registered Professional Land Surveyor
7016

RECEIVED
JAN 10 1964
U.S. AIR FORCE

NOV 10 1963
U.S. AIR FORCE

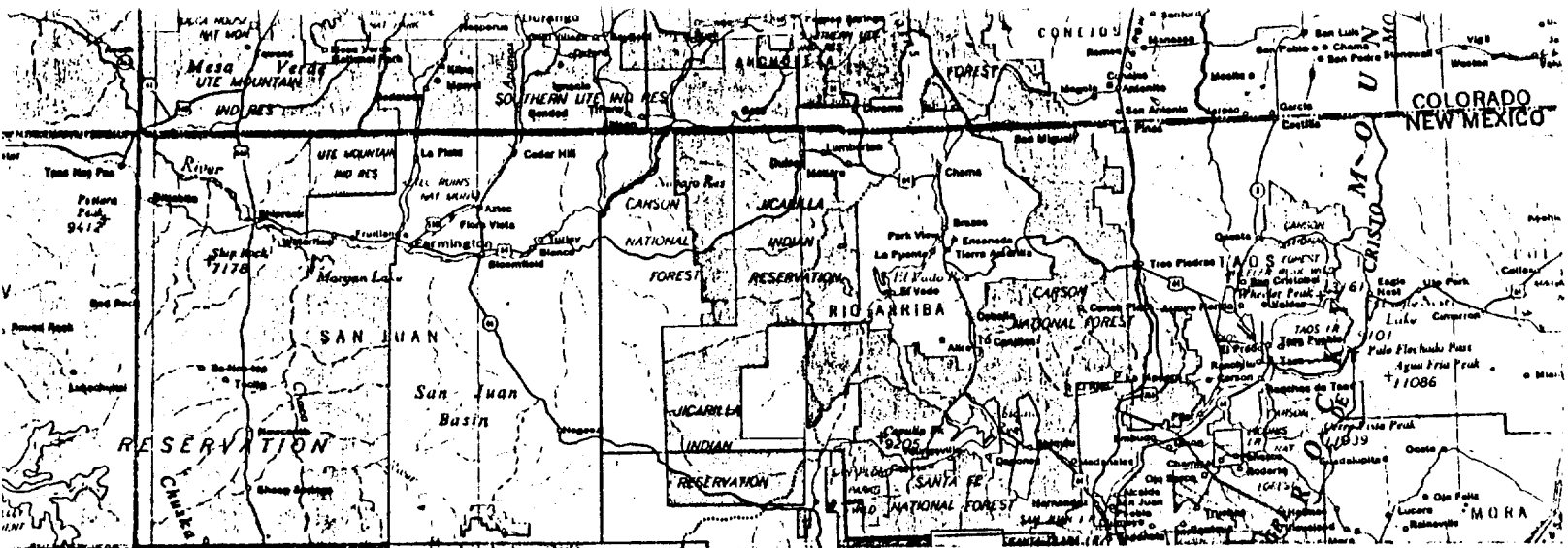

BARNES GAS COM /B/ # 1
 1180' F/SL 1390' F/WL
 SEC. 22, T32N, R11W, NMPM
 RAIL POINT: 159 miles from Montrose, Co.
 MUD POINT: 17 miles from Aztec, NM
 CEMENT POINT: 31 miles from Farmington, NM

