

UNITED STATES  
DEPARTMENT OF THE INTERIOR  
BUREAU OF LAND MANAGEMENT

APPLICATION FOR PERMIT TO DRILL, DEEPEN, OR PLUG BACK

1a. TYPE OF WORK

DRILL ☒

DEEPEN ☐

PLUG BACK ☐

b. TYPE OF WELL

OIL  
WELL ☐

GAS  
WELL ☒

OTHER

Coal Seam

SINGLE  
ZONE ☒

MULTIPLE  
ZONE ☐

2. NAME OF OPERATOR

Amoco Production Company

ATTN: J. L. Hampton

3. ADDRESS OF OPERATOR

P. O. Box 800 Denver, Colorado 80201

4. LOCATION OF WELL (Report location clearly and in accordance with any State requirements.)\*

At surface  
1520' FSL, 1805' FWL

NE/SW

At proposed prod. zone

same

14. DISTANCE IN MILES AND DIRECTION FROM NEAREST TOWN OR POST OFFICE\*

13 miles from Aztec, NM

10. DISTANCE FROM PROPOSED\*

LOCATION TO NEAREST  
PROPERTY OR LEASE LINE, FT.  
(Also to nearest drilg. unit line, if any)

1520'

18. DISTANCE FROM PROPOSED LOCATION\*

TO NEAREST WELL, DRILLING, COMPLETED,  
OR APPLIED FOR, ON THIS LEASE, FT.

10. NO. OF ACRES IN LEASE

2,080

19. PROPOSED DEPTH

3454 TD

17. NO. OF ACRES ASSIGNED  
TO THIS WELL

320 acres S/2

20. ROTARY OR CABLE TOOLS

Rotary

21. ELEVATIONS (Show whether DF, RT, GR, etc.)

6446

GR

This action is subject to technical and  
procedural review pursuant to 43 CFR 3165.3

and appeal pursuant to 43 CFR 3165.4  
PROPOSED CASING AND CEMENTING PROGRAM

22. APPROX. DATE WORK WILL START\*

As soon as permitted

SIZE OF HOLE	SIZE OF CASING	WEIGHT PER FOOT	SETTING DEPTH	QUANTITY OF CEMENT
12 1/4"	8 5/8"	24#	250'	250 cf (cement to surface)
7 7/8"	5 1/2"	17#	3454' (TD)	967 cf (cement to surface)

Notice of Staking was submitted: 3/22/90

Lease Description:

T32N R11W

Sec.13: S/2

Sec.14: E/2 SE/4

Sec.15: W/2 SW/4

Sec.22: N/2 NW/4, SW/4

Sec.23: S/2 NE/4, NW/4 NW/4, E/2 SW/4, SE/4

Sec.24: NE/4, S/2 NW/4

Sec.26: NE/4, E/2 NW/4, SW/4, SW/4 Se/4

Sec.27: N/2

IN ABOVE SPACE DESCRIBE PROPOSED PROGRAM: If proposal is to deepen or plug back, give data on present productive zone and proposed new productive zone. If proposal is to drill or deepen directionally, give pertinent data on subsurface locations and measured and true vertical depths. Give blowout preventer program, if any.

23.

J.L. Hampton

SIGNED

J.L. Hampton/CB

TITLE Sr. Staff Admin. Supv.

DATE

4/4/90

(This space for Federal or State office use)

PERMIT NO.

APPROVAL DATE

APPROVED  
AS AMENDED

APPROVED BY

CONDITIONS OF APPROVAL, IF ANY:

TITLE

MAY 02 1990

AREA MANAGER

\*See Instructions On Reverse Side

RECEIVED  
JAN 1971  
VHS 100-100  
2 100

Submit to Appropriate  
District Office  
State Lease - 4 copies  
Fee Lease - 3 copies

State of New Mexico  
Energy, Minerals and Natural Resources Department

Form C-102  
Revised 1-1-89

OIL CONSERVATION DIVISION

DISTRICT I  
P.O. Box 1980, Hobbs, NM 88240

P.O. Box 2088

Santa Fe, New Mexico 87504-2088

DISTRICT II  
P.O. Drawer DD, Artesia, NM 88210

DISTRICT III  
1000 Rio Brazos Rd., Aztec, NM 87410

WELL LOCATION AND ACREAGE DEDICATION PLAT

All Distances must be from the outer boundaries of the section

Operator <b>AMOCO PRODUCTION COMPANY</b>			Lease <b>BARNES GAS COM /F/</b>		Well No. <b># 1</b>
Unit Letter <b>K</b>	Section <b>26</b>	Township <b>32 NORTH</b>	Range <b>11 WEST</b>	County <b>SAN JUAN</b>	

Actual Footage Location of Well:

1520 feet from the <b>SOUTH</b> line and		1805 feet from the <b>WEST</b> line	
Ground level Elev. <b>6446</b>	Producing Formation <b>Fruitland Coal</b>	Pool <b>Basin-Fruitland Coal Gas</b>	Dedicated Acreage: <b>320</b> Acres <b>5/2</b>

- Outline the acreage dedicated to the subject well by colored pencil or hatchure marks on the plat below.
- If more than one lease is dedicated to the well, outline each and identify the ownership thereof (both as to working interest and royalty).
- If more than one lease of different ownership is dedicated to the well, have the interest of all owners been consolidated by communization, unitization, force-pooling, etc.?  
☐ Yes ☐ No If answer is "yes" type of consolidation \_\_\_\_\_  
If answer is "no" list the owners and tract descriptions which have actually been consolidated. (Use reverse side of this form if necessary). \_\_\_\_\_  
No allowable will be assigned to the well until all interests have been consolidated (by communization, unitization, forced-pooling, or otherwise) or until a non-standard unit, eliminating such interest, has been approved by the Division.

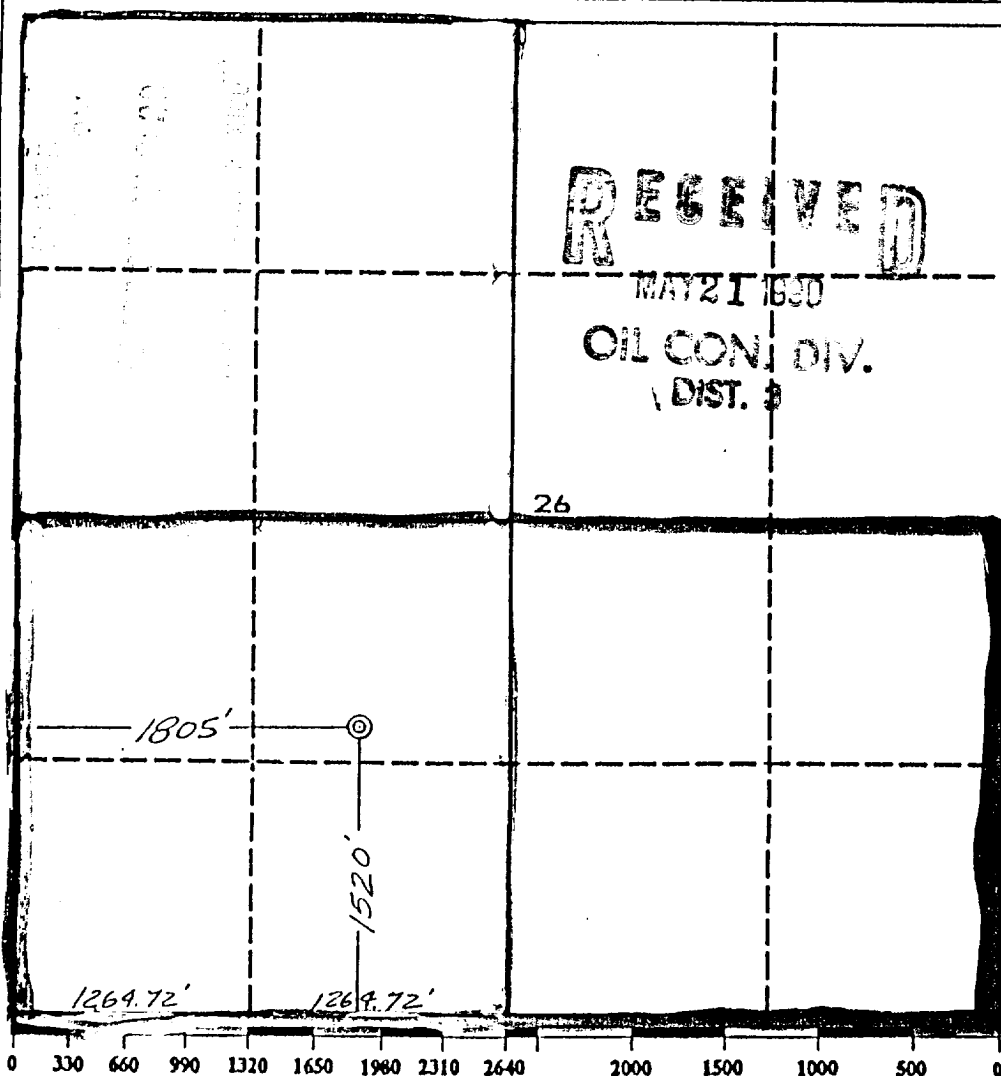

OPERATOR CERTIFICATION

I hereby certify that the information contained herein is true and complete to the best of my knowledge and belief.

Signature **J.L. Hampton/cub**  
Printed Name **J.L. HAMPTON**  
Position **Sr. Staff Admin Supr**  
Company **Amoco Prod. Company**  
Date **3/21/90**

SURVEYOR CERTIFICATION

I hereby certify that the well location shown on this plat was plotted from field notes of actual surveys made by me or under my supervision, and that the same is true and correct to the best of my knowledge and belief.

Date Surveyed  
**March 16, 1990**

Signature & Seal of Professional Surveyor  
**GARY D. VANN**  
**7016**  
Gary  
Certification  
**7016**

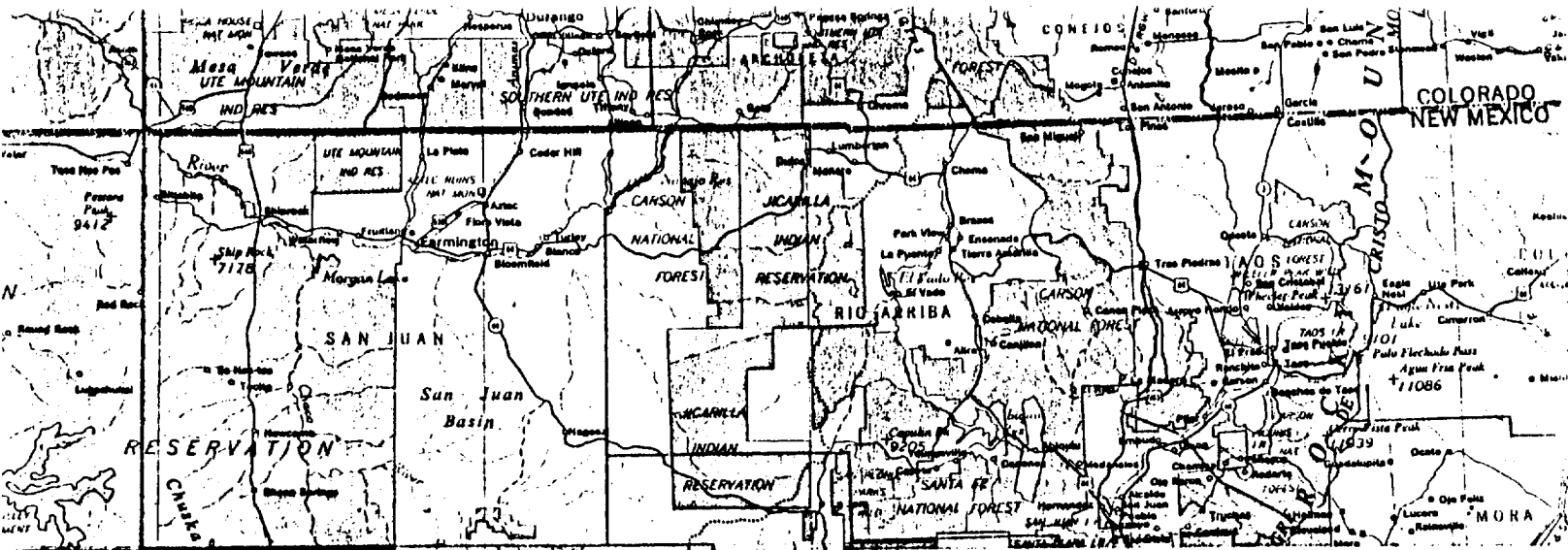

BARNES GAS COM /F/ # 1  
 1520' F/SL 1805' F/WL  
 SEC. 26, T32N, R11W, NMPM  
 RAIL POINT: 155 miles from Montrose, CO  
 MUD POINT: 13 miles from Aztec, NM  
 CEMENT POINT: 27 miles from Farmington, NM

