

UNITED STATES
DEPARTMENT OF THE INTERIOR
BUREAU OF LAND MANAGEMENT

(Other instructions on reverse side)

Expires 7/1/91

APPLICATION FOR PERMIT TO DRILL, DEEPEN, OR PLUG BACK

1a. TYPE OF WORK

DRILL ☒

DEEPEN ☐

PLUG BACK ☐

b. TYPE OF WELL

OIL WELL ☐

GAS WELL ☒

OTHER ☐

2. NAME OF OPERATOR

NORTHWEST PIPELINE CORPORATION

3. ADDRESS OF OPERATOR

3539 EAST 30TH ST, FARMINGTON, NM 87401

4. LOCATION OF WELL (Report location clearly and in accordance with any State requirements.)

2075' FNL
1050' FEL

UNIT H

At proposed prod. zone

SAME

14. DISTANCE IN MILES AND DIRECTION FROM NEAREST TOWN OR POST OFFICE*

APPROXIMATELY 7.6 MILES NW OF CEDAR HILL, NM

16. NO. OF ACRES IN LEASE

1384.60

17. NO. OF ACRES ASSIGNED TO THIS WELL

E/2 320 ACRES

15. DISTANCE FROM PROPOSED LOCATION TO NEAREST PROPERTY OR LEASE LINE, FT. (Also to nearest drlg. unit line, if any)

1050'

18. PROPOSED DEPTH

3345' KB

20. ROTARY OR CABLE TOOLS

ROTARY

18. DISTANCE FROM PROPOSED LOCATION TO NEAREST WELL, DRILLING, COMPLETED, OR APPLIED FOR, ON THIS LEASE, FT.

± 233'

22. APPROX. DATE WORK WILL START*

JUNE 15, 1990

21. ELEVATIONS (Show whether DF, RT, GR, etc.)

6692' GR

This action is subject to technical and procedural review pursuant to 43 CFR 3105.5 and 43 CFR 3105.6.

PROPOSED CASING AND CEMENTING PROGRAM

	WEIGHT PER FOOT	SETTING DEPTH
12 1/4"	36 # K-55	200'
8 3/4"	23 # K-55	3080'
5 1/2"	23 # P-110	2980' to 3345'

DRILLING OPERATIONS AUTHORIZED ARE SUBJECT TO COMPLIANCE WITH ATTACHED GENERAL REQUIREMENTS.

120 SX (1143 cu ft)

425 SX (814 cu ft)

NONE - OPEN HOLE

- 1) PLAN TO DRILL FRUITLAND FROM 3129' TO 3333' AND SET LINER IN OPEN HOLE. IF OPEN HOLE PROVES UNPRODUCTIVE, THE 5 1/2" LINER WILL BE CHANGED TO 15.5 # K-55, CEMENTED AND HYDRAULICALLY STIMULATED AS NECESSARY.
- 2) THE E/2 HALF OF SECTION 20 IS DEDICATED TO THIS WELL

RECEIVED

JUN 18 1990

OIL CON. DIV. DIST. 3

IN ABOVE SPACE DESCRIBE PROPOSED PROGRAM: If proposal is to deepen or plug back, give data on present productive zone. If proposal is to drill or deepen directionally, give pertinent data on subsurface locations and measured and true vertical depths. Give blow preventer program, if any.

SIGNED Mark McCallister

TITLE PRODUCTION & DRILLING ENGINEER

DATE 4/20/90

(This space for Federal or State office use)

APPROVAL DATE

PERMIT NO.

TITLE

APPROVED BY CONDITIONS OF APPROVAL, IF ANY:

APPROVE

JUN 18 1990 AREA MANAGER

*See Instructions On Reverse Side

Title 18 U.S.C. Section 1001, makes it a crime for any person knowingly and willfully to make to any department or agency of the United States any false, fictitious or fraudulent statements or representations as to any matter within its jurisdiction.

[illegible]

... ..

Submit to Appropriate
District Office
State Lease - 4 copies
Fee Lease - 3 copies

State of New Mexico
Energy, Minerals and Natural Resources Department

Form C-102
Revised 1-1-89

OIL CONSERVATION DIVISION

P.O. Box 2088
Santa Fe, New Mexico 87504-2088

DISTRICT I
P.O. Box 1980, Hobbs, NM 88240

DISTRICT II
P.O. Drawer DD, Artesia, NM 88210

DISTRICT III
1000 Rio Brazos Rd., Aztec, NM 87410

WELL LOCATION AND ACREAGE DEDICATION PLAT

All Distances must be from the outer boundaries of the section

Operator NORTHWEST PIPELINE CORP.			Lease COX CANYON UNIT		Well No. 205
Unit Letter H	Section 20	Township T.32 N.	Range R.11 W.	County SAN JUAN COUNTY	
Actual Footage Location of Well: 2075 feet from the NORTH line and 1050 feet from the EAST line					
Ground level Elev. 6692	Producing Formation FRUITLAND		Pool BASIN FRUITLAND COAL		Dedicated Acreage: E/2 320 Acres

- Outline the acreage dedicated to the subject well by colored pencil or hatchure marks on the plat below.
- If more than one lease is dedicated to the well, outline each and identify the ownership thereof (both as to working interest and royalty).
- If more than one lease of different ownership is dedicated to the well, have the interest of all owners been consolidated by communitization, unitization, force-pooling, etc.?
☒ Yes ☐ No If answer is "yes" type of consolidation UNITIZED
If answer is "no" list the owners and tract descriptions which have actually been consolidated. (Use reverse side of this form if necessary.)
No allowable will be assigned to the well until all interests have been consolidated (by communitization, unitization, forced-pooling, or otherwise) or until a non-standard unit, eliminating such interest, has been approved by the Division.

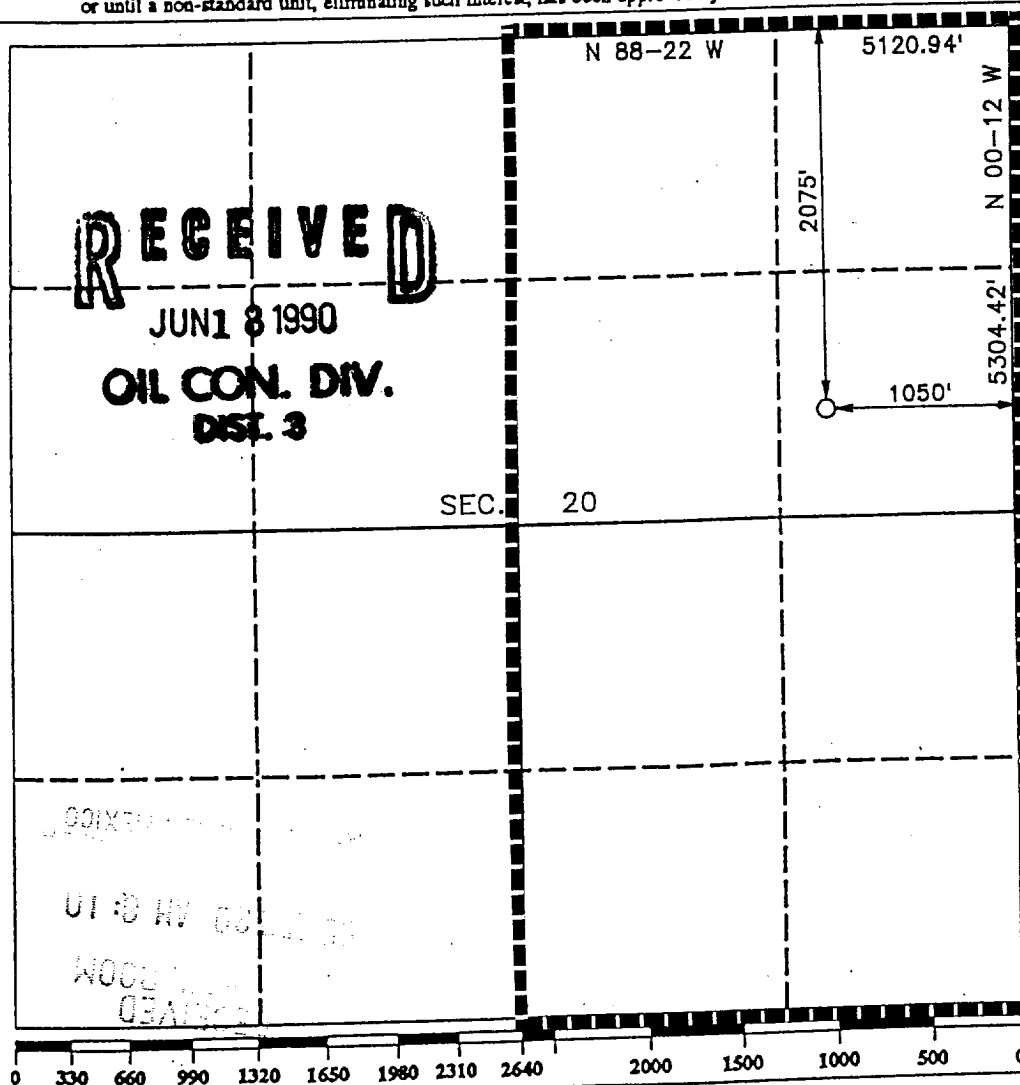

OPERATOR CERTIFICATION

I hereby certify that the information contained herein is true and complete to the best of my knowledge and belief.

Signature
Mark McCallister
Printed Name
MARK MCCALLISTER
Position
PROD. & DRG. ENGINEER
Company
NORTHWEST PIPELINE CORP.
Date
APRIL 17, 1990

SURVEYOR CERTIFICATION

I hereby certify that the well location shown on this plat was plotted from field notes of actual surveys made by me or under my supervision, and that the same is true and correct to the best of my knowledge and belief.

Date Surveyed
APRIL 16, 1990
Signature & Seal of Professional Surveyor
R. HOWARD DAGGETT
Certificate No.
9679
Registered Professional
Land Surveyor

