

UNITED STATES
DEPARTMENT OF THE INTERIOR
BUREAU OF LAND MANAGEMENT

(Other instructions on
reverse side)

Budget Bureau No. 1004-0136
Expires August 31, 1985

APPLICATION FOR PERMIT TO DRILL, DEEPEN, OR PLUG BACK

1a. TYPE OF WORK
DRILL ☒ DEEPEN ☐ PLUG BACK ☐

b. TYPE OF WELL
OIL WELL ☐ GAS WELL ☒ OTHER ☐ SINGLE ZONE ☒ MULTIPLE ZONE ☐

2. NAME OF OPERATOR
NORTHWEST PIPELINE CORPORATION

3. ADDRESS OF OPERATOR
3539 EAST 30TH ST, FARMINGTON, NM 87401

4. LOCATION OF WELL (Report location clearly and in accordance with any State requirements.)
At surface 2014' FSL 1805' FWL UNIT K
At proposed prod. zone SAME

14. DISTANCE IN MILES AND DIRECTION FROM NEAREST TOWN OR POST OFFICE*
APPROXIMATELY 6.4 MILES NW OF CEDAR HILL, NM

16. NO. OF ACRES IN LEASE
1384.60

17. NO. OF ACRES ASSIGNED TO THIS WELL
W/2 320 ACRES

18. DISTANCE FROM PROPOSED LOCATION* TO NEAREST WELL, DRILLING, COMPLETED, OR APPLIED FOR, ON THIS LEASE, FT.
± 185'

19. PROPOSED DEPTH
3580' KB

20. ROTARY OR CABLE TOOLS
ROTARY

21. ELEVATIONS (Show whether DF, RT, GR, etc.)
6890 GR

22. APPROX. DATE WORK WILL START*
JUNE 15, 1990

5. LEASE DESIGNATION AND SERIAL NO.
NMO3189

6. IF INDIAN, ALLOTTEE OR TRIBE NAME

7. UNIT AGREEMENT NAME
COX CANYON UNIT

8. FARM OR LEASE NAME
COX CANYON UNIT

9. WELL NO.
#207

10. FIELD AND POOL, OR WILDCAT
BASIN FRUITLAND COAL

11. SEC., T., R., M., OR BLK. AND SURVEY OR AREA
SECTION 21, T32N, R11W

12. COUNTY OR PARISH
SAN JUAN

13. STATE
NM

This action is subject to technical and procedural review pursuant to 43 CFR 3106.3 and appeal pursuant to 43 CFR 3106.4.

	WEIGHT PER FOOT	SETTING DEPTH	QUANTITY OF CEMENT
12 1/4"	36 # K-55	200'	120 SX (143 cu ft)
8 3/4"	23 # K-55	3310'	455 SX (876 cu ft)
5 1/2"	23 # P-110	3210' to 3580'	NONE - OPEN HOLE

1) PLAN TO DRILL FRUITLAND FROM 3333' TO 3579' AND SET LINER IN OPEN HOLE. IF OPEN HOLE PROVES UNPRODUCTIVE, THE 5 1/2" LINER WILL BE CHANGED TO 15.5 # K-55, CEMENTED AND HYDRAULICALLY STIMULATED AS NECESSARY.

2) THE WEST HALF OF SECTION 21 IS DEDICATED TO THIS WELL

RECEIVED
JUN 18 1990

IN ABOVE SPACE DESCRIBE PROPOSED PROGRAM: If proposal is to deepen or plug back, give data on present production zone and proposed productive zone. If proposal is to drill or deepen directionally, give pertinent data on subsurface locations and measured and true vertical depths. Give blowout preventer program, if any.

24. SIGNED Mark McCallister TITLE PRODUCTION & DRILLING ENGINEER DATE 4/20/90
(This space for Federal or State office use)

PERMIT NO. APPROVAL DATE
APPROVED BY TITLE DATE
CONDITIONS OF APPROVAL, IF ANY:
NMOCD
APPROVED
JUN 18 1990
AREA MANAGER

*See Instructions On Reverse Side

Title 18 U.S.C. Section 1001, makes it a crime for any person knowingly and willfully to make to any department or agency of the United States any false, fictitious or fraudulent statements or representations as to any matter within its jurisdiction.

Submit to Appropriate
District Office
State Lease - 4 copies
Fee Lease - 3 copies

State of New Mexico
Energy, Minerals and Natural Resources Department

Form C-102
Revised 1-1-89

OIL CONSERVATION DIVISION

P.O. Box 2088
Santa Fe, New Mexico 87504-2088

DISTRICT I
P.O. Box 1980, Hobbs, NM 88240

DISTRICT II
P.O. Drawer DD, Artesia, NM 88210

DISTRICT III
1000 Rio Brazos Rd., Aztec, NM 87410

WELL LOCATION AND ACREAGE DEDICATION PLAT

All Distances must be from the outer boundaries of the section

Operator NORTHWEST PIPELINE CORP.		Lease COX CANYON UNIT		Well No. 207
Unit Letter K	Section 21	Township 1.32 N.	Range R.11 W. NMPM	County SAN JUAN COUNTY
Actual Footage Location of Well: 2014 feet from the SOUTH line and 1805 feet from the WEST line				
Ground level Elev. 6890	Producing Formation FRUITLAND	Pool BASIN FRUITLAND COAL	Dedicated Acreage: W/2 320 Acres	
<p>1. Outline the acreage dedicated to the subject well by colored pencil or hatchure marks on the plat below.</p> <p>2. If more than one lease is dedicated to the well, outline each and identify the ownership thereof (both as to working interest and royalty).</p> <p>3. If more than one lease of different ownership is dedicated to the well, have the interest of all owners been consolidated by communitization, unitization, force-pooling, etc.?</p> <p><input checked="" type="checkbox"/> Yes <input type="checkbox"/> No If answer is "yes" type of consolidation UNITIZED</p> <p>If answer is "no" list the owners and tract descriptions which have actually been consolidated. (Use reverse side of this form if necessary.)</p> <p>No allowable will be assigned to the well until all interests have been consolidated (by communitization, unitization, forced-pooling, or otherwise) or until a non-standard unit, eliminating such interest, has been approved by the Division.</p>				

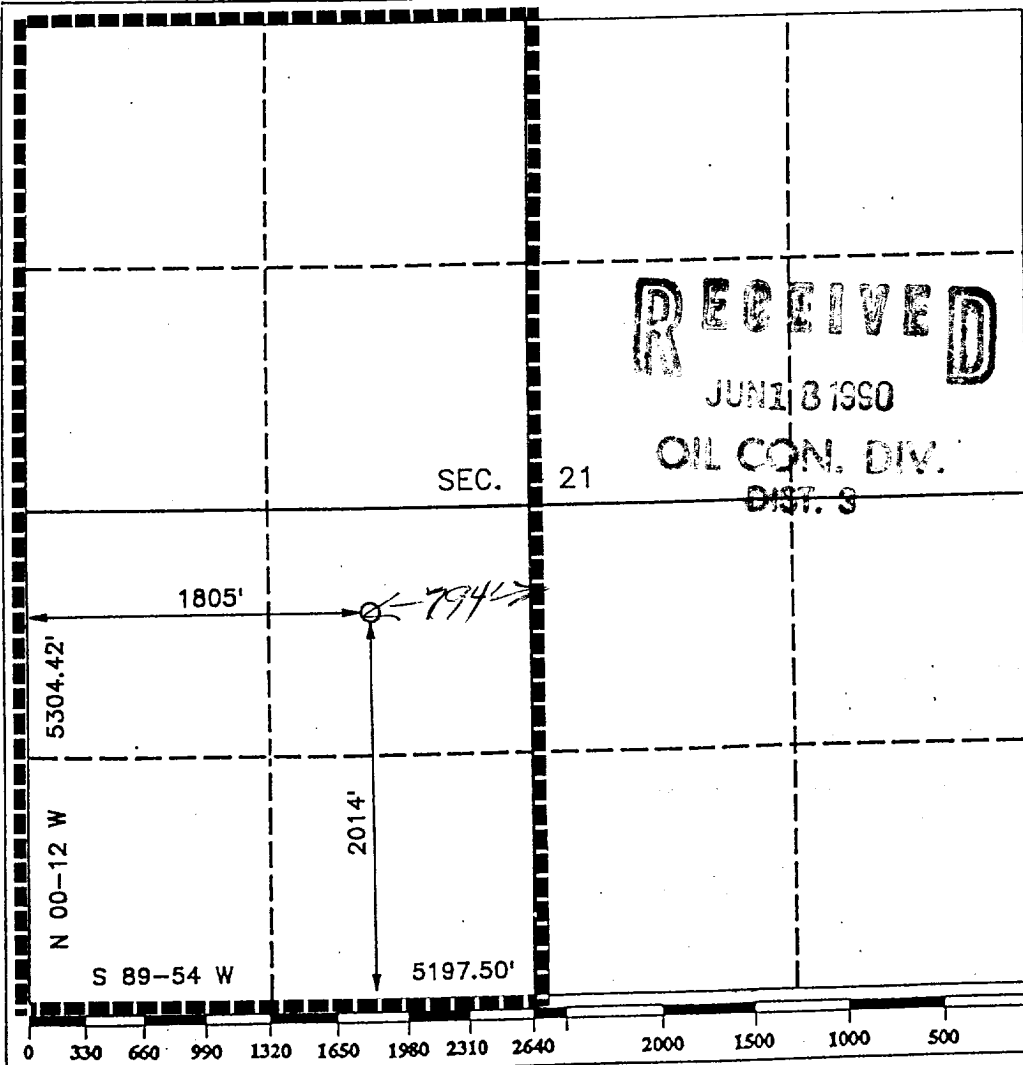

OPERATOR CERTIFICATION

I hereby certify that the information contained herein is true and complete to the best of my knowledge and belief.

Signature <i>Mark McCallister</i>
Printed Name MARK MCCALLISTER
Position PROD. & DRILG. ENGINEER
Company NORTHWEST PIPELINE CORP.
Date APRIL 18, 1990

SURVEYOR CERTIFICATION

I hereby certify that the well location shown on this plat was plotted from field notes of actual surveys made by me or under my supervision, and that the same is true and correct to the best of my knowledge and belief.

Date Surveyed APRIL 18, 1990
Signature & Seal of Professional Surveyor <i>R. Howard Daggett</i> R. HOWARD DAGGETT 9670
Certificate No. 9670
Registered Professional Land Surveyor

