

UNITED STATES
DEPARTMENT OF THE INTERIOR
BUREAU OF LAND MANAGEMENT

SUBMIT IN TRIPLICATE*
(Other instructions on
reverse side)

Form approved.
Budget Bureau No. 1004-0136
Expires August 31, 1985

APPLICATION FOR PERMIT TO DRILL, DEEPEN, OR PLUG BACK

1a. TYPE OF WORK DRILL <input checked="" type="checkbox"/> DEEPEN <input checked="" type="checkbox"/> PLUG BACK <input type="checkbox"/>		5. LEASE DESIGNATION AND SERIAL NO. NM-010910 - SE-078718	
b. TYPE OF WELL OIL WELL <input type="checkbox"/> GAS WELL <input checked="" type="checkbox"/> OTHER <input type="checkbox"/>		6. IF INDIAN, ALLOTTEE OR TRIBE NAME	
2. NAME OF OPERATOR NORTHWEST PIPELINE CORP.		7. UNIT AGREEMENT NAME	
3. ADDRESS OF OPERATOR 3539 EAST 30TH ST. FARMINGTON, NM 87401		8. FARM OR LEASE NAME HOLT	
4. LOCATION OF WELL (Report location clearly and in accordance with any State requirements.) At surface 917' FNL UNIT A At proposed prod. zone 1199' FEL SAME		9. WELL NO. #200	
14. DISTANCE IN MILES AND DIRECTION FROM NEAREST TOWN OR POST OFFICE* APPROXIMATELY 8.1 MILES NW OF CEDAR HILL, NM		10. FIELD AND POOL, OR WILDCAT BASIN FRUITLAND COAL	
15. DISTANCE FROM PROPOSED* LOCATION TO NEAREST PROPERTY OR LEASE LINE, FT. (Also to nearest drlg. unit line, if any) 917'		11. SEC., T., R., M., OR BLK. AND SURVEY OR AREA SECTION 19, T32N, R11W	
18. DISTANCE FROM PROPOSED LOCATION* TO NEAREST WELL, DRILLING, COMPLETED, OR APPLIED FOR, ON THIS LEASE, FT. ± 245'		12. COUNTY OR PARISH 13. STATE SAN JUAN NM	
21. ELEVATIONS (Show whether DF, RT, GR, etc.) 6613' RR		17. NO. OF ACRES ASSIGNED TO THIS WELL E/2 320 ACRES	
20. PROPOSED DEPTH 3160' KB		22. APPROX. DATE WORK WILL START* JUNE 15, 1990	
20. ROTARY OR CABLE TOOLS ROTARY			
23. APPROX. DATE WORK WILL START* JUNE 15, 1990			

This action is subject to technical and procedural review pursuant to 43 CFR 3165.3 and appeal pursuant to 43 CFR 3165.4.

PROPOSED CASING AND CEMENTING PROGRAM			
	WEIGHT PER FOOT	SETTING DEPTH	
12 1/4"	9 5/8"	36# K-55	200'
8 3/4"	7"	23# K-55	2985'
6 1/4"	5 1/2"	23# P-110	2885' TO 3160'

DRILLING OPERATIONS AUTHORIZED ARE SUBJECT TO COMPLIANCE WITH ATTACHED "GENERAL REQUIREMENTS".

QUANTITY OF CEMENT
120 SX (143 cu ft.)
415 SX (793 cu ft.)
NONE - OPEN HOLE

1) PLAN TO DRILL FRUITLAND COAL FROM 3006' TO 3153' AND SET LINER IN OPEN HOLE. IF OPEN HOLE PROVES UNPRODUCTIVE, THE 5 1/2" LINER WILL BE CHANGED TO 15.5# K-55, CEMENTED AND HYDRAULICALLY STIMULATED AS NECESSARY.

2) THE EAST HALF OF SECTION 19 IS DEDICATED TO THIS WELL.

RECEIVED

JUN 19 1990

OIL CON. DIST.

IN ABOVE SPACE DESCRIBE PROPOSED PROGRAM: If proposal is to deepen or plug back, give data on present productive zone and proposed new productive zone. If proposal is to drill or deepen directionally, give pertinent data on subsurface locations and measured and true vertical depths. Give blowout preventer program, if any.

24. SIGNED Mark M. Culis TITLE PRODUCTION & DRILLING ENGINEER DATE 4/23/90

(This space for Federal or State office use)

PERMIT NO. _____ APPROVAL DATE _____

APPROVED BY _____ TITLE _____ DATE _____

CONDITIONS OF APPROVAL, IF ANY:

NMOC

APPROVED

JUN 13 1990
John S. Keller
AREA MANAGER

*See Instructions On Reverse Side

1. 在 1982 年 12 月 1 日以前，
 2. 在 1982 年 12 月 1 日以后，
 3. 在 1982 年 12 月 1 日以后，

Submit to Appropriate
District Office
State Lease - 4 copies
Fee Lease - 3 copies

State of New Mexico
Energy, Minerals and Natural Resources Department

Form C-102
Revised 1-1-89

OIL CONSERVATION DIVISION

P.O. Box 2088
Santa Fe, New Mexico 87504-2088

DISTRICT I
P.O. Box 1980, Hobbs, NM 88240

DISTRICT II
P.O. Drawer DD, Artesia, NM 88210

DISTRICT III
1000 Rio Brazos Rd., Aztec, NM 87410

WELL LOCATION AND ACREAGE DEDICATION PLAT

All Distances must be from the outer boundaries of the section

Operator NORTHWEST PIPELINE CORP.			Lease HOLT		Well No. 200
Unit Letter A	Section 19	Township T.32 N.	Range R.11 W.	County SAN JUAN COUNTY	
Actual Footage Location of Well: 917 feet from the NORTH line and 1199 feet from the EAST line					
Ground level Elev. 6613	Producing Formation FRUITLAND		Pool BASIN FRUITLAND COAL		Dedicated Acreage: E/2 320 Acres

1. Outline the acreage dedicated to the subject well by colored pencil or hatchure marks on the plat below.
2. If more than one lease is dedicated to the well, outline each and identify the ownership thereof (both as to working interest and royalty).
3. If more than one lease of different ownership is dedicated to the well, have the interest of all owners been consolidated by communitization, unitization, force-pooling, etc.?
☒ Yes ☐ No If answer is "yes" type of consolidation **UNITIZED**
If answer is "no" list the owners and tract descriptions which have actually been consolidated. (Use reverse side of this form if necessary.)
No allowable will be assigned to the well until all interests have been consolidated (by communitization, unitization, forced-pooling, or otherwise) or until a non-standard unit, eliminating such interest, has been approved by the Division.

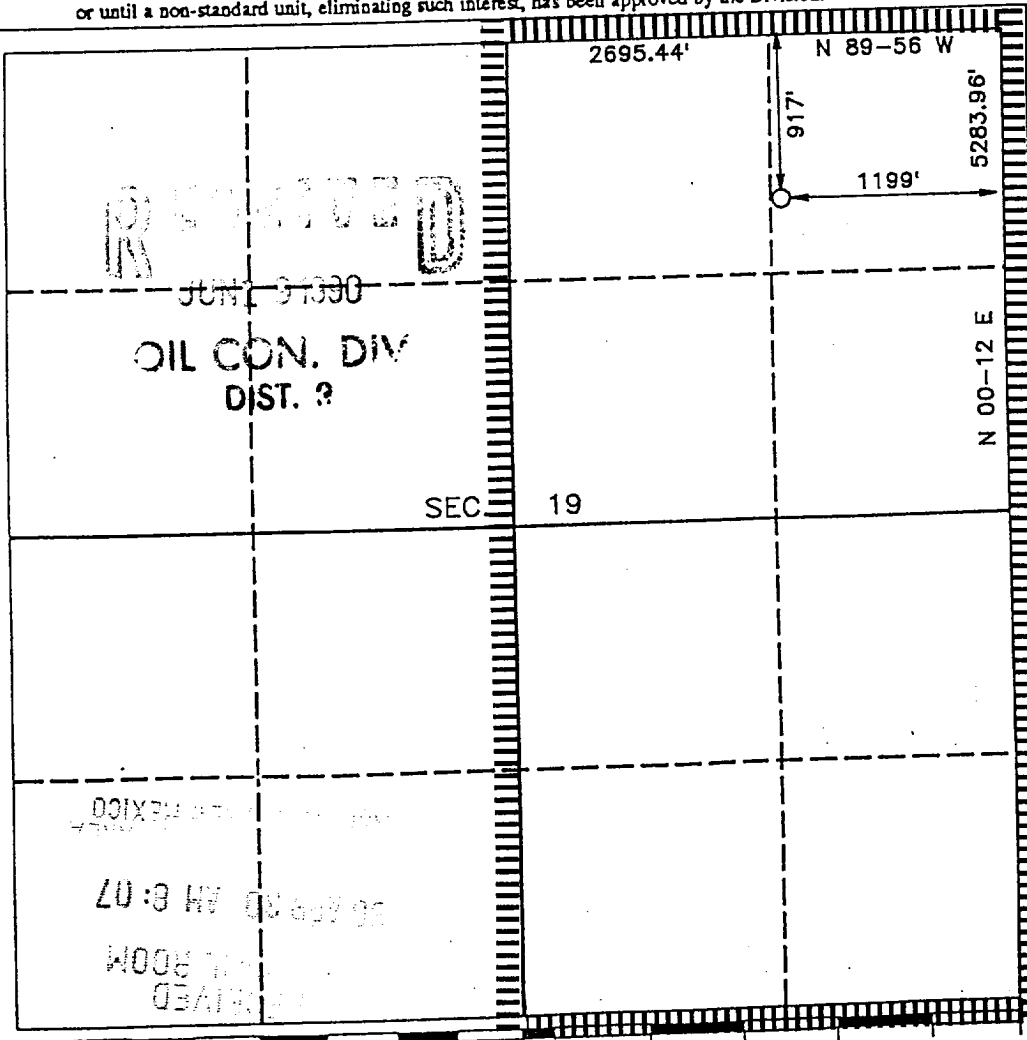

OPERATOR CERTIFICATION

I hereby certify that the information contained herein is true and complete to the best of my knowledge and belief.

Signature
Mark McCallister
Printed Name
MARK MCCALLISTER
Position
PROD. & DRLG. ENGINEER
Company
NORTHWEST PIPELINE CORP.
Date
APRIL 18, 1990

SURVEYOR CERTIFICATION

I hereby certify that the well location shown on this plat was plotted from field notes of actual surveys made by me or under my supervision, and that the same is true and correct to the best of my knowledge and belief.

Date Surveyed
APRIL 17, 1990
Signature & Seal of Professional Surveyor
R. HOWARD DADGE
Certificate No.
9679
Registered Professional
Land Surveyor

