

UNITED STATES  
DEPARTMENT OF THE INTERIOR  
BUREAU OF LAND MANAGEMENT

APPLICATION FOR PERMIT TO DRILL, DEEPEN, OR PLUG BACK

1a. TYPE OF WORK

DRILL ☒

DEEPEN ☐

PLUG BACK ☐

b. TYPE OF WELL

OIL  
WELL ☐

COAL  
WELL ☒

OTHER Coal Seam

SINGLE  
ZONE ☒

MULTIPLE  
ZONE ☐

2. NAME OF OPERATOR

Amoco Production Company ATTN: J. L. Hampton

3. ADDRESS OF OPERATOR

P. O. Box 800 Denver, Colorado 80201

4. LOCATION OF WELL (Report location clearly and in accordance with any State requirements.)\*  
At surface

2270' FNL, 1420' FEL, SW/NE

At proposed prod. zone

14. DISTANCE IN MILES AND DIRECTION FROM NEAREST TOWN OR POST OFFICE\*

18 miles - Aztec, NM

15. DISTANCE FROM PROPOSED\*

LOCATION TO NEAREST  
PROPERTY OR LEASE LINE, FT.  
(Also to nearest drlg. unit line, if any) 1420'

16. NO. OF ACRES IN LEASE

2,136.90

17. NO. OF ACRES ASSIGNED  
TO THIS WELL

320 acres E/2 311.61

18. DISTANCE FROM PROPOSED LOCATION\*  
TO NEAREST WELL, DRILLING, COMPLETED,  
OR APPLIED FOR, ON THIS LEASE, FT.

19. PROPOSED DEPTH

3458' TD

20. ROTARY OR CABLE TOOLS

Rotary

21. ELEVATIONS (Show whether DF, RT, GR, etc.) This action is subject to technical and  
procedural review pursuant to 43 CFR 3165.3  
and appeal pursuant to 43 CFR 3165.4.  
6612' GR PROPOSED CASING AND CEMENTING PROGRAM

22. APPROX. DATE WORK WILL START\*

As soon as permitted

23.

DRILLING OPERATIONS AUTHORIZED ARE  
SUBJECT TO COMPLIANCE WITH ATTACHED  
"GENERAL REQUIREMENTS"

SIZE OF HOLE	SIZE OF CASING	WEIGHT PER FOOT	SETTING DEPTH
12 1/4"	9 5/8"	36#	250'
8 3/4"	7"	20#	3150'
6 1/4"	5 1/2"	23#	3458' (TD)

200 cf Class B (cement to surface)  
882 cf Class B (cement to surface)  
None

Notice of Staking was Submitted: 7/18/90

Lease Description:

T31N-R9W:

Sec. 5: Lots 5-12

Sec. 6: Lots 8-22

T32N-R9W:

Sec. 29: Lots 3-6, 11-14 W/2

Sec. 30: Lots 5-20, All

Sec. 31: Lots 5-20, All

**CONFIDENTIAL**

IN ABOVE SPACE DESCRIBE PROPOSED PROGRAM: If proposal is to deepen or plug back, give data on present productive zone and proposed new productive zone. If proposal is to drill or deepen directionally, give pertinent data on subsurface locations and measured and true vertical depths. Give blowout preventer program, if any.

24.

SIGNED

J. L. Hampton

TITLE Sr. Staff Admin. Supervisor

DATE

8/14/90

(This space for Federal or State Approval)

PERMIT NO.

APPROVAL DATE

APPROVED BY

AUG 29 1990

TITLE

DATE

CONDITIONS OF APPROVAL, IF ANY:

OIL CON. DIV  
DIST. 3

NMOCD

\*See Instructions On Reverse Side

Send to Appropriate  
District Office  
State Lease - 4 copies  
Fee Lease - 3 copies

State of New Mexico  
Energy, Minerals and Natural Resources Department

Form C-102  
Revised 1-1-89

OIL CONSERVATION DIVISION

P.O. Box 2088  
Santa Fe, New Mexico 87504-2088

**CONFIDENTIAL**

DISTRICT I  
P.O. Box 1980, Hobbs, NM 88240

DISTRICT II  
P.O. Drawer DD, Artesia, NM 88210

DISTRICT III  
1000 Rio Brazos Rd., Aztec, NM 87410

WELL LOCATION AND ACREAGE DEDICATION PLAT

All Distances must be from the outer boundaries of the section

Operator <b>AMOCO PRODUCTION COMPANY</b>			Lease <b>ISABEL /A/</b>		Well No. <b># 1</b>
Unit Letter <b>G</b>	Section <b>30</b>	Township <b>32 NORTH</b>	Range <b>9 WEST</b>	County <b>SAN JUAN</b>	
Actual Footage Location of Well: <b>2270</b> feet from the <b>NORTH</b> line and <b>1420</b> feet from the <b>EAST</b> line					
Ground level Elev. <b>6612</b>	Producing Formation <b>Fruitland Coal</b>		Pool <b>Basin Fruitland Coal Gas</b>		Dedicated Acreage <b>E/2 311.61</b> Acres

1. Outline the acreage dedicated to the subject well by colored pencil or hatchure marks on the plat below.
2. If more than one lease is dedicated to the well, outline each and identify the ownership thereof (both as to working interest and royalty).
3. If more than one lease of different ownership is dedicated to the well, have the interest of all owners been consolidated by communitization, unitization, force-pooling, etc.?  
☐ Yes ☐ No If answer is "yes" type of consolidation \_\_\_\_\_  
If answer is "no" list the owners and tract descriptions which have actually been consolidated. (Use reverse side of this form if necessary.) \_\_\_\_\_  
No allowable will be assigned to the well until all interests have been consolidated (by communitization, unitization, forced-pooling, or otherwise) or until a non-standard unit, eliminating such interest, has been approved by the Division.

**RECEIVED**  
**AUG 29 1990**  
**OIL CON. DIV**  
**DIST. 3**

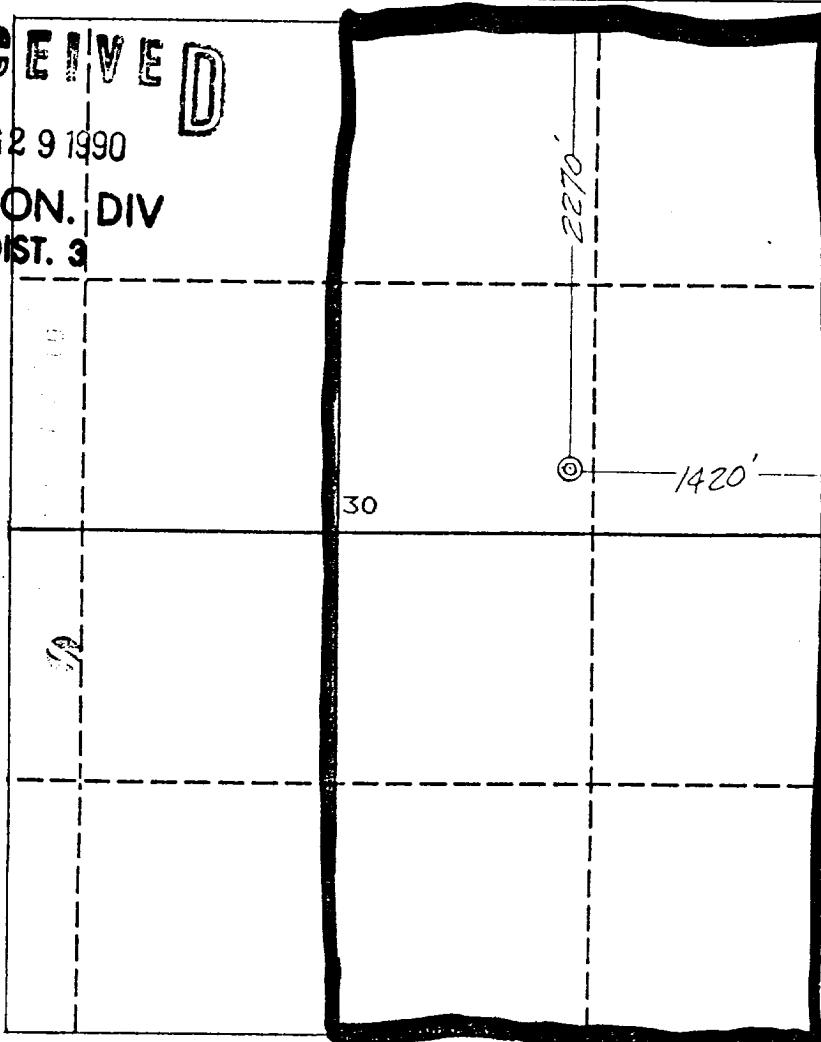

OPERATOR CERTIFICATION

I hereby certify that the information contained herein is true and complete to the best of my knowledge and belief.

Signature *[Signature]*  
Printed Name **J L Hampton**  
Position **Sr Staff Admin Supr**  
Company **Amoco Prod.**  
Date **7-18-90**

SURVEYOR CERTIFICATION

I hereby certify that the well location shown on this plat was plotted from field notes of actual surveys made by me or under my supervision, and that the same is true and correct to the best of my knowledge and belief.

Date Surveyed **July 9, 1990**

Signature & Seal of Professional Surveyor  
**GARY D. VANN**  
**NEW MEXICO**  
**REGISTERED PROFESSIONAL LAND SURVEYOR**  
**7016**

